

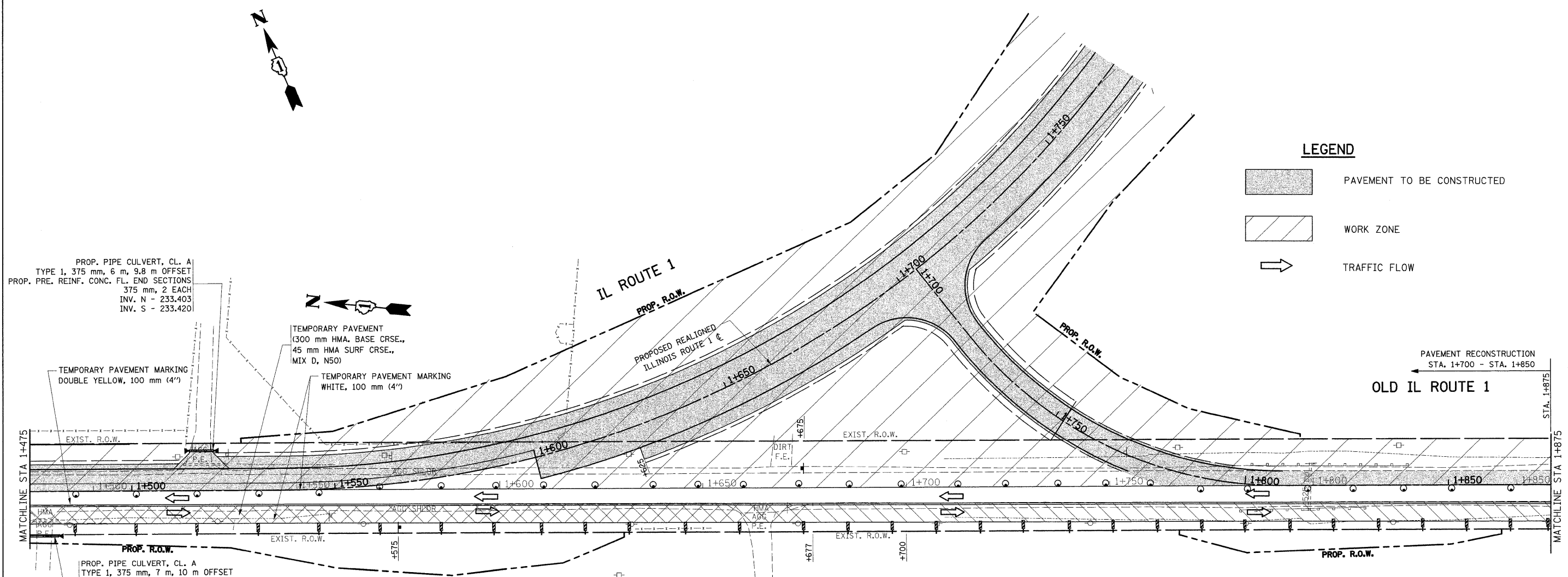

F.A.P. RTE.	SECTION	COUNTY	TOTAL SHEETS	SHEET NO.
876	9Y-RS-7	WILL	100	25
STA. 1+475		TO STA. 1+875		
FED. ROAD DIST. NO. 1		ILLINOIS FED. AID PROJECT		
CONTRACT NO. 60E52				



**LEGEND**

-  PAVEMENT TO BE CONSTRUCTED
-  WORK ZONE
-  TRAFFIC FLOW

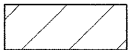
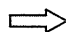
PROP. PIPE CULVERT, CL. A  
TYPE 1, 375 mm, 6 m, 9.8 m OFFSET  
PROP. PRE. REINF. CONC. FL. END SECTIONS  
375 mm, 2 EACH  
INV. N - 233.403  
INV. S - 233.420

TEMPORARY PAVEMENT  
(300 mm HMA. BASE CRSE.,  
45 mm HMA SURF CRSE.,  
MIX D, N50)  
TEMPORARY PAVEMENT MARKING  
WHITE, 100 mm (4")

TEMPORARY PAVEMENT MARKING  
DOUBLE YELLOW, 100 mm (4")

PAVEMENT RECONSTRUCTION  
STA. 1+700 - STA. 1+850  
OLD IL ROUTE 1

PROP. PIPE CULVERT, CL. A  
TYPE 1, 375 mm, 7 m, 10 m OFFSET  
PROP. PRE. REINF. CONC. FL. END SECTIONS  
375 mm, 2 EACH  
INV. N - 233.100  
INV. S - 233.105

REVISIONS	
NAME	DATE

ILLINOIS DEPARTMENT OF TRANSPORTATION  
**SUGGESTED  
MAINTENANCE OF TRAFFIC  
IL. 1  
STAGE I**

SCALE 1:500  
DATE 9/3/2008

DRAWN BY  
CHECKED BY