

F.A.P. RTE.	SECTION	COUNTY	TOTAL SHEETS	SHEET NO.
876	9Y-RS-7	WILL	100	33
STA. 1+100		TO STA. 1+475		
FED. ROAD DIST. NO. 1		ILLINOIS FED. AID PROJECT		
CONTRACT NO. 60E52				

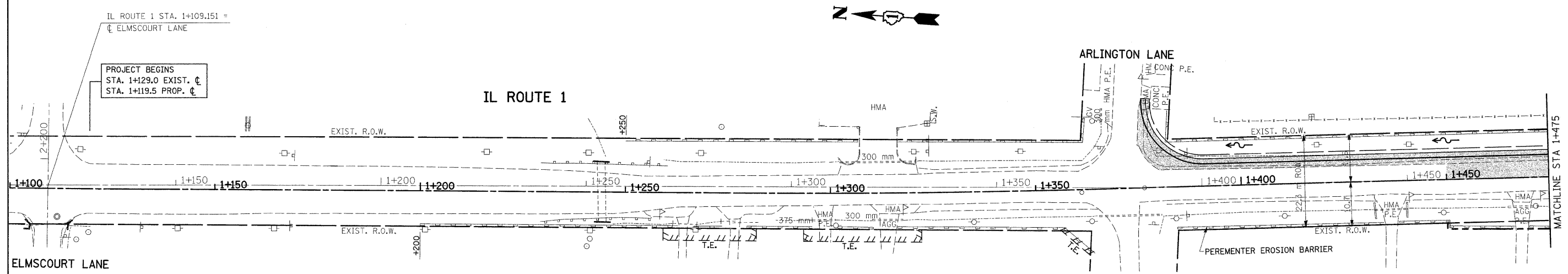

IL ROUTE 1 STA. 1+109.151 =  
 CL ELMSCOURT LANE

PROJECT BEGINS  
 STA. 1+129.0 EXIST. CL  
 STA. 1+119.5 PROP. CL

**LEGEND**

- PERIMETER EROSION CONTROL
- TEMPORARY DITCH CHECKS, URETHANE FORM
- SEDIMENT CONTROL DRAINAGE STRUCTURE INLET FILTER CLEANING
- INLET FILTERS
- PAVEMENT TO BE CONSTRUCTED

REVISIONS		ILLINOIS DEPARTMENT OF TRANSPORTATION EROSION CONTROL PLAN IL. 1 STAGE I
NAME	DATE	
		SCALE 1:500 DATE 9/23/2008
DRAWN BY		CHECKED BY