

F.A.P. RTE.	SECTION	COUNTY	TOTAL SHEETS	SHEET NO.
876	9Y-RS-7	WILL	100	41
STA. 1+100		TO STA. 1+875		
FED. ROAD DIST. NO. 1 ILLINOIS FED. AID PROJECT				

CONTRACT NO. 60E52

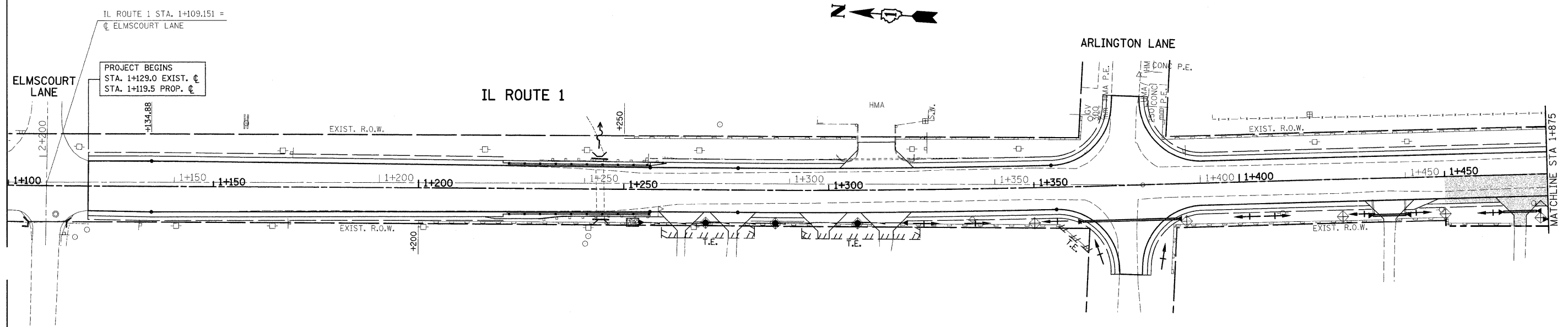

IL ROUTE 1 STA. 1+109.151 =  
 ☉ ELMSCOURT LANE

PROJECT BEGINS  
 STA. 1+129.0 EXIST. ☉  
 STA. 1+119.5 PROP. ☉

IL ROUTE 1

ARLINGTON LANE

ELMSCOURT LANE

MATCHLINE STA 1+875

LEGEND

- PERIMETER EROSION CONTROL
- ◆ TEMPORARY DITCH CHECKS, URETHANE FORM
- ◆\* SEDIMENT CONTROL DRAINAGE STRUCTURE INLET FILTER CLEANING
- ◆ INLET FILTERS

PAVEMENT TO BE CONSTRUCTED

REVISIONS	
NAME	DATE

ILLINOIS DEPARTMENT OF TRANSPORTATION  
**EROSION CONTROL PLAN**  
**IL. 1**  
**STAGE III**

SCALE 1:500  
 DATE 9/23/2008

DRAWN BY  
 CHECKED BY