

F.A.P. RTE.	SECTION	COUNTY	TOTAL SHEETS	SHEET NO.
876	9Y-RS-7	WILL	100	70
STA. 2+400		TO STA. 2+600		
FED. ROAD DIST. NO. 1		ILLINOIS FED. AID PROJECT		
CONTRACT NO. 60E52				

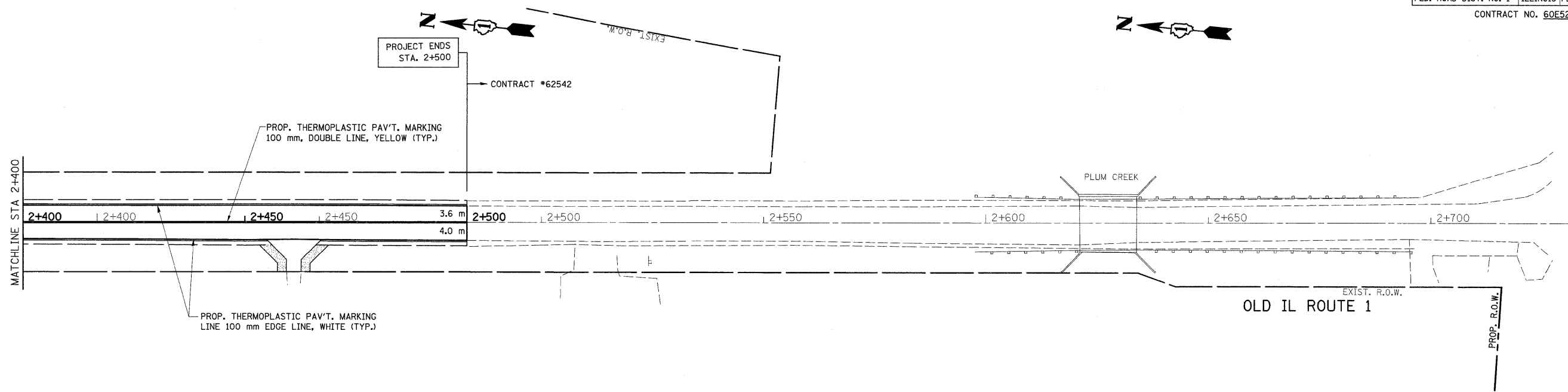

LEGEND

- SODDING SALT TOLERANT
- SEEDING CLASS 2A
- SEEDING CLASS 4
- EROSION CONTROL BLANKET (SEE SEEDING DETAIL THIS PAGE)

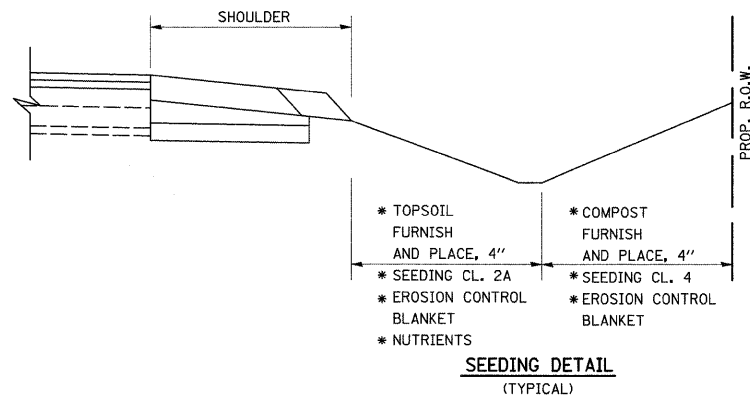

REVISIONS	
NAME	DATE

ILLINOIS DEPARTMENT OF TRANSPORTATION
IL. ROUTE 1
PROPOSED
LANDSCAPING AND
PAVEMENT MARKING PLAN

SCALE 1:500
 DATE 9/3/2008

DRAWN BY
 CHECKED BY