

F.A.U. RTE.	SECTION	COUNTY	TOTAL SHEETS	SHEET NO.
2505	94-P4008-01-BR	KANE	81	23
STA.		TO STA.		
FED. ROAD DIST. NO.		ILLINOIS FED. AID PROJECT		

GRAPHIC SCALE



**REMOVE EXISTING TRAFFIC SIGNAL EQUIPMENT, 1 EACH**

THE FOLLOWING ITEMS SHALL BE REMOVED BY THE CONTRACTOR AND SHALL BE DISPOSED OF BY THEM OUTSIDE THE RIGHT-OF-WAY AT THEIR EXPENSE. THE SALVAGE VALUE OF THE REMOVED EQUIPMENT SHALL BE REFLECTED IN THE CONTRACT BID PRICE.

- 4 EACH PEDESTRIAN SIGNAL HEAD
- 4 EACH PEDESTRIAN PUSH-BUTTON

**TRAFFIC SIGNAL LEGEND**

	PROPOSED	EXISTING
CONTROLLER	[Symbol]	[Symbol]
SERVICE INSTALLATION	[Symbol]	[Symbol]
SIGNAL HEAD	[Symbol]	[Symbol]
SIGNAL HEAD WITH BACKPLATE	[Symbol]	[Symbol]
SIGNAL HEAD PEDESTRIAN WITH COUNTDOWN TIMERS	[Symbol]	[Symbol]
SIGNAL POST	[Symbol]	[Symbol]
MAST ARM ASSEMBLY AND POLE, STEEL	[Symbol]	[Symbol]
MAST ARM ASSEMBLY AND POLE, ALUMINUM	[Symbol]	[Symbol]
HANDHOLE	[Symbol]	[Symbol]
HEAVY DUTY HANDHOLE	[Symbol]	[Symbol]
DOUBLE HANDHOLE	[Symbol]	[Symbol]
G.S. CONDUIT IN TRENCH OR PUSHED	[Symbol]	[Symbol]
PEDESTRIAN PUSHBUTTON DETECTOR	[Symbol]	[Symbol]
DETECTOR LOOP	[Symbol]	[Symbol]
CAST IRON JUNCTION BOX	[Symbol]	[Symbol]
COMMON TRENCH	[Symbol]	[Symbol]
UNIT DUCT	[Symbol]	[Symbol]
EMERGENCY VEHICLE SYSTEM DETECTOR	[Symbol]	[Symbol]
CONFIRMATION BEACON	[Symbol]	[Symbol]
SIGNAL HEAD OPTICALLY PROGRAMMED	[Symbol]	[Symbol]
MICROWAVE VEHICLE SENSOR	[Symbol]	[Symbol]
TELEPHONE CONNECTION	[Symbol]	[Symbol]
ILLUMINATED SIGN "NO LEFT TURN"	[Symbol]	[Symbol]
ILLUMINATED SIGN "NO RIGHT TURN"	[Symbol]	[Symbol]
CONDUIT SPLICE	[Symbol]	[Symbol]
WOOD POLE	[Symbol]	[Symbol]
RACEWAY FOR MAGNETIC DETECTOR, TYPE I OR TYPE II	[Symbol]	[Symbol]
VEHICLE DETECTOR, NON COMPENSATED MAGNETIC TYPE	[Symbol]	[Symbol]
RAILROAD CONTROL HUT	[Symbol]	[Symbol]
UNINTERRUPTABLE POWER SUPPLY (UPS) BATTERY BACK-UP SYSTEM	[Symbol]	[Symbol]
EXISTING HANDHOLE TO BE REMOVED	[Symbol]	[Symbol]

**NOTES**

- THE EXISTING TRAFFIC SIGNAL PLAN WAS DERIVED FROM THE PLANS FOR PROPOSED TRAFFIC SIGNAL INTERCONNECT PLANS, CONGESTION MITIGATION AIR QUALITY RANDALL ROAD FROM RED HAW LANE TO SILVER GLEN ROAD AND IL RT 72 TO BINNIE ROAD, JUNE 13, 2008, AND FIELD OBSERVATIONS. CONTRACTOR SHALL VERIFY THAT THE PLANS MATCH EXISTING CONDITIONS. CONTRACTOR SHALL NOTIFY THE ENGINEER OF DISCREPANCIES PRIOR TO CONSTRUCTION.
- ALL COUNTDOWN PEDESTRIAN SIGNAL HEADS SHALL BE 16" X 18".

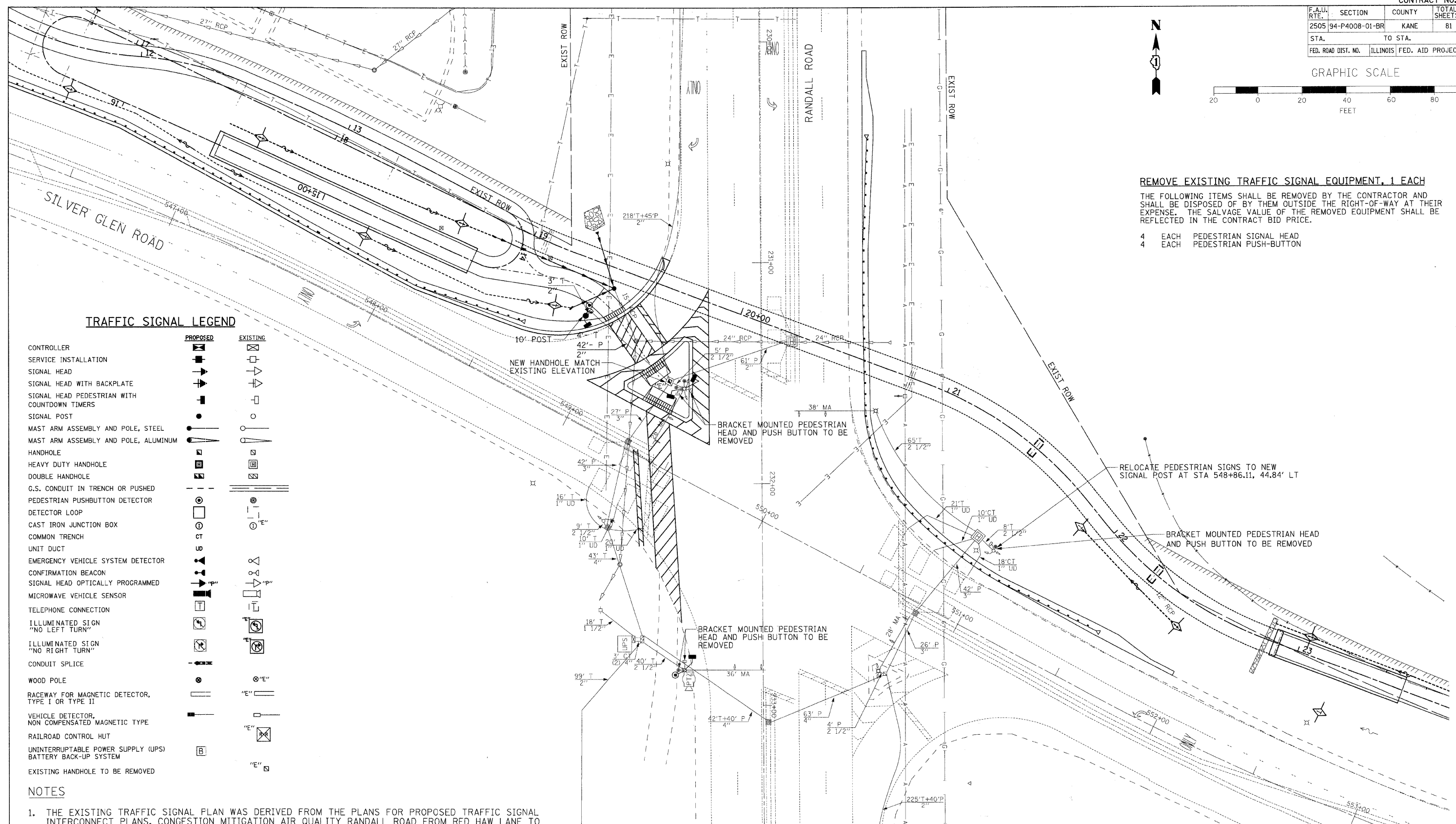

PLOT DATE = 11/4/2008  
 FILE NAME = H:\AS\CP\p4008-01-BR\Design\Drawings\11606451081.dgn  
 PLOT SCALE = 1"=20'  
 REFERENCE = #REF#

**RH&A**  
 Robert H. Anderson & Associates, Inc.  
 Consulting Engineers  
 License No. 184-005281

REVISIONS	
NAME	DATE

ILLINOIS DEPARTMENT OF TRANSPORTATION  
 PEDESTRIAN BRIDGE OVER  
 RANDALL ROAD AT SILVER GLEN ROAD  
 FAU 2505, SECTION 94-P4008-01-BR  
 STRUCTURE NUMBER 045-9000  
 TRAFFIC SIGNAL PLAN  
 SHEET 1 OF 1

VERT. SCALE: 1"=20'  
 HORIZ. SCALE: 1"=20'  
 DATE: OCTOBER 31, 2008

DRAWN BY: TC  
 CHECKED BY: SBP