

FMP ROUTE	SECTION	COUNTY	TOTAL SHEETS	SHEET NO.
	05-00016-03-BR	MADISON	129	30
STA.	32+00	TO STA.	38+00	
CONTRACT NO.: 97351				

DATE	2/27/06
BY	J.L.F.
PLANNED	
NOTED	
NO.	
NO.	
NO.	
NO.	
NO.	

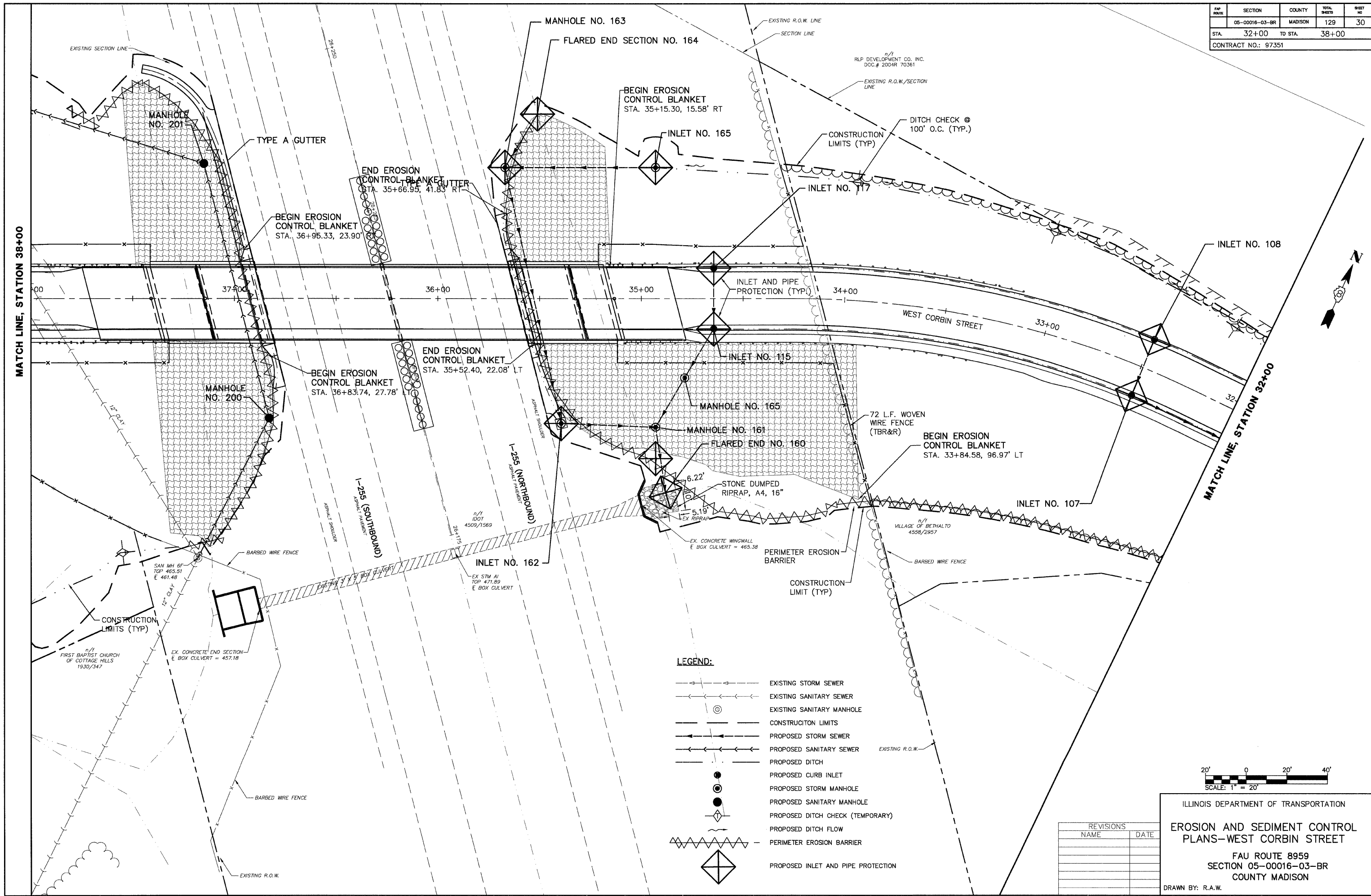

- LEGEND:**
- >--->---> EXISTING STORM SEWER
 - >--->---> EXISTING SANITARY SEWER
 - ⊙ EXISTING SANITARY MANHOLE
 - CONSTRUCTION LIMITS
 - >--->---> PROPOSED STORM SEWER
 - >--->---> PROPOSED SANITARY SEWER
 - PROPOSED DITCH
 - PROPOSED CURB INLET
 - PROPOSED STORM MANHOLE
 - PROPOSED SANITARY MANHOLE
 - ⊙ PROPOSED DITCH CHECK (TEMPORARY)
 - PROPOSED DITCH FLOW
 - PERIMETER EROSION BARRIER
 - ◇ PROPOSED INLET AND PIPE PROTECTION

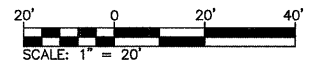

REVISIONS	
NAME	DATE

ILLINOIS DEPARTMENT OF TRANSPORTATION

EROSION AND SEDIMENT CONTROL PLANS—WEST CORBIN STREET

FAU ROUTE 8959
SECTION 05-00016-03-BR
COUNTY MADISON

DRAWN BY: R.A.W.