

FMP ROUTE	SECTION	COUNTY	TOTAL SHEETS	SHEET NO.
	05-00016-03-BR	MADISON	129	32
STA.	43+50	TO STA.	49+00	
CONTRACT NO.: 97351				

PLAN	SURVEYED	DATE
NO.	BY	2/7/06
	J.L.L.	
	ERCO.	
	PLANNING	
	DESIGNED	
	CHECKED	
	BY	
	DATE	
	FILE NAME	

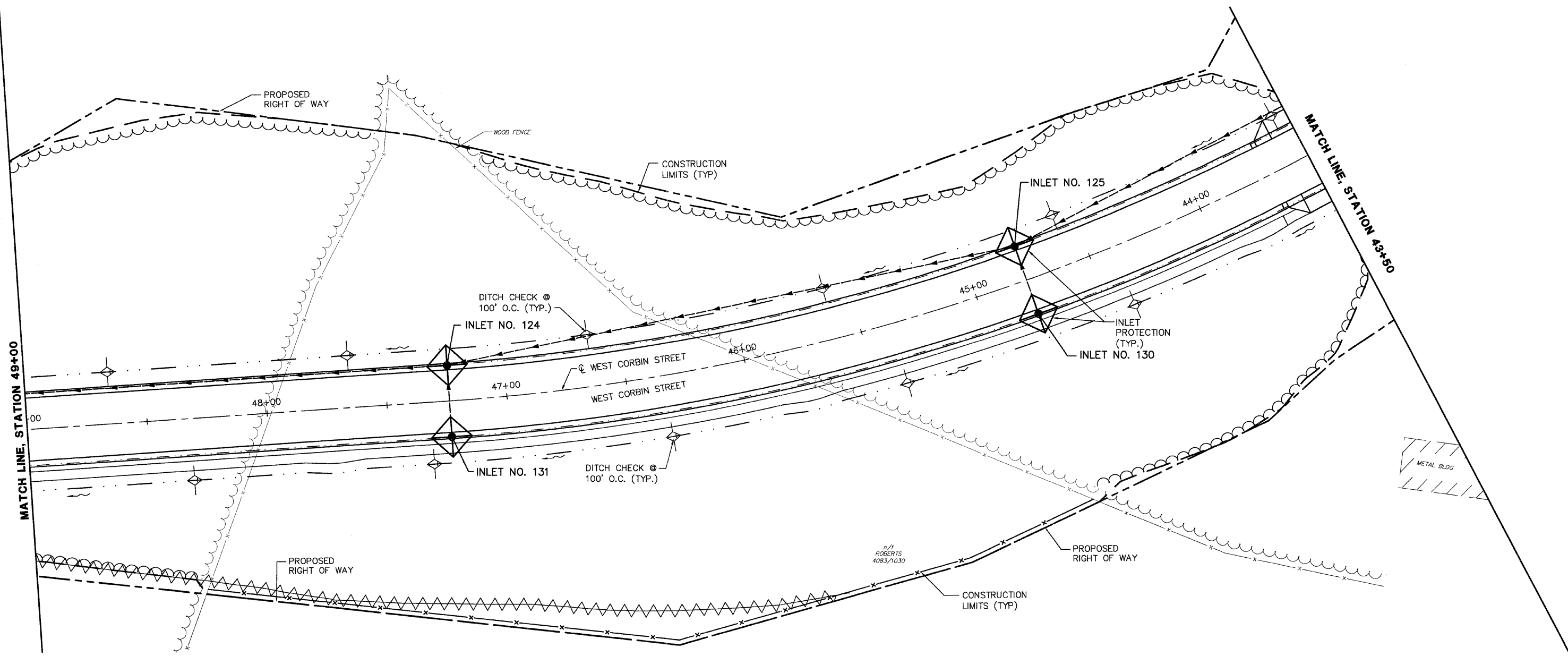

LEGEND:

	EXISTING STORM SEWER
	EXISTING SANITARY SEWER
	EXISTING SANITARY MANHOLE
	CONSTRUCTION LIMITS
	PROPOSED STORM SEWER
	PROPOSED SANITARY SEWER
	PROPOSED DITCH
	PROPOSED CURB INLET
	PROPOSED STORM MANHOLE
	PROPOSED SANITARY MANHOLE
	PROPOSED DITCH CHECK (TEMPORARY)
	PROPOSED DITCH FLOW
	PERIMETER EROSION BARRIER
	PROPOSED INLET AND PIPE PROTECTION

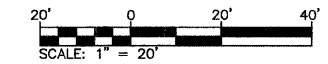
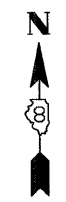

REVISIONS	
NAME	DATE

ILLINOIS DEPARTMENT OF TRANSPORTATION
**EROSION AND SEDIMENT CONTROL
PLANS—WEST CORBIN STREET**

FAU ROUTE 8959
SECTION 05-00016-03-BR
COUNTY MADISON

DRAWN BY: R.A.W.