

FAU ROUTE	SECTION	COUNTY	TOTAL SHEETS	SHEET NO.
05-00016-03-BR	MADISON	129	33	
STA. 49+00		TO STA. 54+50		
CONTRACT NO.: 97351				

DATE	2/27/06
BY	A.T.C.
CHECKED	E.R.O.
PLANNED	
NOTED	
NO.	

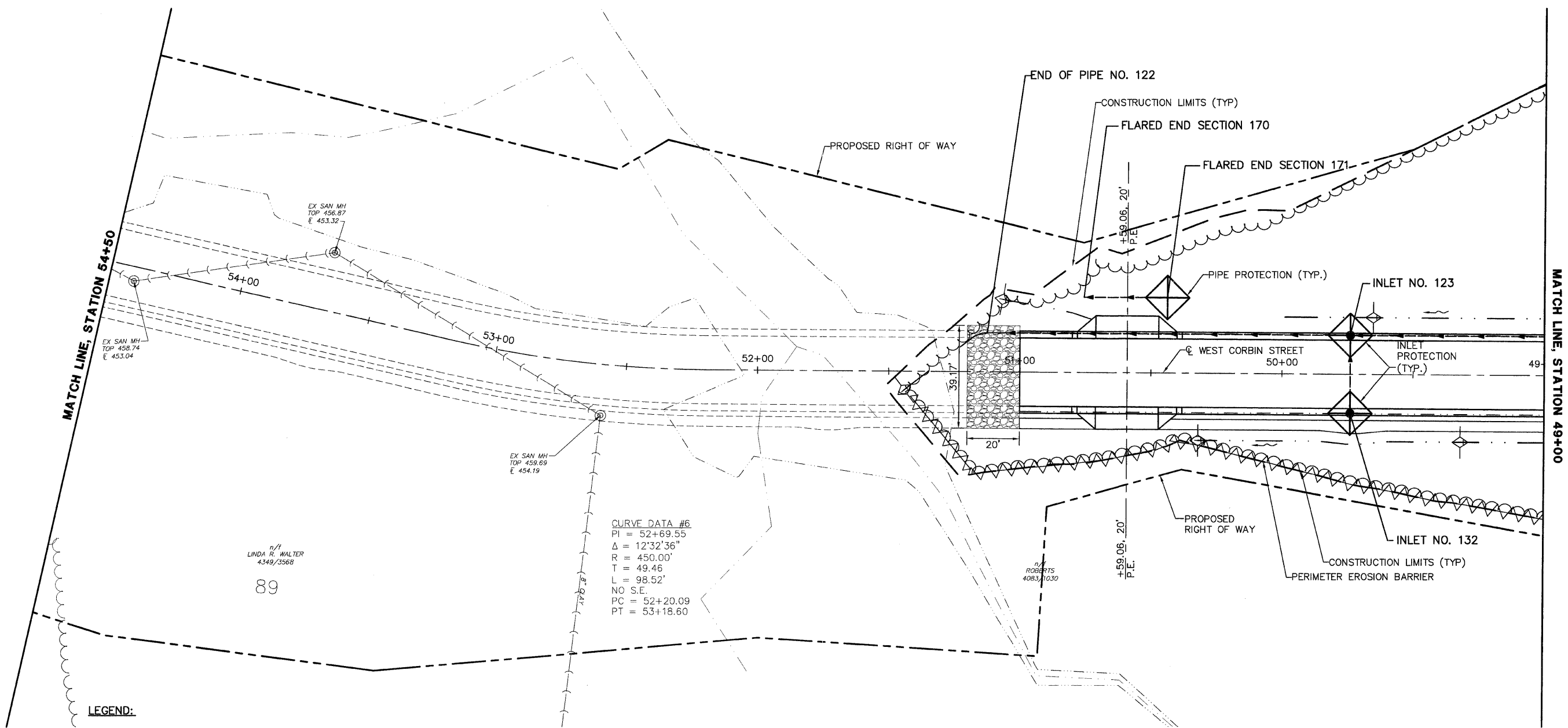

- LEGEND:**
- EXISTING STORM SEWER
  - EXISTING SANITARY SEWER
  - ⊙ EXISTING SANITARY MANHOLE
  - CONSTRUCTION LIMITS
  - PROPOSED STORM SEWER
  - PROPOSED SANITARY SEWER
  - PROPOSED DITCH
  - PROPOSED CURB INLET
  - ⊙ PROPOSED STORM MANHOLE
  - PROPOSED SANITARY MANHOLE
  - ◇ PROPOSED DITCH CHECK (TEMPORARY)
  - ~ PROPOSED DITCH FLOW
  - ▲ PERIMETER EROSION BARRIER
  - ◇ PROPOSED INLET AND PIPE PROTECTION

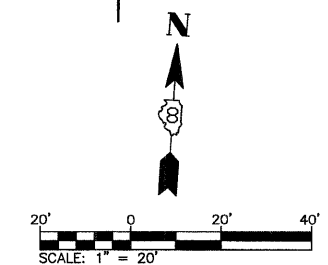

REVISIONS	
NAME	DATE

ILLINOIS DEPARTMENT OF TRANSPORTATION

**EROSION AND SEDIMENT CONTROL PLANS—WEST CORBIN STREET**

FAU ROUTE 8959  
SECTION 05-00016-03-BR  
COUNTY MADISON

DRAWN BY: R.A.W.