

IL 1/14 CENTERLINE			
DESCRIPTION	STATION	NORTHING	EASTING
POT	322+00.00	536182.5372	1054082.2707
PI	330+14.18	536802.7730	1054609.7142
PI	337+23.1588	537340.4574	1055071.8250
POT	351+00.0004	538387.3970	1055966.0343

CONTROL POINTS					
POINT NUMBER	STATION	OFFSET	NORTHING	EASTING	ELEVATION
97061	320+10.43±	24.83' RT±	536022.039	1053978.382	399.062
97062	329+71.01	31.37' RT	536749.562	1054605.649	394.197
97063	377+73.38	19.52' RT	537368.245	1055121.231	386.642

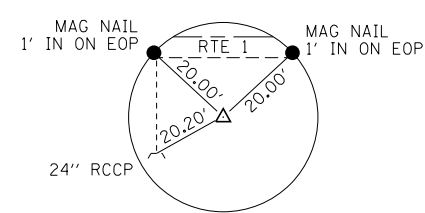

CP#97061 STA. 320+10.43±
 IRON PIN/CAP
 N. 536022.039
 E. 1053978.382

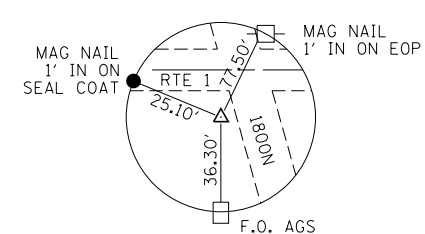

CP#97062 STA. 329+71.01
 IRON PIN/CAP
 N. 536749.562
 E. 1054605.649

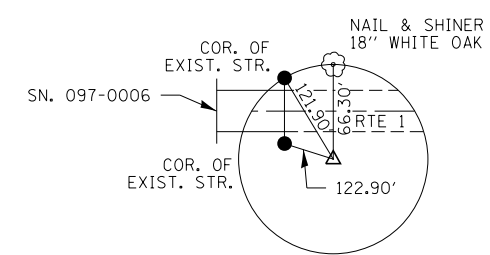

CP#97063 STA. 377+73.38
 IRON PIN/CAP
 N. 537368.245
 E. 1055121.231

BM AS-13
 1.9 MILES SOUTH OF INTERSECTION OF RTE 1 AND 14 IN CROSSVILLE,
 SET CHISELED SQUARE IN NORTH WEST WINGWALL OF BRIDGE SN 097-0006
 (REFER TO BOOK #3003 PG #29) FROM IDOT ELEV 385.051

BM AS-13A
 RAILROAD SPIKE IN POWER POLE IN
 NORTH WEST QUADRANT OF IL RTE 1
 AND CR1800 N, FROM IDOT
 46.56' LT STA 329+72.55 ELEV 395.163