

BENCHMARK: Chisled "C" in NW wingwall of bridge. 22.5' Lt., Sta. 336+44. Elev. 385.05

EXISTING STRUCTURE: SN 097-0006 was built in 1923 as SBI Route 1, Section 5B, BY Sec 5BR. It consisted of a 1-span RC slab bridge on closed abutments. In 1950 the bridge was widened in kind. In 1978, the superstructure was replaced with PPC deck beams. The bridge is 26'-9 1/2" bk.-bk. and 44'-0" o.-o. Structure is to be removed and replaced using stage construction to maintain one lane of traffic at all times.

SALVAGE: None

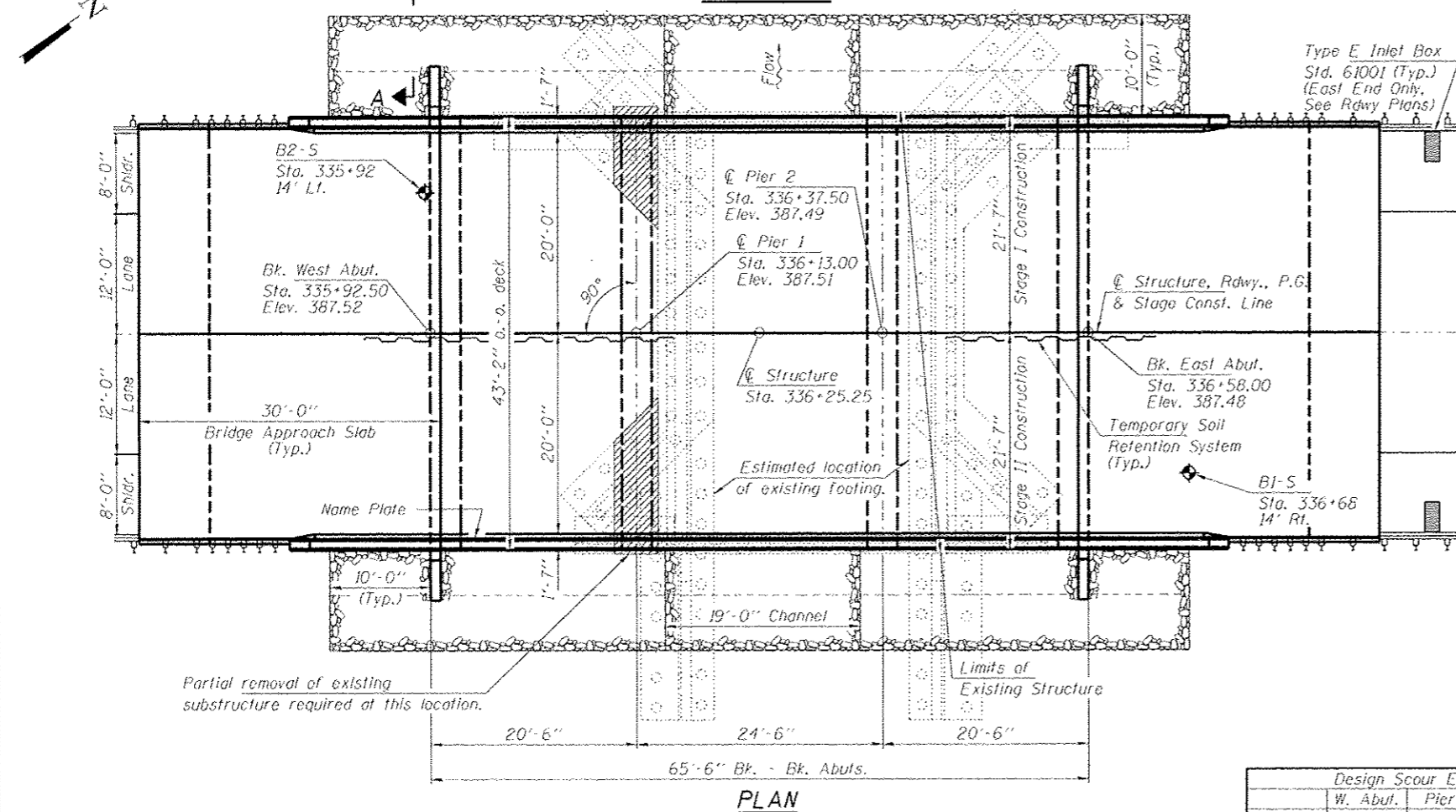
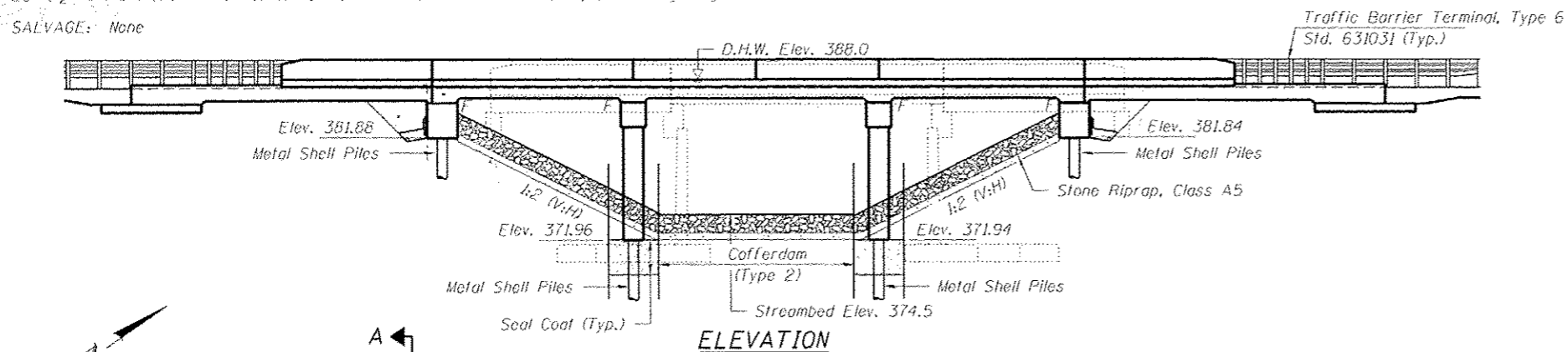

INDEX OF STRUCTURE SHEETS

1. General Plan & Elevation
2. General Details
3. Stage Construction Details
4. Temporary Concrete Barrier
5. Superstructure
- 6-7. Superstructure Details
- 8-9. Bridge Approach Slab Details
10. Abutments
11. Piers
12. Bar Splicer Details
13. Metal Shell Pile Details
- 14-15. Borings

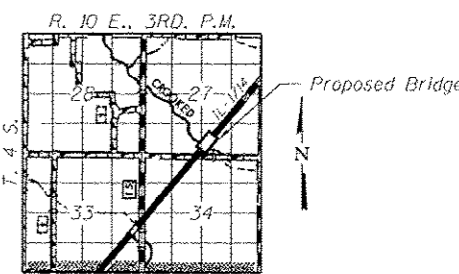

LOCATION SKETCH

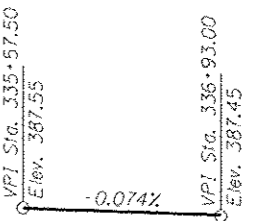

PROFILE GRADE

Design Scour Elevations (ft.)

	W. Abut.	Pier 1	Pier 2	E. Abut.
0100	382.0	361.0	361.0	381.9
0500	382.0	361.0	361.0	381.9

SEISMIC DATA

Seismic Performance Zone (SPZ) = 2
 Design Spectral Acceleration at 1.0 sec. (S_{pl}) = 0.288g
 Design Spectral Acceleration at 0.2 sec. (S₀₅) = 0.684g
 Soil Site Class = D

DESIGN SPECIFICATIONS

2012 AASHTO LRFD Bridge Design Specifications

LOADING HL-93

Allow 50#/sq. ft. for future wearing surface.

DESIGN STRESSES

f'_c = 3,500 psi
 f_y = 60,000 psi (Reinf.)

WATERWAY INFORMATION

Drainage Area = 5.26 Sq. Mi. Existing Low Grade Elev. 387.12 @ Sta. 339+50
 Proposed Low Grade Elev. 387.50 @ Sta. 336+26

Flood	Freq. Yr.	C.F.S.	Opening Sq. Ft.		Natural Head - Ft.		Headwater El.		
			Exist.	Prop.	H.W.E. Exist.	Prop.	Exist.	Prop.	
Min. Calc.	10	1160	225	400	385.7	0.8	0.2	386.5	385.9
Ex. Overtop	15	1285	225	422	386.1	1.0		387.1	
Pr. Overtop	26	1615	225	422	387.1		0.4		387.4
Design	50	1900	225	422	388.0	0.1	0.1	388.1	388.1
Base	100	2230	225	422	389.1	0.0	0.0	389.2	389.2

APPROVED
 For Structural Adequacy Only

Michael D. Cina
 Engineer of Bridges & Structures



Michael D. Cina
 ILLINOIS STRUCTURAL NO. 081-5984

Expires 11-30-2014
 9-11-2013

GENERAL PLAN AND ELEVATION
IL ROUTE 1/14
OVER CROOKED CREEK
FAP ROUTE 332 - SECTION 5B-1
WHITE COUNTY
STATION 336+25.25
STRUCTURE NO. 097-0079