

Notes:
 See sheet 9 of 15 for Sections C-C & D-D and View E-E.
 $a_2(E)$ and $a_3(E)$ bar spacings measured along \varnothing Rdwy.
 See sheet 9 of 15 for additional details.
 The joint opening shall be determined per Article 520.04 except that on jointless structures, the distance described as the bridge length between the nearest fixed bearings each way from the joint shall be taken as half the bridge length plus the approach slab length. The minimum dimension shall be $1\frac{1}{2}'$ for installation purposes.

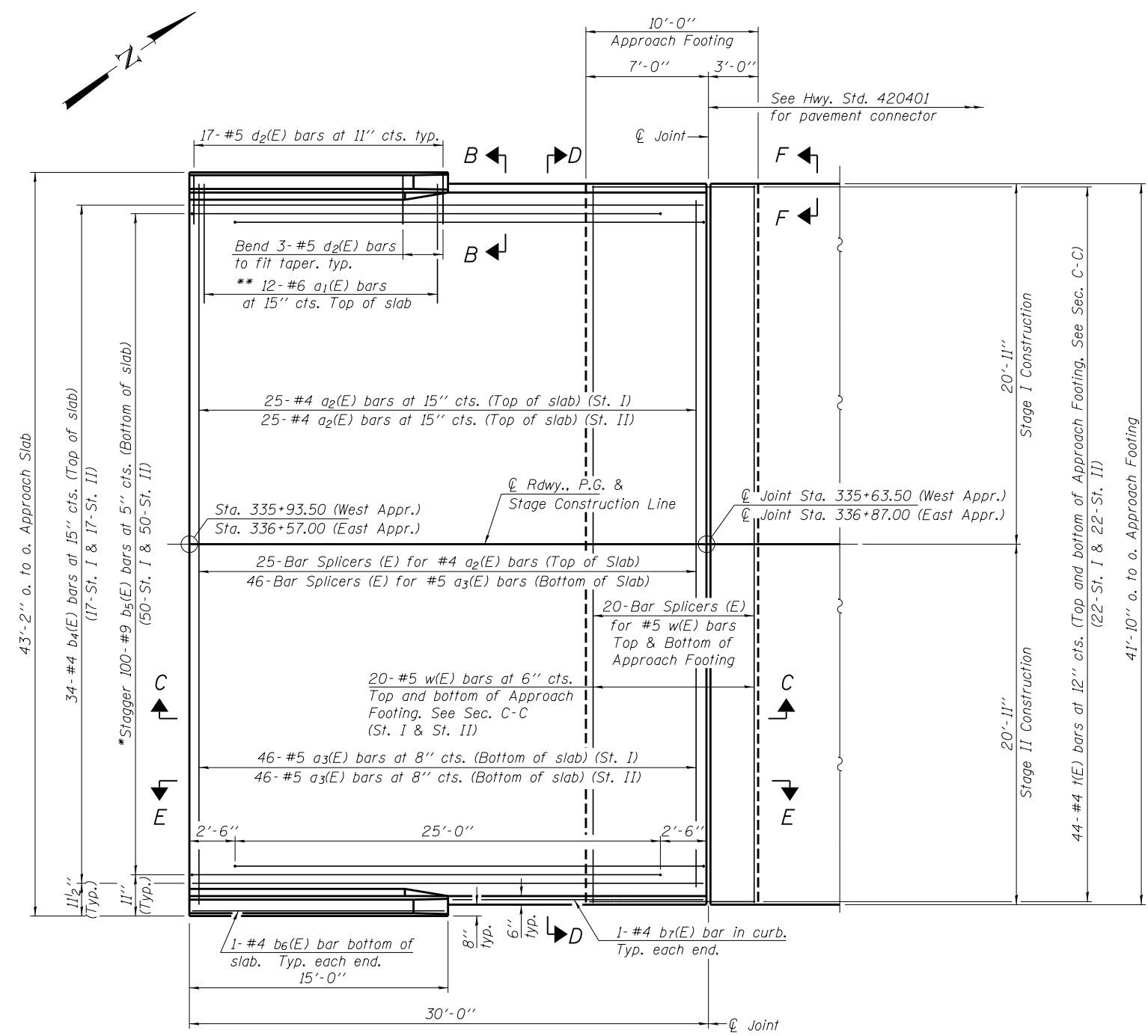

PLAN
 (East Approach Shown)

* Tilt #9 $b_5(E)$ bars as required to maintain clearance.
 ** Space between $a_2(E)$ bars, typ. ea. parapet.

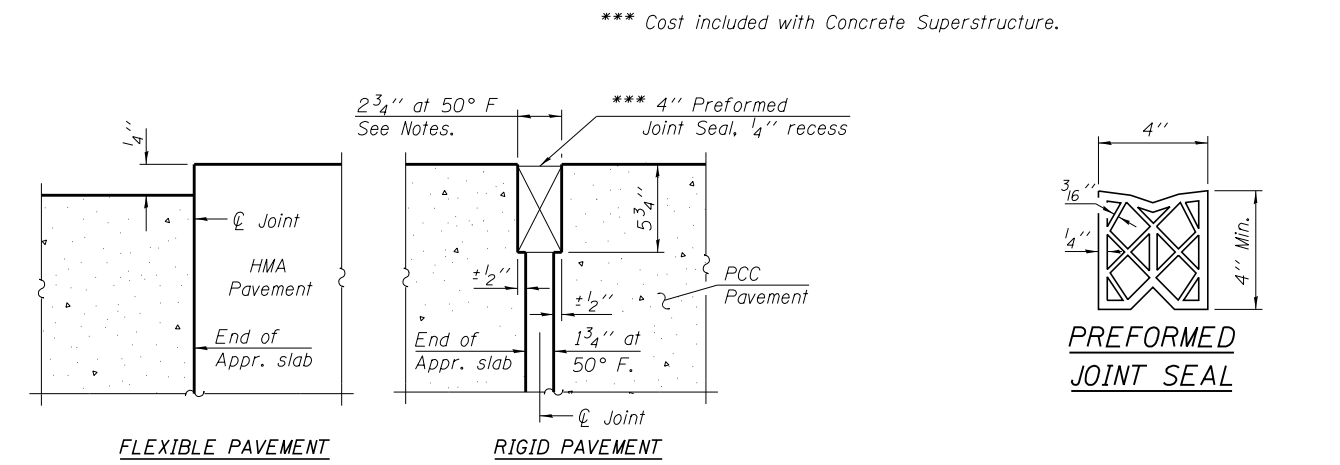

DETAIL A

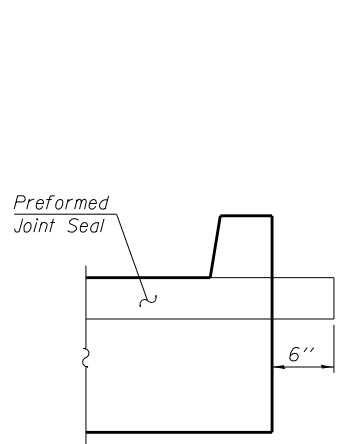
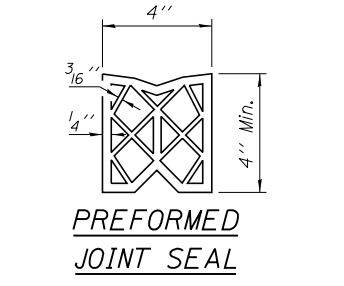

VIEW F-F

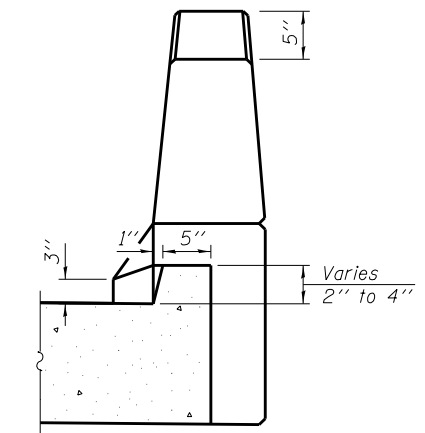

VIEW B-B

BA-0 12-12-12

(Sheet 1 of 2)

FILE NAME = \$FILE\$	USER NAME =	DESIGNED - T.J.A.	REVISED -	STATE OF ILLINOIS DEPARTMENT OF TRANSPORTATION	BRIDGE APPROACH SLAB DETAILS STRUCTURE NO. 097-0079	FAP	SECTION	COUNTY	TOTAL SHEETS	SHEET NO.	
HAMPTON, LENZINI AND RENWICK, INC. 3085 STEVENSON DRIVE, SUITE 201 SPRINGFIELD, ILLINOIS 62703 ILLINOIS PROFESSIONAL DESIGN FIRM LS / PE / SE CORP. 184.000959		CHECKED - S.M.S.	REVISED -			332	5B-1	WHITE	51	32	
	PLOT SCALE =	DRAWN - D.A.B.	REVISED -			IL RTE 1/14 OVER CROOKED CR. CONTRACT NO. 78266					
	PLOT DATE = 9/17/2013	CHECKED - M.D.C.	REVISED -			SHEET NO. 8 OF 15 SHEETS ILLINOIS FED. AID PROJECT					