

14 - #4 d(E) BARS AT 18" CTS

ELEVATION

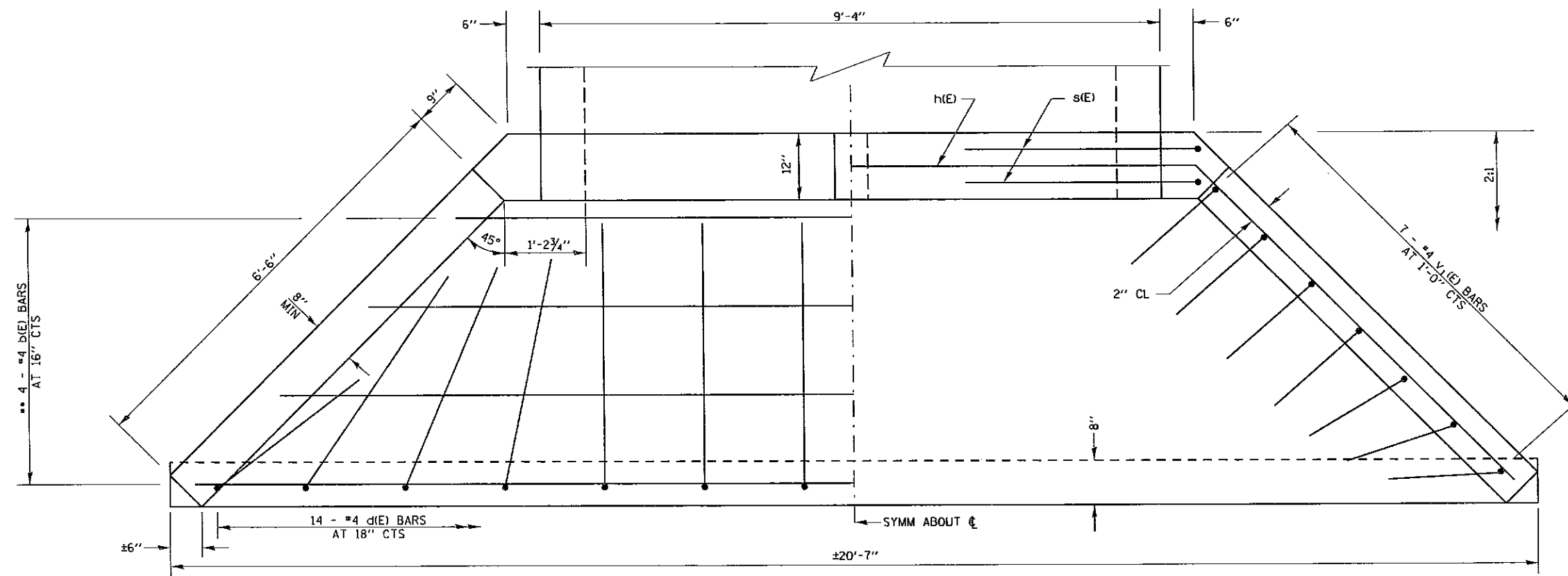

PLAN

• CUT OR BEND TO FIT
 ** LAP BARS WHERE NECESSARY
 MIN BAR LAP
 #4 1'-8"
 WORK THIS SHEET WITH
 SHEET 9 OF 10

FILE NAME =	USER NAME = wolkerra	DESIGNED -	REVISED -	STATE OF ILLINOIS DEPARTMENT OF TRANSPORTATION	PROPOSED CAST-IN-PLACE APRON END SECTION (SN 077-7060)	F.A.S. RTE.	SECTION	COUNTY	TOTAL SHEETS	SHEET NO.	
ci:\pw\work\p10\dot\wolkerra\0334982\78354-077-design.dgn	PLOT SCALE = 2.0000' / 1"	DRAWN -	REVISED -			2936	14A(B-11)	PULASKI	10	10	
Default	PLOT DATE = 9/5/2013	CHECKED -	REVISED -			CONTRACT NO. 78354					
		DATE -	REVISED -			ILLINOIS FED. AID PROJECT					