

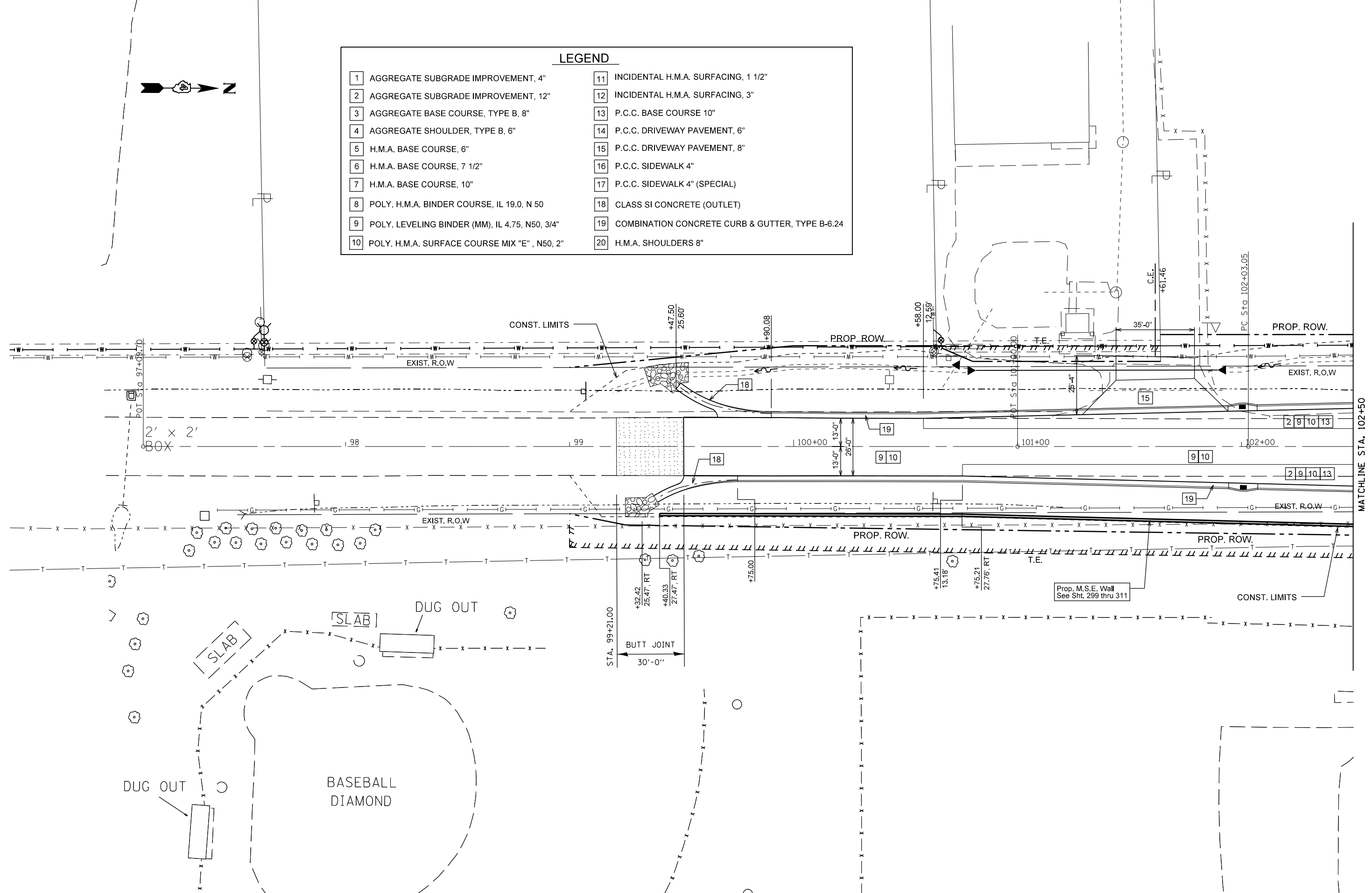

LEGEND	
1	AGGREGATE SUBGRADE IMPROVEMENT, 4"
2	AGGREGATE SUBGRADE IMPROVEMENT, 12"
3	AGGREGATE BASE COURSE, TYPE B, 8"
4	AGGREGATE SHOULDER, TYPE B, 6"
5	H.M.A. BASE COURSE, 6"
6	H.M.A. BASE COURSE, 7 1/2"
7	H.M.A. BASE COURSE, 10"
8	POLY. H.M.A. BINDER COURSE, IL 19.0, N 50
9	POLY. LEVELING BINDER (MM), IL 4.75, N50, 3/4"
10	POLY. H.M.A. SURFACE COURSE MIX "E", N50, 2"
11	INCIDENTAL H.M.A. SURFACING, 1 1/2"
12	INCIDENTAL H.M.A. SURFACING, 3"
13	P.C.C. BASE COURSE 10"
14	P.C.C. DRIVEWAY PAVEMENT, 6"
15	P.C.C. DRIVEWAY PAVEMENT, 8"
16	P.C.C. SIDEWALK 4"
17	P.C.C. SIDEWALK 4" (SPECIAL)
18	CLASS SI CONCRETE (OUTLET)
19	COMBINATION CONCRETE CURB & GUTTER, TYPE B-6.24
20	H.M.A. SHOULDERS 8"



MATCHLINE STA. 102+50

FILE NAME =	USER NAME = crespole	DESIGNED -	REVISED -
c:\pw\work\p\idot\crespole\d0330150\048792-sht-proposed.dgn		DRAWN -	REVISED -
PLOT SCALE = 40.0000' / in.		CHECKED -	REVISED -
PLOT DATE = 8/16/2013		DATE -	REVISED -

**STATE OF ILLINOIS
DEPARTMENT OF TRANSPORTATION**

**IL RTE 91
PROPOSED PLANS**

SCALE: SHEET NO. OF SHEETS STA. TO STA.

F.A.S. RTE.	SECTION	COUNTY	TOTAL SHEETS	SHEET NO.
1380	7W-1,RS-3	Peoria	617	81
CONTRACT NO. 88792				
ILLINOIS FED. AID PROJECT				