

ALL EXISTING UTILITIES LOCATIONS AND DEPTHS TO BE VERIFIED PRIOR TO ALL DRILLING AND BORES.

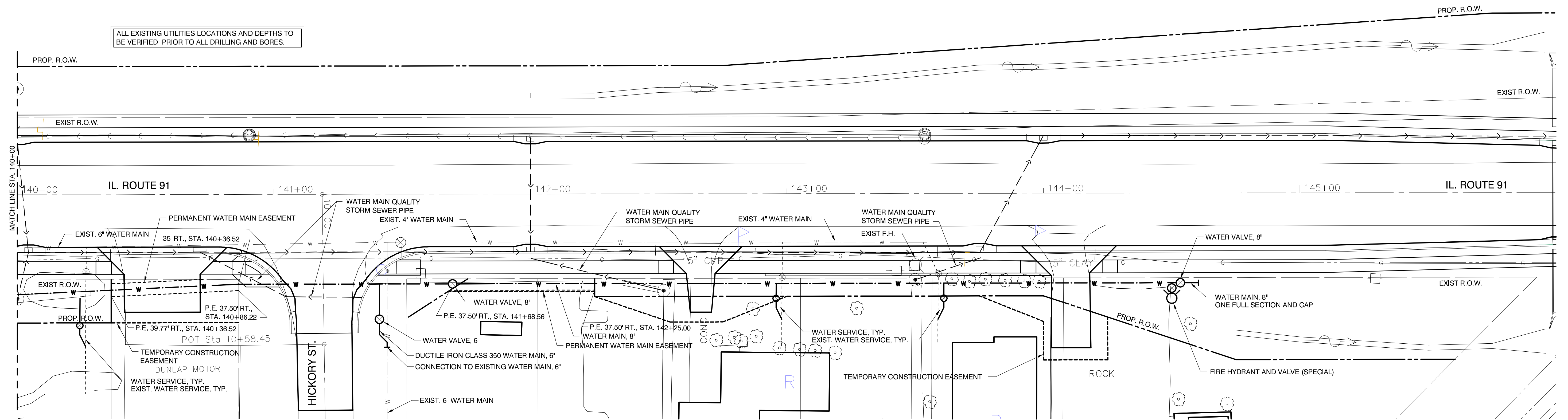

PLAN VIEW

SCALES: 1" = 20' HOR

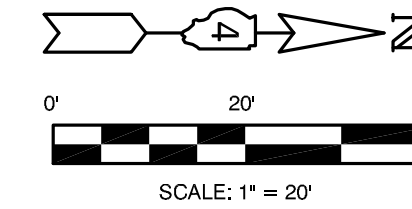

FIRE HYDRANTS TO BE REMOVED

LOCATION	QUANTITY
RT. STA. 143+50	1 EA.
SHEET TOTAL	1 EA.

WATER MAIN TEE 8"x6"

LOCATION	QUANTITY
RT. STA. 141+41	1 EA.
RT. STA. 144+50	1 EA.
SHEET TOTAL	2 EA.

CONNECTION TO EXISTING WATER MAIN, 6"

LOCATION	QUANTITY
HICKORY ST. 6"	1 EA.
SHEET TOTAL	1 EA.

REMOVE EXISTING WATER VALVE

LOCATION	QUANTITY
RT. STA. 141+50	1 EA.
SHEET TOTAL	1 EA.

WATER SERVICE CONNECTION

LOCATION	QUANTITY
RT. STA. 140+26	1 EA.
RT. STA. 142+97	1 EA.
RT. STA. 143+59	1 EA.
SHEET TOTALS	3 EA.

FIRE HYDRANT AND VALVE (SPECIAL)

LOCATION	QUANTITY
41' RT. STA. 144+50	1 EA.
SHEET TOTAL	1 EA.

WATER VALVES, 6"

LOCATION	QUANTITY
49' RT. STA. 141+41	1 EA.
SHEET TOTAL	1 EA.

WATER VALVES, 8"

LOCATION	QUANTITY
RT. STA. 141+69	1 EA.
RT. STA. 144+53	1 EA.
SHEET TOTALS	2 EA.

DUCTILE IRON WATER MAIN, 6"

LOCATION	LENGTH
RT. STA. 141+44	26 FT.
SHEET TOTAL	26 FT.

WATER MAIN, 8"

LOCATION	LENGTH
RT. STA. 140+00 TO STA. 144+60	460 FT.
SHEET TOTAL	460 FT.

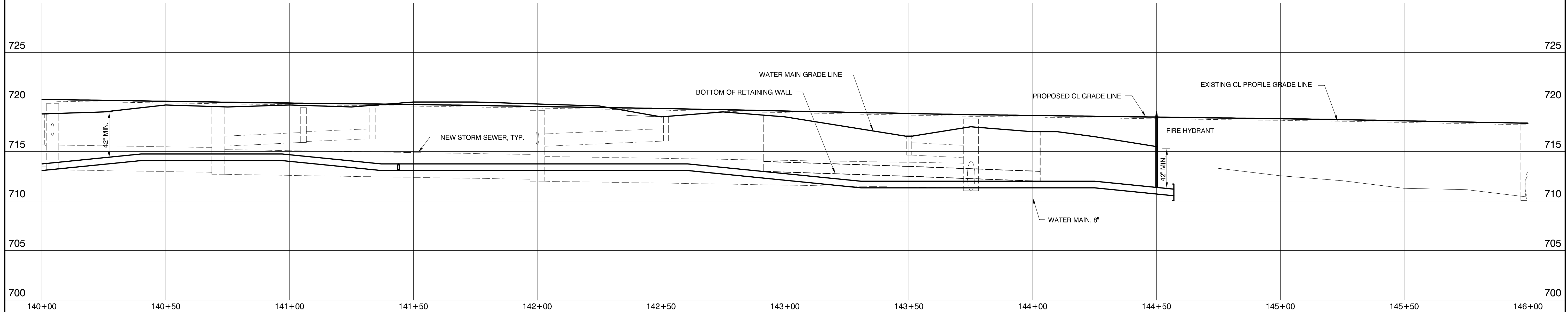

PROFILE VIEW

SCALES: 1" = 20' HOR
1" = 5' VER

M MOHR & KERR ENGINEERING & LAND SURVEYING, P.C.
7336 N. University Ave. Office: (309) 692-8500
Peoria, Illinois 61614 Fax: (309) 692-8501
www.mohrandkerr.com Professional Design Firm #184.005091

DESIGNED	WFS	REVISED
DRAWN	DEH	REVISED
CHECKED	WFS	REVISED
DATE	08-30-13	REVISED

STATE OF ILLINOIS
DEPARTMENT OF TRANSPORTATION

IL RTE 91
WATER MAIN PLANS
PLAN AND PROFILE SHEET
SCALE: 1" = 20' SHEET NO. 14 OF 17 SHEETS STA. 140+00 TO STA. 146+00

F.A. ROUTE	SECTION	COUNTY	TOTAL SHEETS	SHEET NO.
1380	7W-1, RS-3	PEORIA	617	268
CONTRACT NO. 88792				
ILLINOIS FEDERAL ROAD DIST NO.				