

TBM C-2 Chisled "□" top concrete post (4" x 6"), 2.5' high,
S.E. intersection of IL 91 and Legion Hall Road. Elev. = 730.02

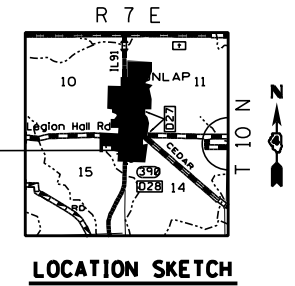
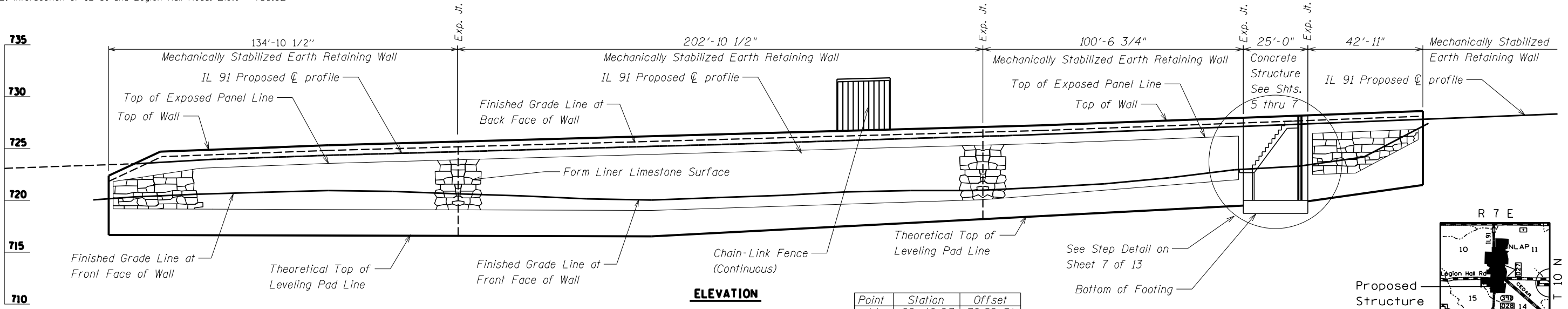

Point	Station	Offset
A1	99+40.23	30.89 Rt.
A2	100+75.00	31.18 Rt.
A3	102+77.71	36.41 Rt.
A4	103+80.13	43.69 Rt.
A5	103+83.34	49.10 Rt.
A6	104+02.11	50.46 Rt.
A7	104+02.48	45.31 Rt.
A8	104+04.98	45.49 Rt.
A9	104+47.80	48.61 Rt.

WALL CONTROL POINTS

Wall offsets are measured from Q IL 91 to the front face of precast panels

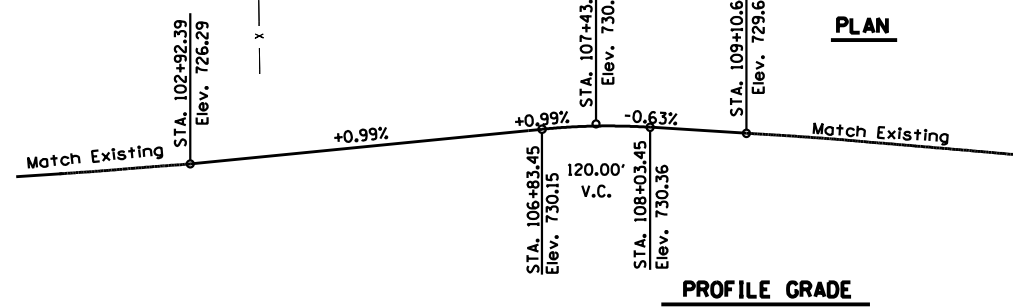
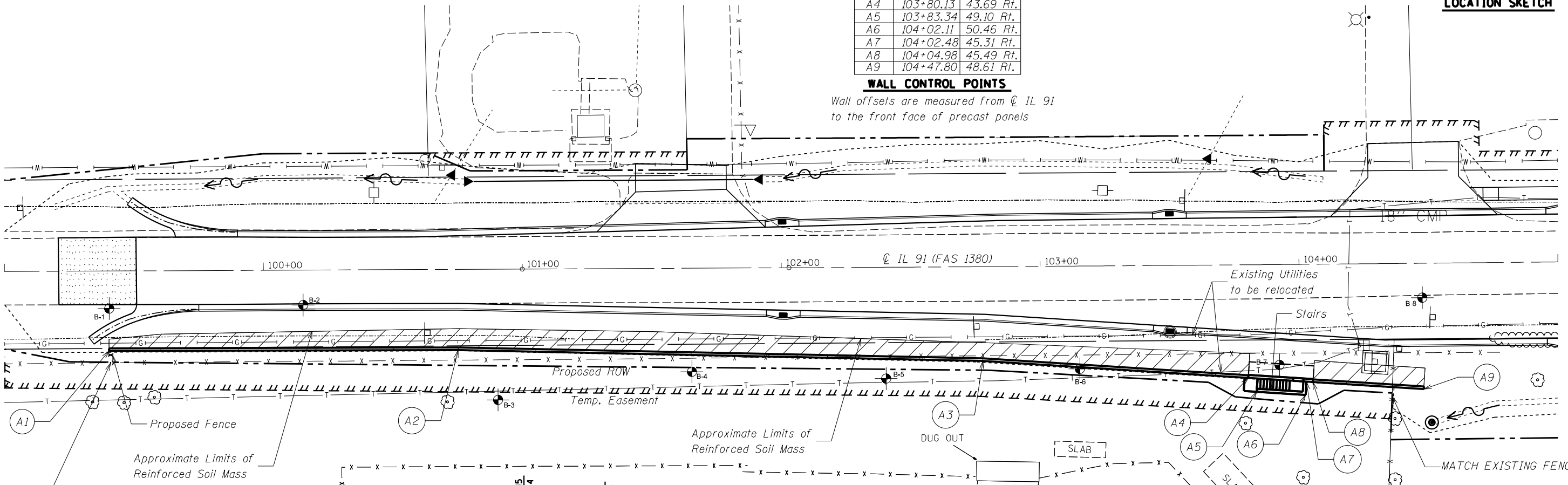

DESIGN STRESSES

FIELD UNITS
 $f'c = 3,500$ psi
 $f_y = 60,000$ psi (Reinforcement)
PRECAST UNITS
 $f'c = 4,500$ psi (Precast Panels)

DESIGN SPECIFICATIONS

2007 AASHTO LRFD Bridge Design Specifications with 2008 and 2009 Interims

GENERAL PLAN & ELEVATION
DUNLAP HIGH SCHOOL RETAINING WALL
F.A.S 1380 - SEC 7W-1, RS-3
PEORIA COUNTY
STATION 99+40.23 TO 104+47.80

FILE NAME =	USER NAME = lababidism	DESIGNED -	REVISED -	STATE OF ILLINOIS DEPARTMENT OF TRANSPORTATION	GENERAL PLAN AND ELEVATION M.S.E. WALL PLANS		F.A.S. RTE. = 1380	SECTION = 7W-1,RS-3	COUNTY = Peoria	TOTAL SHEETS = 617	SHEET NO. = 299	
Default	et:\pw_work\pwidot\lababidism\d0330150\0488792-sht-details.dgn	DRAWN -	REVISED -		SCALE:	SHEET 1 OF 13 SHEETS	STA. TO STA.	ILLINOIS FED. AID PROJECT		CONTRACT NO. 88792		
	PLOT SCALE = 40.0000' / in.	CHECKED -	REVISED -									
	PLOT DATE = 9/6/2013	DATE -	REVISED -									