

| | |
|---------------|--|
| DATE | |
| BY | |
| SURVEYED | |
| PLOTTED | |
| TEMPLATE | |
| NOTE BOOK | |
| AREAS CHECKED | |
| NO. | |

| | |
|---------------|--|
| DATE | |
| BY | |
| SURVEYED | |
| PLOTTED | |
| TEMPLATE | |
| NOTE BOOK | |
| AREAS CHECKED | |
| NO. | |

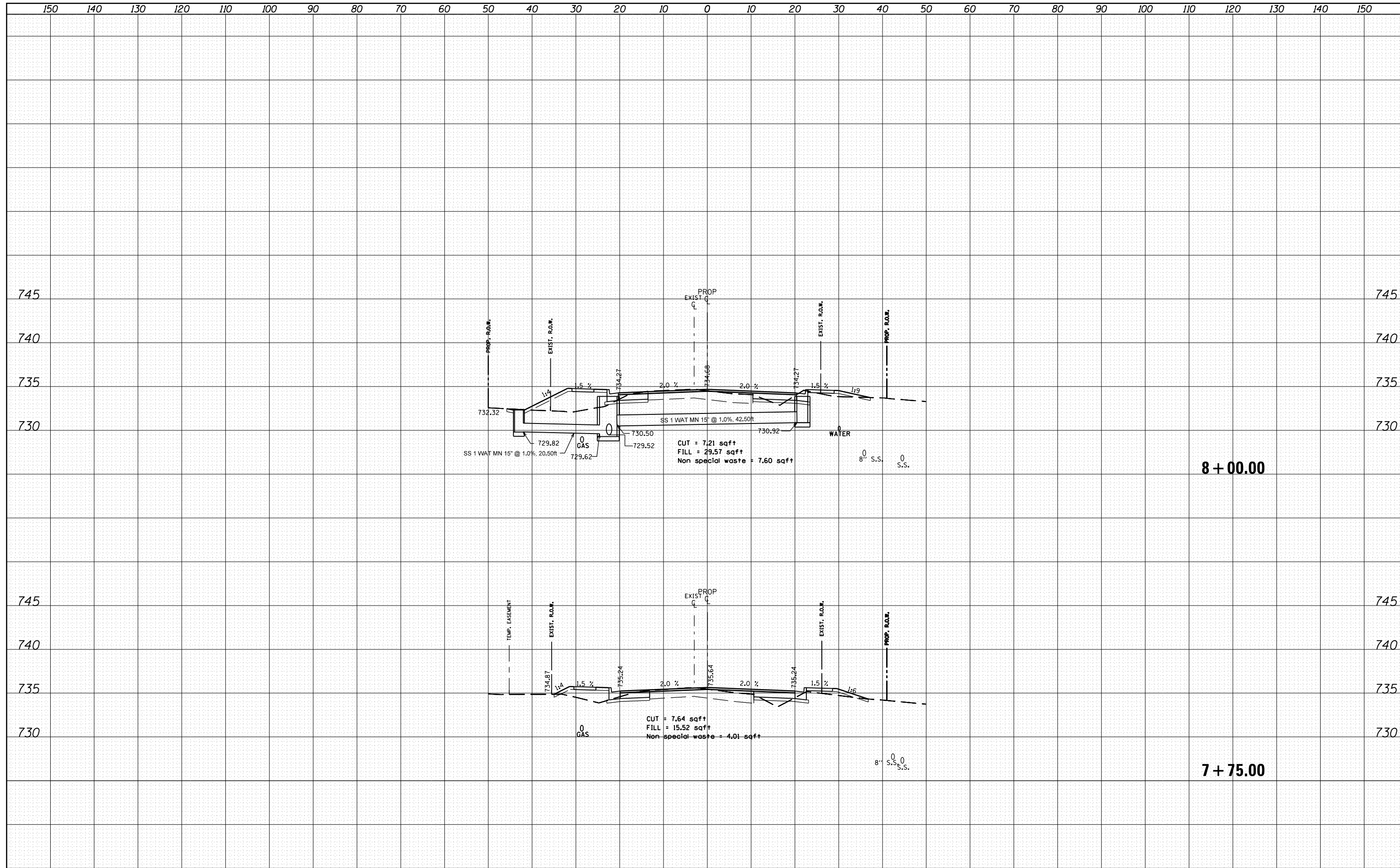

| | | | | | | | | | | | | |
|---|-----------------------------|------------|-----------|---|---|--|--|--------------------|-----------|--------|--------------|-----------|
| FILE NAME = | USER NAME = crespole | DESIGNED - | REVISED - | STATE OF ILLINOIS DEPARTMENT OF TRANSPORTATION | LEGION HALL ROAD CROSS SECTION | | | F.A.S. RTE. | SECTION | COUNTY | TOTAL SHEETS | SHEET NO. |
| c:\pw\work\pwidot\crespole\10330150\10488792-sh | -LHR-XS.dgn | DRAWN - | REVISED - | | | | | 1380 | 7W-1,RS-3 | Peoria | 617 | 521 |
| Default | PLOT SCALE = 20.0000' / in. | CHECKED - | REVISED - | | SCALE: SHEET OF SHEETS STA. 7+75.00 TO STA. 8+00.00 | | | CONTRACT NO. 88792 | | | | |
| | PLOT DATE = 8/15/2013 | DATE - | REVISED - | | ILLINOIS FED. AID PROJECT | | | | | | | |