

DATE	
BY	
SURVEYED	
PLOTTED	
TEMPLATE	
AREAS	
CHECKED	
FINAL SURVEY	
NOTE BOOK	
NO.	

DATE	
BY	
SURVEYED	
PLOTTED	
TEMPLATE	
AREAS	
CHECKED	
ORIGINAL SURVEY	
NOTE BOOK	
NO.	

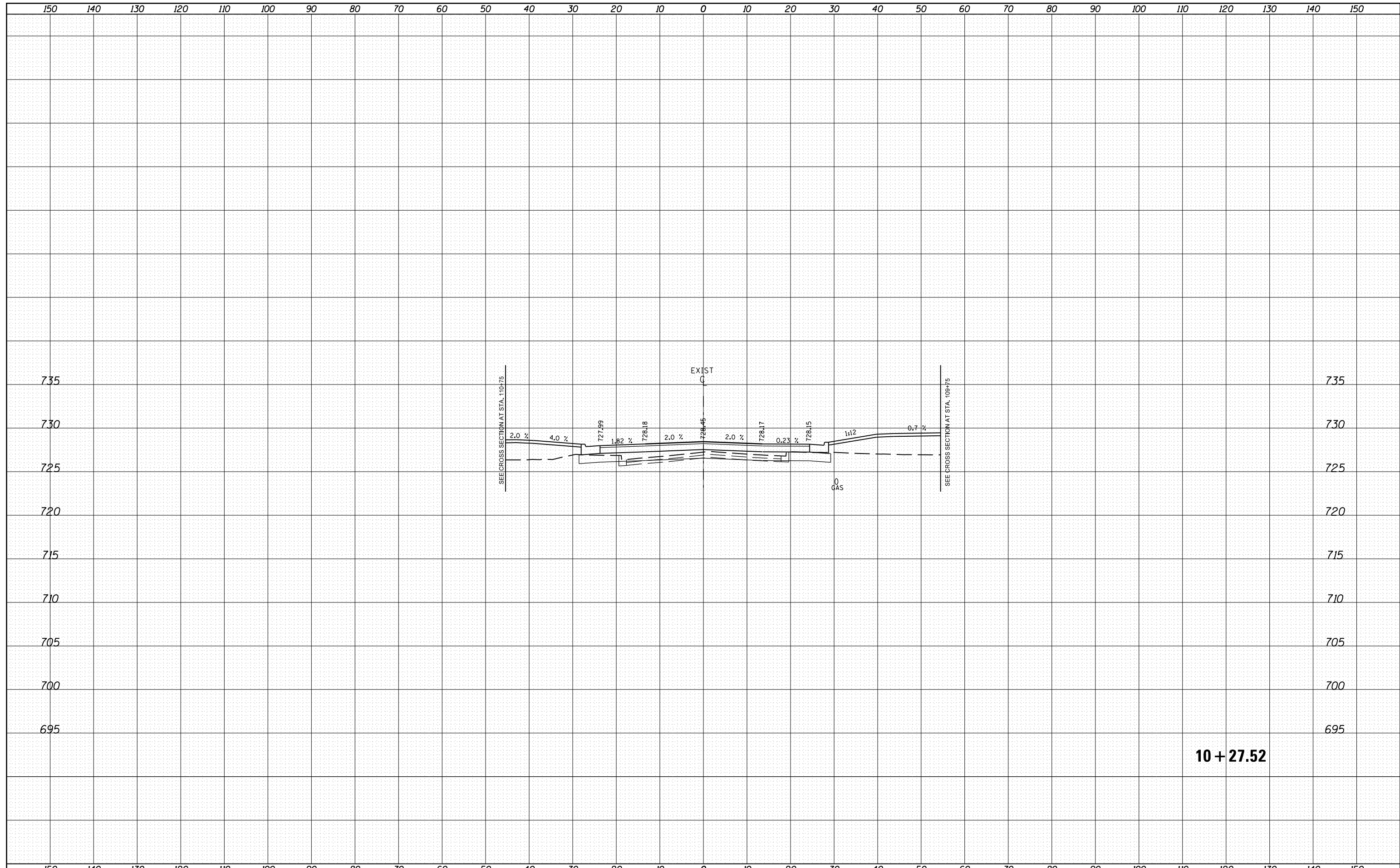

**10 + 27.52**

FILE NAME =	USER NAME = crespole	DESIGNED -	REVISED -	<b>STATE OF ILLINOIS DEPARTMENT OF TRANSPORTATION</b>	<b>S. CASTLE DRIVE CROSS SECTIONS</b>		F.A.S. RTE.	SECTION	COUNTY	TOTAL SHEETS	SHEET NO.
c:\pw_work\pwidot\crespole\10330150\10488792-sh	xsxssideroad.dgn	DRAWN -	REVISED -				1380	7W-1,RS-3	Peoria	617	552
Default	PLOT SCALE = 20.0000' / in.	CHECKED -	REVISED -				CONTRACT NO. 88792				
	PLOT DATE = 8/16/2013	DATE -	REVISED -				ILLINOIS FED. AID PROJECT				
				SCALE:	SHEET	OF	SHEETS	STA. 10+27.52	TO	STA. 10+27.52	