

**THE CITY OF PERU, ILLINOIS
ILLINOIS VALLEY REGIONAL AIRPORT
WALTER DUNCAN FIELD
CONSTRUCTION PLANS
FOR
REHABILITATE GENERAL AVIATION APRON
ILLINOIS PROJECT NO. VYS-4191
STATE BLOCK GRANT No. 3-17-0060-B22
LATITUDE: N 41°21'01", LONGITUDE: W 89°09'11"
ELEVATION 653.28
DATE: NOVEMBER, 2013
RUNWAY 18/36 (EXISTING) CATEGORY B, GROUP II
RUNWAY 7/25 (EXISTING) CATEGORY B, GROUP II**

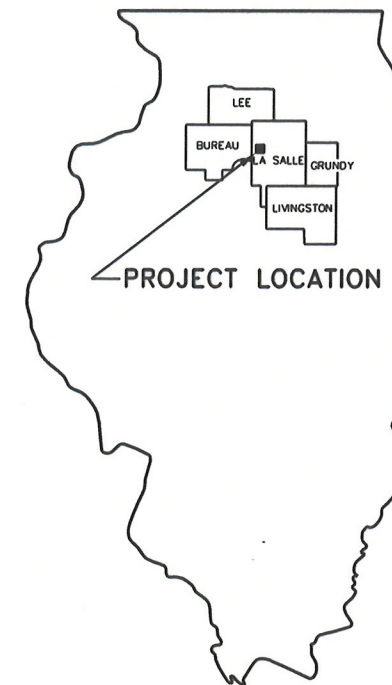

INDEX OF SHEETS

PAGE NO.	DESCRIPTION
1	COVER SHEET & SUMMARY OF QUANTITIES
2	PROPOSED IMPROVEMENT AND SAFETY PLAN
3	DIMENSIONAL LAYOUT PLAN & PAVEMENT MARKING PLAN
4	GRADING, DRAINAGE, AND EROSION CONTROL PLAN
5	PAVING PLAN

BENCHMARKS:

- BM #184 WORD MUE ON TOP OF FIRE HYDRANT @ SOUTH EAST CORNER OF AIRPORT OFFICE. ELEV. = 652.64
- BM "AA" TOP OF 1" CAPPED PIPE 4' IN GROUND. STA. 246+02, 260' LT. ELEV. = 647.72
- BM "BB" TOP OF 1" CAPPED PIPE 4' IN GROUND. STA. 237+85, 229' LT. ELEV. = 646.57
- BM "C" SPIKE NAIL SET IN 6" WOOD FENCE POST SOUTH OF RUNWAY. STA. 220+13, 339' RT. ELEV. = 644.27

SUMMARY OF QUANTITIES

ITEM	DESCRIPTION	UNIT	QUANTITY
AR152410	UNCLASSIFIED EXCAVATION	C.Y.	1250
AR209606	CRUSHED AGG. BASE COURSE - 6"	S.Y.	5630
AR401900	REMOVE BITUMINOUS PAVEMENT	S.Y.	115
AR501508	8" PCC PAVEMENT	S.Y.	5570
AR501530	PCC TEST BATCH	EACH	1
AR501604	4" PCC SIDEWALK	SF	90
AR501690	PCC SIDEWALK REMOVAL	SF	90
AR501906	6" PCC PAVEMENT REMOVAL	S.Y.	5455
AR510510	TIE DOWN	EACH	9
AR510515	GROUND ROD	EACH	2
AR620520	PAVEMENT MARKING - WATERBORNE	S.F.	925
AR705526	6" PERFORATED UNDERDRAIN W/ SOCK	L.F.	750
AR705640	UNDERDRAIN CLEANOUT	EACH	4

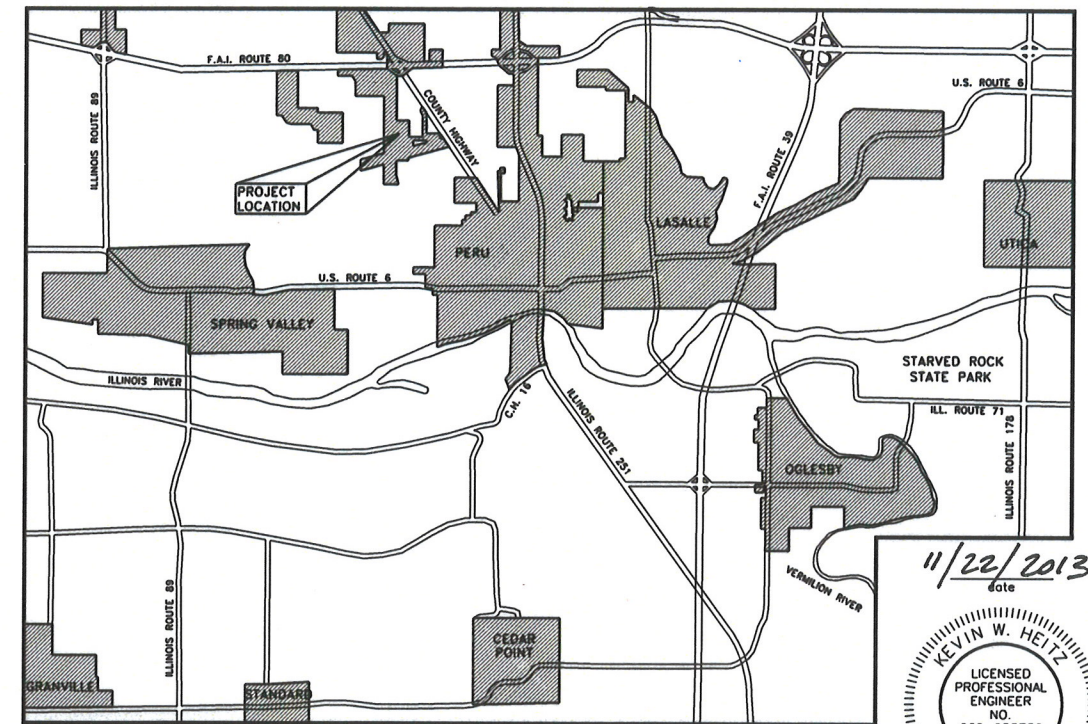

LOCATION MAP



11/22/2013
date



Kevin W. Heitz
signature

PROFESSIONAL DESIGN FIRM
LICENSE NO. 184-001717

PLANS PREPARED BY:
CHAMLIN ASSOCIATES
PERU ILLINOIS MORRIS
SUBMITTED BY: *Kevin W. Heitz* ENG'R
DATE: *November 22, 2013*

CITY OF PERU, ILLINOIS
APPROVED BY: *[Signature]* MAYOR
DATE: *12/10/2013*
APPROVED BY: *[Signature]* CITY CLERK
DATE: *12-6-13*

UTILITY SERVICE	CONTACT	TELEPHONE #
WATER	CITY OF PERU WATER DEPARTMENT SEAN MIKOS	(815) 223-8615
ELECTRICAL POWER	CITY OF PERU ELECTRIC DEPARTMENT JIM POTTHOFF	(815) 223-0044
NATURAL GAS	J.U.L.I.E.	(800) 892-0123
PIPELINE	J.U.L.I.E.	(800) 892-0123
TELEPHONE	J.U.L.I.E.	(800) 892-0123
CABLE	J.U.L.I.E.	(800) 892-0123
SANITARY SEWER	CITY OF PERU SEWER DEPARTMENT SEAN MIKOS	(815) 223-1148



NOTE:
ALL EXCESS MATERIALS SHALL BE HAULED OFF-SITE TO A LOCATION APPROVED BY THE ENGINEER.

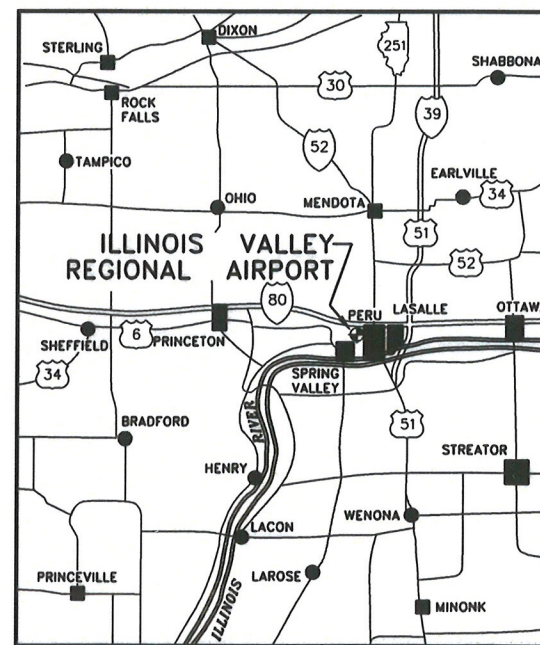

VICINITY MAP

DESCRIPTION
ILLINOIS VALLEY REGIONAL AIRPORT
TOWNSHIP 33 N., SECTION 7, RANGE 1 E.
LA SALLE COUNTY, PERU TOWNSHIP



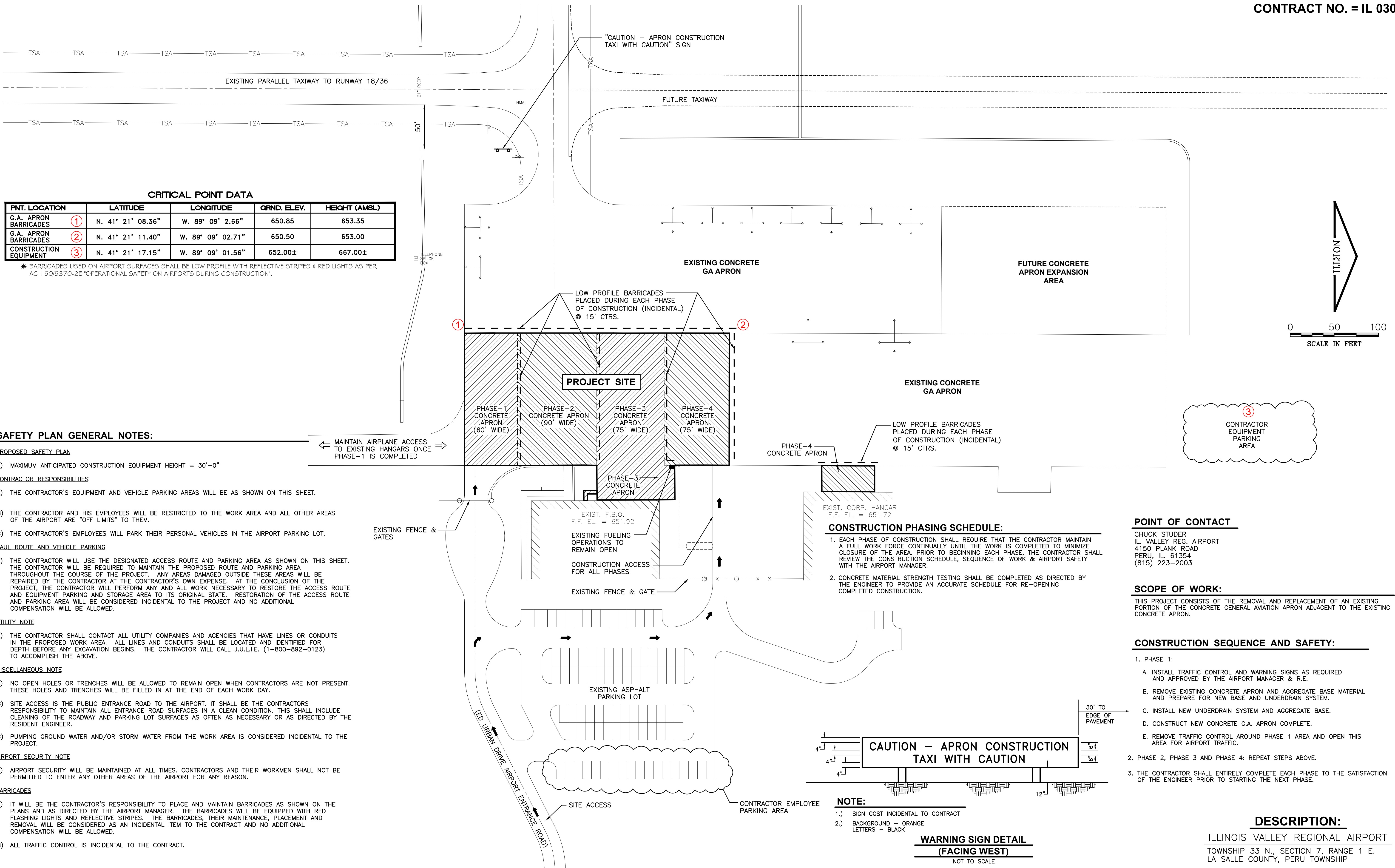

CRITICAL POINT DATA

PNT. LOCATION	LATITUDE	LONGITUDE	GRND. ELEV.	HEIGHT (AMSL)
G.A. APRON BARRICADES ①	N. 41° 21' 08.36"	W. 89° 09' 2.66"	650.85	653.35
G.A. APRON BARRICADES ②	N. 41° 21' 11.40"	W. 89° 09' 02.71"	650.50	653.00
CONSTRUCTION EQUIPMENT ③	N. 41° 21' 17.15"	W. 89° 09' 01.56"	652.00±	667.00±

* BARRICADES USED ON AIRPORT SURFACES SHALL BE LOW PROFILE WITH REFLECTIVE STRIPES & RED LIGHTS AS PER AC 150/5370-2E "OPERATIONAL SAFETY ON AIRPORTS DURING CONSTRUCTION".

SAFETY PLAN GENERAL NOTES:

PROPOSED SAFETY PLAN

A) MAXIMUM ANTICIPATED CONSTRUCTION EQUIPMENT HEIGHT = 30'-0"

CONTRACTOR RESPONSIBILITIES

- A) THE CONTRACTOR'S EQUIPMENT AND VEHICLE PARKING AREAS WILL BE AS SHOWN ON THIS SHEET.
- B) THE CONTRACTOR AND HIS EMPLOYEES WILL BE RESTRICTED TO THE WORK AREA AND ALL OTHER AREAS OF THE AIRPORT ARE "OFF LIMITS" TO THEM.
- C) THE CONTRACTOR'S EMPLOYEES WILL PARK THEIR PERSONAL VEHICLES IN THE AIRPORT PARKING LOT.

HAUL ROUTE AND VEHICLE PARKING

A) THE CONTRACTOR WILL USE THE DESIGNATED ACCESS ROUTE AND PARKING AREA AS SHOWN ON THIS SHEET. THE CONTRACTOR WILL BE REQUIRED TO MAINTAIN THE PROPOSED ROUTE AND PARKING AREA THROUGHOUT THE COURSE OF THE PROJECT. ANY AREAS DAMAGED OUTSIDE THESE AREAS WILL BE REPAIRED BY THE CONTRACTOR AT THE CONTRACTOR'S OWN EXPENSE. AT THE CONCLUSION OF THE PROJECT, THE CONTRACTOR WILL PERFORM ANY AND ALL WORK NECESSARY TO RESTORE THE ACCESS ROUTE AND EQUIPMENT PARKING AND STORAGE AREA TO ITS ORIGINAL STATE. RESTORATION OF THE ACCESS ROUTE AND PARKING AREA WILL BE CONSIDERED INCIDENTAL TO THE PROJECT AND NO ADDITIONAL COMPENSATION WILL BE ALLOWED.

UTILITY NOTE

A) THE CONTRACTOR SHALL CONTACT ALL UTILITY COMPANIES AND AGENCIES THAT HAVE LINES OR CONDUITS IN THE PROPOSED WORK AREA. ALL LINES AND CONDUITS SHALL BE LOCATED AND IDENTIFIED FOR DEPTH BEFORE ANY EXCAVATION BEGINS. THE CONTRACTOR WILL CALL J.U.L.I.E. (1-800-892-0123) TO ACCOMPLISH THE ABOVE.

MISCELLANEOUS NOTE

- A) NO OPEN HOLES OR TRENCHES WILL BE ALLOWED TO REMAIN OPEN WHEN CONTRACTORS ARE NOT PRESENT. THESE HOLES AND TRENCHES WILL BE FILLED IN AT THE END OF EACH WORK DAY.
- B) SITE ACCESS IS THE PUBLIC ENTRANCE ROAD TO THE AIRPORT. IT SHALL BE THE CONTRACTORS RESPONSIBILITY TO MAINTAIN ALL ENTRANCE ROAD SURFACES IN A CLEAN CONDITION. THIS SHALL INCLUDE CLEANING OF THE ROADWAY AND PARKING LOT SURFACES AS OFTEN AS NECESSARY OR AS DIRECTED BY THE RESIDENT ENGINEER.
- C) PUMPING GROUND WATER AND/OR STORM WATER FROM THE WORK AREA IS CONSIDERED INCIDENTAL TO THE PROJECT.

AIRPORT SECURITY NOTE

A) AIRPORT SECURITY WILL BE MAINTAINED AT ALL TIMES. CONTRACTORS AND THEIR WORKMEN SHALL NOT BE PERMITTED TO ENTER ANY OTHER AREAS OF THE AIRPORT FOR ANY REASON.

BARRICADES

- A) IT WILL BE THE CONTRACTOR'S RESPONSIBILITY TO PLACE AND MAINTAIN BARRICADES AS SHOWN ON THE PLANS AND AS DIRECTED BY THE AIRPORT MANAGER. THE BARRICADES WILL BE EQUIPPED WITH RED FLASHING LIGHTS AND REFLECTIVE STRIPES. THE BARRICADES, THEIR MAINTENANCE, PLACEMENT AND REMOVAL WILL BE CONSIDERED AS AN INCIDENTAL ITEM TO THE CONTRACT AND NO ADDITIONAL COMPENSATION WILL BE ALLOWED.
- B) ALL TRAFFIC CONTROL IS INCIDENTAL TO THE CONTRACT.

← MAINTAIN AIRPLANE ACCESS TO EXISTING HANGARS ONCE PHASE-1 IS COMPLETED →

POINT OF CONTACT

CHUCK STUDER
 IL VALLEY REG. AIRPORT
 4150 PLANK ROAD
 PERU, IL 61354
 (815) 223-2003

SCOPE OF WORK:

THIS PROJECT CONSISTS OF THE REMOVAL AND REPLACEMENT OF AN EXISTING PORTION OF THE CONCRETE GENERAL AVIATION APRON ADJACENT TO THE EXISTING CONCRETE APRON.

CONSTRUCTION SEQUENCE AND SAFETY:

1. PHASE 1:
 - A. INSTALL TRAFFIC CONTROL AND WARNING SIGNS AS REQUIRED AND APPROVED BY THE AIRPORT MANAGER & R.E.
 - B. REMOVE EXISTING CONCRETE APRON AND AGGREGATE BASE MATERIAL AND PREPARE FOR NEW BASE AND UNDERDRAIN SYSTEM.
 - C. INSTALL NEW UNDERDRAIN SYSTEM AND AGGREGATE BASE.
 - D. CONSTRUCT NEW CONCRETE G.A. APRON COMPLETE.
 - E. REMOVE TRAFFIC CONTROL AROUND PHASE 1 AREA AND OPEN THIS AREA FOR AIRPORT TRAFFIC.
2. PHASE 2, PHASE 3 AND PHASE 4: REPEAT STEPS ABOVE.
3. THE CONTRACTOR SHALL ENTIRELY COMPLETE EACH PHASE TO THE SATISFACTION OF THE ENGINEER PRIOR TO STARTING THE NEXT PHASE.

DESCRIPTION:

ILLINOIS VALLEY REGIONAL AIRPORT
 TOWNSHIP 33 N., SECTION 7, RANGE 1 E.
 LA SALLE COUNTY, PERU TOWNSHIP

CHAMLIN & ASSOCIATES, INC. © 2011
 Drawing Name: G:\Users\N1102-00-Peru\04-Apron-Retain\040\Final Plans - 100%_02-SAFETY.dwg Last Modified: Nov 22, 2013 11:11am Plotted on: Nov 22, 2013 11:11am Plotted by: tmh

DRAWN BY: TIM H	REVISIONS			
	LEVEL	BY	DATE	DESCRIPTION
CHECKED BY: KWH				
DATE: 11/13				

CHAMLIN ASSOCIATES
 PERU MORRIS ILLINOIS

ILLINOIS VALLEY REGIONAL AIRPORT
 ILLINOIS PROJECT NO. VYS-4191
 STATE BLOCK GRANT No. 3-17-0060-B22

PROPOSED IMPROVEMENT AND SAFETY PLAN

CONSTRUCTION PLANS
 CURRENT AS OF: 11/13
 SCALE: AS NOTED SHEET 2
 FILE NO.: 1102.00 Y- OF 5

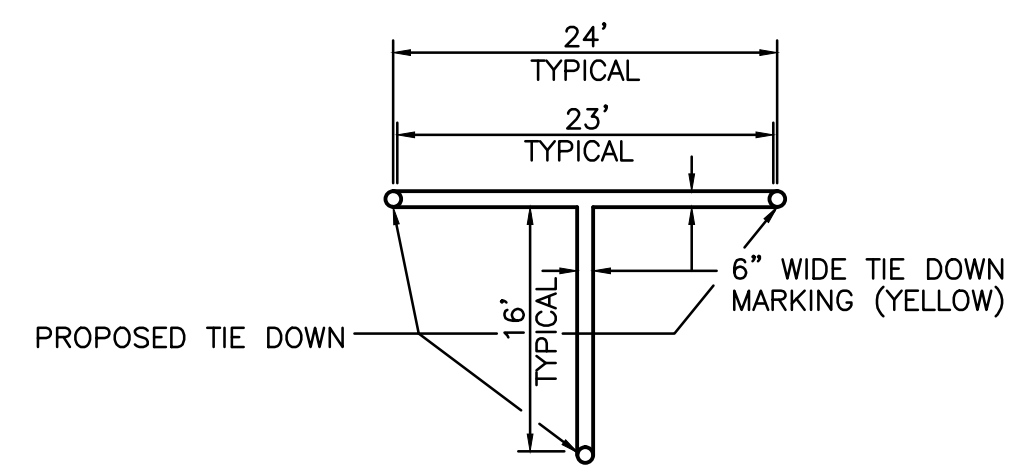
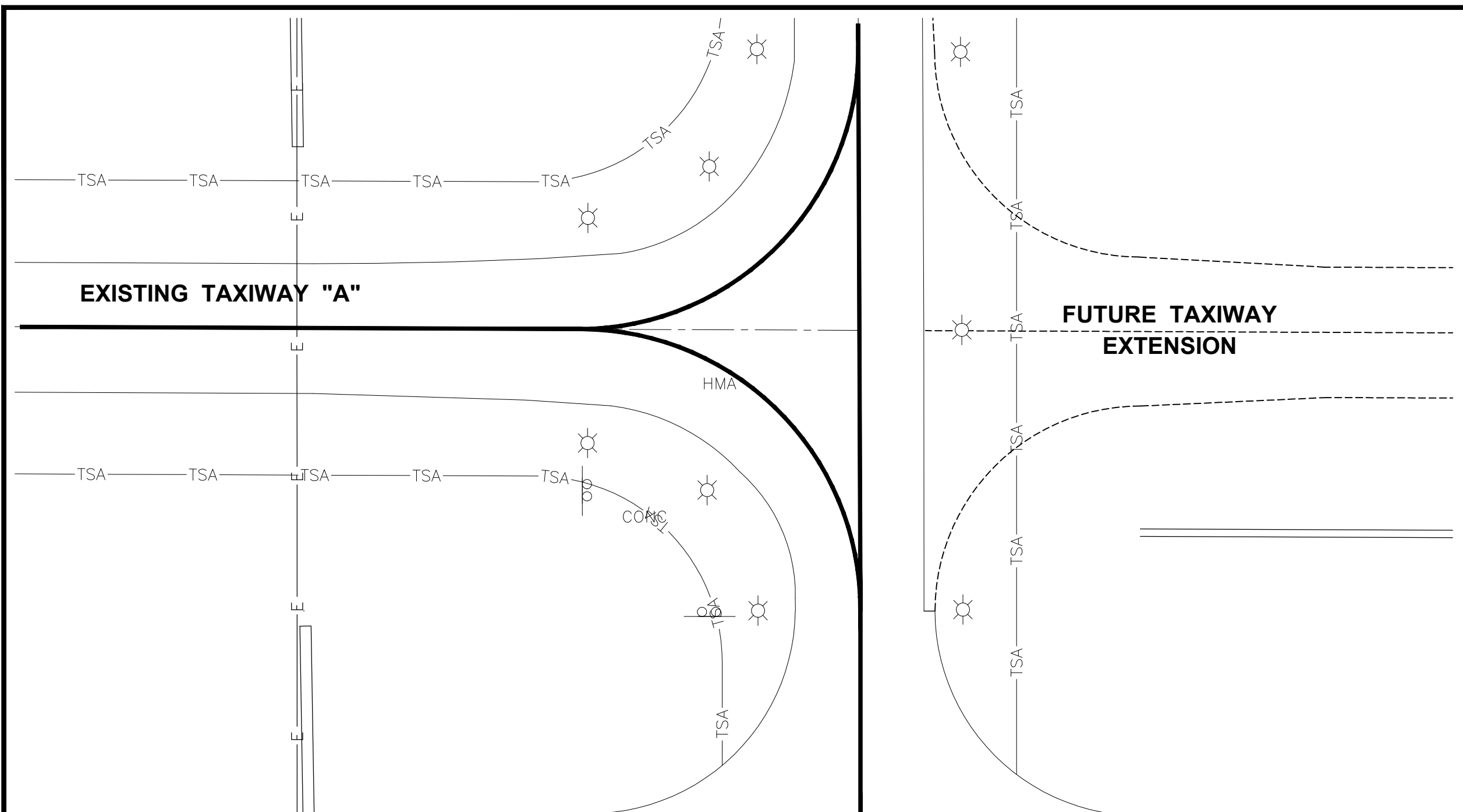
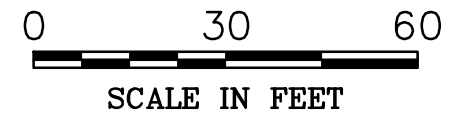

TIE DOWN "A" DETAIL
N.T.S.

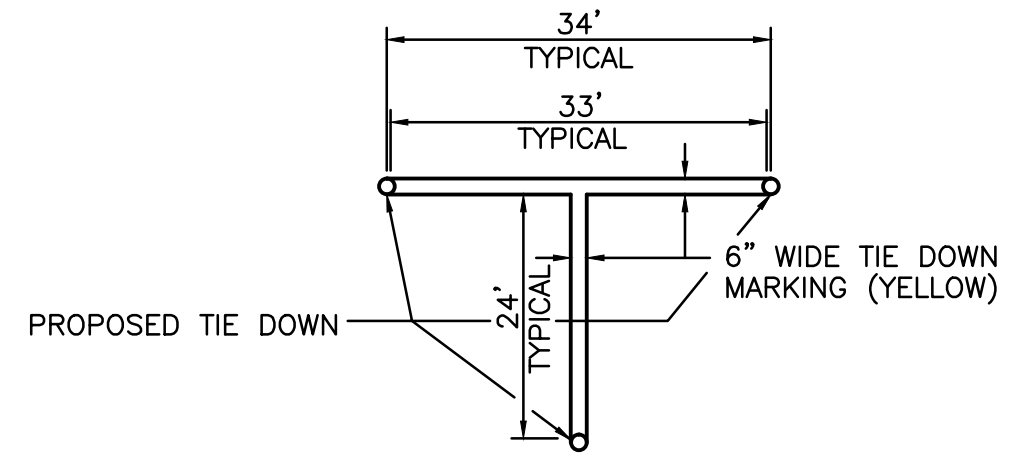

TIE DOWN "B" DETAIL
N.T.S.

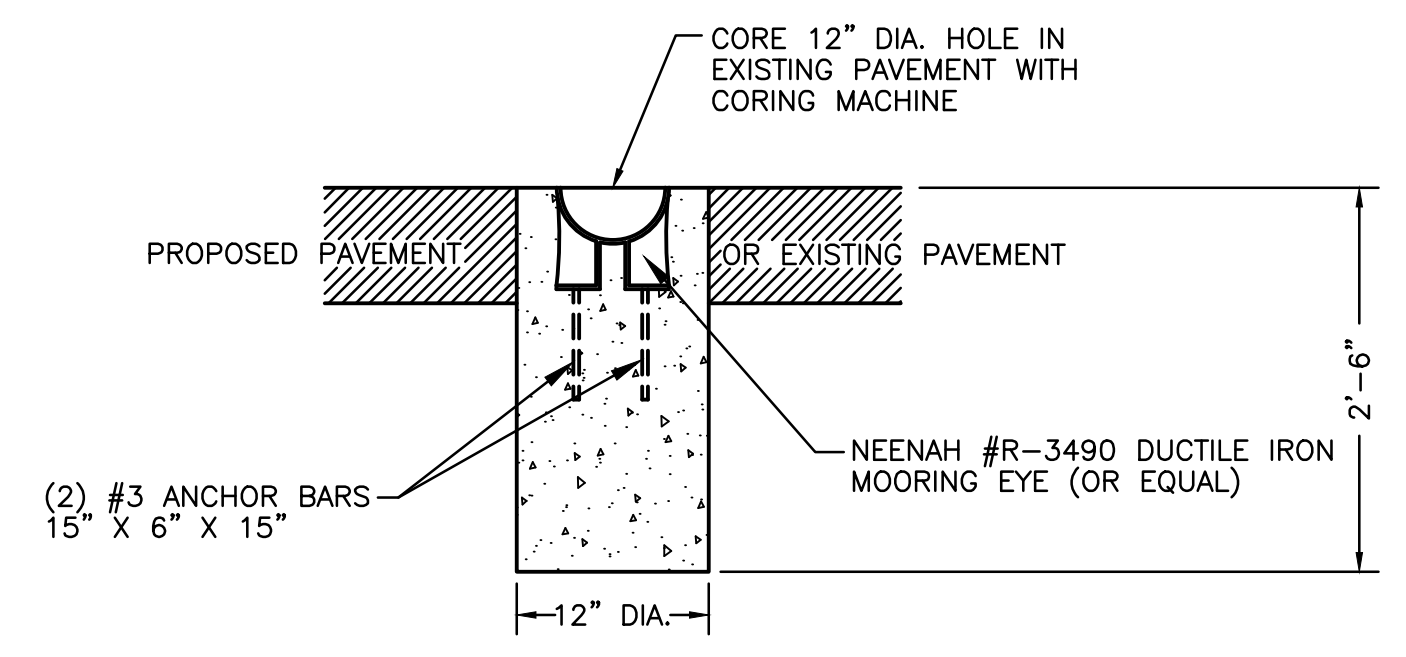

TIE DOWN DETAIL
N.T.S.

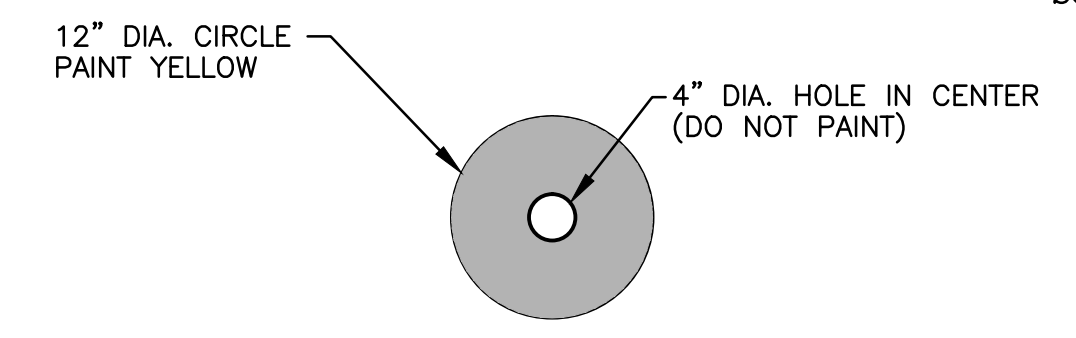

GROUND ROD MARKING DETAIL
N.T.S.

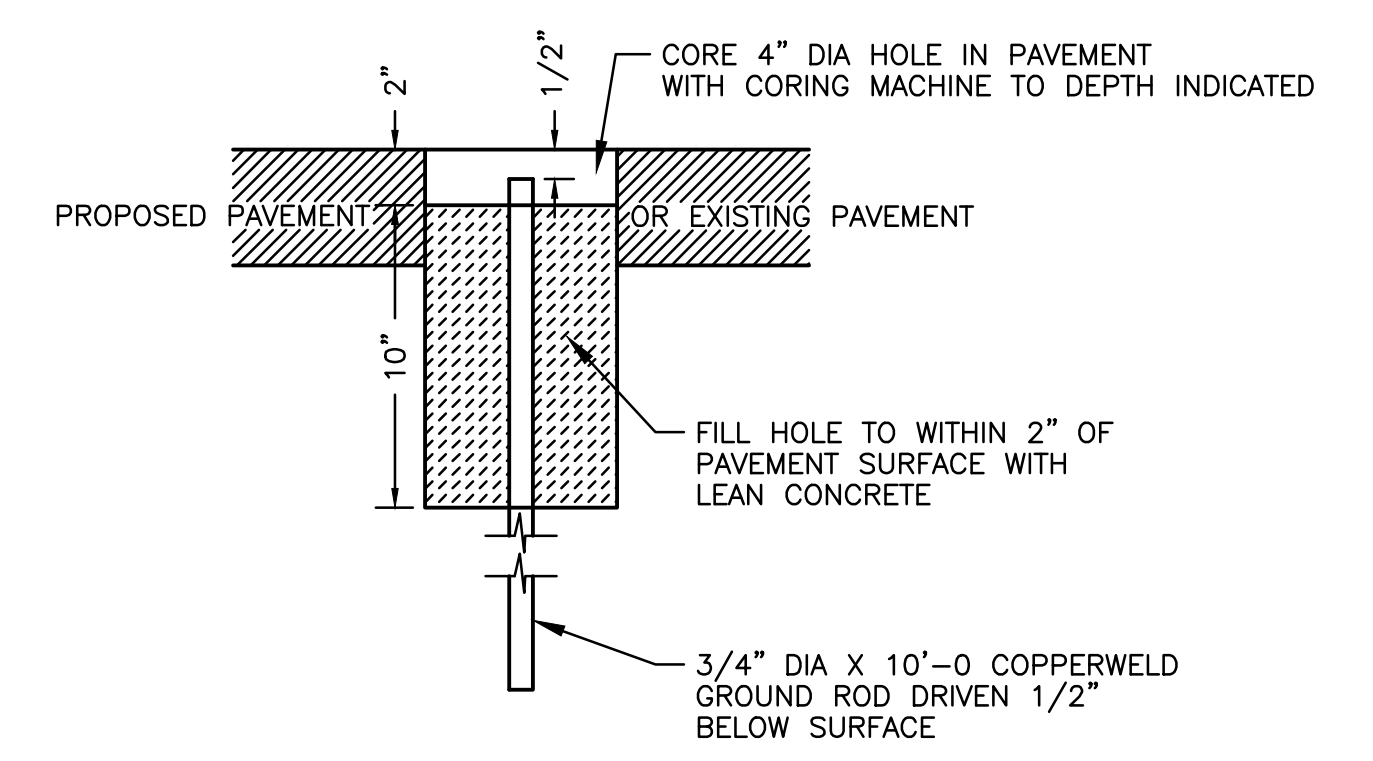

GROUND ROD DETAIL
N.T.S.

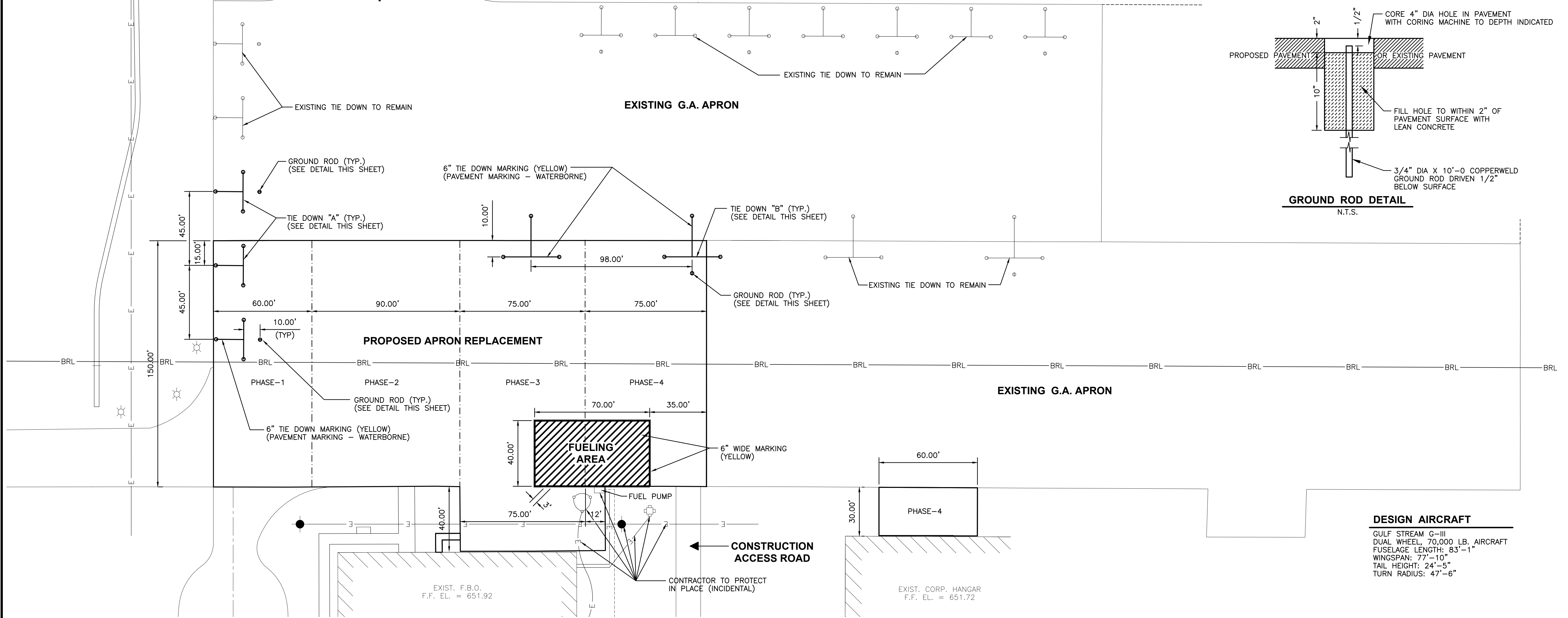

DESIGN AIRCRAFT
 GULF STREAM G-III
 DUAL WHEEL, 70,000 LB. AIRCRAFT
 FUSELAGE LENGTH: 83'-1"
 WINGSPAN: 77'-10"
 TAIL HEIGHT: 24'-5"
 TURN RADIUS: 47'-6"

CHAMLIN & ASSOCIATES, INC. © 2011
 Drawing Name: G:\Users\11102-00-Peru\00-Apron-Replac\00-Plan\1102-00-Peru-04-Apron-Replac.dwg Last Modified: Nov 22, 2013 11:11:11am Plotted on: Nov 22, 2013 2:04pm by tmh

DRAWN BY: TIM H	REVISIONS			
CHECKED BY: KWH	LEVEL	BY	DATE	DESCRIPTION
DATE: 11/13				

CHAMLIN ASSOCIATES
 PERU MORRIS ILLINOIS

ILLINOIS VALLEY REGIONAL AIRPORT
 ILLINOIS PROJECT NO. VYS-4191
 STATE BLOCK GRANT No. 3-17-0060-B22

DIMENSIONAL LAYOUT PLAN & PAVEMENT MARKING PLAN

CONSTRUCTION PLANS

CURRENT AS OF: 11/13	
SCALE: AS NOTED	SHEET 3
FILE NO.: 1102.00 Y-	OF 5

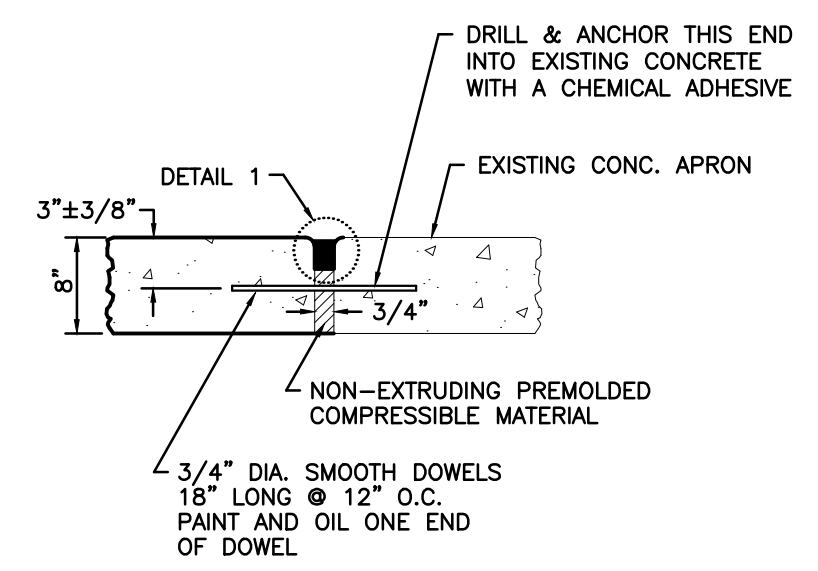
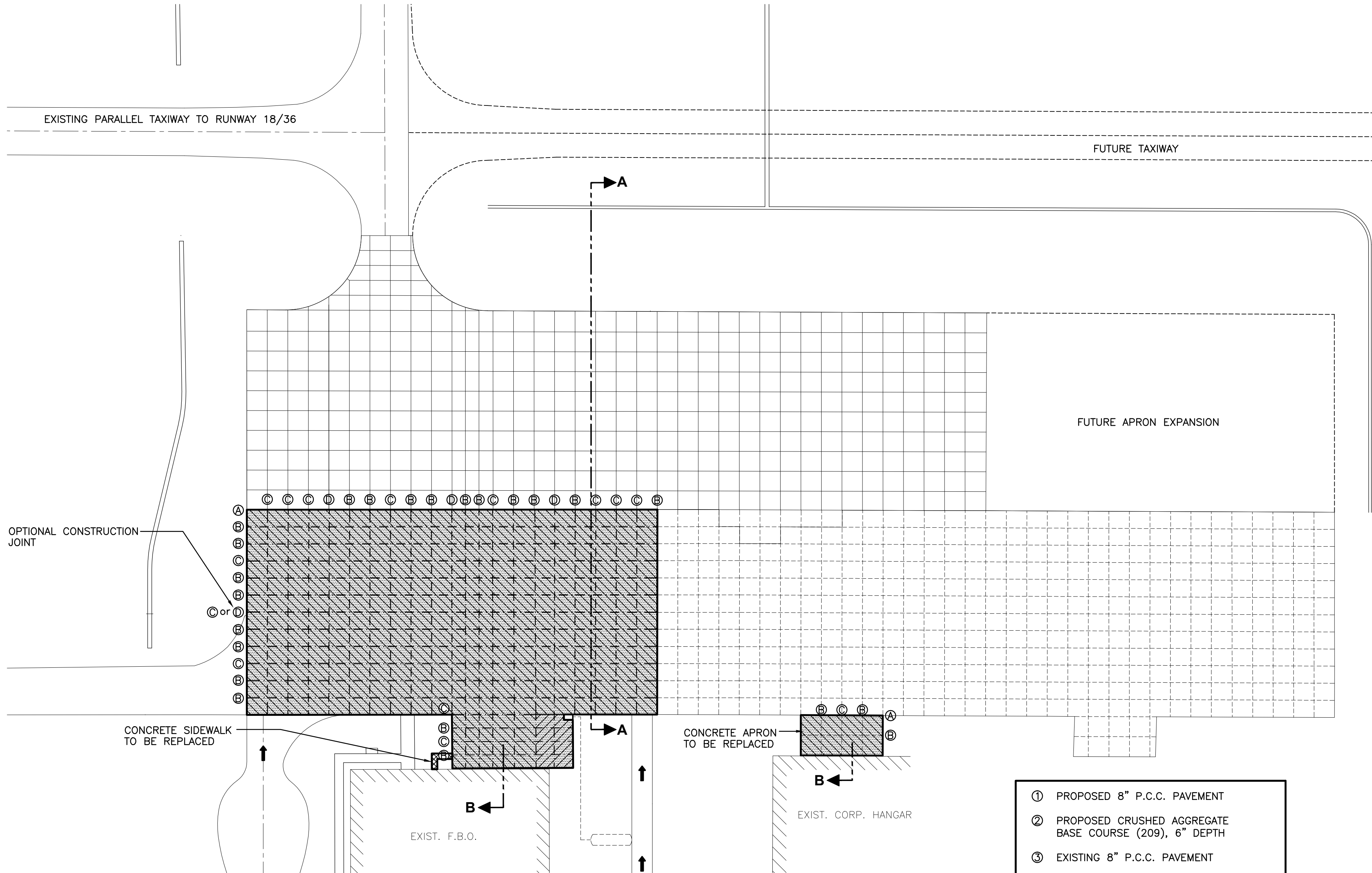
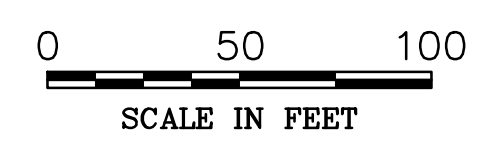

TYPE A DOWELED JOINT

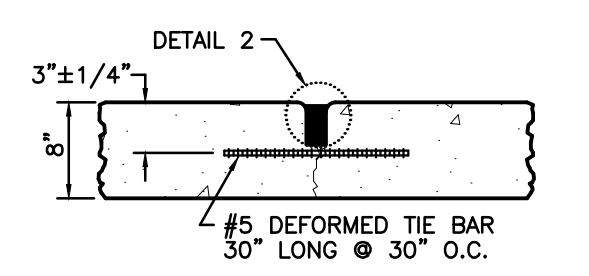

TYPE B HINGED JOINT

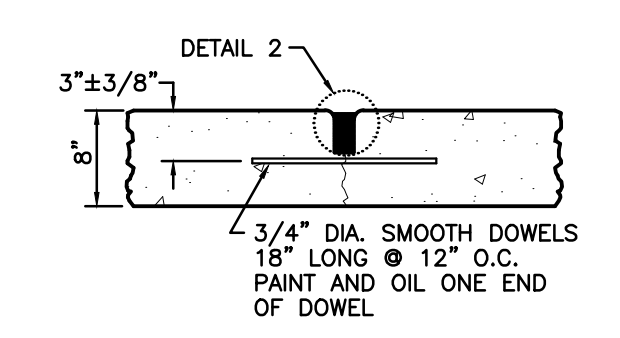

TYPE C DOWELED JOINT

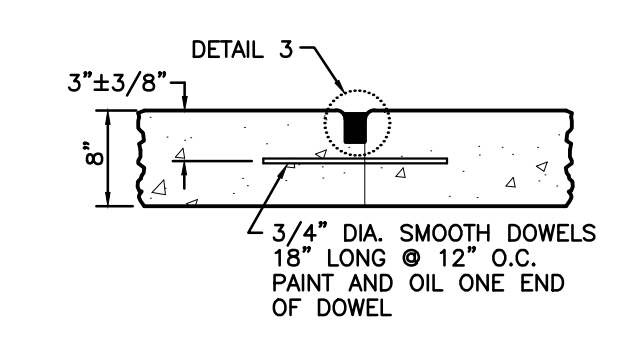

TYPE D DOWELED (CONSTRUCTION JOINT)

JOINT DETAILS
NOT TO SCALE

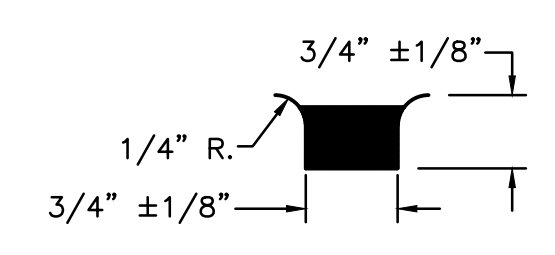

DETAIL 1

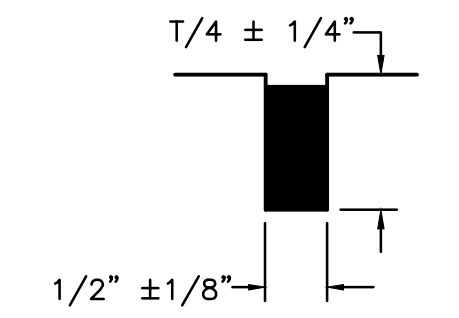

DETAIL 2

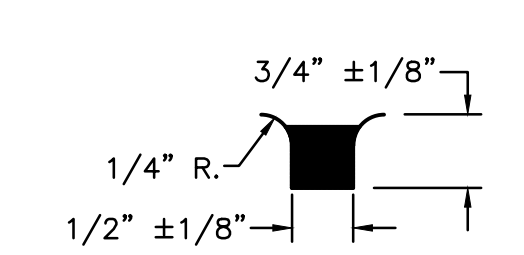

DETAIL 3

JOINT FILLER DETAILS
NOT TO SCALE

LEGEND

	CONCRETE PAVEMENT (5,570 SQ. YD.)
	ASPHALT PAVEMENT REMOVAL (115 SQ. YD.)
	CONCRETE PAVEMENT REMOVAL (5,455 SQ. YD.)
	4" CONCRETE SIDEWALK REMOVAL & REPLACEMENT (10 SQ. YD.)

- ① PROPOSED 8" P.C.C. PAVEMENT
- ② PROPOSED CRUSHED AGGREGATE BASE COURSE (209), 6" DEPTH
- ③ EXISTING 8" P.C.C. PAVEMENT
- ④ EXISTING CRUSHED AGGREGATE BASE COURSE (209), 6" DEPTH.
- ⑤ EXISTING P.C.C. PAVEMENT TO BE REMOVED
- ⑥ EXISTING CRUSHED AGGREGATE BASE COURSE, 4" DEPTH TO BE REMOVED (PAID AS UNCLASSIFIED EXCAVATION)
- ⑦ UNCLASSIFIED EXCAVATION, 8" DEPTH TO BE REMOVED

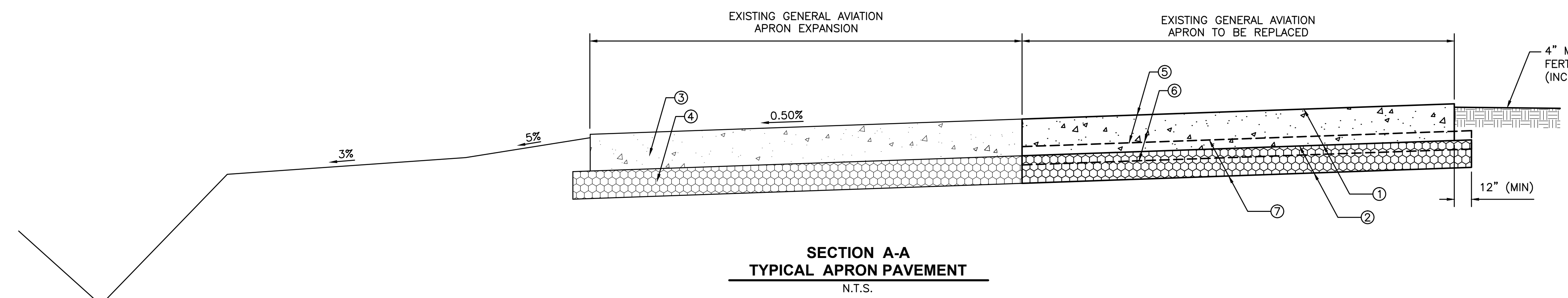

SECTION A-A
TYPICAL APRON PAVEMENT
N.T.S.

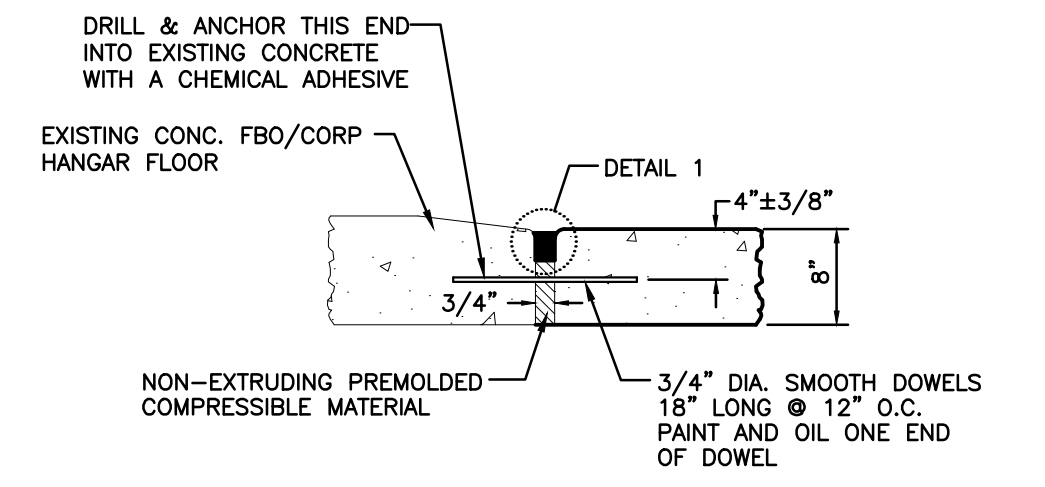

SECTION B
PAVEMENT @ FBO OVERHEAD DOOR
N.T.S.

CHAMLIN & ASSOCIATES, INC. © 2011
Drawing Name: G:\Users\N1102-09-Peru\005-Paving\Apron-Reliab\CAD\Final Plans - 100%_005-Paving.dwg Last Modified: Jun 02, 2013 1:10:58pm Plotted on: Nov 22, 2013 2:05:58pm by lmm

DRAWN BY: TIM H	REVISIONS			
CHECKED BY: KWH	LEVEL	BY	DATE	DESCRIPTION
DATE: 11/13				

CHAMLIN & ASSOCIATES
PERU MORRIS ILLINOIS

ILLINOIS VALLEY REGIONAL AIRPORT
ILLINOIS PROJECT NO. VYS-4191
STATE BLOCK GRANT No. 3-17-0060-B22

PAVING PLAN

CONSTRUCTION PLANS	CURRENT AS OF: 11/13	
	SCALE: AS NOTED	SHEET 5
	FILE NO.: 1102.00 Y-	OF 5