

094

F.A. RTE.	SECTION	COUNTY	TOTAL SHEETS	SHEET NO.
VAR	D4 BRIDGE WASHING 2020		6	1
ILLINOIS			CONTRACT 68F18	

MARSHALL & MASON

D-94-007-20

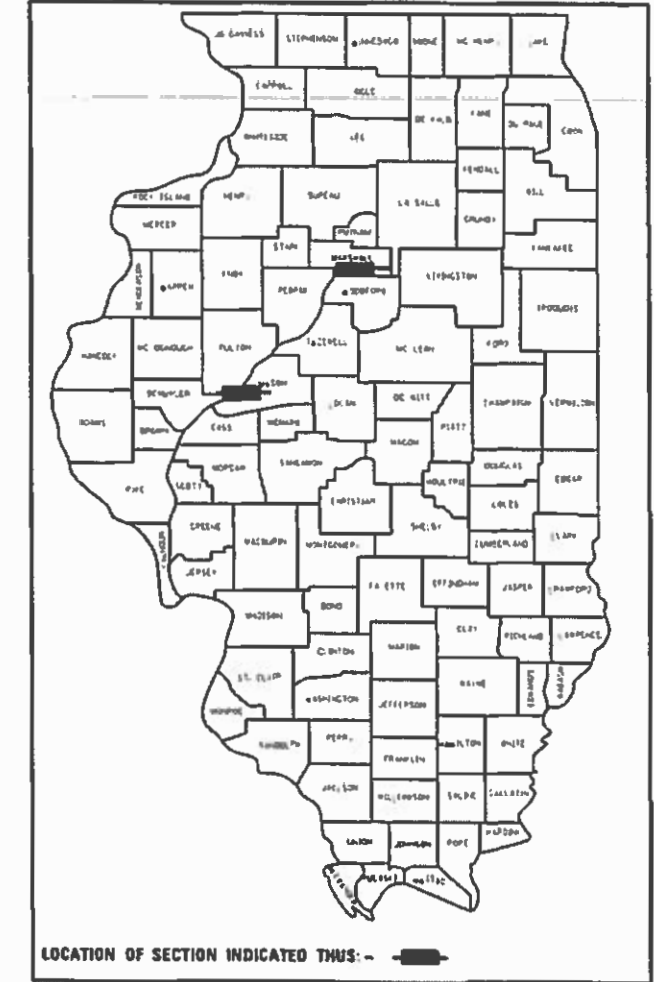

LOCATION OF SECTION INDICATED THUS: - [shaded area]

STATE OF ILLINOIS
 DEPARTMENT OF TRANSPORTATION
 DIVISION OF HIGHWAYS
**PROPOSED
 HIGHWAY PLANS**

VARIOUS ROUTES
 SECTION D4 BRIDGE WASHING 2020
 PROJECT NHPP-STP-0FHX(163)
 TYPE of IMPROVEMENT BRIDGE WASHING
 MARSHALL AND MASON COUNTIES

C-94-008-20

INDEX OF SHEETS

- 1 COVER SHEET
- 2 GENERAL NOTES
- 3 SUMMARY OF QUANTITIES
- 4-6 PLAN SHEETS

STANDARDS

- 701001-02
- 701006-05
- 701011-04
- 701201-05
- 701301-04
- 701901-08

ADT

- Location 1 - 2550
- Location 2 - 7400
- Location 3 - 5650

J.U.L.I.E.
 JOINT UTILITY LOCATION INFORMATION FOR EXCAVATION
 1-800-892-0123
 OR 811

PROJECT ENGINEER TOM INGLIS (309) 671-3481
 PROJECT MANAGER MIKE LEWIS (309) 671-3454
 CONTRACT NO. 68F18
 CATALOG NO. 035840-00D

- Location 1
S.N. 062-0036
- Location 2
S.N. 062-0003

- Location 3
S.N. 063-0002



STATE OF ILLINOIS
 DEPARTMENT OF TRANSPORTATION

SUBMITTED Oct 18 2019
Kensil A. Garnett RSD
 REGIONAL ENGINEER

Dec 6 2019
[Signature]
 ENGINEER OF DESIGN AND ENVIRONMENT

Dec 10 2019
[Signature]
 DIRECTOR OF HIGHWAYS PROJECT IMPLEMENTATION

PRINTED BY THE AUTHORITY
 OF THE STATE OF ILLINOIS

COMMITMENTS

No Commitments have been made for this project.

GENERAL NOTE

All bridge locations: The ENTIRE bridge shall be washed in accordance with Section 592 of the Standard Specifications for Road and Bridge Construction.

MODEL: Default
FILE: \\marshall-pc\pub\baronm\data\illinois.gov\PW\DOT\Documents\DOT_Offices\District_4\Projects\ID4_68F18\CADD\Drawings\ID468F18-CADD.dwg

USER NAME = eversct	DESIGNED -	REVISED -
	DRAWN -	REVISED -
PLOT SCALE = 100,0000 ' / in.	CHECKED -	REVISED -
PLOT DATE = 10/18/2019	DATE -	REVISED -

STATE OF ILLINOIS
DEPARTMENT OF TRANSPORTATION

GENERAL NOTES

SCALE: SHEET OF SHEETS STA. TO STA.

F.A. RTE.	SECTION	COUNTY	TOTAL SHEETS	SHEET NO.
VAR	D4 BRIDGE WASHING 2020	*	6	2
			CONTRACT NO. 68F18	
		ILLINOIS	FED. AID PROJECT	

CODE NO.	ITEM	UNIT	TOTAL QUANTITY	STP	NHPP
				CONSTRUCTION CODE	
				RURAL	RURAL
				80(FED) / 20(STATE)	80(FED) / 20(STATE)
				VARIOUS	VARIOUS
MARSHALL	MASON				
				0047	0047
59200101	BRIDGE WASHING NO. 1	EACH	1	1	
59200102	BRIDGE WASHING NO. 2	EACH	1	1	
59200103	BRIDGE WASHING NO. 3	EACH	1		1
67100100	MOBILIZATION	L SUM	1	0.67	0.33
70100450	TRAFFIC CONTROL AND PROTECTION, STANDARD 701201	L SUM	1	0.67	0.33

MODEL: D:\default
 FILE: \\p:\arooms\dst\illinois\p\DOT\Documents\DOT - Offices\District 4\Projects\04-66F18\CADData\CAD-arungs\0466F18-CAD.dgn

USER NAME = everscl	DESIGNED -	REVISED -
PLOT SCALE = 100.0000' / in.	DRAWN -	REVISED -
PLOT DATE = 10/18/2019	CHECKED -	REVISED -
	DATE -	REVISED -

**STATE OF ILLINOIS
 DEPARTMENT OF TRANSPORTATION**

SUMMARY OF QUANTITIES

F.A. + RTE.	SECTION	COUNTY	TOTAL SHEETS	SHEET NO.
VAR	D4 BRIDGE WASHING 2020	*	6	3
			CONTRACT NO. 68F18	
ILLINOIS FED. AID PROJECT				

FOR INFORMATION ONLY

LOCATION 1 (IL 18 OVER ILLINOIS RIVER)

HENRY BRIDGE

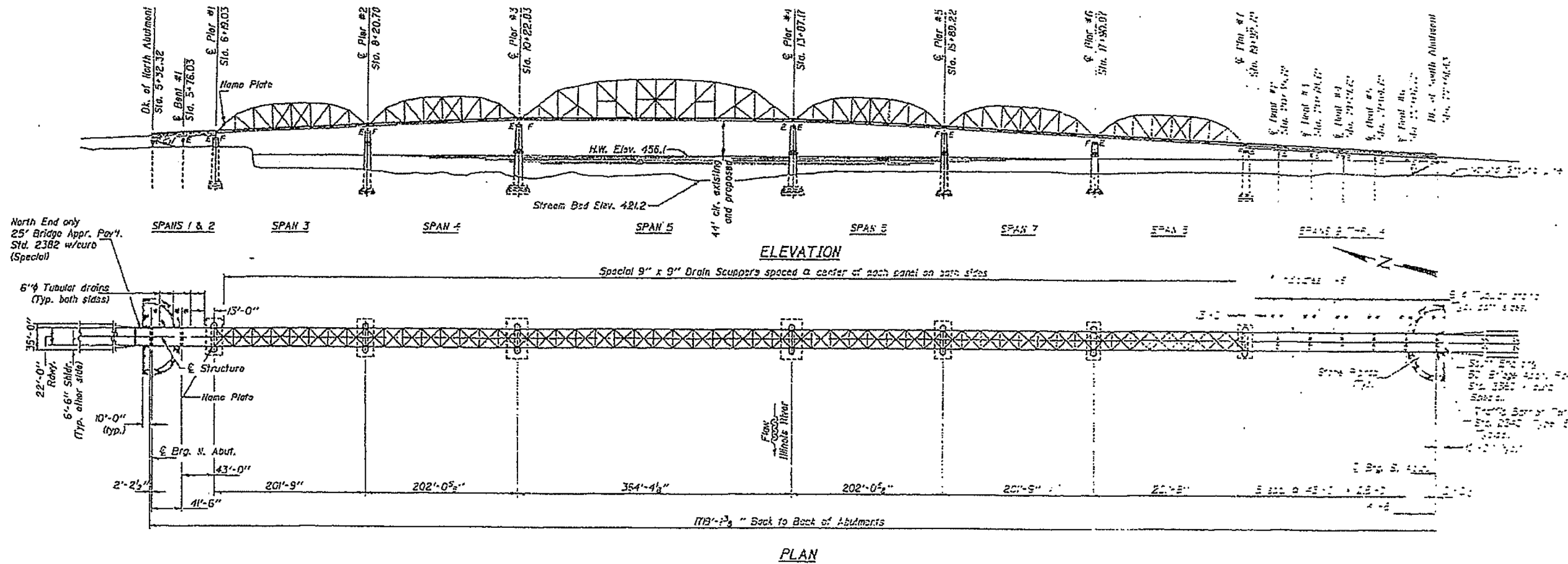

S.N. 062-0036

FILE NAME =	USER NAME = everscl	DESIGNED -	REVISED -	STATE OF ILLINOIS DEPARTMENT OF TRANSPORTATION	LOCATION 1 - IL 18 OVER THE ILLINOIS RIVER	F.A. RTE.	SECTION	COUNTY	TOTAL SHEETS	SHEET NO.	
pw\planroom.dot.illinois.gov\PIDOT\Documents\IDOT Offices\District 4\Projects\04.68F18\Drawings\0468F18-CADD.dgn		REVISOR -	DATE -			VAR	D4 BRIDGE WASHING 2020			6	4
Default	PLOT SCALE = 100.0000' / in.	CHECKED -	REVISED -			CONTRACT NO. 68F18					
	PLOT DATE = 10/18/2019	DATE -	REVISED -			ILLINOIS FED. AID PROJECT					
					SCALE:	SHEET	OF	SHEETS	STA.	TO STA.	

FOR INFORMATION ONLY

LOCATION 2 (IL 17 OVER ILLINOIS RIVER)

LACON BRIDGE

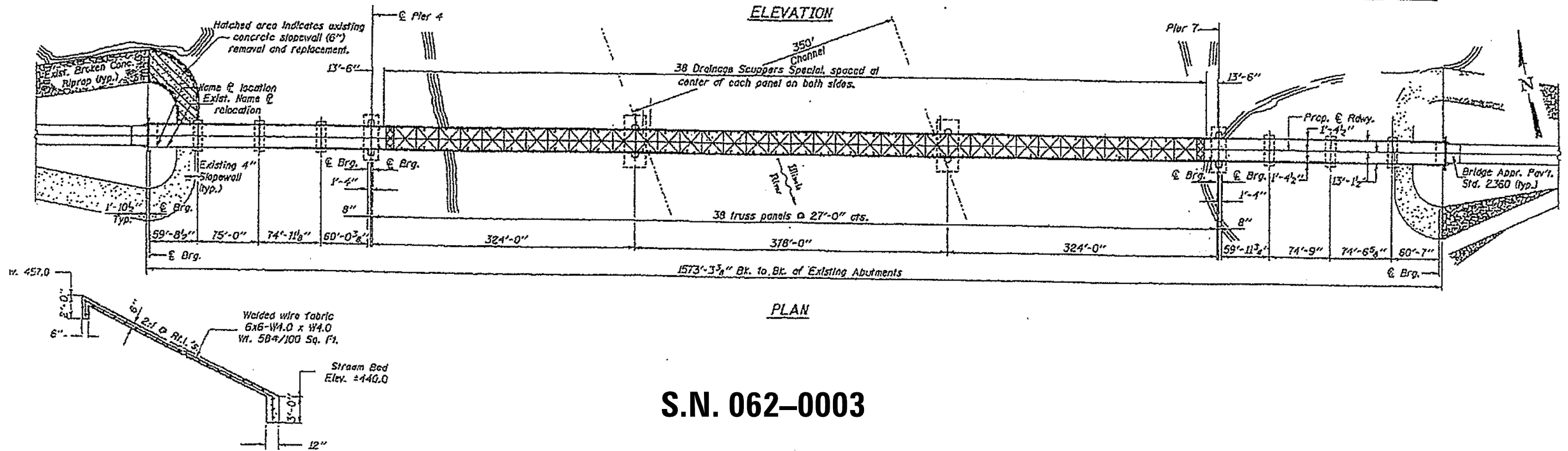
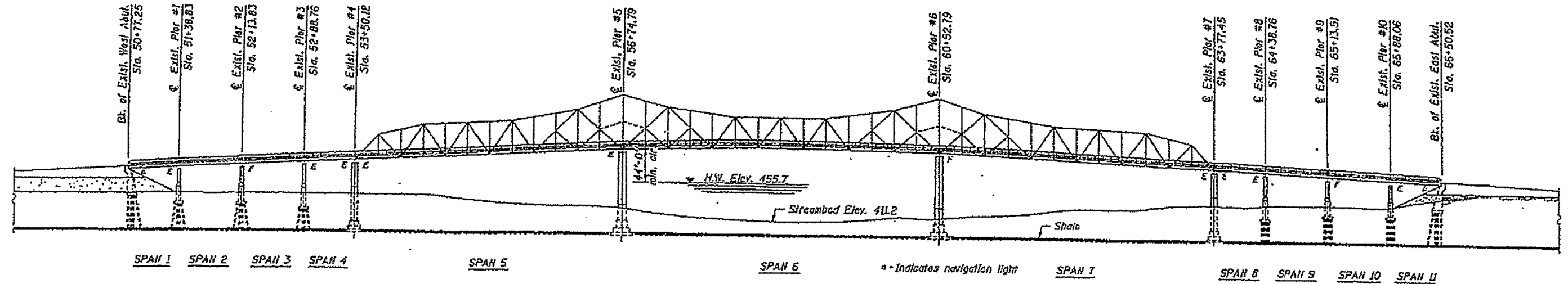

S.N. 062-0003

FILE NAME =	USER NAME = everscl	DESIGNED -	REVISED -	STATE OF ILLINOIS DEPARTMENT OF TRANSPORTATION	LOCATION 2 - IL 17 OVER ILLINOIS RIVER	F.A. RTE.	SECTION	COUNTY	TOTAL SHEETS	SHEET NO.
pw\planroom.dot.illinois.gov\PIWIDOT\Documents\IDOT Offices\District 4\Projects\D4_68F18\BRAWN\CA04drawings\D468F18-CA04.dgn						VAR	D4 BRIDGE WASHING 2020	*	6	5
Default	PLOT SCALE = 100.0000' / in.	CHECKED -	REVISED -			CONTRACT NO. 68F18				
	PLOT DATE = 10/18/2019	DATE -	REVISED -		SCALE:	ILLINOIS FED. AID PROJECT				
					SHEET	MARSHALL & MASON				

FOR INFORMATION ONLY
LOCATION 3 (S.N.063-0002) IL 136 OVER ILLINOIS RIVER
SCOTT LUCAS BRIDGE (HAVANA BRIDGE)

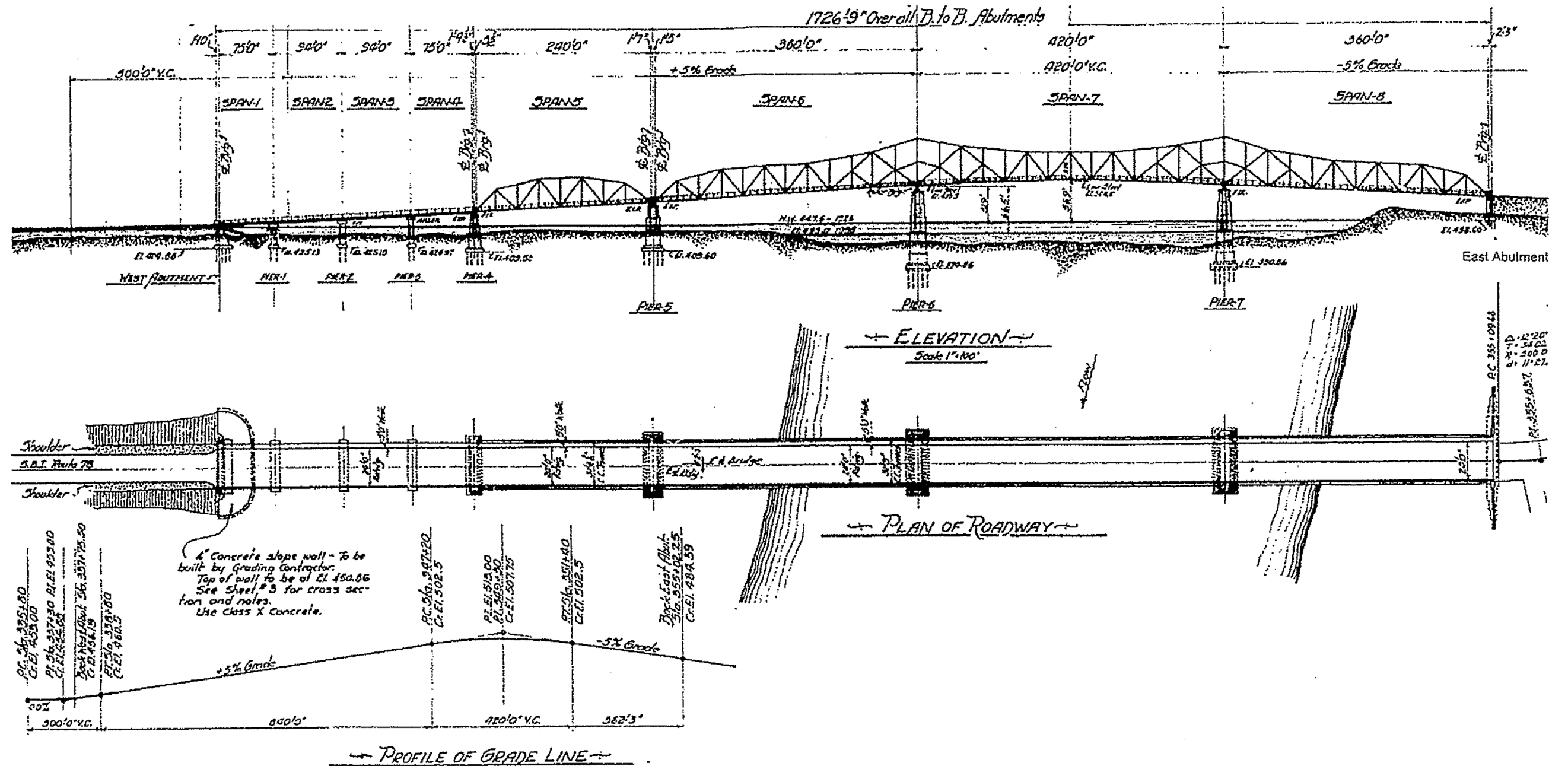

FILE NAME =	USER NAME = everscl	DESIGNED -	REVISED -	STATE OF ILLINOIS DEPARTMENT OF TRANSPORTATION	LOCATION 3 - IL 136 OVER ILLINOIS RIVER	F.A. RTE.	SECTION	COUNTY	TOTAL SHEETS	SHEET NO.	
pw\planroom.dot.illinois.gov\PIDOT\Documents\DOT Offices\District 4\Projects\D4.681\DRAWING\CA0drawings\D468F18-CA00.dgn		REVISOR -	REVISED -			VAR	D4 BRIDGE WASHING 2020	*	6	6	
PLOT SCALE = 100.0000' / in.		CHECKED -	REVISED -			CONTRACT NO. 68F18					
Default		DATE -	REVISED -			SCALE:	SHEET	OF	SHEETS	STA.	TO