

LETTING ITEM NO. 04A
 JANUARY 17, 2020 LETTING

CONSTRUCTION PLANS FOR GREENVILLE AIRPORT

GR010
 TOTAL SHEETS: 15

REHABILITATE PARTIAL PARALLEL TAXIWAY B

FINAL SUBMITTAL NOVEMBER 15, 2019

ILLINOIS PROJECT NUMBER: GRE-4759
 SBG PROJECT NUMBER: 3-17-SBGP-TBD

GREENVILLE, ILLINOIS
 BOND COUNTY

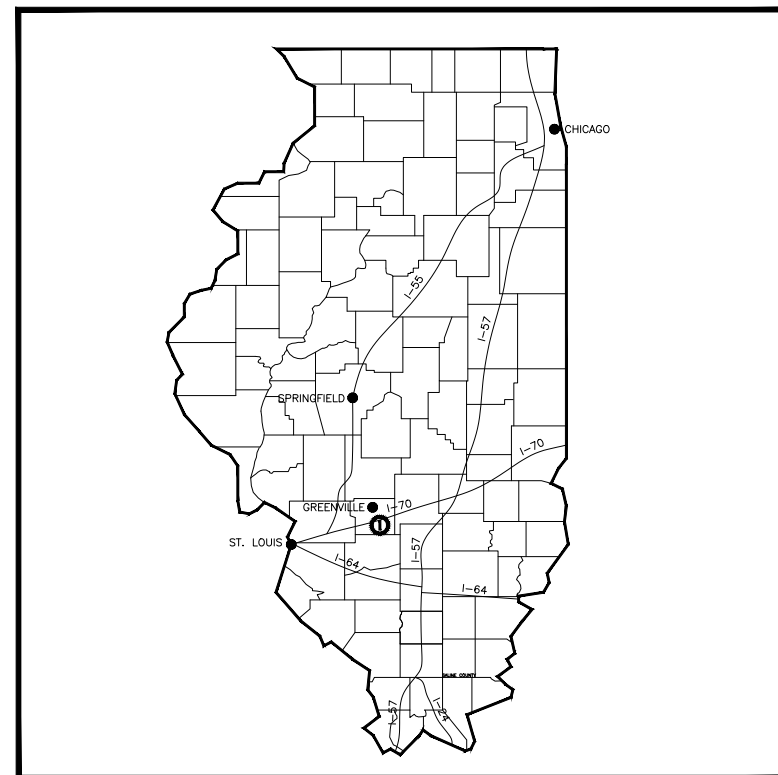

LOCATION MAP

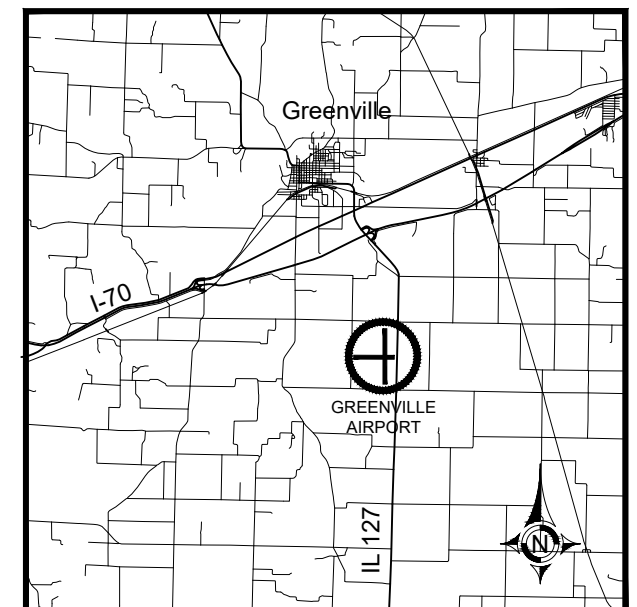

VICINITY MAP

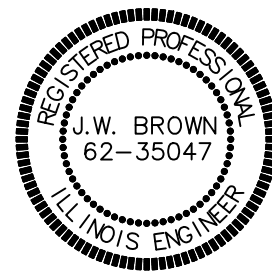

DESIGN INFORMATION
 - CRITICAL AIRCRAFT = CESSNA CITATION III
 - AIRCRAFT APPROACH CATEGORY (AAC) = B
 - AIRPLANE DESIGN GROUP (ADG) = II
 - TAXIWAY DESIGN GROUP (TDG) = 2
 - DEPARTURE WEIGHT = 22,000 LBS.

BROWN AND ROBERTS, INC.
 CONSULTING ENGINEER
 PRESIDENT
 SUBMITTED BY: *Jim W. Brown*
 JIM W. BROWN
 DATE SUBMITTED: 11/6/19
 LICENSE NUMBER: 184-002518
 LICENSE EXPIRATION DATE: APRIL 30, 2021

PLANS PREPARED BY:

 BROWN AND ROBERTS, INC.
 1 WESTRIDGE ROAD
 HARRISBURG, IL. 62946
 (618) 252-8111

GREENVILLE AIRPORT AUTHORITY
 CHAIRPERSON
 APPROVED BY: *Thuy Schuler* 11/6/19
 SECRETARY
 ATTESTED BY: *Randolph Vesel* 11-6-19

18 Nov 2019 - 9:50am X:\2018\18198\ac\Plans\1 Cover.dwg: Layout Tab 'Layout1'

SUMMARY OF QUANTITIES			
ITEM NUMBER	ITEM DESCRIPTION	UNIT	TOTAL QUANTITY
AR150520	MOBILIZATION	L. S.	1
AR150540	HAUL ROUTE	L. S.	1
AR152480	SHOULDER ADJUSTMENT	S.Y.	4525
AR152511	SUBGRADE REPAIR	S.Y.	500
AR201661	CLEAN & SEAL BITUMINOUS CRACKS	L.F.	2600
AR401613	BIT. SURF. CSE. - METHOD I, SUPERPAVE	TON	1230
AR 401620	BIT. SURFACE COURSE, LEVELING	TON	115
AR401650	BITUMINOUS PAVEMENT MILLING	S.Y.	9930
AR603510	BITUMINOUS TACK COAT	GAL.	2100
AR620520	PAVEMENT MARKING - WATERBORNE	S.F.	3560
AR620525	PAVEMENT MARKING - BLACK BORDER	S.F.	1402
AR901510	SEEDING	ACRE	0.9
AR908510	MULCHING	ACRE	0.9

INDEX OF SHEETS	
SHEET NUMBER	DESCRIPTION
1	COVER SHEET
2	SUMMARY OF QUANTITIES & INDEX OF SHEETS
3	CONSTRUCTION SAFETY & PHASING PLAN
4	TYPICAL SECTIONS
5	TAXIWAY B PLAN & PROFILE 1
6	TAXIWAY B PLAN & PROFILE 2
7	TAXIWAY B PLAN & PROFILE 3
8	TAXIWAY B PLAN & PROFILE 4
9	DETAILED ELEVATIONS
10	MARKING PLAN & DETAILS 1
11	MARKING PLAN & DETAILS 2
12	TAXIWAY B CROSS SECTIONS 1
13	TAXIWAY B CROSS SECTIONS 2
14	TAXIWAY B CROSS SECTIONS 3
15	TAXIWAY B CROSS SECTIONS 4

SCOPE OF WORK

THE PROJECT SCOPE CONSISTS OF THE REHABILITATION OF PARTIAL PARALLEL TAXIWAY B ALONG WITH OTHER NECESSARY AND RELATED WORK.

PROPOSED SAFETY PLAN

GENERAL- THE GREENVILLE AIRPORT CURRENTLY HAS A TURF RUNWAY 9-27 WHICH IS 2822 FT. x 250 FT. AND A PAVED RUNWAY 18-36 WHICH IS 4001 FT. x 75 FT.

RUNWAY 18-36 SHALL BE LIMITED TO SMALL AIRCRAFT (MAX TAKEOFF WEIGHT OF 12,500 LBS OR LESS) FOR THE DURATION OF THE PROJECT. THE AIRPORT WILL BE RESPONSIBLE FOR ISSUING ANY NOTAMS TO MEET THIS REQUIREMENT.

ANY WORK WITHIN 125' OF THE CENTERLINE OF A RUNWAY WILL REQUIRE CLOSURE OF THAT RUNWAY.

THE CONTRACTOR SHALL SUBMIT A SAFETY PLAN COMPLIANCE DOCUMENT (SPCD) CONFIRMING COMPLIANCE WITH THE CONSTRUCTION SAFETY PHASING PLAN (CSPF) PRIOR TO THE ISSUANCE OF THE NOTICE TO PROCEED AS SPECIFIED IN FAA AC 150/5370-2.

CONTRACTOR'S RESPONSIBILITIES

IDENTIFICATION- THE CONTRACTOR'S VEHICLES AND EQUIPMENT SHALL BE PROPERLY MARKED WITH 3-FOOT SQUARE INTERNATIONAL ORANGE AND WHITE CHECKERED FLAGS ANYTIME THEY ARE ON AIRPORT PROPERTY.

THE CONTRACTOR AND HIS EMPLOYEES SHALL BE RESTRICTED TO THE WORK AREA.

EQUIPMENT PARKING AND STORAGE- THE CONTRACTOR'S EQUIPMENT PARKING, STORAGE, AND EMPLOYEE PARKING WILL BE AT THE LOCATION SHOWN ON THIS SHEET. ONLY CONTRACTOR VEHICLES AND EQUIPMENT REQUIRED FOR CONSTRUCTION WILL BE ALLOWED OUTSIDE THIS AREA.

BARRICADES AND TRAFFIC CONES- IT WILL BE THE CONTRACTOR'S RESPONSIBILITY TO PLACE AND MAINTAIN BARRICADES AND TRAFFIC CONES AS REQUIRED AND AS DIRECTED BY THE RESIDENT ENGINEER. BARRICADES, THEIR MAINTENANCE, PLACEMENT, AND REMOVAL WILL BE CONSIDERED AS AN INCIDENTAL ITEM TO THE CONTRACT AND NO ADDITIONAL COMPENSATION WILL BE ALLOWED.

THE CONTRACTOR WILL BE RESPONSIBLE FOR REPAIRING ANY DAMAGE TO EXISTING PAVEMENTS CAUSED BY HIS PERSONNEL OR EQUIPMENT.

ACCESS/HAUL ROUTE AND EQUIPMENT PARKING

THE CONTRACTOR WILL USE THE DESIGNATED ACCESS/HAUL ROUTE AND EQUIPMENT PARKING AREA SHOWN ON THIS SAFETY PLAN. THE PROPOSED EQUIPMENT PARKING AREA WILL BE APPROXIMATELY 70-FT BY 150-FT. THE CONTRACTOR WILL BE REQUIRED TO MAINTAIN THE PROPOSED ACCESS/HAUL ROUTE AND PARKING AREA THROUGHOUT THE COURSE OF THE PROJECT. AT THE CONCLUSION OF THE PROJECT, ALL AREAS DISTURBED WILL BE RESTORED AS NEEDED TO ITS ORIGINAL STATE. RESTORATION OF THE ACCESS/HAUL ROUTE AND EQUIPMENT PARKING AREA WILL BE CONSIDERED INCLUDED WITH THE AR150540 HAUL ROUTE PAY ITEM AND NO ADDITIONAL COMPENSATION WILL BE ALLOWED.

UTILITY NOTE

THE CONTRACTOR IS RESPONSIBLE FOR CONTACTING ALL UTILITY COMPANIES AND ORGANIZATIONS THAT HAVE LINES OR CONDUITS IN THE PROPOSED WORK AREA. ALL LINES AND CONDUITS SHALL BE LOCATED AND IDENTIFIED FOR DEPTH BEFORE ANY EXCAVATION BEGINS. THE CONTRACTOR SHALL CALL JULIE (1-800-892-0123) TO ACCOMPLISH THESE REQUIREMENTS. THE CONTRACTOR IS RESPONSIBLE FOR IDENTIFYING ALL NON-JULIE UTILITIES LOCATED WITHIN THE PROPOSED CONSTRUCTION LIMITS. THESE UTILITIES ARE TO BE LOCATED PRIOR TO THE START OF CONSTRUCTION.

J.U.L.I.E. INFORMATION

COUNTY.....BOND
 CITY.....GREENVILLE (4 MI SOUTHEAST)
 TOWNSHIP.....CENTRAL
 SECTION NO.....36
 NEAREST MAJOR ROAD INTERSECTION...ILLINOIS RT. 127 & SKY LANE
 AIRPORT ADDRESS...GREENVILLE AIRPORT
 1374 SKY LANE
 GREENVILLE, IL 62246

HEIGHT OF CONSTRUCTION EQUIPMENT

THE MAXIMUM ANTICIPATED HEIGHT OF THE CONSTRUCTION EQUIPMENT IS 19 FEET. THE TALLEST EQUIPMENT IS EXPECTED TO BE A SEMI-TRUCK WITH TRAILER IN THE UP POSITION.

AIRPORT SECURITY

AIRPORT SECURITY WILL BE MAINTAINED AT ALL TIMES. THE PROPOSED HAUL ROUTE SHOWN ON THIS SAFETY PLAN IS THE ONLY ACCESS CONTRACTOR EQUIPMENT AND PERSONNEL WILL BE ALLOWED TO USE. THE CONTRACTOR SHALL PROVIDE BARRICADES AT THIS ACCESS AND ENSURE THE BARRICADES ARE IN PLACE AT THE END OF EACH WORKING DAY.

AIRCRAFT OPERATIONAL AREA

THE CONTRACTOR, HIS EMPLOYEES, OR ANY EQUIPMENT WILL NOT PROCEED WITH ANY WORK WITHIN THE AIRCRAFT OPERATIONAL AREA WITHOUT FIRST CLOSING THE RUNWAY.

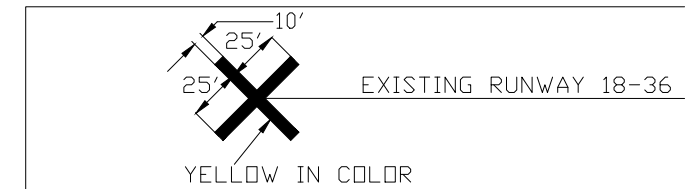

DETAIL OF CROSS FOR CLOSED RUNWAY
 "NOT TO SCALE"

NOTE:

THE COST OF CONSTRUCTING, PLACING, MAINTAINING, AND REMOVING CROSSES WILL BE CONSIDERED INCIDENTAL TO THE CONTRACT AND NO ADDITIONAL COMPENSATION WILL BE ALLOWED. THE CROSSES WILL BE YELLOW IN COLOR AND SHALL BE MADE OF A SUITABLE MATERIAL AS APPROVED BY THE RESIDENT ENGINEER. THE CROSSES WILL BE PLACED AT THE ENDS OF THE RUNWAY AND SECURED IN A MANNER APPROVED BY THE RESIDENT ENGINEER. THE PROPOSED CROSSES WILL BE PLACED WHEN THE RUNWAY IS CLOSED AND REMOVED WHEN THE RUNWAY IS RE-OPENED. THE CONTRACTOR WILL BE RESPONSIBLE FOR THE PLACEMENT AND REMOVAL OF THE CROSSES AT NO ADDITIONAL COST TO THE CONTRACT.

RUNWAY CLOSURE PROCEDURES:

- * CONTACT THE AIRPORT MANAGER OR HIS ASSIGNED REPRESENTATIVE.
- * ISSUANCE OF NOTAM BY THE AIRPORT MANAGER OR HIS ASSIGNED REPRESENTATIVE.
- * PLACEMENT OF CROSSES (SEE DETAIL THIS SHEET).
- * PLACEMENT OF LIGHTED BARRICADES. ONLY AT THE TIME THAT ALL OF THE ABOVE ARE COMPLETED MAY ANY CONSTRUCTION OPERATIONS WITHIN 200-FT OF THE AFFECTED RUNWAY CENTERLINE AND WITHIN 600 FT OF THE RUNWAY END BEGIN.
- * RUNWAY LIGHTS SHALL BE DISABLED

RUNWAY RE-OPENING PROCEDURES:

- * REMOVE CROSSES.
- * REMOVE LIGHTED BARRICADES.
- * NOTIFY THE AIRPORT MANAGER OR HIS REPRESENTATIVE TO CANCEL THE NOTAM.
- * CANCELLATION OF THE NOTAM. A CLOSED RUNWAY WILL NOT BE RE-OPENED UNTIL ALL EQUIPMENT AND WORK ARE FURTHER THAN 200 FEET FROM THE AFFECTED RUNWAY CENTERLINE.
- * RUNWAY LIGHTS SHALL BE REACTIVATED.

LEGEND

- EXISTING PAVEMENT
- PROPOSED PAVEMENT IMPROVEMENTS
- EXISTING BUILDINGS
- PROPOSED CONTRACTOR ACCESS AND HAUL ROUTE
- PROPOSED CONTRACTOR PARKING AND STAGING AREAS
- IDOT TYPE II BARRICADE WITH RED FLASHING LIGHTS - 10' MAX SPACING
- AIRCRAFT OPERATIONS AREA (AOA)

CRITICAL POINTS

NO.	LATITUDE	LONGITUDE	ELEVATION
1	38° 50' 04.76" N	89° 22' 31.07" W	534.0' MSL
2	38° 50' 13.43" N	89° 22' 30.50" W	538.0' MSL
3	38° 50' 28.06" N	89° 22' 32.85" W	538.0' MSL
4	38° 50' 07.86" N	89° 22' 25.67" W	537.0' MSL
5	38° 50' 09.34" N	89° 22' 25.68" W	537.0' MSL

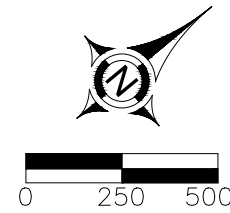
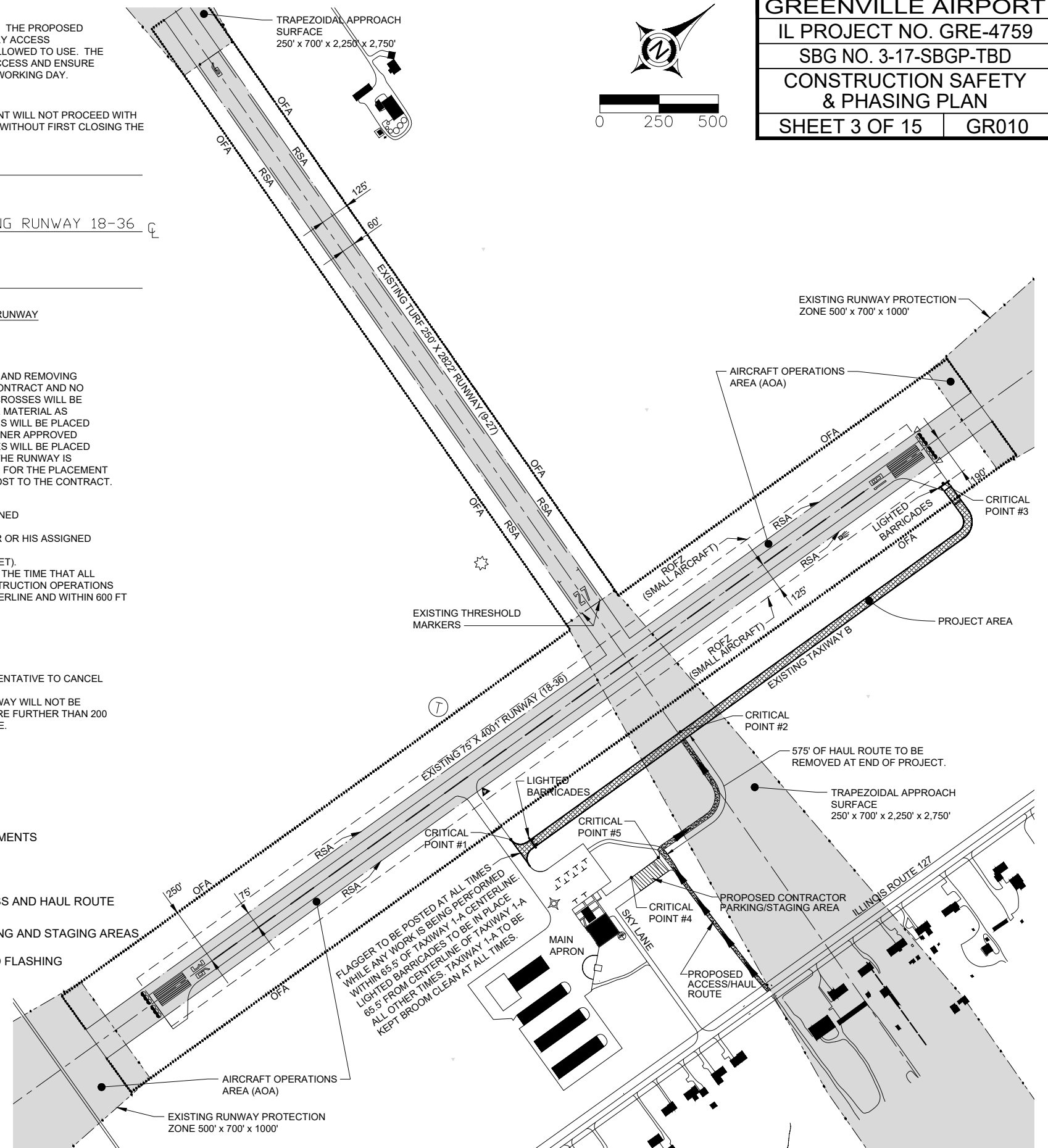

03 Dec 2019 - 2:38pm X:\2018\18198\ac\Plans\3 Safety Plan.dwg: Layout Tab 'Runway Safety Plan'

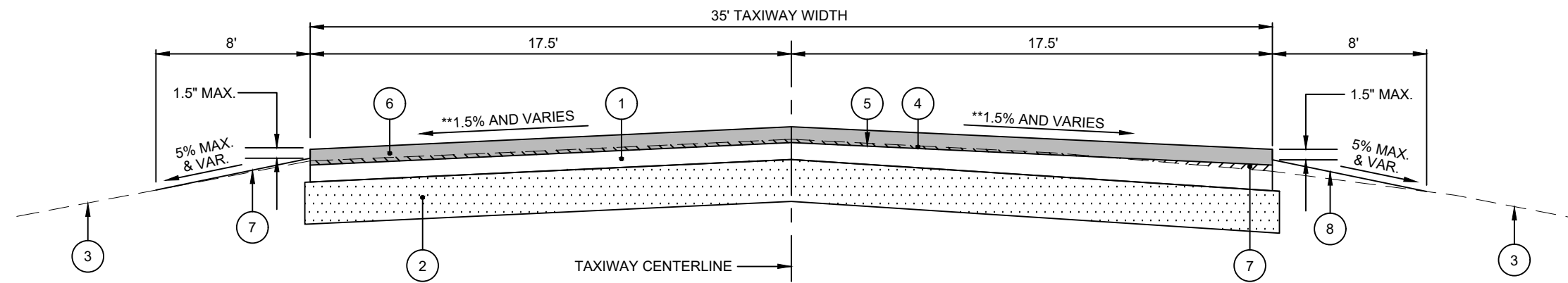

TAXIWAY B TYPICAL SECTION (WEST - EAST)

NO SCALE

LEGEND

- | | |
|----------------------------------------------------------------------------------------------------------------------|-------------------------------------------------------------------|
| ① EXISTING BITUMINOUS TAXIWAY PAVEMENT
*1.5" 401 BITUMINOUS SURFACE COURSE
AND 1.5" 201 BITUMINOUS BASE COURSE | ⑤ AR603510 - BITUMINOUS TACK COAT |
| ② EXISTING AGGREGATE BASE TO REMAIN
*8" CRUSHED AGGREGATE BASE COURSE | ⑥ AR401613 - BITUMINOUS SURFACE COURSE - METHOD I, SUPERPAVE (2") |
| ③ EXISTING TURF SHOULDER | ⑦ AR401620 - BITUMINOUS SURFACE COURSE, LEVELING (VARIABLE DEPTH) |
| ④ AR401650 - BITUMINOUS PAVEMENT MILLING
(1/2" NOMINAL DEPTH) | ⑧ AR152480 - SHOULDER ADJUSTMENT |

*NOTE 1: EXISTING PAVEMENT TYPES AND THICKNESS OBTAINED FROM GREENVILLE PAVEMENT HISTORY DATA, ILLINOIS DEPARTMENT OF TRANSPORTATION - DIVISION OF AERONAUTICS
**NOTE 2: PAVEMENT CROSS SLOPES TRANSITION AT EACH END TO MATCH EXISTING PAVEMENT CROSS SLOPES. SEE ELEVATION DETAIL SHEET FOR LOCATIONS OF SLOPE TRANSITIONS.

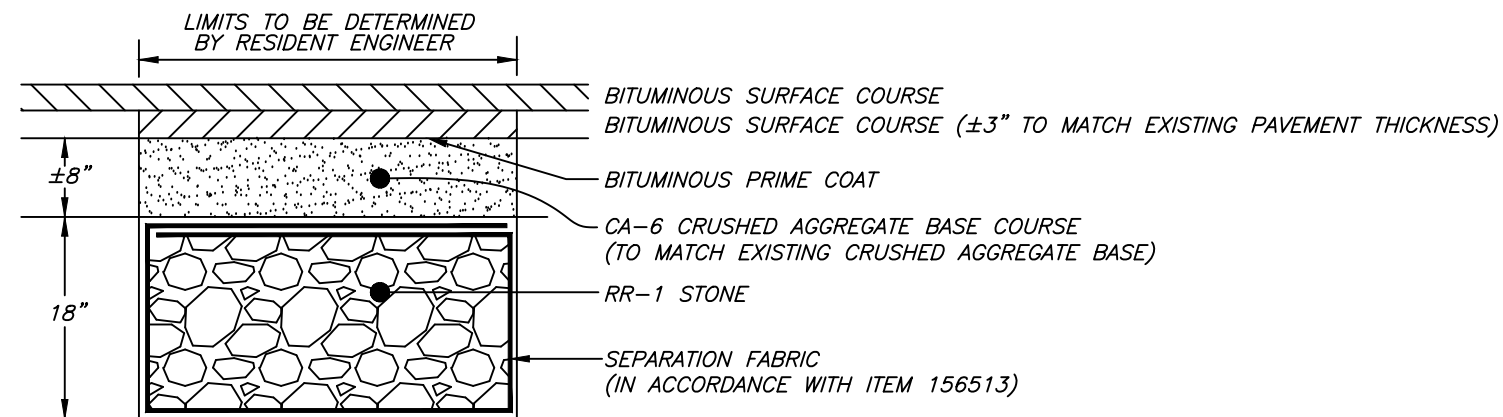

SUBGRADE REPAIR

NO SCALE

CONTROL POINTS				
CONTROL POINT #	NORTHING	EASTING	ELEVATION	DESCRIPTION
1	790420.02	2521778.55	533.37	NGS MON.
9	789774.96	2521567.78	532.09	MAG SPIKE



NOTE:
 ALL CONSTRUCTION LAYOUT NECESSARY FOR THE
 CONSTRUCTION OF THE VARIOUS PAY ITEMS WILL BE THE
 RESPONSIBILITY OF THE CONTRACTOR. HORIZONTAL AND
 VERTICAL CONTROL WILL BE FURNISHED BY THE ENGINEER.

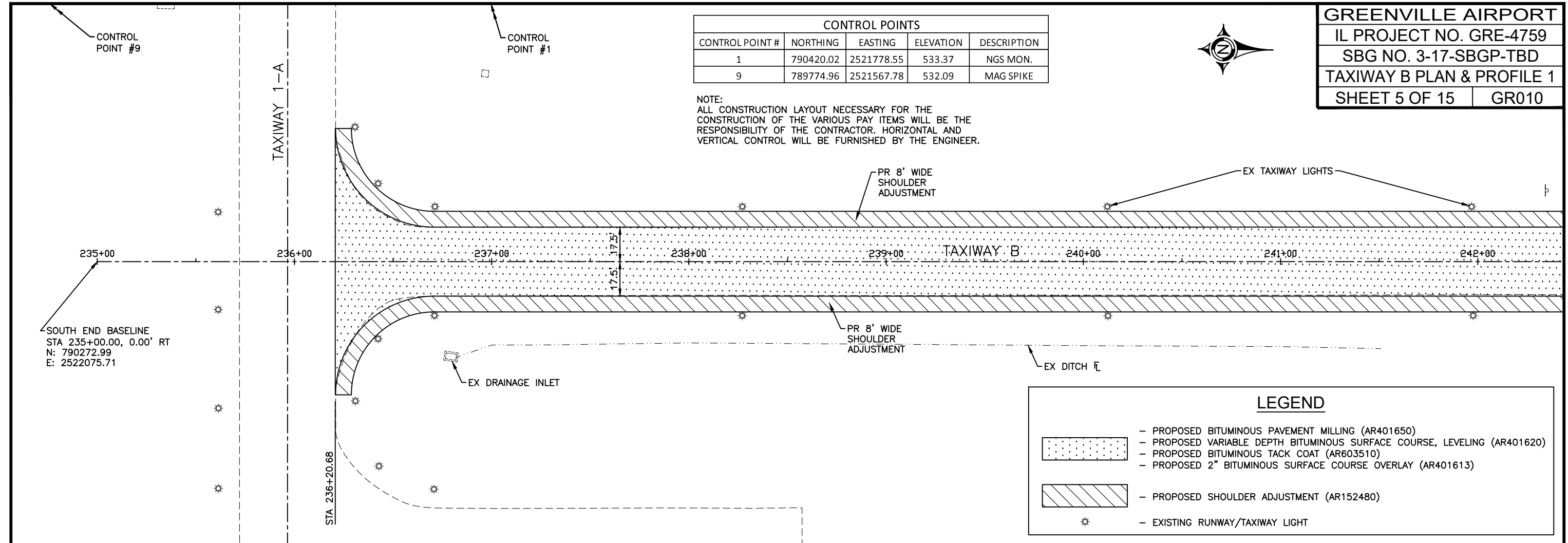

LEGEND

- PROPOSED BITUMINOUS PAVEMENT MILLING (AR401650)
- PROPOSED VARIABLE DEPTH BITUMINOUS SURFACE COURSE, LEVELING (AR401620)
- PROPOSED BITUMINOUS TACK COAT (AR603510)
- PROPOSED 2" BITUMINOUS SURFACE COURSE OVERLAY (AR401613)
- PROPOSED SHOULDER ADJUSTMENT (AR152480)
- EXISTING RUNWAY/TAXIWAY LIGHT

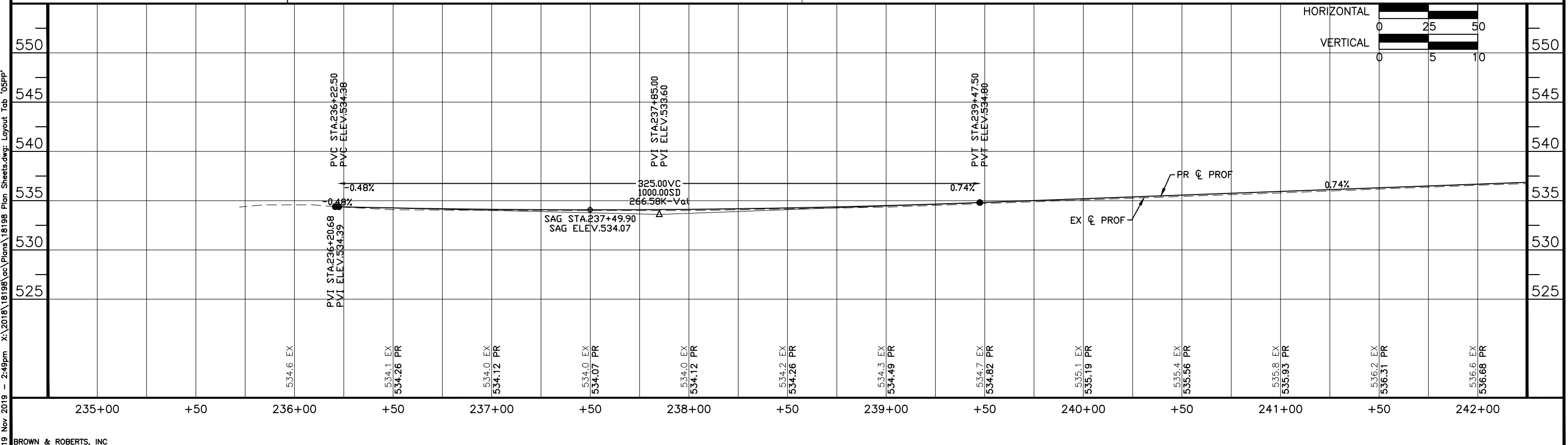

19 Nov 2019 - 2:49pm X:\2018\18198\vac\Plans\18198 Plan Sheets.dwg: Layout Tab '05PP'

GREENVILLE AIRPORT
IL PROJECT NO. GRE-4759
SBG NO. 3-17-SBGP-TBD
TAXIWAY B PLAN & PROFILE 2
SHEET 6 OF 15 | **GR010**

CONTROL POINTS				
CONTROL POINT #	NORTHING	EASTING	ELEVATION	DESCRIPTION
10	791228.43	2521532.90	537.50	MAG SPIKE



CL RUNWAY 9-27

CONTROL POINT #10

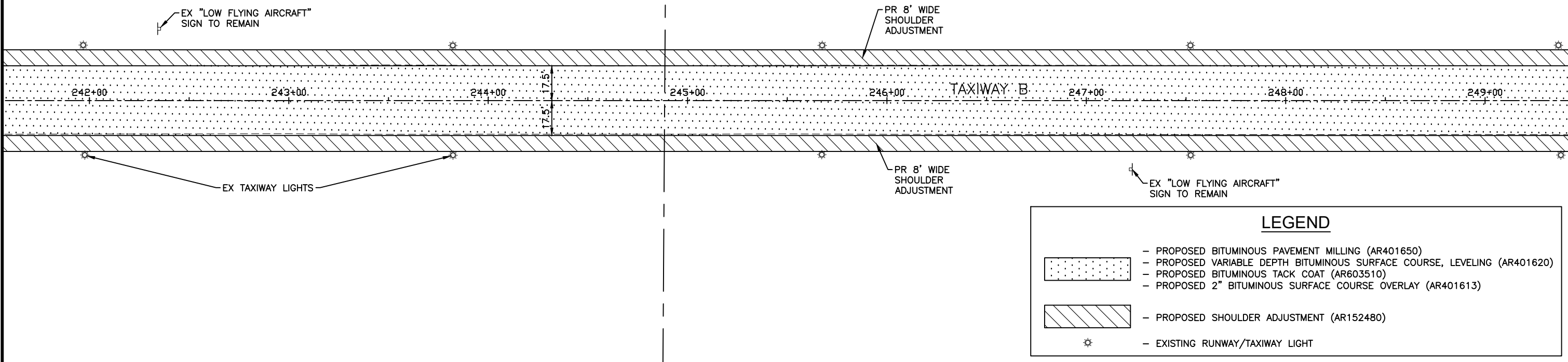

LEGEND

- PROPOSED BITUMINOUS PAVEMENT MILLING (AR401650)
- PROPOSED VARIABLE DEPTH BITUMINOUS SURFACE COURSE, LEVELING (AR401620)
- PROPOSED BITUMINOUS TACK COAT (AR603510)
- PROPOSED 2" BITUMINOUS SURFACE COURSE OVERLAY (AR401613)
- PROPOSED SHOULDER ADJUSTMENT (AR152480)
- EXISTING RUNWAY/TAXIWAY LIGHT

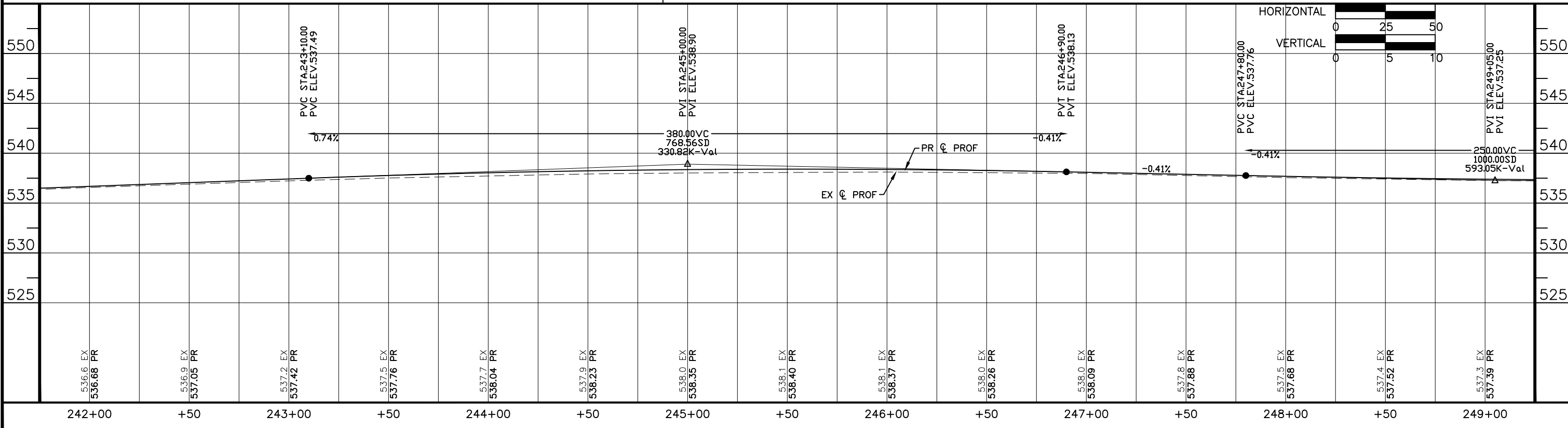

19 Nov 2019 - 2:49pm X:\2018\18198\vac\Plans\18198 Plan Sheets.dwg: Layout Tab '06PP'



CONTROL POINTS				
CONTROL POINT #	NORTHING	EASTING	ELEVATION	DESCRIPTION
11	791769.99	2521771.02	537.87	MAG SPIKE

CONTROL POINT #11

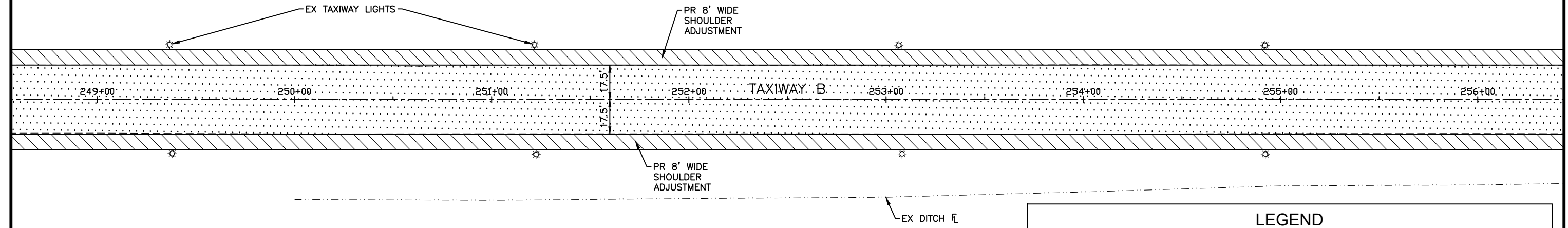

LEGEND

- PROPOSED BITUMINOUS PAVEMENT MILLING (AR401650)
- PROPOSED VARIABLE DEPTH BITUMINOUS SURFACE COURSE, LEVELING (AR401620)
- PROPOSED BITUMINOUS TACK COAT (AR603510)
- PROPOSED 2" BITUMINOUS SURFACE COURSE OVERLAY (AR401613)
- PROPOSED SHOULDER ADJUSTMENT (AR152480)
- EXISTING RUNWAY/TAXIWAY LIGHT

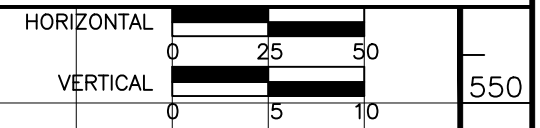
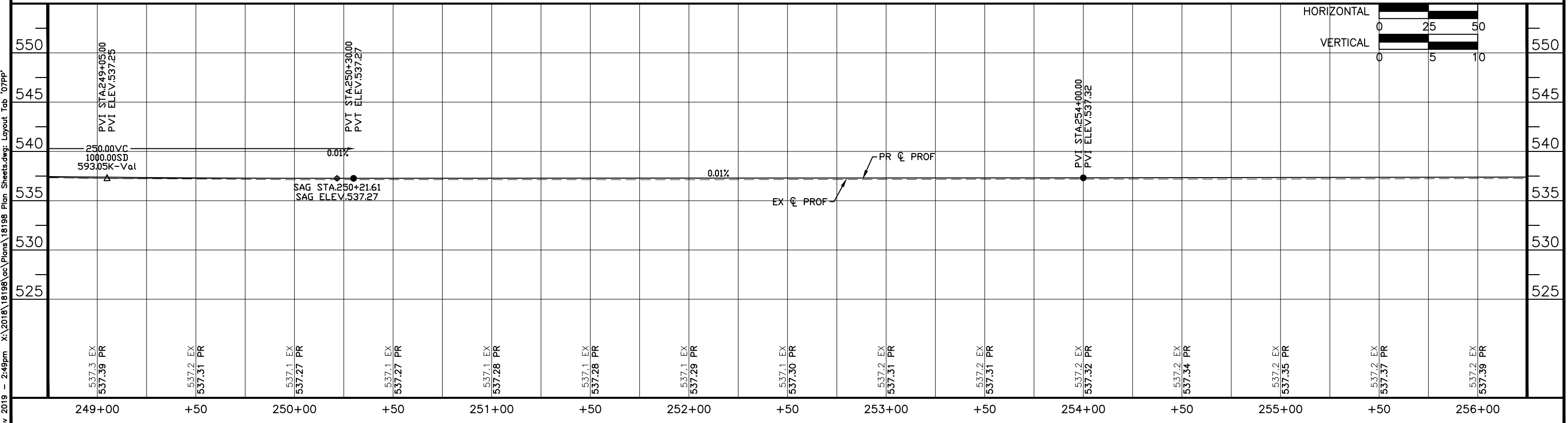

19 Nov 2019 - 2:48pm X:\2018\18198\18198\Plans\18198 Plan Sheets.dwg: Layout Tab '07PP'

GREENVILLE AIRPORT
IL PROJECT NO. GRE-4759
SBG NO. 3-17-SBGP-TBD
TAXIWAY B PLAN & PROFILE 4
SHEET 8 OF 15 | **GR010**



CONTROL POINT #2

STA 261+42.24

NORTH END BASELINE
 STA 264+00.00, 0.00' RT
 N: 792746.46
 E: 2521592.39

CONTROL POINTS				
CONTROL POINT #	NORTHING	EASTING	ELEVATION	DESCRIPTION
2	792595.07	2521742.61	538.13	NGS MON.

HORIZONTAL CURVE DATA
 $\Delta = 89^{\circ}58'26''$ LT PC STA = 259+12.20
 R = 67.50' PI STA = 259+79.66
 L = 106.00' PT STA = 260+18.19
 T = 67.47'

LEGEND	
	- PROPOSED BITUMINOUS PAVEMENT MILLING (AR401650)
	- PROPOSED VARIABLE DEPTH BITUMINOUS SURFACE COURSE, LEVELING (AR401620)
	- PROPOSED BITUMINOUS TACK COAT (AR603510)
	- PROPOSED 2" BITUMINOUS SURFACE COURSE OVERLAY (AR401613)
	- PROPOSED SHOULDER ADJUSTMENT (AR152480)
	- EXISTING RUNWAY/TAXIWAY LIGHT

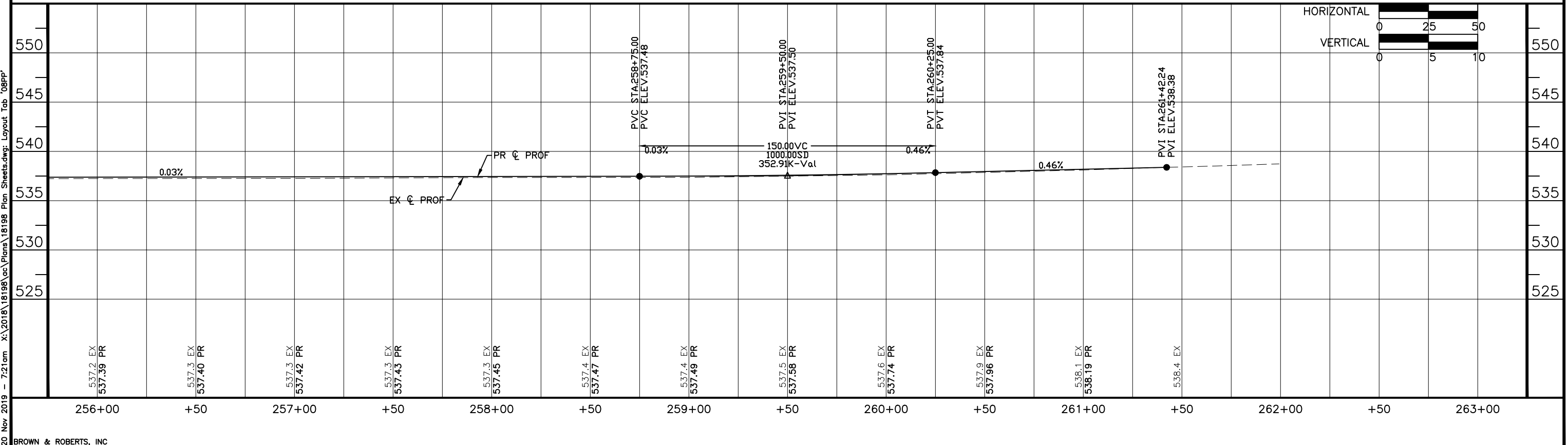
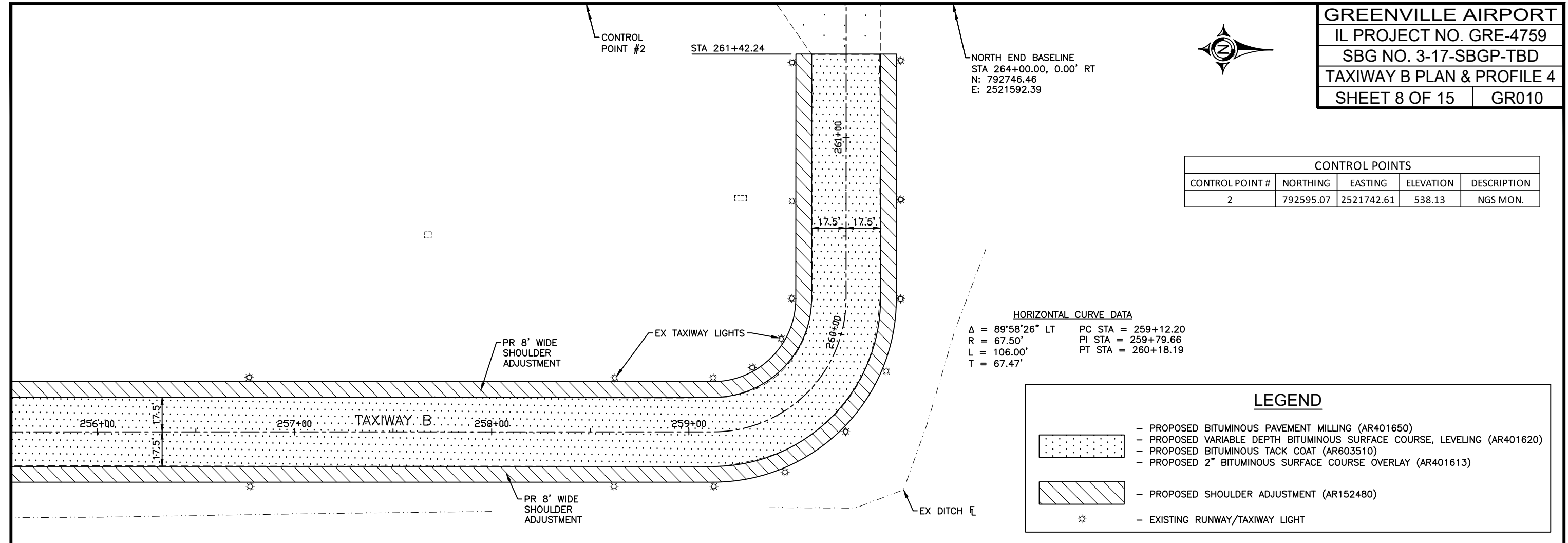

20 Nov 2019 - 7:21am X:\2018\18198\vac\Plans\18198 Plan Sheets.dwg: Layout Tab '08PP'

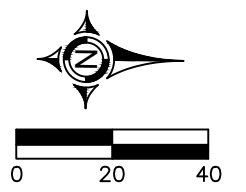

NOTE:
ELEVATIONS SHOWN ARE
PROPOSED FINISHED GRADES.

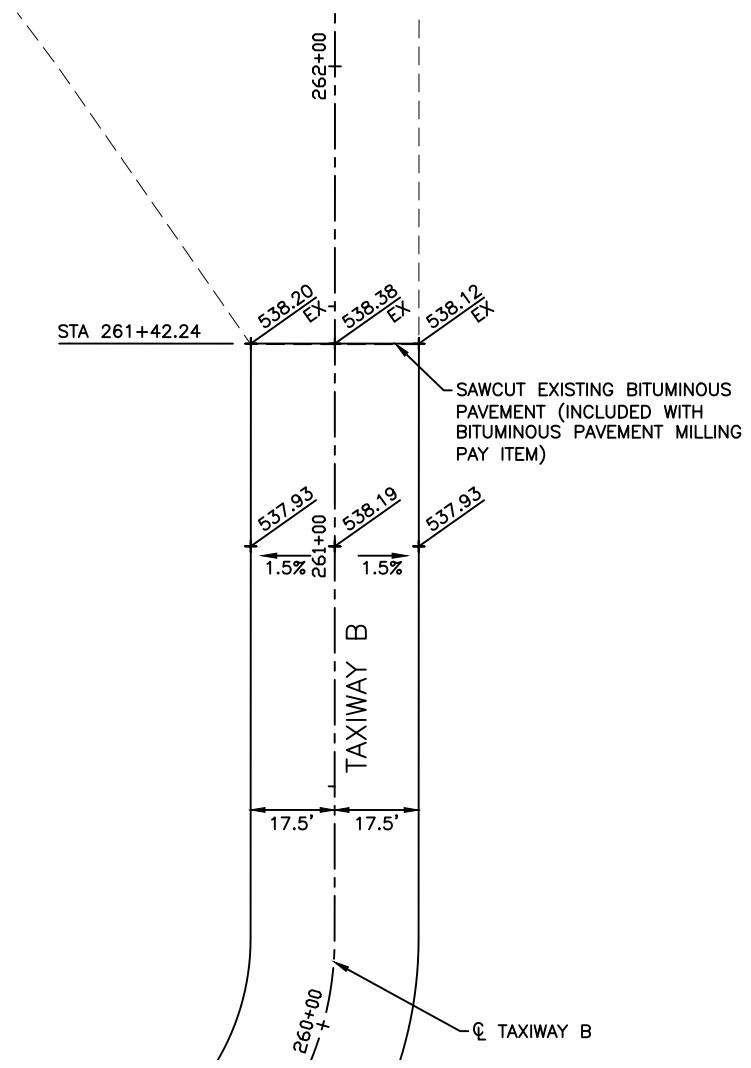
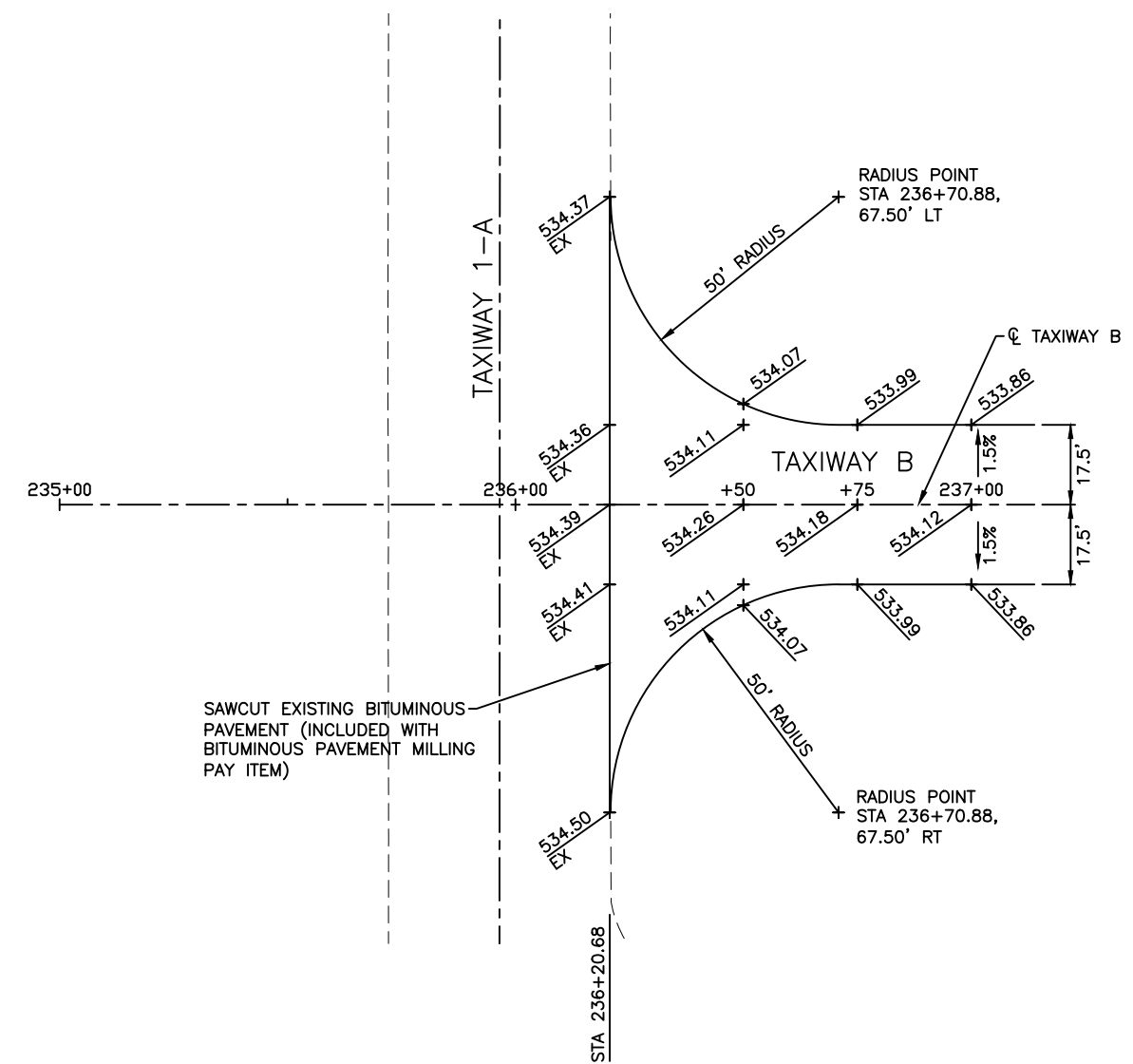

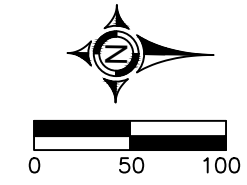

RUNWAY 18-36

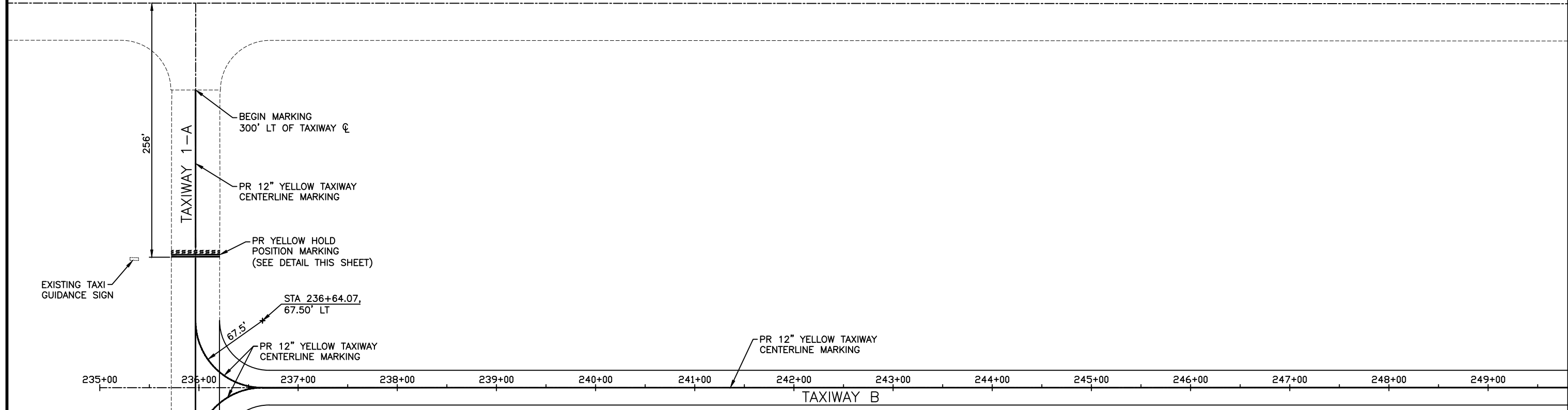

SEE DETAIL THIS SHEET FOR TAXIWAY CENTERLINE MARKINGS ON EXISTING PVMT

PAVEMENT MARKING - WATERBORNE SCHEDULE			
DESCRIPTION	UNIT AREA (SQ FT)	NO. REQ'D	TOTAL (SQ FT)
HOLD POSITION MARKING - TAXIWAY B (NORTH END)	106	1	106
HOLD POSITION MARKING - TAXIWAY 1-A	160	1	160
TAXIWAY B CENTERLINE	2679	1	2679
TAXIWAY 1-A CENTERLINE	615	1	615
TOTAL YELLOW WATERBORNE			3560

PAVEMENT MARKING - BLACK BORDER SCHEDULE			
DESCRIPTION	UNIT AREA (SQ FT)	NO. REQ'D	TOTAL (SQ FT)
HOLD POSITION MARKING - TAXIWAY B (NORTH END)	279	1	279
HOLD POSITION MARKING - TAXIWAY 1-A	390	1	390
TAXIWAY B CENTERLINE	118	1	118
TAXIWAY 1-A CENTERLINE	615	1	615
TOTAL BLACK BORDER			1402

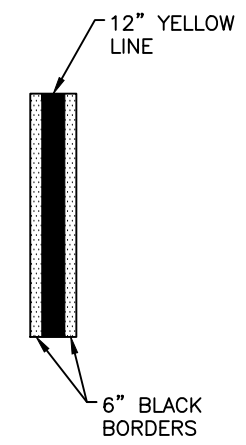

TAXIWAY CENTERLINE (ON EXISTING PAVEMENT)
N.T.S.

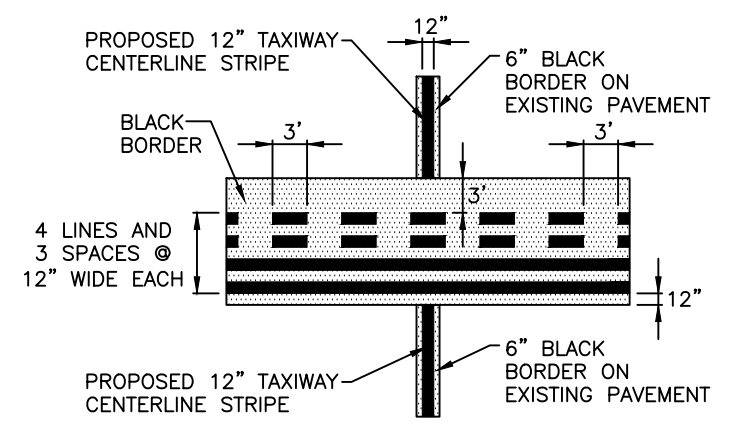

HOLD POSITION MARKING DETAIL TAXIWAY 1-A
N.T.S.

19 Nov 2019 - 2:51pm x:\2018\18198\oc\Plans\18198 Plan Sheets.dwg: Layout Tab '10 MARK 1'

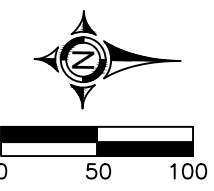

GREENVILLE AIRPORT	
IL PROJECT NO. GRE-4759	
SBG NO. 3-17-SBGP-TBD	
MARKING PLAN & DETAILS 2	
SHEET 11 OF 15	GR010

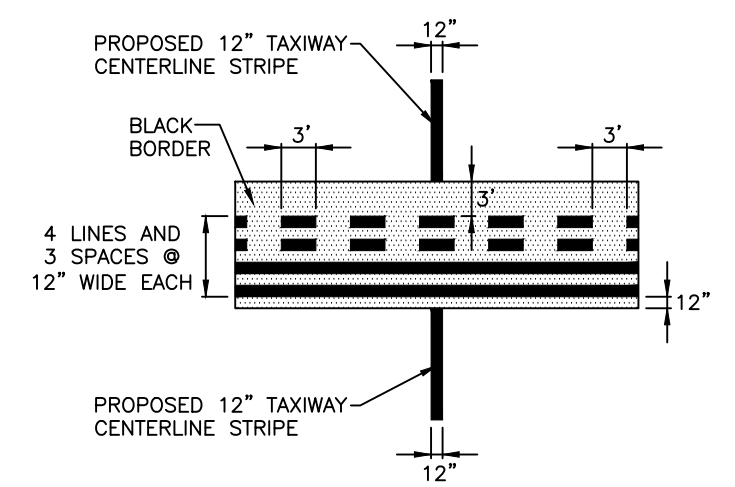
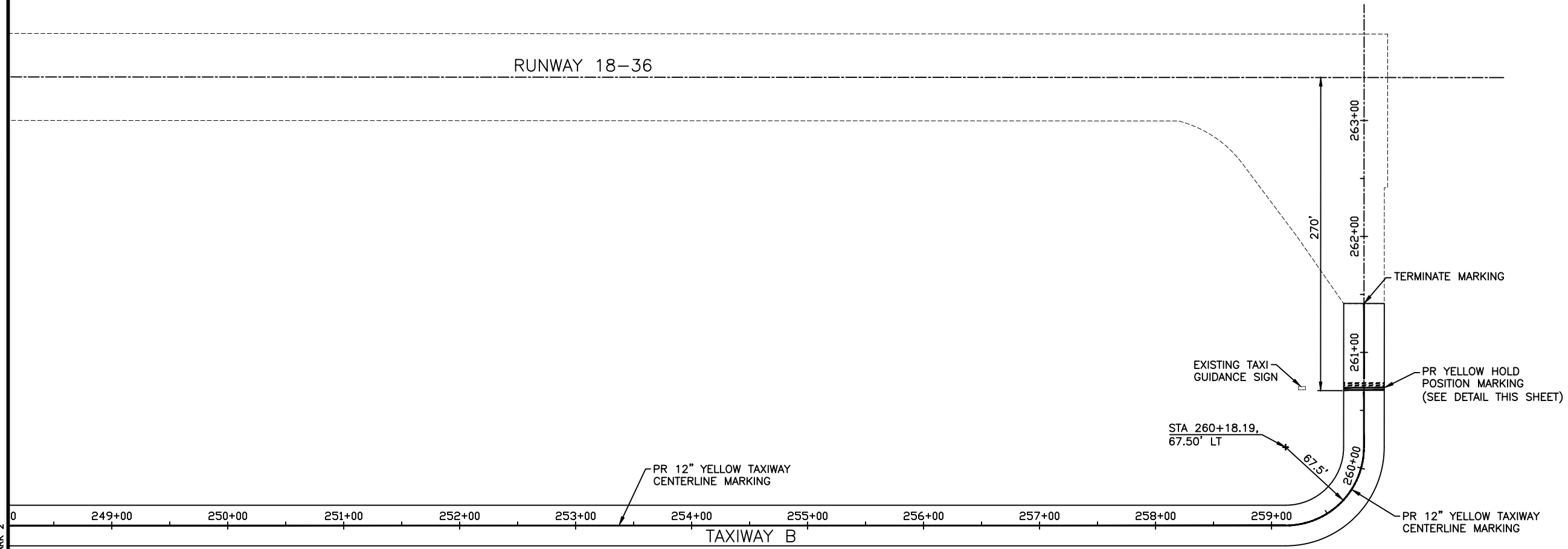

HOLD POSITION MARKING DETAIL
TAXIWAY B
N.T.S.

20 Nov 2019 - 7:22am x:\2018\18198\oc\Plans\18198 Plan Sheets.dwg: Layout Tab '11 MARK 2'

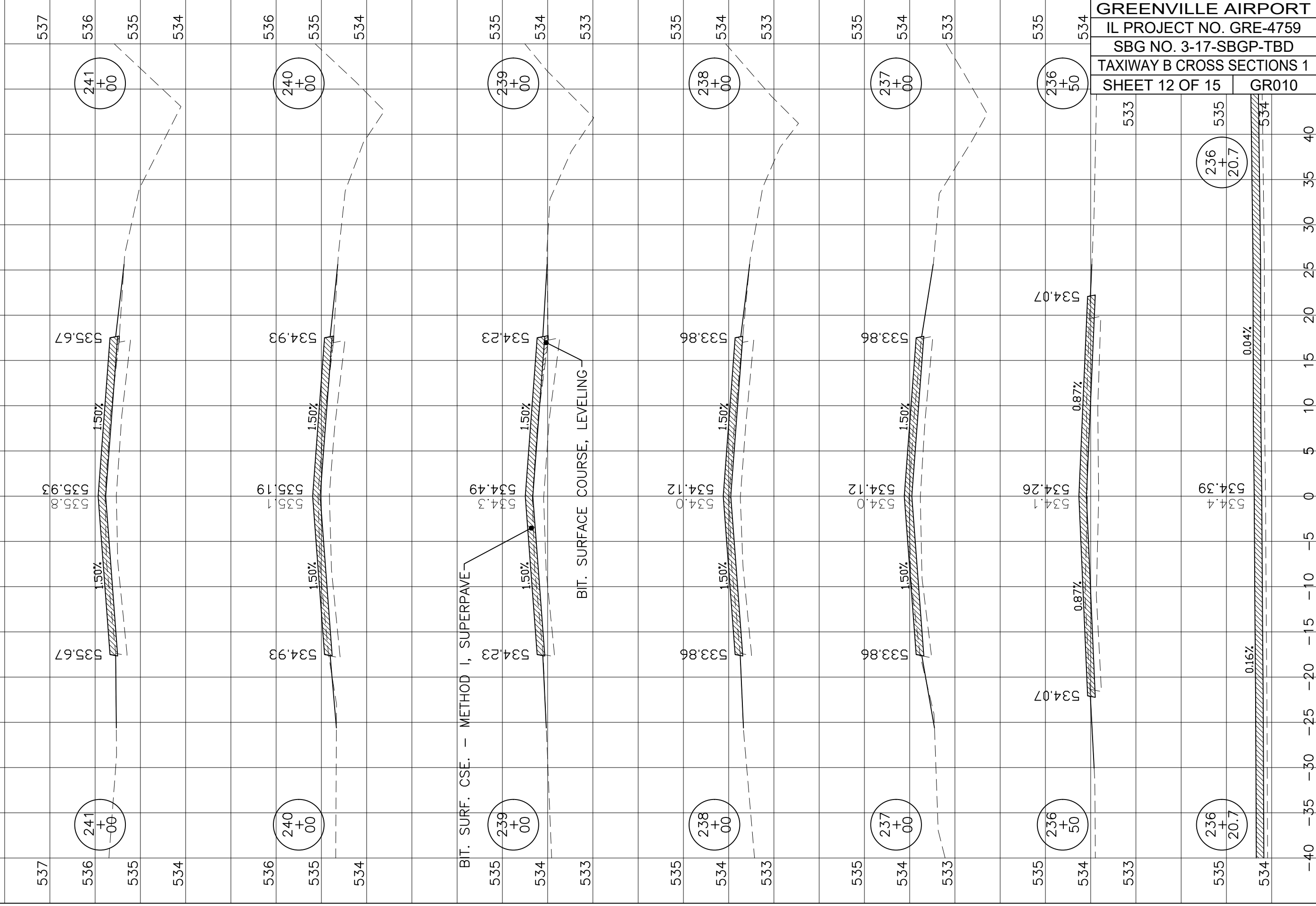
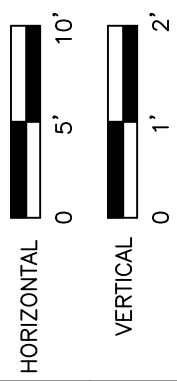

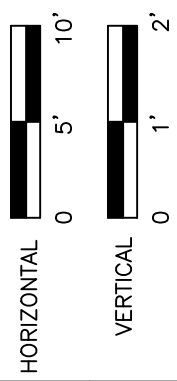

GREENVILLE AIRPORT
 IL PROJECT NO. GRE-4759
 SBG NO. 3-17-SBGP-TBD
 TAXIWAY B CROSS SECTIONS 2
 SHEET 13 OF 15 GR010

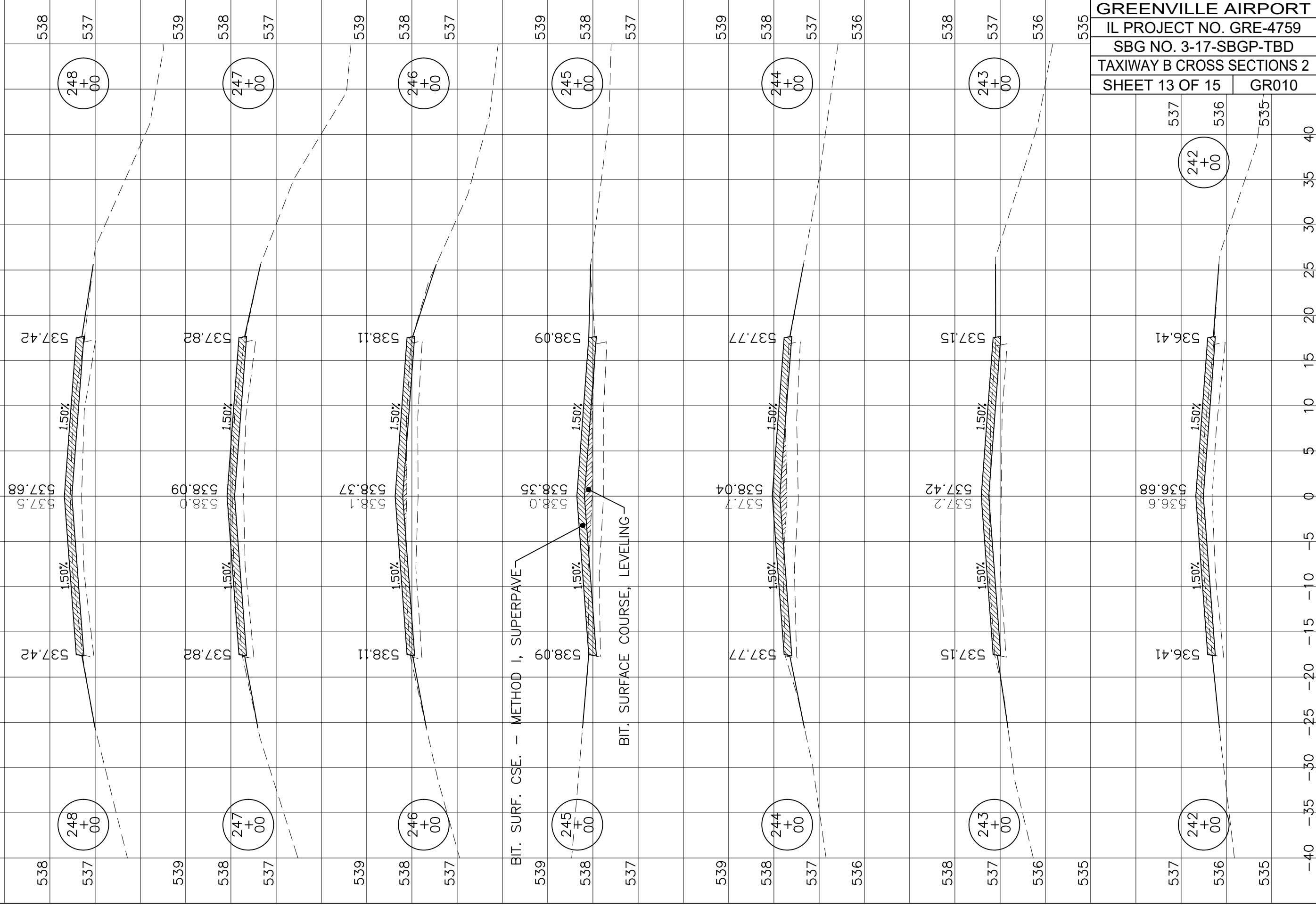

BIT. SURF. CSE. - METHOD I, SUPERPAVE

BIT. SURFACE COURSE, LEVELING

248
+
00

247
+
00

246
+
00

245
+
00

244
+
00

243
+
00

242
+
00

248
+
00

247
+
00

246
+
00

245
+
00

244
+
00

243
+
00

242
+
00

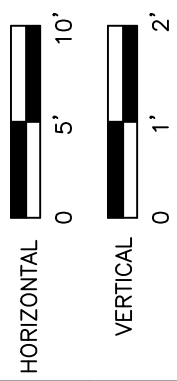

GREENVILLE AIRPORT
 IL PROJECT NO. GRE-4759
 SBG NO. 3-17-SBGP-TBD
 TAXIWAY B CROSS SECTIONS 3
 SHEET 14 OF 15 GR010

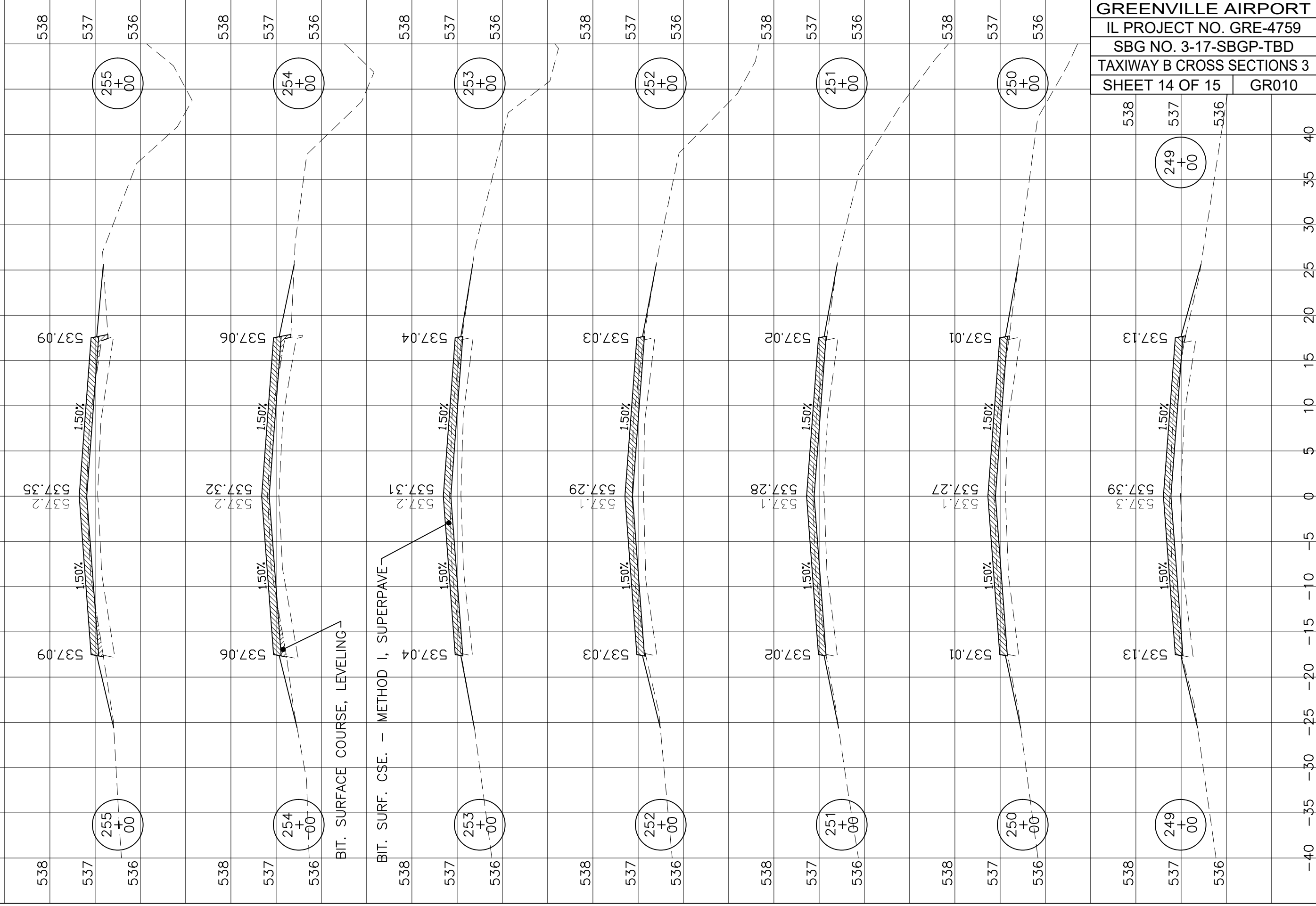

BIT. SURF. CSE. - LEVELING

BIT. SURF. CSE. - METHOD 1, SUPERPAVE

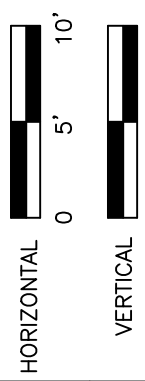

GREENVILLE AIRPORT
 IL PROJECT NO. GRE-4759
 SBG NO. 3-17-SBGP-TBD
 TAXIWAY B CROSS SECTIONS 4
 SHEET 15 OF 15 GR010

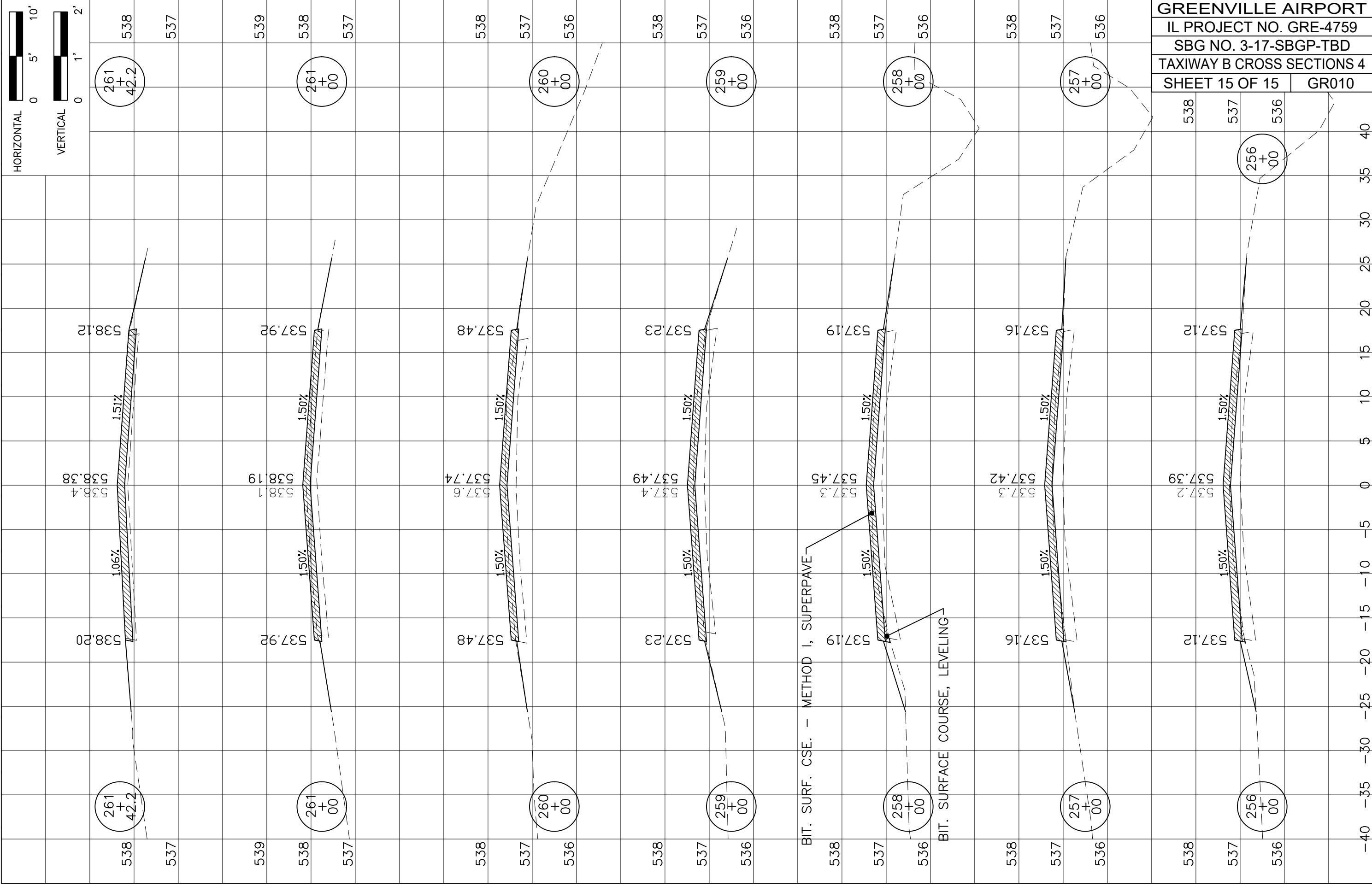

BIT. SURF. CSE. - METHOD I, SUPERPAVE

BIT. SURFACE COURSE, LEVELING

261
+
42.2

261
+
00

260
+
00

259
+
00

258
+
00

257
+
00

256
+
00

261
+
42.2

261
+
00

260
+
00

259
+
00

258
+
00

257
+
00

256
+
00