

SUMMARY OF QUANTITIES			CONSTRUCTION TYPE CODE	
CODE NO	ITEM	UNIT	TOTAL QUANTITIES	URBAN - 100% STATE
20201006	GRADING AND SHAPING SHOULDERS	UNIT	6	6
40600200	BITUMINOUS MATERIALS (PRIME COAT)	TON	34	34
40600300	AGGREGATE (PRIME COAT)	TON	152	152
40600400	MIXTURE FOR CRACKS, JOINTS, AND FLANGEWAYS	TON	23	23
40600895	CONSTRUCTING TEST STRIP	EACH	2	2
40600982	HOT-MIX ASPHALT SURFACE REMOVAL - BUTT JOINT	SQ YD	522	522
40601005	HOT-MIX ASPHALT REPLACEMENT OVER PATCHES	TON	596	596
40603595	POLYMERIZED HOT-MIX ASPHALT SURFACE COURSE, MIX "F", N90	TON	7629	7629
42001300	PROTECTIVE COAT	SQ YD	670	670
44000159	HOT-MIX ASPHALT SURFACE REMOVAL, 2 1/2"	SQ YD	75584	75584
44001700	COMBINATION CONCRETE CURB AND GUTTER REMOVAL AND REPLACEMENT	FOOT	2000	2000
44002212	HOT-MIX ASPHALT REMOVAL OVER PATCHES, 3"	SQ YD	4730	4730
<del>44201353</del>	<del>CLASS C PATCHES, TYPE II, 10 INCH</del>	<del>SQ YD</del>	<del>338</del>	<del>338</del>
<del>44201761</del>	<del>CLASS D PATCHES, TYPE I, 10 INCH</del>	<del>SQ YD</del>	<del>45</del>	<del>45</del>
<del>44201357</del>	<del>CLASS C PATCHES, TYPE III, 10 INCH</del>	<del>SQ YD</del>	<del>162</del>	<del>162</del>
44201765	CLASS D PATCHES, TYPE II, 10 INCH	SQ YD	2350	2350
44201769	CLASS D PATCHES, TYPE III, 10 INCH	SQ YD	815	815
44201771	CLASS D PATCHES, TYPE IV, 10 INCH	SQ YD	1520	1520
48102100	AGGREGATE WEDGE SHOULDER, TYPE B	TON	21	21
60252800	CATCH BASINS TO BE RECONSTRUCTED	EACH	7	7
60255500	MANHOLES TO BE ADJUSTED	EACH	27	27
60260100	INLETS TO BE ADJUSTED	EACH	4	4
60300105	FRAMES AND GRATES TO BE ADJUSTED	EACH	53	53
60300310	FRAMES AND LIDS TO BE ADJUSTED (SPECIAL)	EACH	43	43
60406000	FRAMES AND LIDS, TYPE 1, OPEN LID	EACH	10	10
60406100	FRAMES AND LIDS, TYPE 1, CLOSED LID	EACH	5	5
67000400	ENGINEER'S FIELD OFFICE, TYPE A	CAL MO	6	6
67100100	MOBILIZATION	L SUM	1	1
70100420	TRAFFIC CONTROL AND PROTECTION, STANDARD 701411	EACH	1	1

SUMMARY OF QUANTITIES			CONSTRUCTION TYPE CODE	
CODE NO	ITEM	UNIT	TOTAL QUANTITIES	URBAN 100% STATE
70102625	TRAFFIC CONTROL AND PROTECTION, STANDARD 701606	L SUM	1	1
70102630	TRAFFIC CONTROL AND PROTECTION, STANDARD 701601	L SUM	1	1
70102635	TRAFFIC CONTROL AND PROTECTION, STANDARD 701701	L SUM	1	1
<del>70103315</del>	<del>TRAFFIC CONTROL SURVEILLANCE</del>	<del>CAL DA</del>	<del>10</del>	<del>10</del>
70300100	SHORT-TERM PAVEMENT MARKING	FOOT	11841	11841
70300210	TEMPORARY PAVEMENT MARKING - LETTERS AND SYMBOLS	SQ FT	1092	1092
70300220	TEMPORARY PAVEMENT MARKING - LINE 4"	FOOT	22720	22720
70300240	TEMPORARY PAVEMENT MARKING - LINE 6"	FOOT	5342	5342
70300250	TEMPORARY PAVEMENT MARKING - LINE 8"	FOOT	4102	4102
70300260	TEMPORARY PAVEMENT MARKING - LINE 12"	FOOT	1475	1475
70300280	TEMPORARY PAVEMENT MARKING - LINE 24"	FOOT	659	659
70301000	WORK ZONE PAVEMENT MARKING REMOVAL	SQ FT	3947	3947
* 78000100	THERMOPLASTIC PAVEMENT MARKING - LETTERS AND SYMBOLS	SQ FT	1092	1092
* 78000200	THERMOPLASTIC PAVEMENT MARKING - LINE 4"	FOOT	22720	22720
* 78000400	THERMOPLASTIC PAVEMENT MARKING - LINE 6"	FOOT	5342	5342
* 78000500	THERMOPLASTIC PAVEMENT MARKING - LINE 8"	FOOT	4102	4102
* 78000600	THERMOPLASTIC PAVEMENT MARKING - LINE 12"	FOOT	1475	1475
* 78000650	THERMOPLASTIC PAVEMENT MARKING - LINE 24"	FOOT	659	659
* 78100100	RAISED REFLECTIVE PAVEMENT MARKER	EACH	960	960
78300200	RAISED REFLECTIVE PAVEMENT MARKER REMOVAL	EACH	900	900
* 88600600	DETECTOR LOOP REPLACEMENT	FOOT	1759	1759
X0322256	TEMPORARY INFORMATION SIGNING	SQ FT	102.8	102.8
X4067107	POLYMERIZED LEVELING BINDER (MACHINE METHOD), IL-4.75, N50	TON	3270	3270

11/5/2007

REVISIONS	
NAME	DATE

ILLINOIS DEPARTMENT OF TRANSPORTATION  
 ILL 19  
 SUMMARY OF QUANTITIES

Rev. 1-3-08 \*SPECIALTY ITEMS

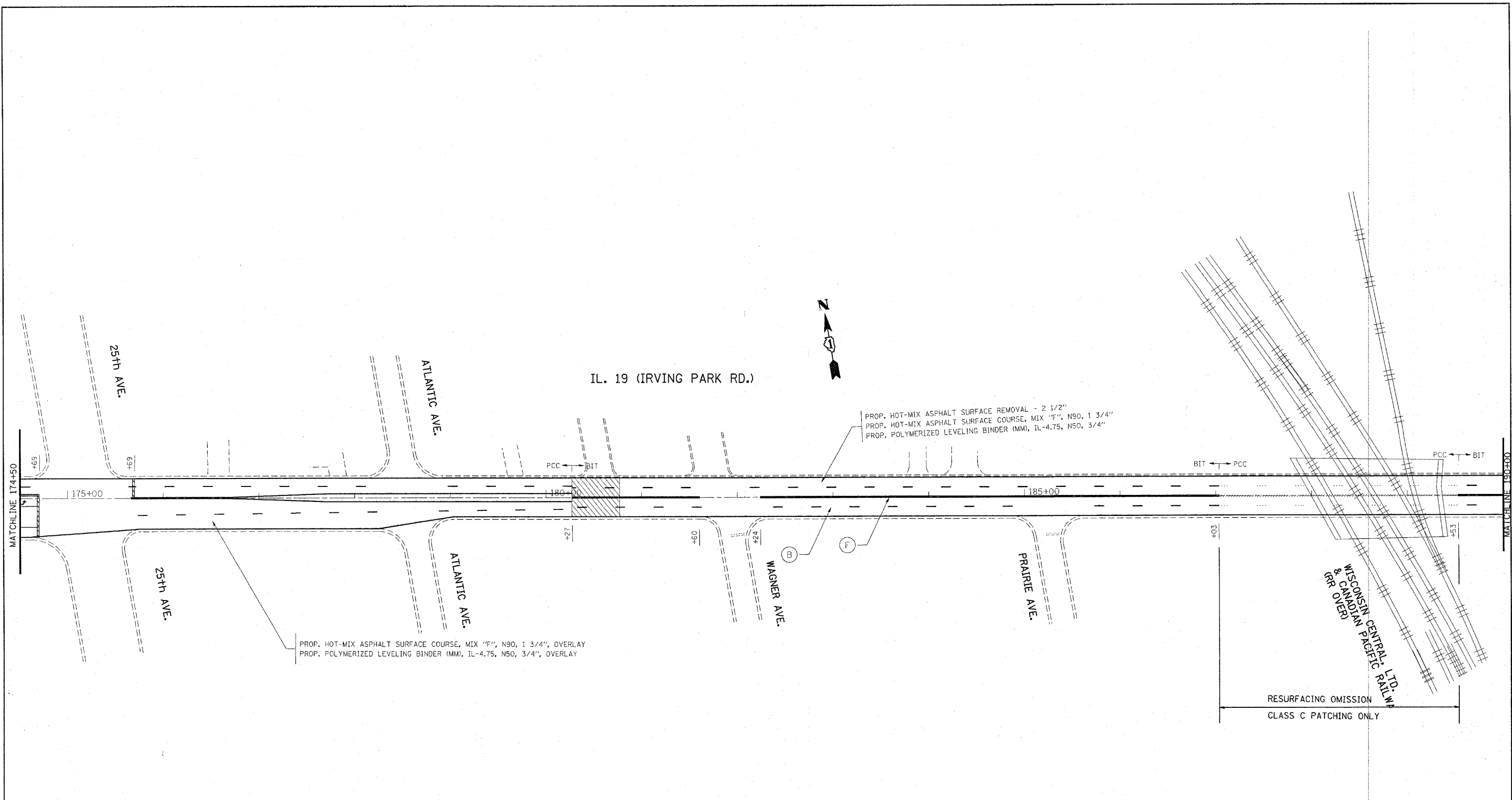

PROP. HOT-MIX ASPHALT SURFACE REMOVAL - 2 1/2"  
 PROP. HOT-MIX ASPHALT SURFACE COURSE, MIX "F", N90, 1 3/4"  
 PROP. POLYMERIZED LEVELING BINDER (MM), IL-4.75, N50, 3/4"

PROP. HOT-MIX ASPHALT SURFACE COURSE, MIX "F", N90, 1 3/4", OVERLAY  
 PROP. POLYMERIZED LEVELING BINDER (MM), IL-4.75, N50, 3/4", OVERLAY

- (A) 6" WHITE - TURN LANE LINE (TYP.)
- (B) 4" WHITE - SKIP-DASH LINE (TYP.) (10' LINE/30' SPACE)
- (C) 8' WHITE - LETTERS & SYMBOLS (TYP.) (LEFT TURN ONLY, RIGHT TURN ONLY)
- (D) 24" SOLID WHITE - STOP LINES (TYP.)
- (E) 6" WHITE - CROSSWALK LINE (TYP.) (2 @ 6' C-C)
- (F) 4" YELLOW - DOUBLE YELLOW PAINTED MEDIAN (TYP.) (2 @ 11" C-C)
- (G) 6" WHITE - DOTTED LINE (TYP.) (2' LINE/6' SPACE)
- (H) 8" WHITE - PAINTED MEDIAN (TYP.)
- (I) 12" WHITE - 45° DIAGONAL (75' C-C OR MINIMUM OF 5)
- (J) 4" WHITE - SOLID EDGE LINE (TYP.)
- (K) 4" YELLOW - SOLID EDGE LINE (TYP.)

*Rev. Sheet 1-3-08*

FILE NAME = c:\projects\dl23807\ah_rdy.dgn	USER NAME = qureshiya	DESIGNED -	REVISED -	<b>STATE OF ILLINOIS DEPARTMENT OF TRANSPORTATION</b>	SCALE: _____	SHEET NO. _____ OF _____ SHEETS	STA. 174+50 TO STA. 190+00										
PLOT SCALE = 50.0000' / IN.		DRAWN -		<table border="1" style="width: 100%; border-collapse: collapse;"> <tr> <td style="width: 10%;">F.A.P. RTE. 345</td> <td style="width: 20%;">SECTION 3058 (A,B,C) RS-1</td> <td style="width: 10%;">COUNTY COOK</td> <td style="width: 10%;">TOTAL SHEETS 51</td> <td style="width: 10%;">SHEET NO. 30</td> </tr> <tr> <td colspan="5" style="text-align: center;">CONTRACT NO. 60C52</td> </tr> </table>				F.A.P. RTE. 345	SECTION 3058 (A,B,C) RS-1	COUNTY COOK	TOTAL SHEETS 51	SHEET NO. 30	CONTRACT NO. 60C52				
F.A.P. RTE. 345	SECTION 3058 (A,B,C) RS-1	COUNTY COOK	TOTAL SHEETS 51					SHEET NO. 30									
CONTRACT NO. 60C52																	
PLOT DATE = 12/27/2007		CHECKED -		FED. ROAD DIST. NO. _____ ILLINOIS FED. AID PROJECT													
		DATE -															