

EXIST. CURVE E\_IL19-14  
 PI STA. = 142+69.47  
 $\Delta = 13^\circ 42' 24''$  (LT)  
 $D = 3^\circ 07' 51''$   
 $R = 1,830.00'$   
 $T = 219.94'$   
 $L = 437.79'$   
 $E = 13.17'$   
 $\theta = \text{---}$   
 T.R. =  $\text{---}$   
 S.E. RUN =  $\text{---}$   
 P.C. STA. = 140+49.53  
 P.T. STA. = 144+87.32

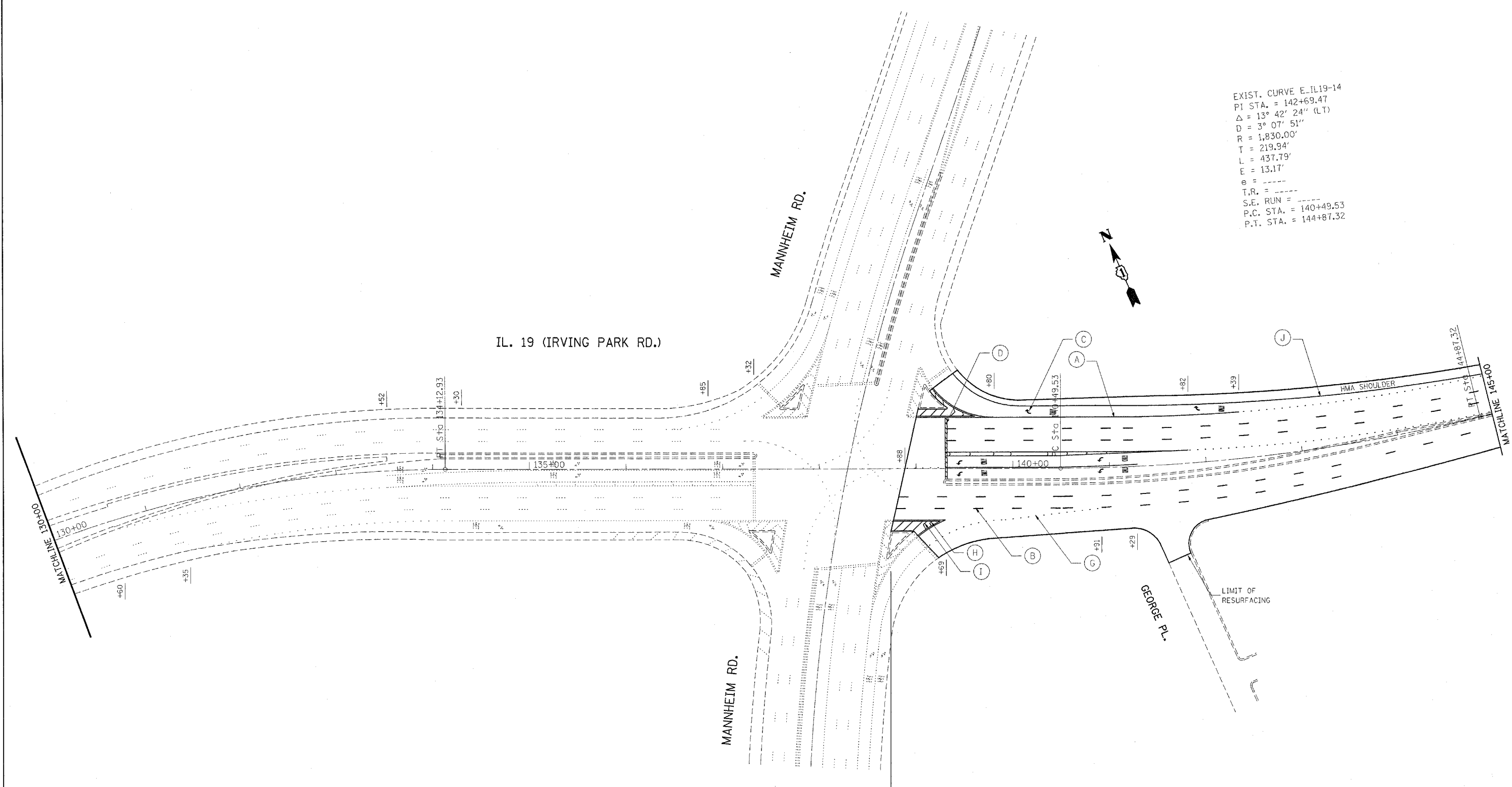

OMISSION

- (A) 6" WHITE - TURN LANE LINE (TYP.)
- (B) 4" WHITE - SKIP-DASH LINE (TYP.) (10' LINE/30' SPACE)
- (C) 8" WHITE - LETTERS & SYMBOLS (TYP.) (LEFT TURN ONLY, RIGHT TURN ONLY)
- (D) 24" SOLID WHITE - STOP LINES (TYP.)
- (E) 6" WHITE - CROSSWALK LINE (TYP.) (2 @ 6' C-C)
- (F) 4" YELLOW - DOUBLE YELLOW PAINTED MEDIAN (TYP.) (2 @ 11" C-C)
- (G) 6" WHITE - DOTTED LINE (TYP.) (2' LINE/6' SPACE)
- (H) 8" WHITE - PAINTED MEDIAN (TYP.)
- (I) 12" WHITE - 45° DIAGONAL (75' C-C OR MINIMUM OF 5)
- (J) 4" WHITE - SOLID EDGE LINE (TYP.)
- (K) 4" YELLOW - SOLID EDGE LINE (TYP.)

**STATE OF ILLINOIS  
 DEPARTMENT OF TRANSPORTATION**

FILE NAME = c:\projects\dl23807\ah_rdw.dgn	USER NAME = qureshya	DESIGNED -	REVISED -
		DRAWN -	REVISED -
		CHECKED -	REVISED -
		DATE -	REVISED -

SCALE:	SHEET NO. OF SHEETS	STA. 130+00 TO STA. 145+00	F.A.P. RTE. 345	SECTION 3058 (A,B,C) RS-1	COUNTY COOK	TOTAL SHEETS 51	SHEET NO. 27
			FED. ROAD DIST. NO. ILLINOIS FED. AID PROJECT				
			CONTRACT NO. 60C52				