

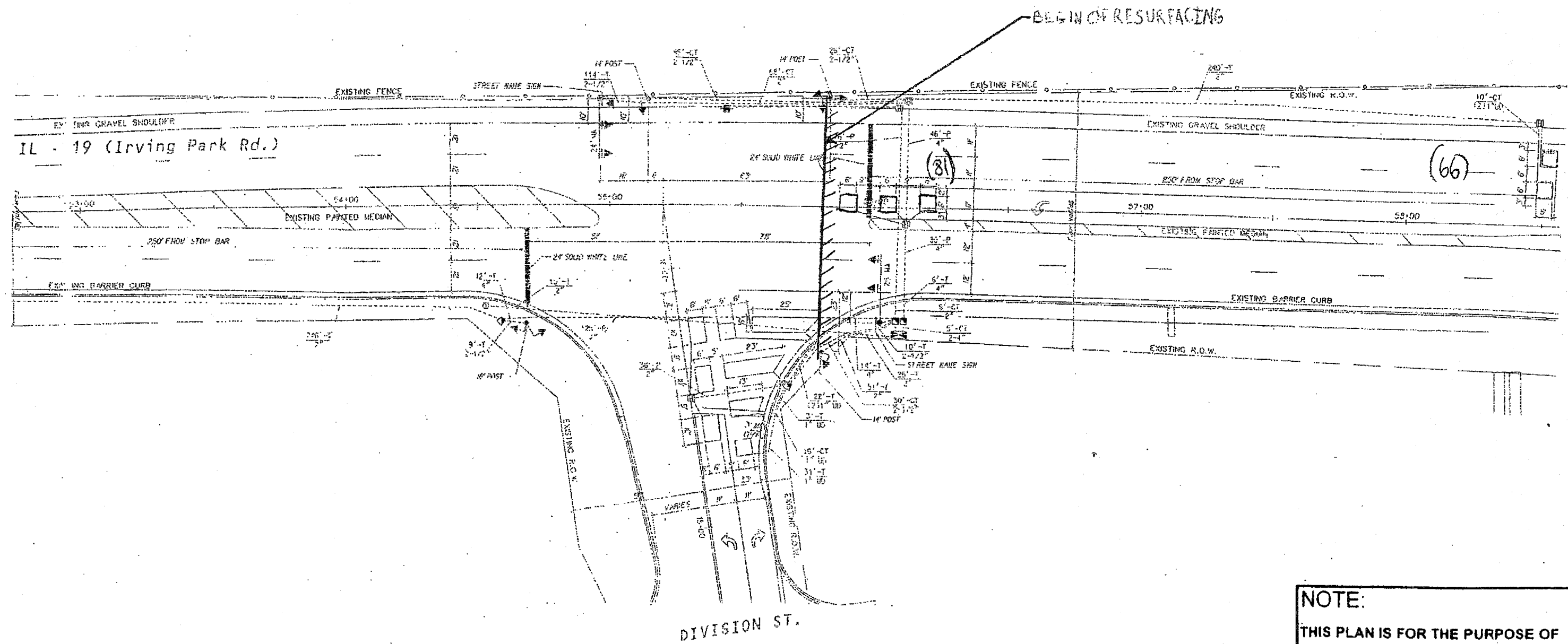

SCALE: 1"=20'



NOTE:
 THIS PLAN IS FOR THE PURPOSE OF REPLACING THE DETECTOR LOOPS ONLY. ALL OTHER INFORMATION SHOWN IS NOT RELATED AND WILL BE DISREGARDED.

REPLACE ALL DETECTOR LOOPS AS SHOWN
 (WITHIN THE RESURFACING LIMITS)

CODE NO.	QUANTITY	UNIT	ITEM
88600600	147	Foot	Detector Loop Replacement

REVISIONS	
NAME	DATE

ILLINOIS DEPARTMENT OF TRANSPORTATION
DETECTOR LOOP REPLACEMENT
 ILL. RTE 19 (IRVING PARK RD.) +
 DIVISION ST.
 SCALE: 1"=20'
 DATE: 02.17.07
 DRAWN BY: JHE
 DESIGNED BY: JHE
 CHECKED BY: DAI