

F.A.P. RTE.	SECTION	COUNTY	TOTAL SHEETS	SHEET NO.
351	2007-025-I	WILL.	18	6
STA.		TO STA.		
FED. ROAD DIST. NO.		ILLINOIS	FED. AID PROJECT	

CONTRACT NO. 60C93

NORTHWIND CONCRETE PRODUCTS
 LOCKPORT SHOP REPAIR FACILITY
 LOCKPORT POWERHOUSE MWRDGC
 ROCKS, ETC.



SCHEDULE

PAVEMENT MARKING TAPE, TYPE III 4"	
LOCATION	LENGTH
CANAL STREET	100'
IL. RTE. 53 - N.B. RT. TURN	300'
IL. RTE. 53 - S.B. LT. TURN	250'
TOTAL	650'

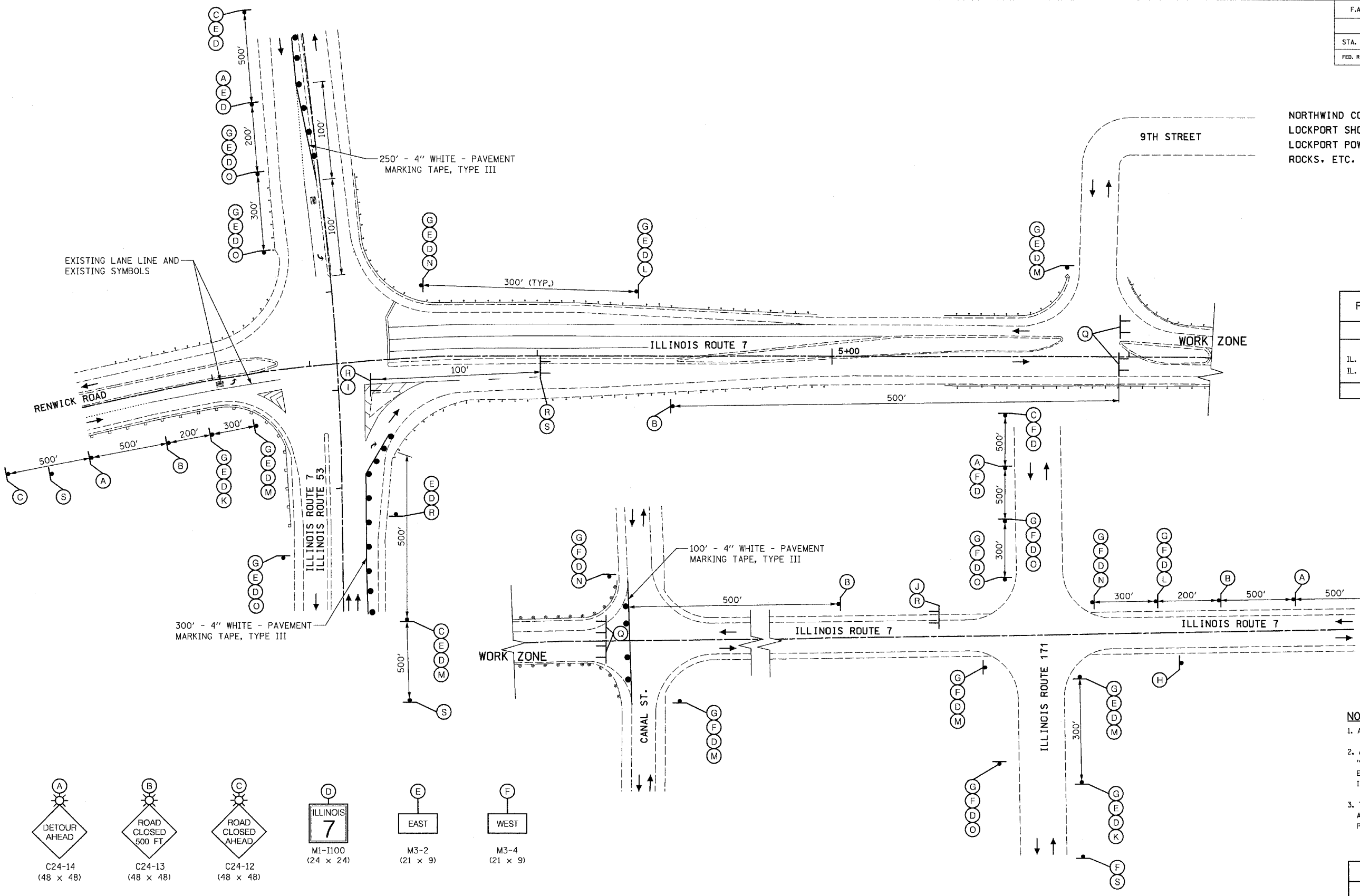

LEGEND

- TYPE III BARRICADES
- TEMPORARY SIGN
- TRAFFIC DIRECTION
- DRUMS/BARRICADES TYPE II WITH STEADY-BURN LIGHTS @ 25' C-C

NOTES:

1. ALL DIMENSIONS ARE SHOWN IN INCHES.
2. ALL DETOUR SIGNS ARE TO BE INCLUDED IN THE COST OF "TRAFFIC CONTROL AND PROTECTION FOR TEMPORARY DETOUR" EXCEPT FOR SIGN (S). SIGN (S) IS PAID FOR AS "TEMPORARY INFORMATION SIGNING."
3. THE TRAFFIC CONTROL AND PROTECTION AT ILLINOIS ROUTE 7 AND ILLINOIS ROUTE 53 SHALL BE INCLUDED IN THE LUMP SUM PRICE FOR "TEMPORARY CONTROL AND PROTECTION FOR DETOUR".

- | | | | | | |
|---------------------------|--------------------------|----------------------------|----------------------------|--------------------------|--------------------------|
|
C24-14
(48 x 48) |
C24-13
(48 x 48) |
C24-12
(48 x 48) |
M1-I100
(24 x 24) |
M3-2
(21 x 9) |
M3-4
(21 x 9) |
|
M4-8
(24 x 12) |
M4-8a
(24 x 18) |
M4-110(R)
(48 x 18) |
M4-110(L)
(48 x 18) |
M5-1(R)
(21 x 15) |
M5-1(L)
(21 x 15) |
|
M6-1(R)
(21 x 15) |
M6-1(L)
(21 x 15) |
M6-3
(21 x 15) |
R3-7(R)
(30 x 30) |
R11-2
(48 x 30) |
R11-4
(60 x 30) |
|
W21-I102
(60 x 30) | | | | | |

REVISIONS	
NAME	DATE

ILLINOIS DEPARTMENT OF TRANSPORTATION

DETOUR PLAN - DETAILS 1
IL. RTE. 7

SCALE: NONE
 DATE: NOVEMBER 13, 2007

DRAWN BY: D.L./F.M.
 CHECKED BY: B.N.S./S.J.P.

CHRISTIAN-ROGE & ASSOC., INC.
 CHICAGO ILLINOIS