

PROP. CURVE PALIMA-8  
 PI STA. = 481+11.45  
 $\Delta = 10^\circ 01' 04''$  (LT)  
 $D = 1^\circ 00' 05''$   
 $R = 5,721.92'$   
 $T = 501.50'$   
 $L = 1,000.45'$   
 $E = 21.94'$   
 $e = \dots$   
 $T.R. = \dots$   
 $S.E. RUN = \dots$   
 $P.C. STA. = 476+09.95$   
 $P.T. STA. = 486+10.40$

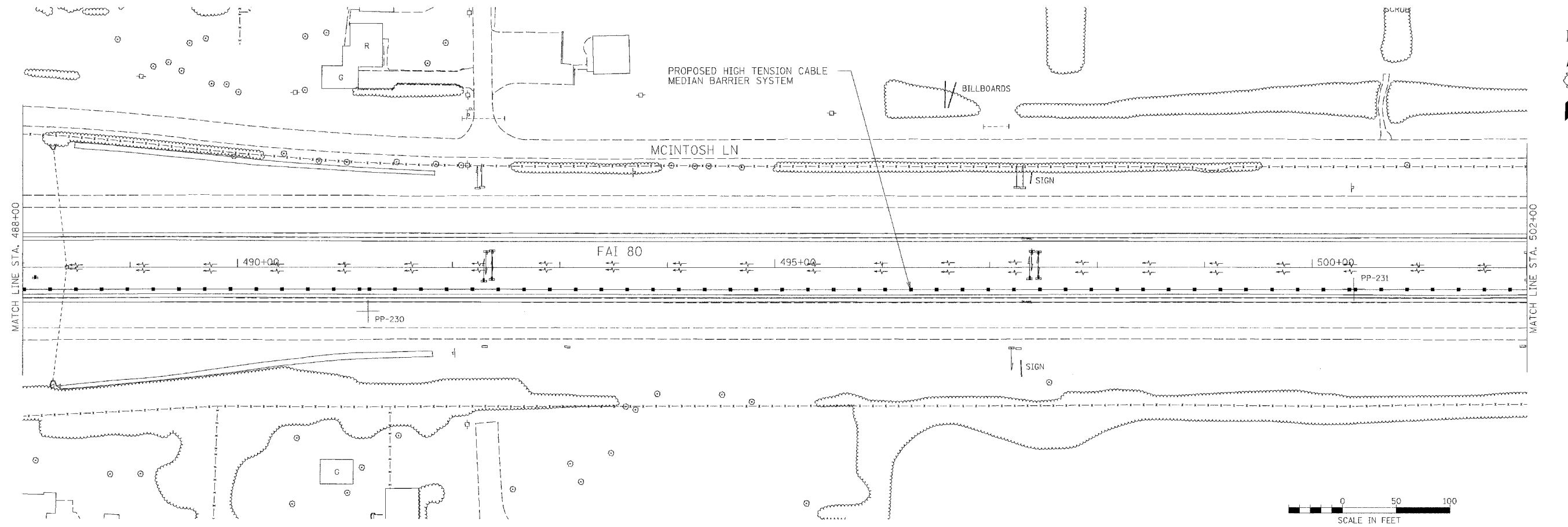

m:\jobs\2006\20063028-34\CAD\DOT1\_Trans\ dgn\00\FAI-80\_Plan16.dgn  
 11/7/2007 11:34:46 AM

FILE NAME =	USER NAME = .USER.	DESIGNED -	REVISED -
#FILE#		DRAWN - EAD	REVISED -
	PLOT SCALE = 50.0000' / IN.	CHECKED - PJ	REVISED -
	PLOT DATE = 11/7/2007	DATE - 11/07/2007	REVISED -

**STATE OF ILLINOIS  
 DEPARTMENT OF TRANSPORTATION**

<b>EXISTING AND PROPOSED ROADWAY PLANS</b>	
SCALE: 50	SHEET NO. 21 OF 28 SHEETS
STA.	TO STA.

F.A.I. RTE. 80	SECTION 2007-043 I	COUNTY WILL	TOTAL SHEETS 28	SHEET NO. 21
FED. ROAD DIST. NO.		ILLINOIS FED. AID PROJECT		
CONTRACT NO. 60D33				