

F.A.S. RTE.	SECTION	COUNTY	TOTAL SHEETS	SHEET NO.
1087	106T-1	STEPHENSON	78	26
STA. 963+00		TO STA. 975+00		
FED. ROAD DIST. NO.		ILLINOIS FED. AID PROJECT		

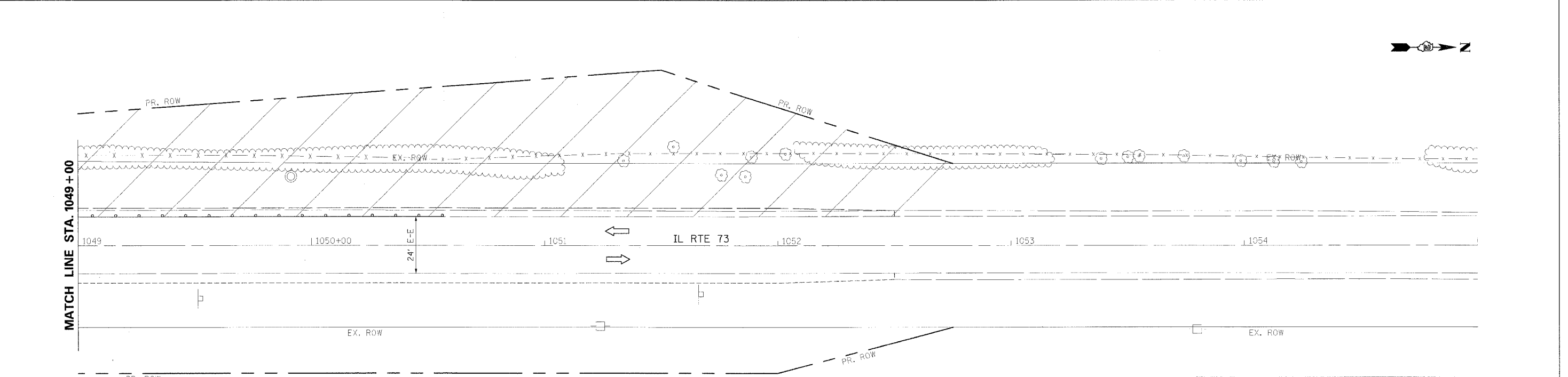

R10-6A-2430

SIGNS, RUMBLE STRIPS AND INDUCTION LOOP DETECTORS ACCORDING TO STANDARD 701321

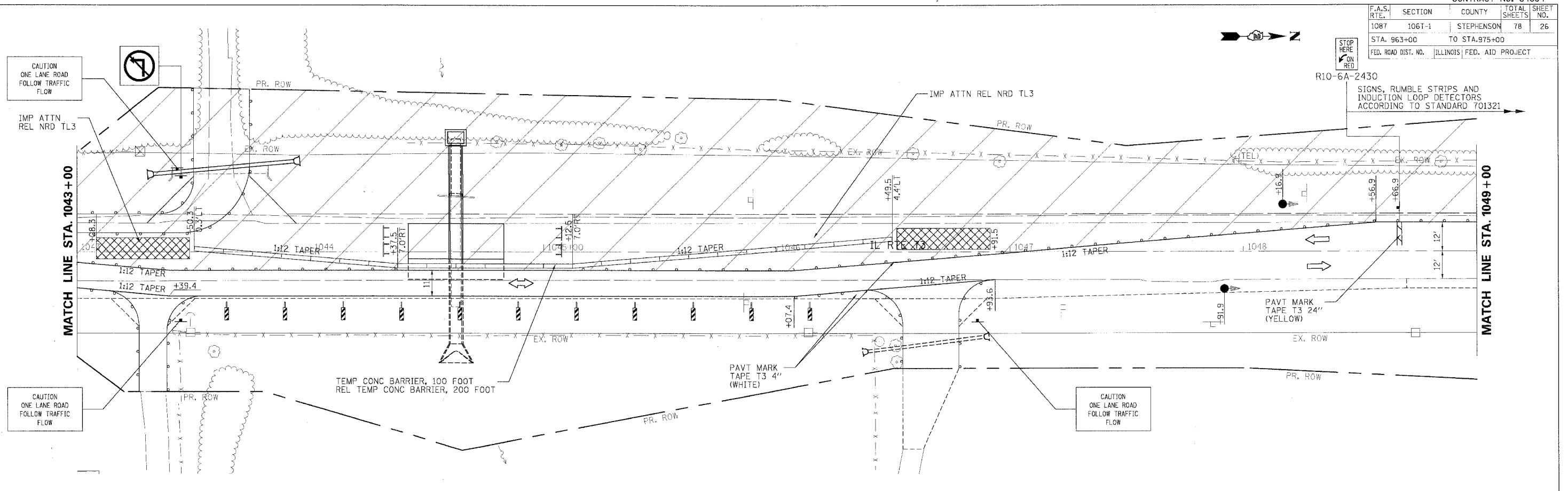

PLOT DATE = 08/25/07
 FILE NAME = 0810148
 USER NAME = 01058708

REVISIONS	
NAME	DATE

ILLINOIS DEPARTMENT OF TRANSPORTATION

MAINTENANCE OF TRAFFIC

IL RTE 73 CULVERT REPLACEMENTS
 STAGE 2 - SN 089-1108

SCALE: VERT.: N.A.
 HORIZ.: 1:20

DATE: OCTOBER 1, 2007

DRAWN BY: DLZ
 CHECKED BY: GB