

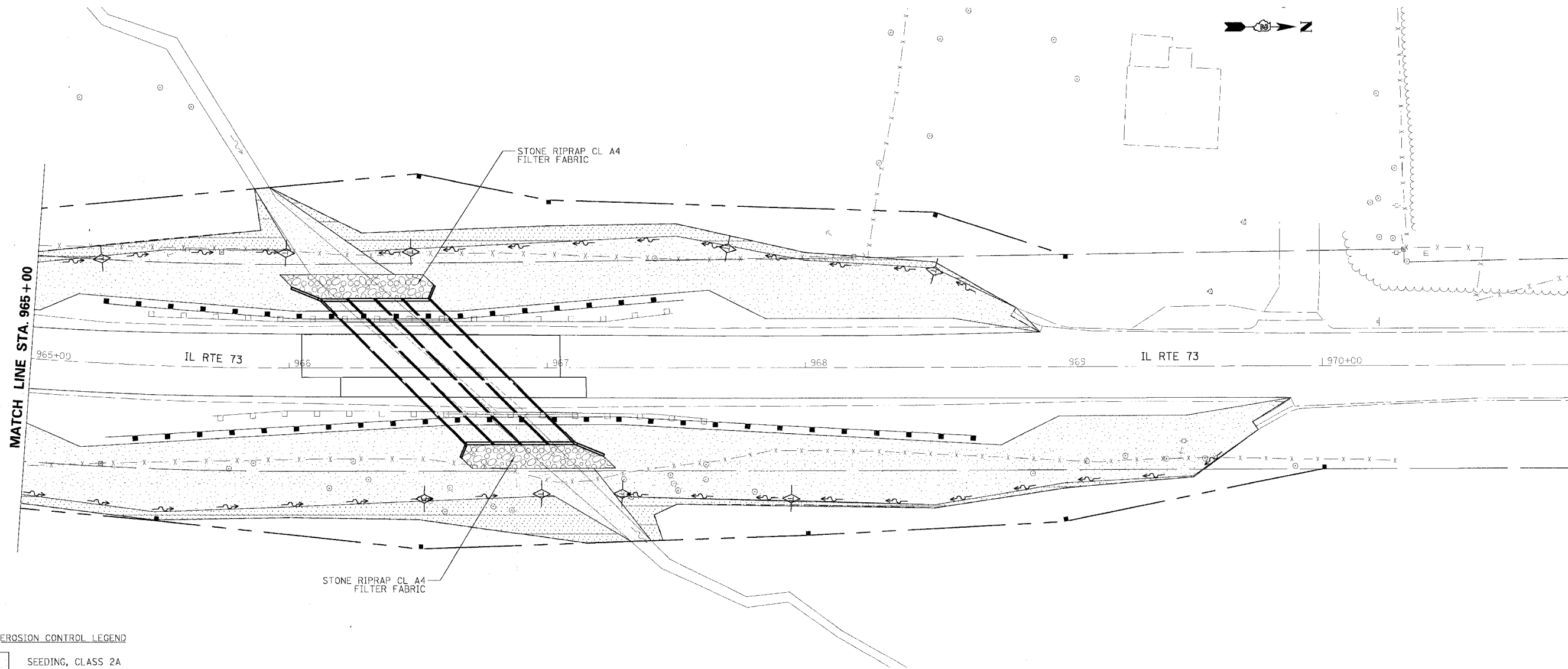



F.A.S. RTE.	SECTION	COUNTY	TOTAL SHEETS	SHEET NO.
10B7	106T-1	STEPHENSON	78	28
STA. 965+00		TO STA. 971+00		
FED. ROAD DIST. NO.	ILLINOIS	FED. AID PROJECT		

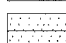
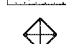
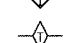
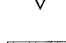

EROSION CONTROL LEGEND

-  SEEDING, CLASS 2A
-  SEEDING, CLASS 4
-  INLET AND PIPE PROTECTION
-  TEMPORARY DITCH CHECKS
-  PERIMETER EROSION BARRIER
-  PROPOSED DITCH FLOW



NOTE:
 EROSION CONTROL BLANKET SHALL BE USED ON ALL SLOPES STEEPER THAN 3:1 AND ON THE BOTTOM OF ALL DITCHES.
 MULCH, METHOD 2 SHALL BE USED WITH ALL OTHER SEEDING OPERATIONS.

REVISIONS	
NAME	DATE

ILLINOIS DEPARTMENT OF TRANSPORTATION
EROSION CONTROL PLAN
 IL RTE 73 CULVERT REPLACEMENTS
 SN 089-1109

SCALE: VERT. : N.A.
 HORIZ. : 1:20
 DATE : OCTOBER 1, 2007
 DRAWN BY: DLZ
 CHECKED BY: GB

PLOT DATE = 08/14/07
 FILE NAME = 081007.01
 PLOT SCALE = 1:20
 USER NAME = GB