

F.A.P. RTE.	SECTION	COUNTY	TOTAL SHEETS	SHEET NO.
313	(7BY)BR	HENDERSON	68	1
FED. ROAD DIST. NO.		ILLINOIS	FED. AID PROJECT	
D-94-033-01			* 68 + 1 = 69	

STATE OF ILLINOIS
DEPARTMENT OF TRANSPORTATION
DIVISION OF HIGHWAYS
PLANS FOR PROPOSED
FEDERAL AID HIGHWAY

F.A.P. ROUTE 313 (U.S. ROUTE 34)
 SECTION (7BY)BR
 PROJECT NO. BRF-0313(016)
 HENDERSON COUNTY
 C-94-043-01

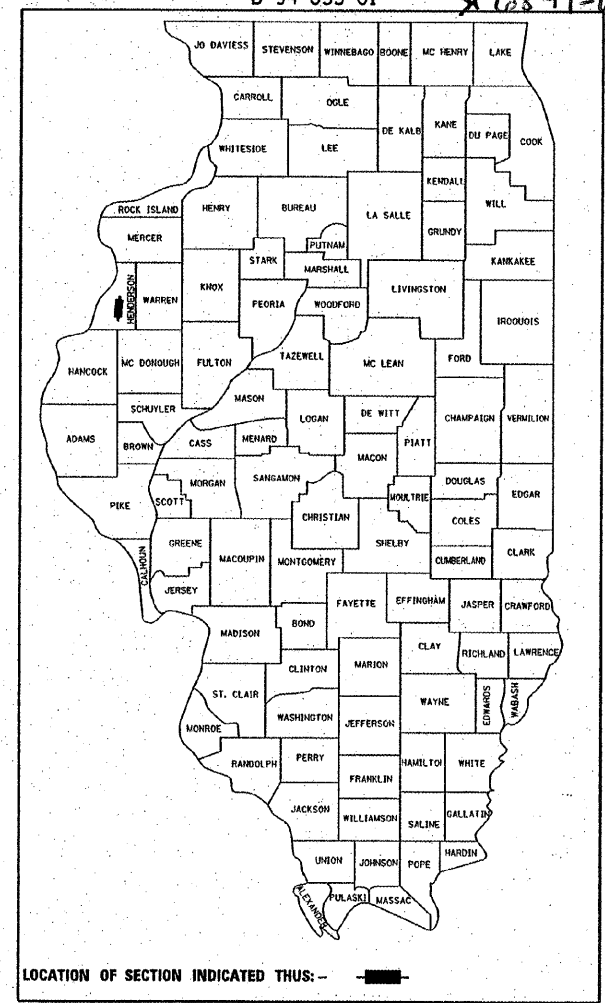

INDEX OF SHEETS

1. COVER SHEET
2. GENERAL NOTES AND COMMITMENTS AND MIXTURE REQUIREMENTS
3. STANDARDS AND UTILITIES STATUS
- 4.-4A. SUMMARY OF QUANTITIES
5. TYPICAL CROSS SECTIONS AND DETAILS
6. ENTRANCE DETAILS
- 7.-9. SCHEDULE OF QUANTITIES
10. ALIGNMENT TIES AND BENCHMARKS
11. PLAN AND PROFILE SHEET - MAINLINE
12. PLAN AND PROFILE SHEET - RUNAROUND
13. EROSION CONTROL PLAN AND NOTES
14. PAVEMENT MARKING PLAN
- 15.-35. STRUCTURE PLANS
- 36.-50. DISTRICT 4 CADD STANDARDS
- 51.-59. CROSS SECTIONS - RUNAROUND
- 60.-68. CROSS SECTIONS - MAINLINE

FOR LIST OF STANDARDS, SEE SHEET NO. 3

DESIGN DESIGNATION

OTHER PRINCIPAL ARTERIAL
 2000 ADT = 6300
 21 % TRUCKS
 POSTED SPEED 55 MPH

SCALES

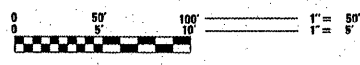

PROJECT ENGINEER: MAUREEN ADDIS

LIAISON ENGINEER: MIKE MOHAMED

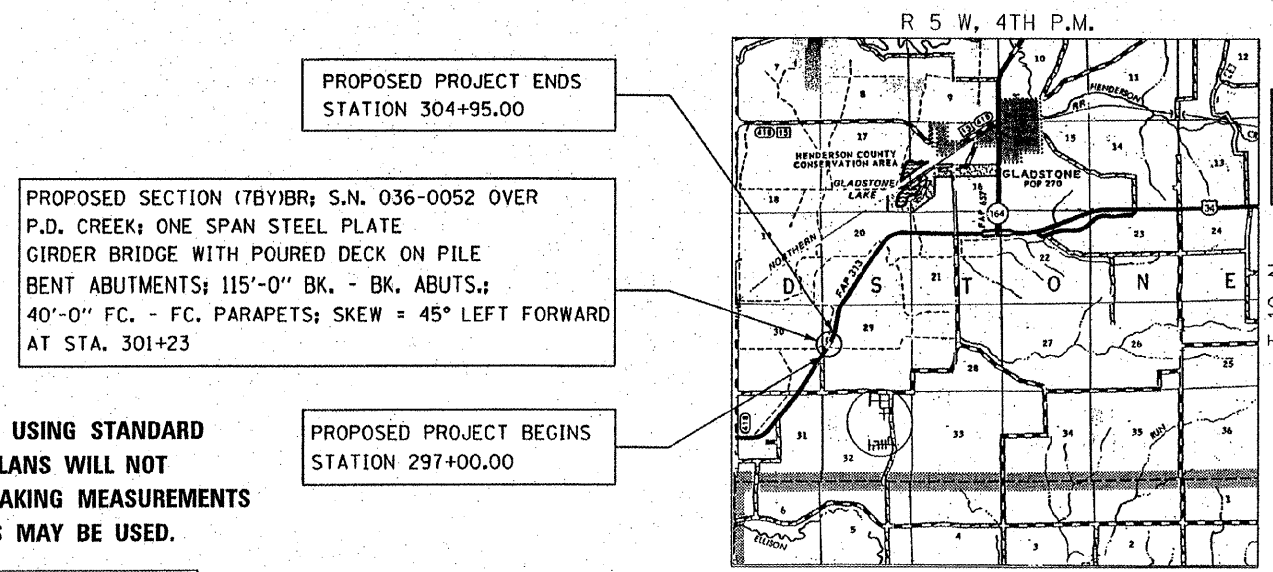

PROPOSED PROJECT ENDS
 STATION 304+95.00

PROPOSED SECTION (7BY)BR; S.N. 036-0052 OVER
 P.D. CREEK; ONE SPAN STEEL PLATE
 GIRDER BRIDGE WITH POURED DECK ON PILE
 BENT ABUTMENTS; 115'-0" BK. - BK. ABUTS.;
 40'-0" FC. - FC. PARAPETS; SKEW = 45° LEFT FORWARD
 AT STA. 301+23

PROPOSED PROJECT BEGINS
 STATION 297+00.00

THIS WORK INCLUDES THE REMOVAL AND REPLACEMENT
 OF P.D. CREEK STRUCTURE (SN 036-0002), RAISING
 EXISTING PROFILE APPROXIMATELY 2 FEET, AND OTHER
 APPROACH COLLATERAL WORK.

NPDES REQUIRED

FULL SIZE PLANS HAVE BEEN PREPARED USING STANDARD
 ENGINEERING SCALES, REDUCED SIZED PLANS WILL NOT
 CONFORM TO STANDARD SCALES, IN MAKING MEASUREMENTS
 ON REDUCED PLANS, THE ABOVE SCALES MAY BE USED.

J.U.L.I.E.
 JOINT UTILITY LOCATION INFORMATION FOR EXCAVATION
 1-800-892-0123
 www.julie1call.com

CONTRACT NO. 68149
CATALOG NO. 031941-00D

LAYOUT
 APPROXIMATE SCALE: 0 1 MILE

GROSS AND NET LENGTH OF SECTION	= 795.00 FEET	= 0.151 MILES
ROADWAY LENGTH	= 680.00 FEET	= 0.129 MILES
BRIDGE LENGTH	= 115.00 FEET	= 0.022 MILES

STATE OF ILLINOIS
 DEPARTMENT OF TRANSPORTATION
 DIVISION OF HIGHWAYS

SUBMITTED Oct 18, 2007
[Signature]
 DEPUTY DIRECTOR OF HIGHWAYS, REGION 2 ENGINEER

December 7, 2007
[Signature]
 ENGINEER OF DESIGN AND ENVIRONMENT

December 7, 2007
[Signature]
 DIRECTOR OF HIGHWAYS, CHIEF ENGINEER

PRINTED BY THE AUTHORITY
 OF THE STATE OF ILLINOIS

DATE: 9/26/2007
 BY: [Signature]
 LICENSE EXPIRES: NOVEMBER 30, 2007

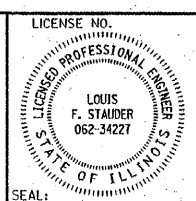

HAMPTON, LENZINI & RENWICK, INC.
 CIVIL & STRUCTURAL ENGINEERS

3085 STEVENSON DRIVE, SUITE 201
 SPRINGFIELD, ILLINOIS 62703
 (217) 546-3400

ELGIN • SPRINGFIELD

PROJECT NUMBER: 12-44-0001-X DATE: 08/07/07