

F.A. RTE.	SECTION	COUNTY	TOTAL SHEETS	SHEET NO.
VAR	*	**	24	3
STA.	TO STA.			
FED. ROAD DIST. NO.	ILLINOIS	FED. AID PROJECT		

- D5 CRACK & JOINT SEAL 2008-2
- ** CHAMPAIGN, DOUGLAS & EDGAR

LOCATION MAP #1 IL 1, FROM EDGAR COUNTY LINE TO SOUTH OF PARIS

EDGAR COUNTY /RURAL 2 – LANE

SECTION D5 CRACK & JOINT SEAL 2008-2
ENDS @ STATION 694+63.00

SECTION D5 CRACK & JOINT SEAL 2008-2
BEGINS @ STATION 212+85.00

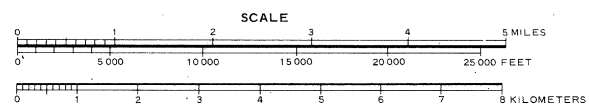
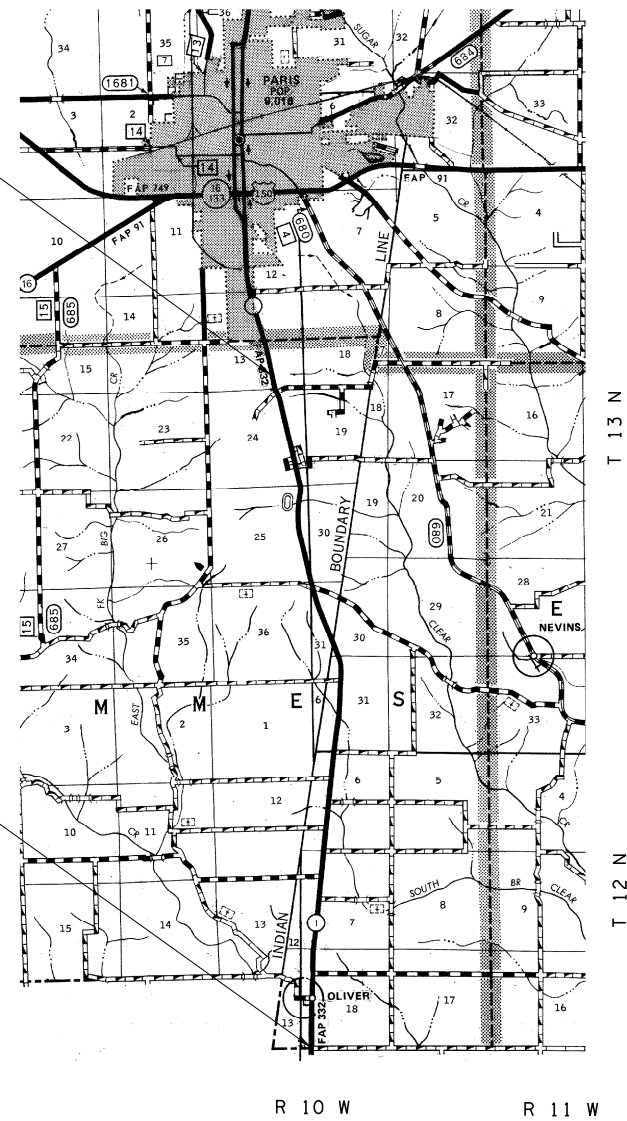

TOTAL LENGTH OF SECTION = 48,178.00 FT. = 9.125 MILES
NET LENGTH OF SECTION = 48,178.00 FT. = 9.125 MILES

PLOT DATE = 10/15/2007
 FILE NAME = G:\projects\050307 (v8)\70659\sheet1.dgn
 USER = COLLIERD
 USER NAME = COLLIERD



LOCATION MAP #2 F.A.I. 57, FROM NORTH OF RANTOUL TO FORD COUNTY LINE

CHAMPAIGN COUNTY /RURAL MULTI – LANE

SECTION D5 CRACK & JOINT SEAL 2008-2
ENDS @ STATION 1649+18.87

STATION EQUATION:
 STATION 1502+40.24 (BK.) =
 STATION 1502+35.17 (AH.)

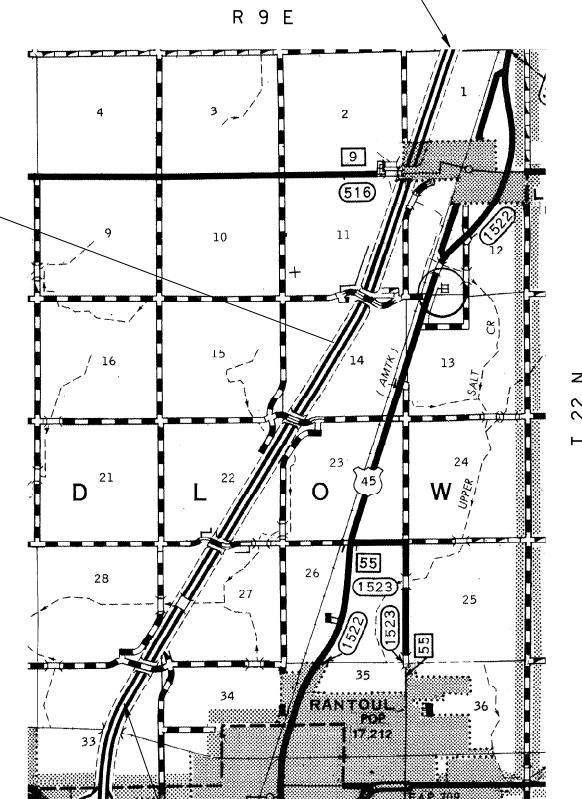

SECTION D5 CRACK & JOINT SEAL 2008-2
BEGINS @ STATION 1339+26.00

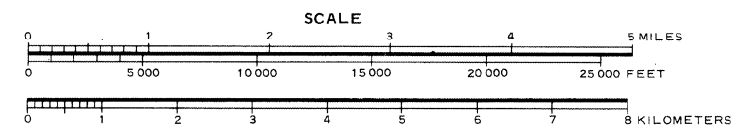

TOTAL LENGTH OF SECTION = 30,997.94 FT. = 5.871 MILES
NET LENGTH OF SECTION = 30,997.94 FT. = 5.871 MILES



ILLINOIS DEPARTMENT OF TRANSPORTATION
LOCATION MAPS
 D5 CRACK & JOINT SEAL 2008-2
 CHAMPAIGN, DOUGLAS & EDGAR COUNTIES
 SHEET 1 OF 4
 SCALE: DRAWN BY: B.B.P.
 DATE: 08/03/07 CHECKED BY: M.L.B.