

BAR LIST - PER ABUTMENT - STR #026-0049

BAR	NUMBER OF BARS		TOTAL	SIZE	LENGTH	SHAPE
	STAGE I	STAGE II				
a(E)	12	12	24	5	17'-10"	—
a1(E)	5	5	10	6	4'-0"	—
h(E)	3	3	6	6	17'-6"	—
x(E)	17	17	34	5	3'-3"	┌
d(E)	5	5	8	4	4'-11"	└
d1(E)	5	5	8	5	4'-2"	└
Concrete Removal				CU YD	5.7	
REINFORCEMENT BARS (EPOXY COATED)				POUND	815	
CONCRETE SUPERSTRUCTURE				CU YD	6.6	

REINFORCEMENT BARS DESIGNATED (E) SHALL BE EPOXY COATED

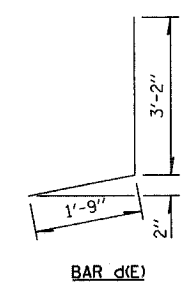
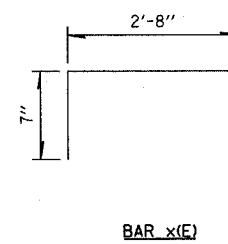
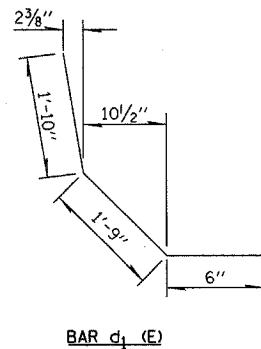
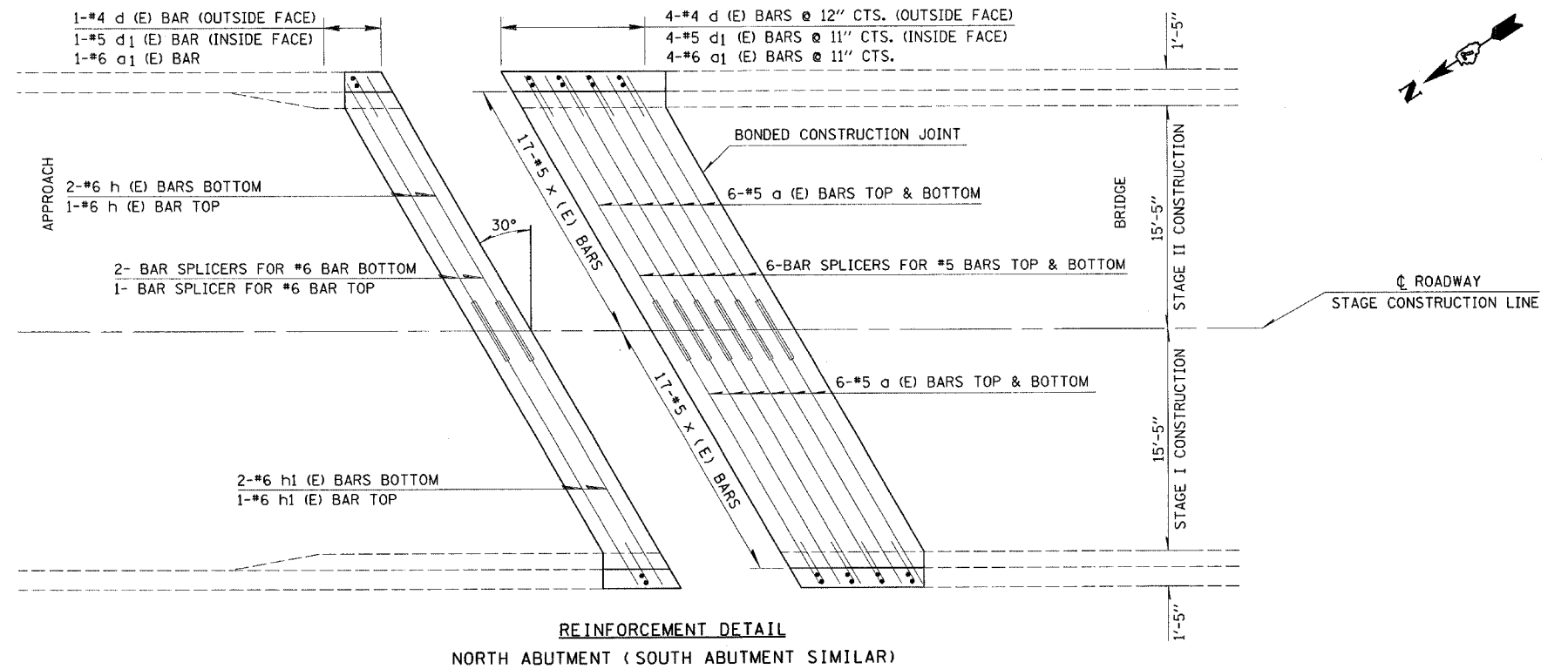

NOTE: EXISTING REINFORCEMENT BARS ARE TO BE CLEANED, STRAIGHTENED AND INCORPORATED INTO THE NEW CONSTRUCTION. ANY REINFORCEMENT BARS THAT ARE DAMAGED DURING CONCRETE REMOVAL OPERATIONS SHALL BE REPAIRED OR REPLACED USING AN APPROVED BAR SPLICER OR ANCHORAGE SYSTEM (COST INCLUDED IN CONCRETE REMOVAL).