

IMPROVEMENT BEGINS
STA. 220+84.60

MATCH LINE STA. 225+50
(SEE SHEET NO. 31)

LEGEND



NOTES:

1. ADDITIONAL GUTTER WIDTH FOR STUB SHALL BE INCLUDED IN COST OF "COMBINATION CONCRETE CURB & GUTTER, TYPE M-2.12".
2. ADDITIONAL WIDTH FOR STUB SHALL BE INCLUDED IN COST OF "CONCRETE MEDIAN, TYPE C-4".
3. SEE TYPICAL SECTIONS AND CCHD DETAIL (SHEET NO. 122) FOR LOCATIONS OF PROPOSED TIE BARS.

PLUM GROVE ROAD

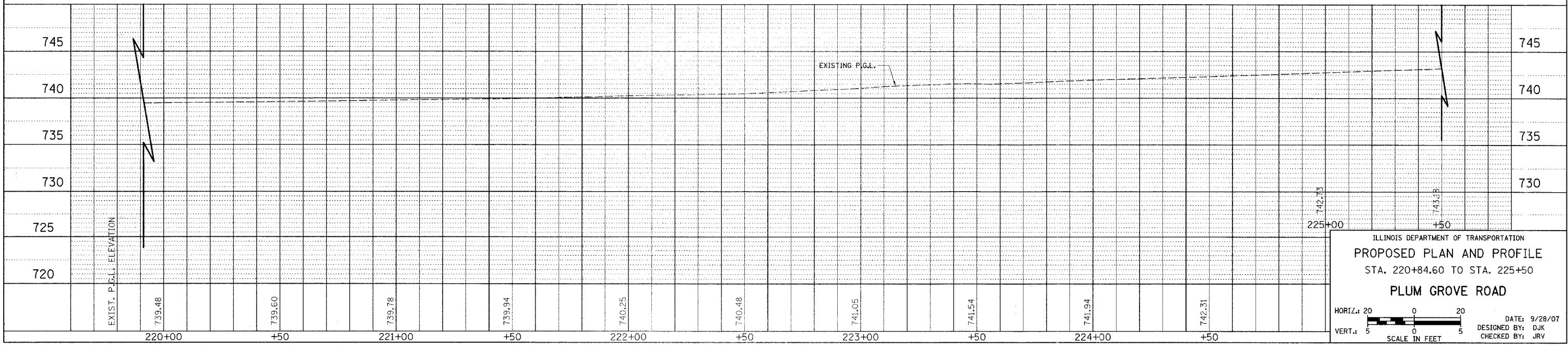

ILLINOIS DEPARTMENT OF TRANSPORTATION
PROPOSED PLAN AND PROFILE
 STA. 220+84.60 TO STA. 225+50
PLUM GROVE ROAD

HORIZ.: 20' SCALE IN FEET
 VERT.: 5' SCALE IN FEET

DATE: 9/28/07
 DESIGNED BY: DJK
 CHECKED BY: JRV