

F.A.U. RTE.	SECTION	COUNTY	TOTAL SHEETS	SHEET NO.
2993	05-00094-00-WR	DUPAGE	67	46
STA. 111+00		TO STA. 122+00		
FED. ROAD DIST. NO. 1   ILLINOIS   FED. AID PROJECT				
PROJECT NO.: M-8003 (707)				

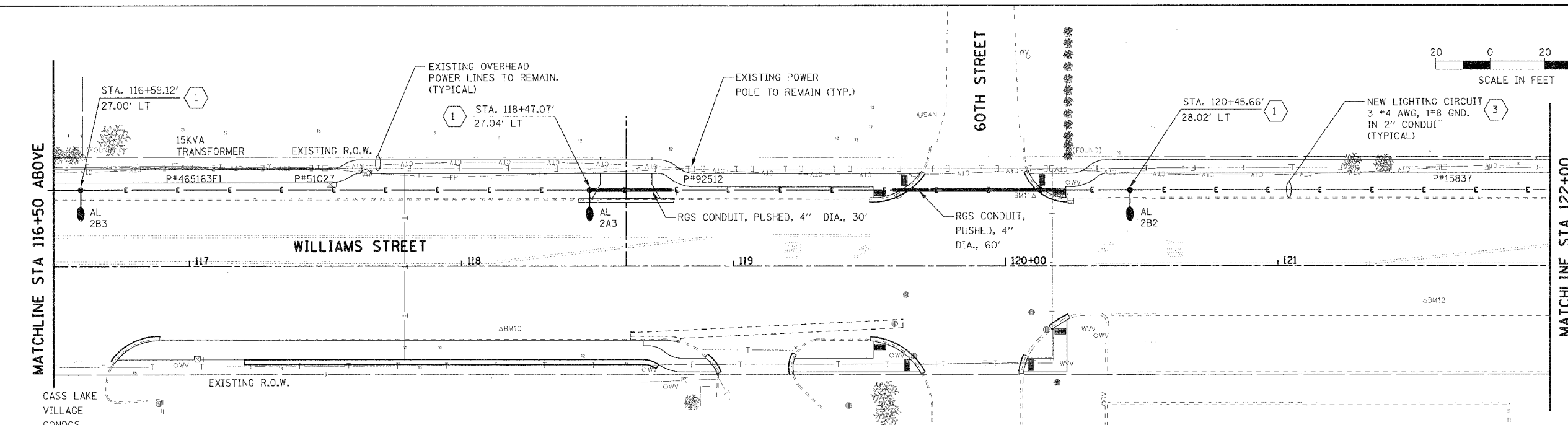
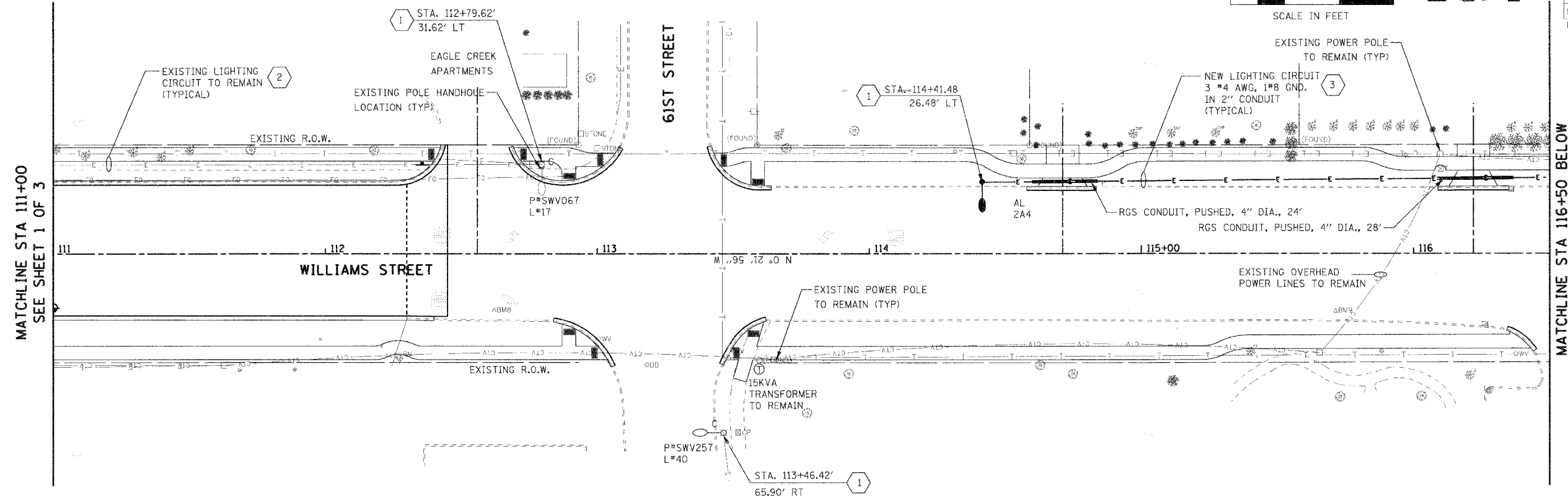
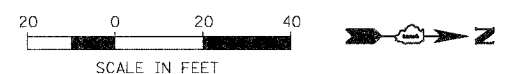

PLAN	SURVEYED	DATE
NOTE BOOK	PLOTTED	
NO.	BY	
	CHECKED	
	DATE	

PROFILE	SURVEYED	DATE
NOTE BOOK	PLOTTED	
NO.	BY	
	CHECKED	
	DATE	

- GENERAL NOTES**
- REFER TO DRAWING E-01 FOR GENERAL NOTES, LEGEND AND ABBREVIATIONS.
  - LOCATION OF EXISTING LIGHT POLES ARE APPROXIMATE. FIELD VERIFY EXACT LOCATION.

- KEY NOTES**
- PROVIDE NEW LIGHT POLE AND LIGHT FIXTURE IN ACCORDANCE WITH DETAILS ON SHEET E-08.
  - EXISTING LIGHTING CIRCUIT TO REMAIN.
  - PROVIDE NEW LIGHT CIRCUIT AND ASSOCIATED CONDUIT AND WIRES PER VILLAGE OF WESTMONT STANDARDS.

REVISIONS	
NAME	DATE

E-06 6 OF 12

ILLINOIS DEPARTMENT OF TRANSPORTATION

VILLAGE OF WESTMONT  
WILLIAMS STREET RECONSTRUCTION

PROPOSED LIGHTING PLAN  
SHEET 2 OF 3

SCALE: 1:20  
DATE: 09/21/07

DRAWN BY: FO  
CHECKED BY: DEM

PLOT DATE = #DATE#  
FILE NAME = #FILE#  
PLOT SCALE = #SCALE#  
USER NAME = #USER#