

ROUTE	SECTION	COUNTY	JURIS.	SHEET
TR 06-1518-01-BR	06-02121-01-BR	OGLE	14	9
WINNEBAGO	FED. AID PROJECT: D-105-14(64)			

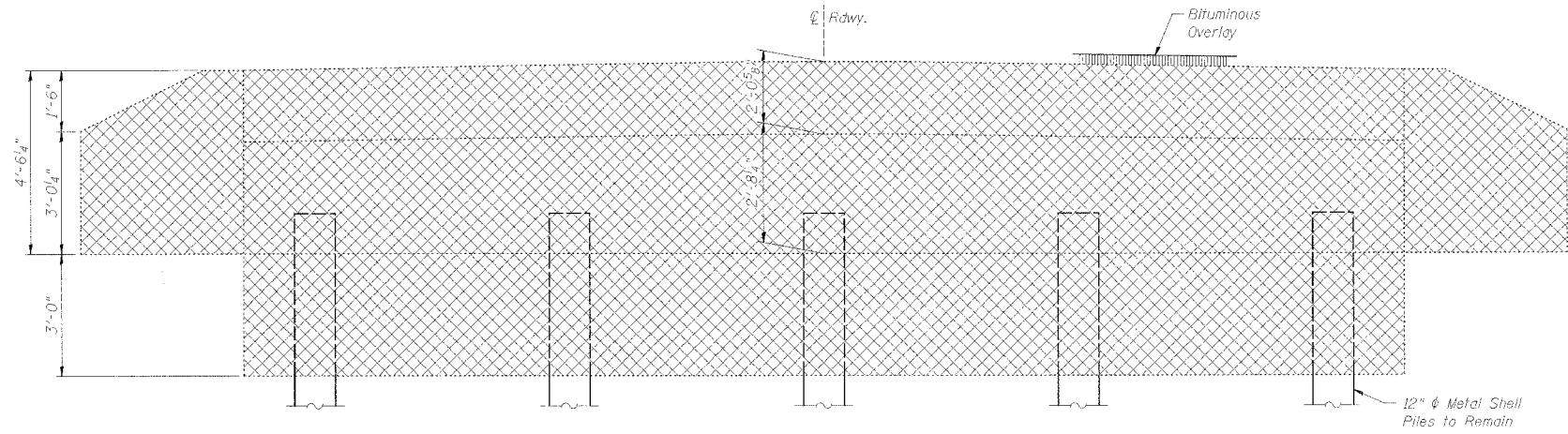

ELEVATION-EXISTING
(Looking East)

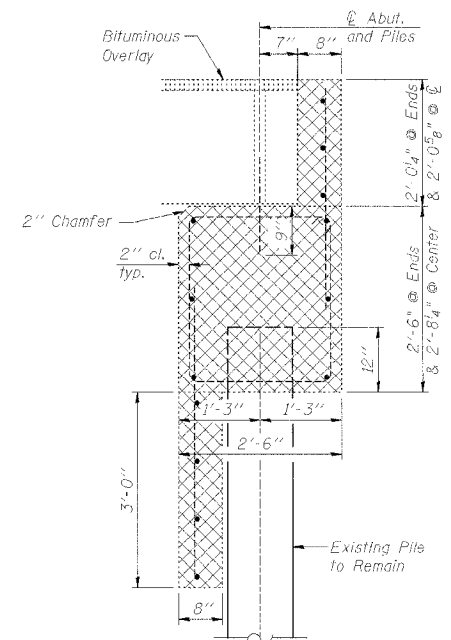

SEC. THRU EXISTING ABUT.

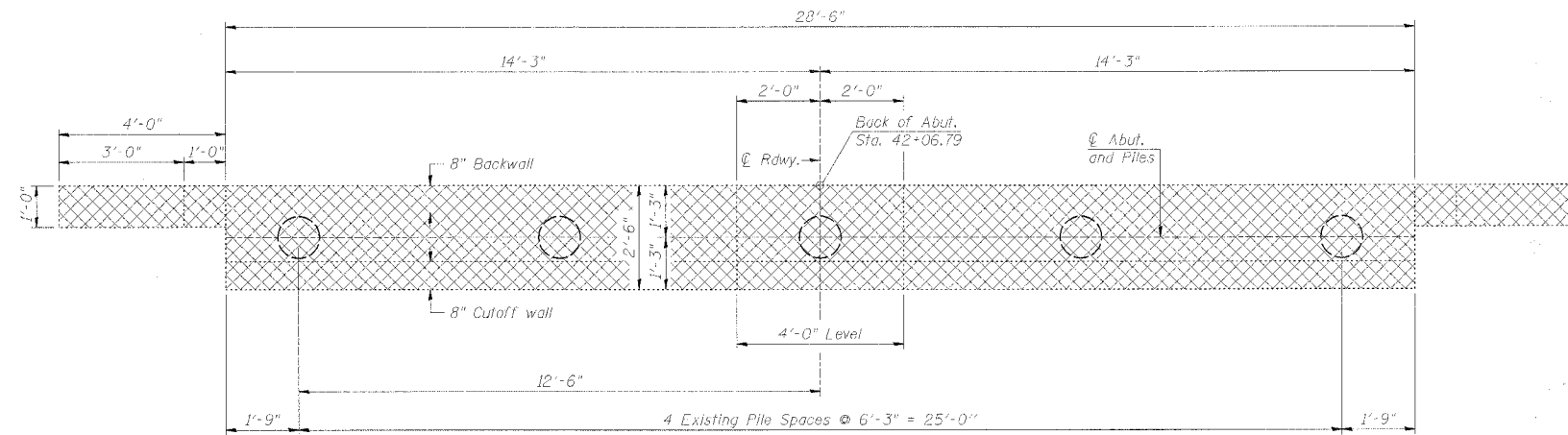

PLAN-EXISTING

BILL OF MATERIAL - EXISTING EAST ABUTMENT

Item	Unit	Quantity
Concrete Removal	Cu. Yd.	11.5

Notes:

Hatched area indicates Concrete Removal limits.

The existing pile shall remain in place, and shall be cleaned of all existing concrete. The cost of this work shall be included in the contract price per Cubic Yard of Concrete Removal. The contractor shall exercise care when removing concrete around piles to eliminate any pile damage. Any damage to piles during Concrete Removal operations shall be repaired at contractor's expense to the satisfaction of the Engineer.

EAST ABUTMENT DETAILS
EDSON ROAD (TR 61A) OVER
SOUTH BRANCH KISHWAUKEE RIVER
STA. 41+00 (071-3304)
SECTION 06-15118-01-BR
MONROE ROAD DISTRICT
OGLE COUNTY
SECTION 06-02121-01-BR
CHERRY VALLEY ROAD DISTRICT
WINNEBAGO COUNTY

WHA # 1092D06