

F.A.U. RTE.	SECTION	COUNTY	TOTAL SHEETS	SHEET NO.
2508	02-00039-00-PV	KENDALL	146	30
STA.		TO STA.		
FED. ROAD DIST. NO.		ILLINOIS FED. AID PROJECT		

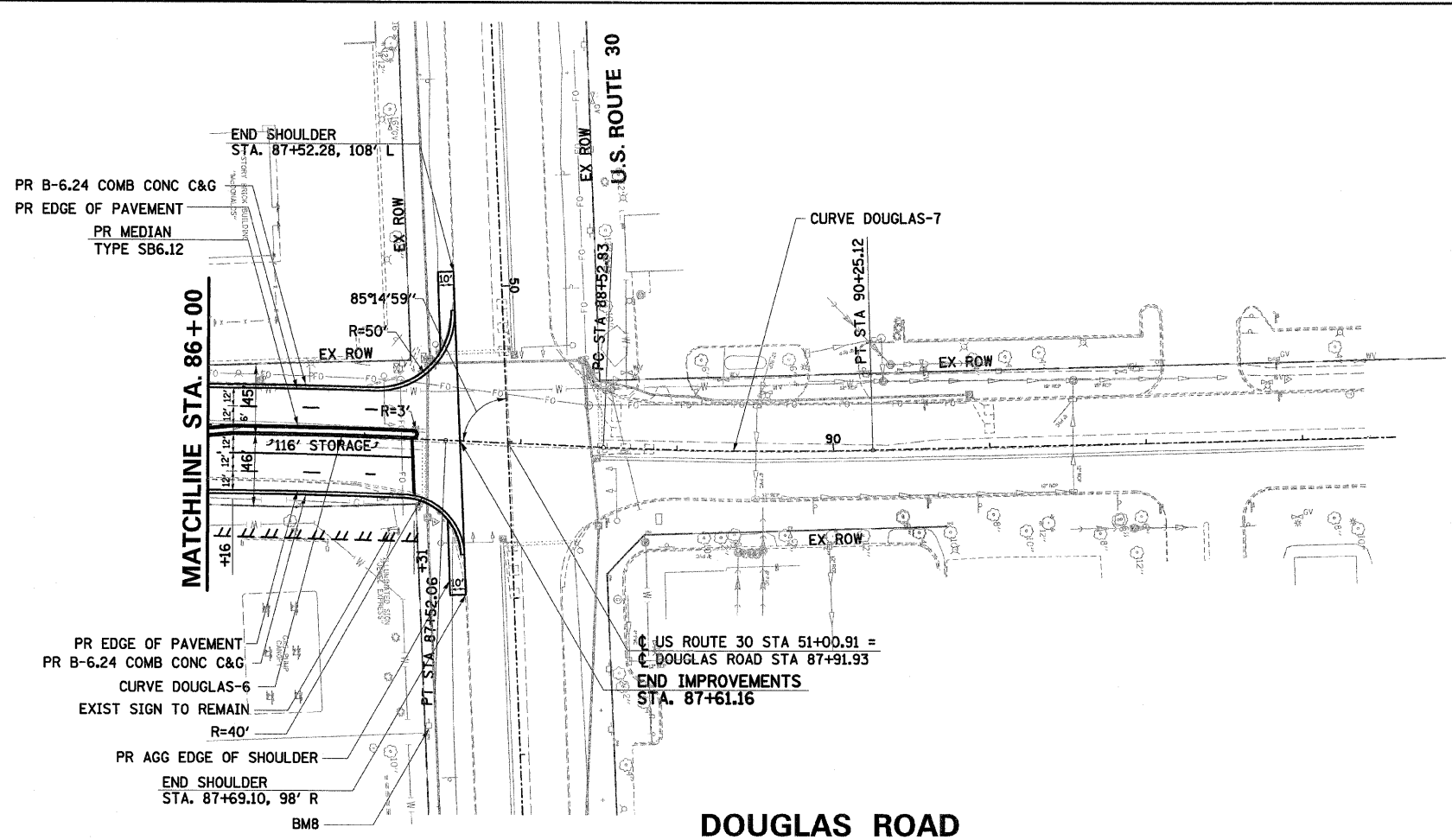

**CURVE DOUGLAS-6**  
 PI STA. = 86+44.34  
 $\Delta = 3^\circ 05' 12''$  (RT)  
 $D = 1^\circ 25' 57''$   
 $R = 4,000.00'$   
 $T = 107.77'$   
 $L = 215.50'$   
 $E = 1.45'$   
 $e = N.C.$   
 P.C. STA. = 85+36.57  
 P.T. STA. = 87+52.06

**CURVE DOUGLAS-7**  
 PI STA. = 89+39.01  
 $\Delta = 3^\circ 56' 55''$  (LT)  
 $D = 2^\circ 17' 31''$   
 $R = 2,500.00'$   
 $T = 86.18'$   
 $L = 172.29'$   
 $E = 1.48'$   
 $e = N.C.$   
 P.C. STA. = 88+52.83  
 P.T. STA. = 90+25.12



NOTE: SEE CURB TRANSITION DETAIL FOR CURB TRANSITIONS

**LEGEND**

-----	PROPOSED ROW
	PR PERM. EASEMENT
	PR TEMP. EASEMENT
X	TREE REMOVAL

PLAN	SURVEYED	DATE
NO.	BY	
	CHECKED	
	DATE	

PROFILE	SURVEYED	DATE
NO.	BY	
	CHECKED	
	DATE	

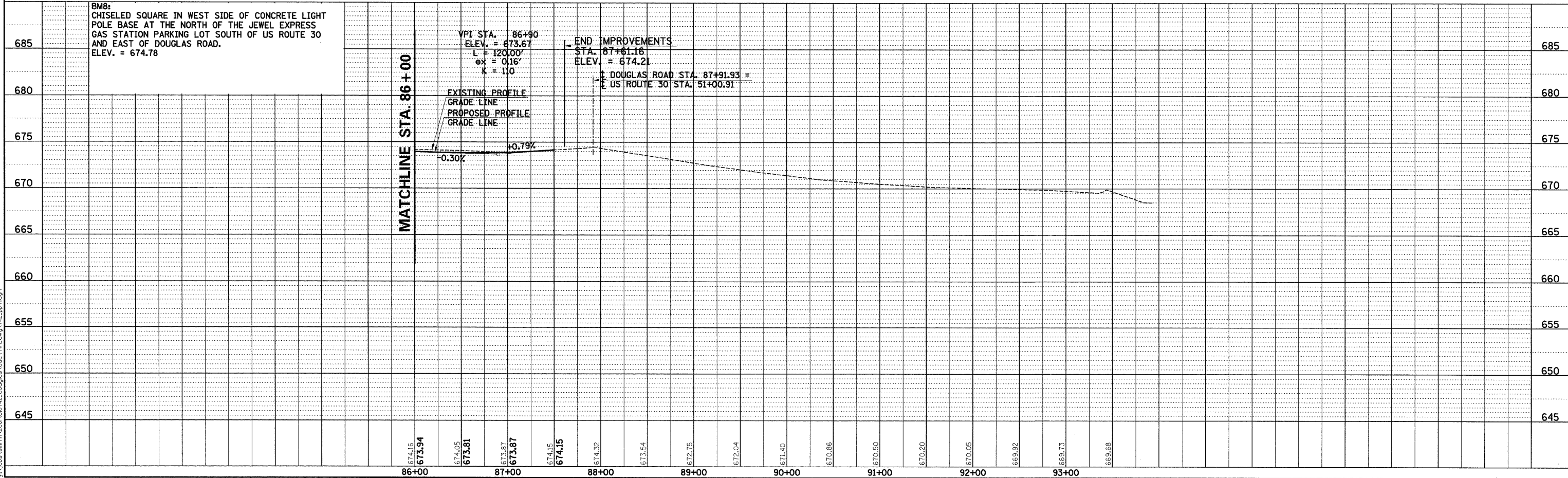

BMB: CHISELED SQUARE IN WEST SIDE OF CONCRETE LIGHT POLE BASE AT THE NORTH OF THE JEWEL EXPRESS GAS STATION PARKING LOT SOUTH OF US ROUTE 30 AND EAST OF DOUGLAS ROAD. ELEV. = 674.78

2/28/2007 3:28:20 PM  
 x:\jbs\sm\h\2006\0200\010742\_douglas\cadd\fin\_dwg\142.ppt.dgn

DOUGLAS ROAD STA.86+00 TO STA. 87+61.16 - PLAN AND PROFILE