

F.A.U. RTE.	SECTION	COUNTY	TOTAL SHEETS	SHEET NO.
2508	02-00039-00-PV	KENDALL	146	36
STA.	TO STA.			
FED. ROAD DIST. NO.	ILLINOIS	FED. AID PROJECT		

87333

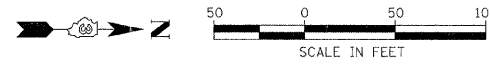

PLAN	SURVEYED	DATE
	BY	
	NO. OF WAY CHECKED	
	NO. OF WAY CHECKED	
	NO. OF WAY CHECKED	
	NO. OF WAY CHECKED	

PROFILE	SURVEYED	DATE
	BY	
	NO. OF WAY CHECKED	
	NO. OF WAY CHECKED	
	NO. OF WAY CHECKED	
	NO. OF WAY CHECKED	

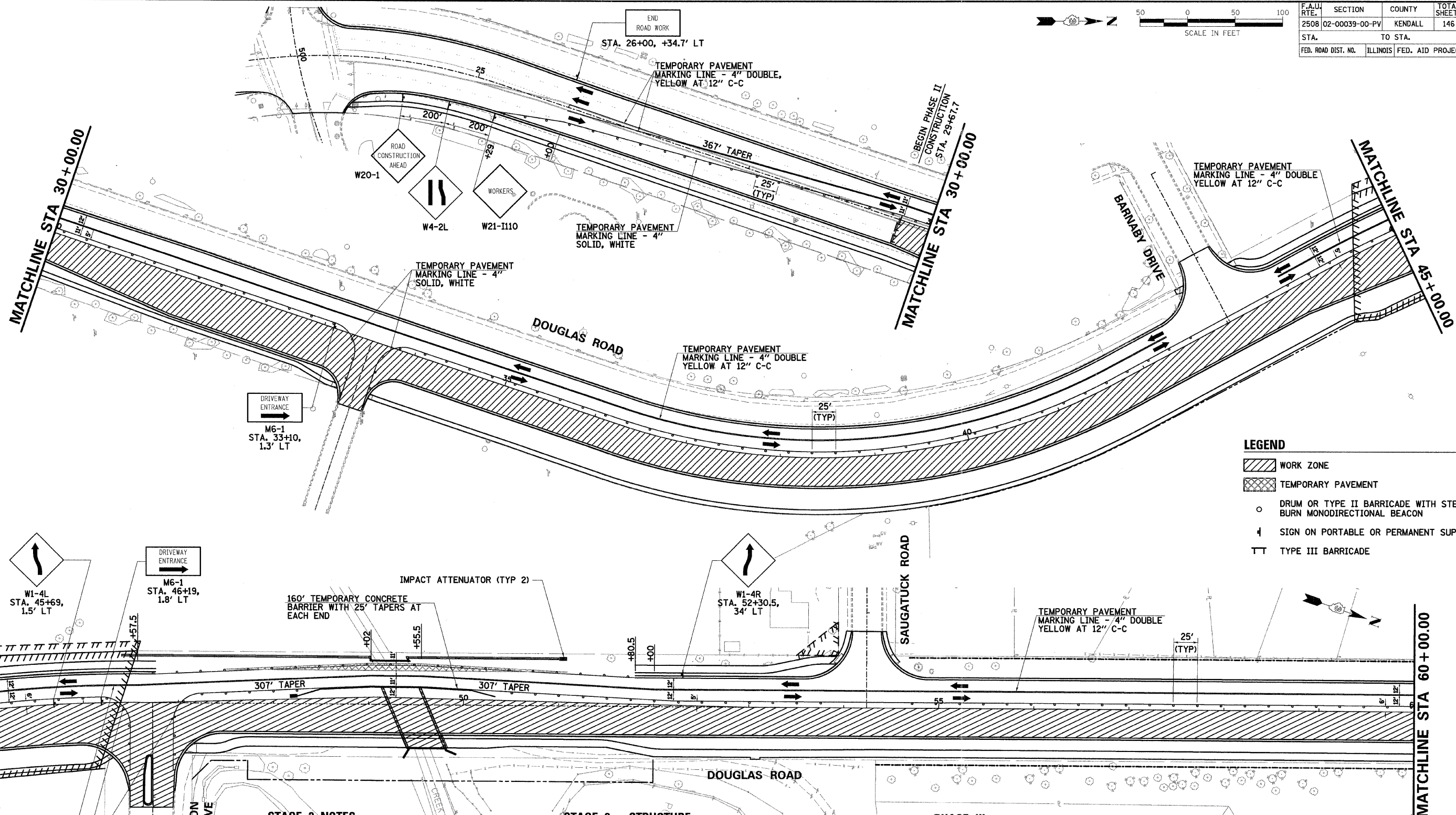

**LEGEND**

	WORK ZONE
	TEMPORARY PAVEMENT
	DRUM OR TYPE II BARRICADE WITH STEADY BURN MONODIRECTIONAL BEACON
	SIGN ON PORTABLE OR PERMANENT SUPPORT
	TYPE III BARRICADE

- STAGE 2 NOTES**
1. INSTALL TEMPORARY PAVEMENT MARKING AND REMOVE EXISTING PAVEMENT MARKINGS THAT CONFLICT WITH TEMPORARY PAVEMENT MARKING.
  2. MOVE TRAFFIC TO SOUTHBOUND LANES. MINIMUM LANE WIDTH = 11'. NO TURN LANES AT INTERSECTIONS WILL BE PROVIDED.
  3. RECONSTRUCT THE NORTHBOUND LANES AND HALF OF THE TURN LANE. (CONSTRUCT UP TO THE CENTERLINE OF THE PAVEMENT UNLESS SHOWN OTHERWISE IN PLAN.) DO NOT PLACE SURFACE COURSE. (SURFACE COURSE TO BE PLACED DURING PHASE III.)
  4. INTERSECTION STAGING - DO NOT CLOSE LONG BEACH ROAD EAST AND FARMINGTON LAKES DRIVE EAST AT THE SAME TIME. ONE WEEK CLOSURE PERIOD FOR EACH INTERSECTION AT SEPARATE TIMES WILL BE ALLOWED.
  5. INSTALL EAST CURB AND GUTTER.
  6. CONSTRUCT STAGE 2 OF THE STRUCTURE OVER WAUBONSEE CREEK.

- STAGE 2 - STRUCTURE**
- A. MOVE TRAFFIC TO SOUTHBOUND LANES OF THREE SIDED PRECAST CONCRETE STRUCTURE.
  - B. COMPLETE EXISTING UTILITY RELOCATION AS NECESSARY.
  - C. REMOVE EXISTING BRIDGE TO LIMITS SHOWN ON THE STRUCTURAL PLANS AND COMPLETE STAGE 2 CONSTRUCTION OF THE PROPOSED BRIDGE AS SHOWN IN THE STRUCTURAL PLANS.
  - D. CONSTRUCT NOISE ABATEMENT WALLS ALONG NORTHBOUND SIDE OF ROADWAY.

- STAGE 3**
1. INSTALL PERMANENT TRAFFIC SIGNALS.
  2. INSTALL SHORT TERM PAVEMENT MARKING.
  3. REMOVE TEMPORARY PAVEMENT FROM SOUTHBOUND LANES ON BRIDGE AND COMPLETE CONSTRUCTION OF FILL, SIDEWALK, C&G AND ROADWAY ON BRIDGE AS SHOWN IN THE STRUCTURAL PLANS.

- PHASE III**
1. MILL AND RESURFACE OLD POST TO US ROUTE 34 APPROXIMATE STATIONS 19+45 TO 29+68
  2. CONSTRUCT DRAINAGE IMPROVEMENTS INCLUDING CURB AND GUTTER, DITCH GRADING, STORM SEWER, STRUCTURES, AND LATERALS.
  3. INSTALL TEMPORARY SIGNALS AT OLD POST ROAD. IMPROVE RADII ON OLD POST ROAD AND RELOCATE MAST ARMS.
  4. PLACE SURFACE COURSE OVER ENTIRE PROJECT LENGTH (US 30 TO PROJECT LIMITS NORTH OF US 34).
  5. PLACE PERMANENT PAVEMENT MARKING.
  6. INSTALL LANDSCAPING.
  7. INSTALL PERMANENT SIGNALS AT APPLICABLE INTERSECTIONS.

ILLINOIS DEPARTMENT OF TRANSPORTATION  
**F.A.U. 2508 - DOUGLAS ROAD**  
**(U.S. RTE 34 TO U.S. RTE 30)**  
**MAINTENANCE OF TRAFFIC**  
**PHASE II - STAGE 2 & 3**  
**DOUGLAS ROAD**

SCALE: VERT. DATE  
 HORIZ. DATE

DRAWN BY BAH  
 CHECKED BY CRF

248344 AM  
 3/28/2007  
 \\sbsa\enr\11\2000\010742\_douglas\cadd\fn.dwg 142.mot06.dgn