

F.A.U. RTE.	SECTION	COUNTY	TOTAL SHEETS	SHEET NO.
2508	02-00039-00-PV	KENDALL	146	77
STA.		TO STA.		
FED. ROAD DIST. NO.	ILLINOIS	FED. AID PROJECT	87333	



REMOVED EXISTING TRAFFIC SIGNAL EQUIPMENT EACH - 1

THE FOLLOWING ITEMS SHALL BE REMOVED BY THE CONTRACTOR AND DISPOSED OF BY HIM AT HIS EXPENSE. THE SALVAGE VALUE OF THE REMOVED EQUIPMENT SHALL BE REFLECTED IN THE CONTRACT BID PRICE.

- 1 EACH STEEL MAST ARM ASSEMBLY AND POLE
- 3 EACH SIGNAL HEAD, 1- FACE

NOTE
ONLY NORTHWEST MAST ARM BEING REMOVED

TEMPORARY TRAFFIC SIGNAL LEGEND

- ← TEMPORARY TRAFFIC SIGNAL HEAD
SPAN WIRE MOUNTED, ORIGINAL LOCATION
- ↖ TEMPORARY TRAFFIC SIGNAL HEAD
SPAN WIRE MOUNTED, SECONDARY LOCATION*
- ⊙ TEMPORARY WOOD POLE (CLASS 5 OR BETTER)
45 FOOT MINIMUM
- PROPOSED GUY WIRE TO TEMPORARY WOOD POLE
- ⊠ TEMPORARY CONTROLLER CABINET
- TEMPORARY SPAN WIRE, TETHER WIRE, AND CABLE
- ⊕ TEMPORARY SERVICE INSTALLATION
- ▶ EMERGENCY VEHICLE LIGHT DETECTOR
- ⊙ CONFIRMATION BEACON

REMOVE EXISTING TRAFFIC SIGNAL EQUIPMENT LEGEND

- ↖ EXISTING SIGNAL HEAD TO BE REMOVED
- "E" ■ EXISTING SERVICE INSTALLATION TO BE REMOVED
- EXISTING SIGNAL POST AND FOUNDATION TO BE REMOVED
- "E" ⊠ EXISTING CONTROLLER AND FOUNDATION TO BE REMOVED
- ⊠ EXISTING HANDHOLE TO BE REMOVED
- "E" ⊕ EXISTING HEAVY-DUTY HANDHOLE TO BE REMOVED
- ⊙ EXISTING ALUMINUM MAST ARM POLE AND FOUNDATION TO BE REMOVED
- ⊙ EXISTING STEEL MAST ARM POLE AND FOUNDATION TO BE REMOVED

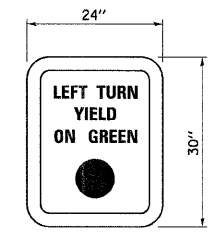

R10-12
24" X 30"
3 SIGN REQUIRED

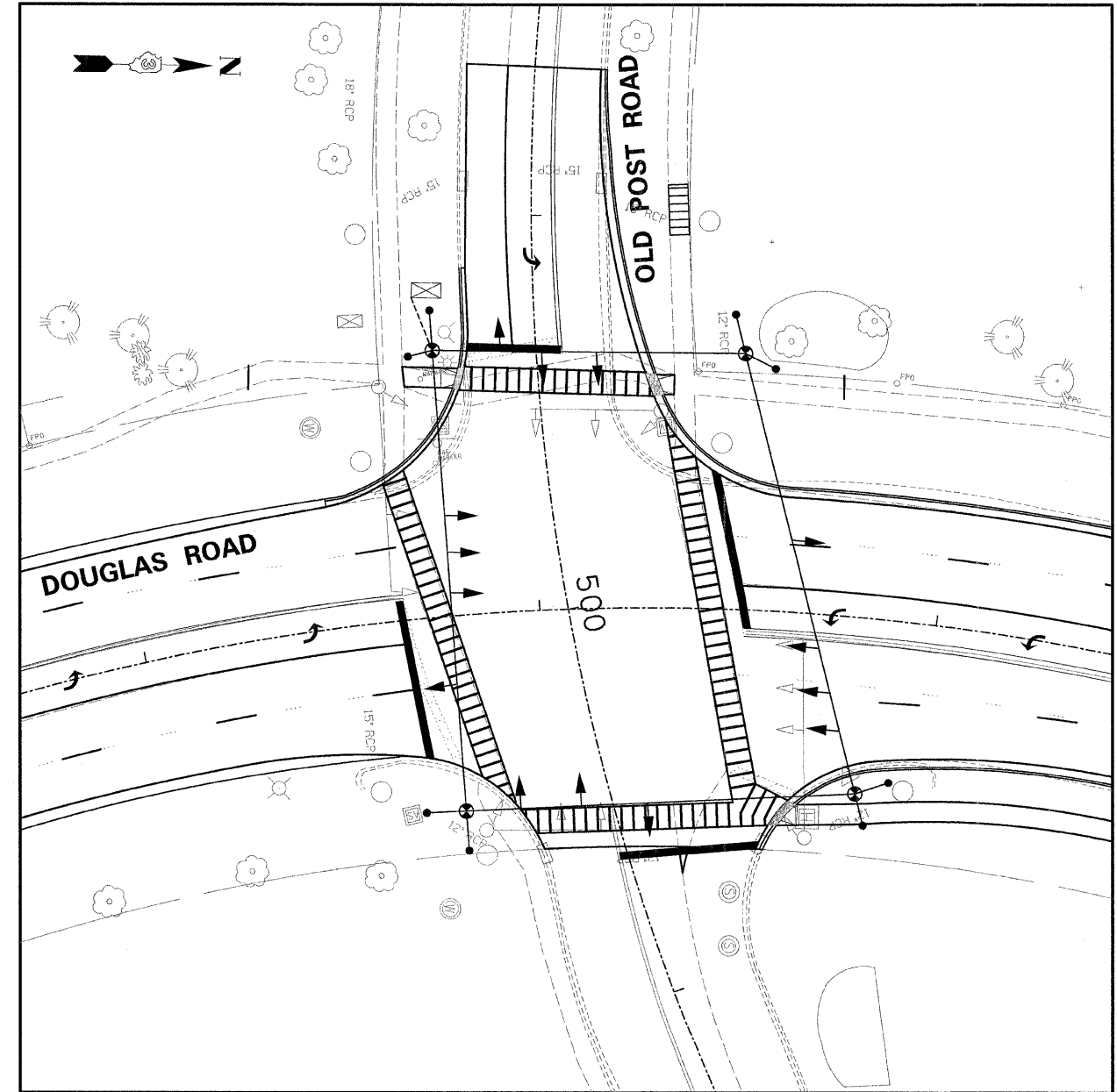

SIGNAL HEADS MAY NEED TO BE MOVED FROM STAGE TO STAGE AS REQUIRED

ILLINOIS DEPARTMENT OF TRANSPORTATION
F.A.U. 2508 - DOUGLAS ROAD
(U.S. RTE 34 TO U.S. RTE 30)
**TEMPORARY TRAFFIC SIGNAL INSTALLATION
INTERSECTION OF DOUGLAS ROAD
AND OLD POST ROAD**

SCALE: VERT. _____
HORIZ. _____
DATE _____ DRAWN BY _____
CHECKED BY _____

PLAN SURVEYED _____ DATE _____
PLOTTED _____
BY _____
NOTE BOOK _____
NO. _____

PROFILE SURVEYED _____ DATE _____
PLOTTED _____
BY _____
NOTE BOOK _____
NO. _____

2:52:25 AM
3/28/2007
y:\jobs\smith\2008\010742-douglas\cadd\fn-dwg\142-1-sig07.dgn