

F.A.U. RTE.	SECTION	COUNTY	TOTAL SHEETS	SHEET NO.
2508	02-00039-00-PV	KENDALL	146	95
STA.		TO STA.		
FED. ROAD DIST. NO.	ILLINOIS	FED. AID PROJECT		

87333

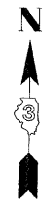
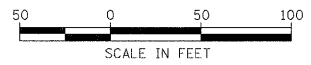

PLAN	SURVEYED	DATE
NOTE BOOK NO.	PLOTTED	
	RTY. OF WAY CHECKED	
	ADD FILE NAME	

PROFILE	SURVEYED	DATE
NOTE BOOK NO.	PLOTTED	
	B.M. NOTED	
	STRUCTURE NOTATIONS CHECKED	

MATCHLINE STA. 55 + 00

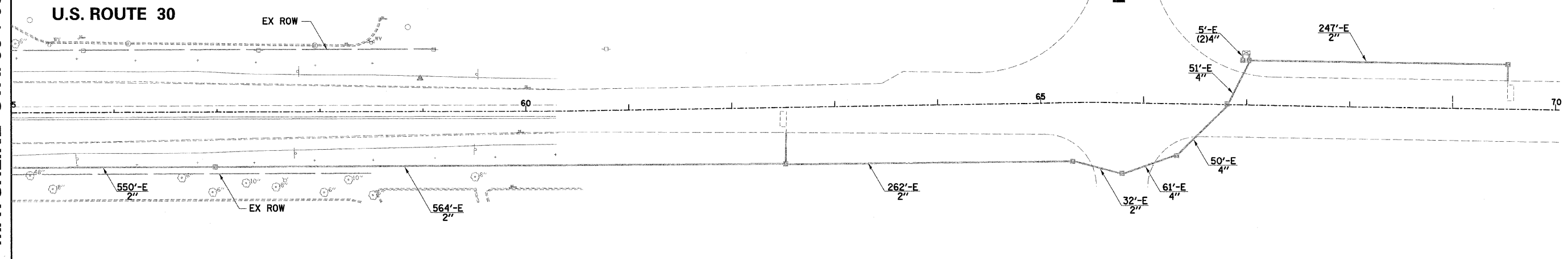

**INTERCONNECT PLAN LEGEND**

	PROPOSED	EXISTING
CONTROLLER		
HANDHOLE		
DOUBLE HANDHOLE		
G.S. CONDUIT IN TRENCH OR PUSHED		
DETECTOR LOOP		
COMMON TRENCH	CT	
UNIT DUCT	UD	
SYSTEM	S	
INTERSECTION	IP	

ILLINOIS DEPARTMENT OF TRANSPORTATION  
 F.A.U. 2508 – DOUGLAS ROAD  
 (U.S. RTE 34 TO U.S. RTE 30)  
**TRAFFIC SIGNAL INTERCONNECT PLAN**

SCALE: VERT. \_\_\_\_\_  
 HORIZ. \_\_\_\_\_  
 DATE \_\_\_\_\_

DRAWN BY MJF  
 CHECKED BY CRF

2:52:33 AM  
 3/28/2007  
 \\sbsa\proj\11\200\010742.dwg\as\cod\frn.dwg\142.sig\in\03.dgn