

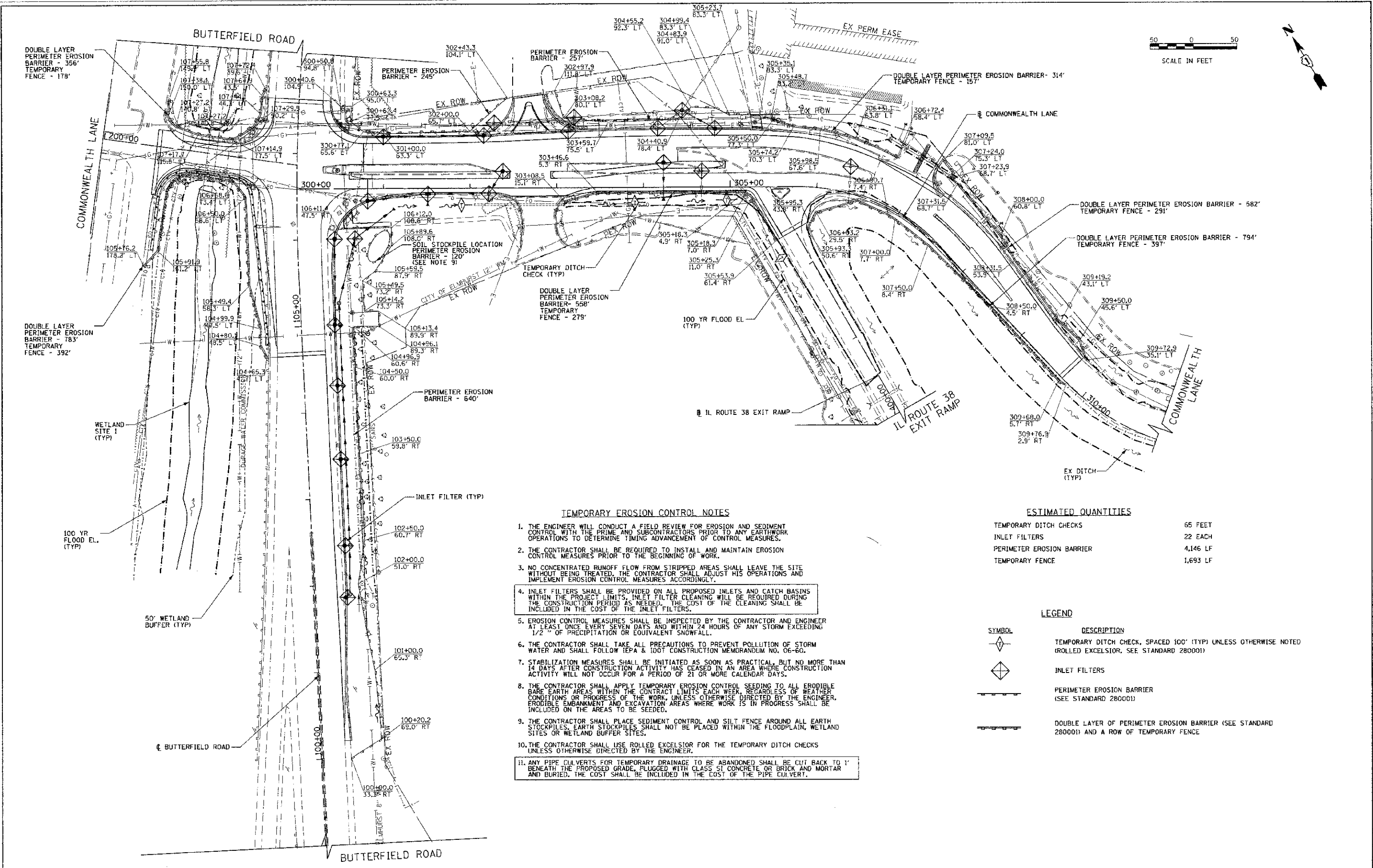

DATE	BY
PLAN	NOTED
NOTE BOOK	ALIGNMENT CHECKED
	FIELD FILE NAME

DATE	BY
PROFILE	NOTED
NOTE BOOK	GRADES CHECKED
	FIELD FILE NAME



- TEMPORARY EROSION CONTROL NOTES**
1. THE ENGINEER WILL CONDUCT A FIELD REVIEW FOR EROSION AND SEDIMENT CONTROL WITH THE PRIME AND SUBCONTRACTORS PRIOR TO ANY EARTHWORK OPERATIONS TO DETERMINE TIMING ADVANCEMENT OF CONTROL MEASURES.
  2. THE CONTRACTOR SHALL BE REQUIRED TO INSTALL AND MAINTAIN EROSION CONTROL MEASURES PRIOR TO THE BEGINNING OF WORK.
  3. NO CONCENTRATED RUNOFF FLOW FROM STRIPPED AREAS SHALL LEAVE THE SITE WITHOUT BEING TREATED. THE CONTRACTOR SHALL ADJUST HIS OPERATIONS AND IMPLEMENT EROSION CONTROL MEASURES ACCORDINGLY.
  4. INLET FILTERS SHALL BE PROVIDED ON ALL PROPOSED INLETS AND CATCH BASINS WITHIN THE PROJECT LIMITS. INLET FILTER CLEANING WILL BE REQUIRED DURING THE CONSTRUCTION PERIOD AS NEEDED. THE COST OF THE CLEANING SHALL BE INCLUDED IN THE COST OF THE INLET FILTERS.
  5. EROSION CONTROL MEASURES SHALL BE INSPECTED BY THE CONTRACTOR AND ENGINEER AT LEAST ONCE EVERY SEVEN DAYS AND WITHIN 24 HOURS OF ANY STORM EXCEEDING 1/2" OF PRECIPITATION OR EQUIVALENT SNOWFALL.
  6. THE CONTRACTOR SHALL TAKE ALL PRECAUTIONS TO PREVENT POLLUTION OF STORM WATER AND SHALL FOLLOW IEPA & IDOT CONSTRUCTION MEMORANDUM NO. 06-60.
  7. STABILIZATION MEASURES SHALL BE INITIATED AS SOON AS PRACTICAL, BUT NO MORE THAN 14 DAYS AFTER CONSTRUCTION ACTIVITY HAS CEASED IN AN AREA WHERE CONSTRUCTION ACTIVITY WILL NOT OCCUR FOR A PERIOD OF 21 OR MORE CALENDAR DAYS.
  8. THE CONTRACTOR SHALL APPLY TEMPORARY EROSION CONTROL SEEDING TO ALL ERODIBLE BARE EARTH AREAS WITHIN THE CONTRACT LIMITS EACH WEEK, REGARDLESS OF WEATHER CONDITIONS OR PROGRESS OF THE WORK, UNLESS OTHERWISE DIRECTED BY THE ENGINEER. ERODIBLE EMBANKMENT AND EXCAVATION AREAS WHERE WORK IS IN PROGRESS SHALL BE INCLUDED ON THE AREAS TO BE SEEDING.
  9. THE CONTRACTOR SHALL PLACE SEDIMENT CONTROL AND SILT FENCE AROUND ALL EARTH STOCKPILES. EARTH STOCKPILES SHALL NOT BE PLACED WITHIN THE FLOODPLAIN, WETLAND SITES OR WETLAND BUFFER SITES.
  10. THE CONTRACTOR SHALL USE ROLLED EXCELSIOR FOR THE TEMPORARY DITCH CHECKS UNLESS OTHERWISE DIRECTED BY THE ENGINEER.
  11. ANY PIPE CULVERTS FOR TEMPORARY DRAINAGE TO BE ABANDONED SHALL BE CUT BACK TO 1' BENEATH THE PROPOSED GRADE, PLUGGED WITH CLASS SI CONCRETE OR BRICK AND MORTAR AND BURIED. THE COST SHALL BE INCLUDED IN THE COST OF THE PIPE CULVERT.

**ESTIMATED QUANTITIES**

TEMPORARY DITCH CHECKS	65 FEET
INLET FILTERS	22 EACH
PERIMETER EROSION BARRIER	4,146 LF
TEMPORARY FENCE	1,693 LF

**LEGEND**

SYMBOL	DESCRIPTION
	TEMPORARY DITCH CHECK, SPACED 100' (TYP) UNLESS OTHERWISE NOTED (ROLLED EXCELSIOR, SEE STANDARD 280001)
	INLET FILTERS
	PERIMETER EROSION BARRIER (SEE STANDARD 280001)
	DOUBLE LAYER OF PERIMETER EROSION BARRIER (SEE STANDARD 280001) AND A ROW OF TEMPORARY FENCE

FILE NAME = G:\CHRB\0006\Road\PHASE 2\Sheet\CI\0006	USER NAME = kelorenz	DESIGNED TKS	REVISED - 12/18/12
PLOT SCALE = 58,0000 ft. / in.	DATE = 10/22/2012	CHECKED - JMG	REVISED -
PLOT DATE = 12/17/2012		DATE = 10/22/2012	REVISED -

**STATE OF ILLINOIS  
DEPARTMENT OF TRANSPORTATION**

<b>BUTTERFIELD ROAD AT COMMONWEALTH LANE EROSION CONTROL PLAN</b>		F.A.J. 3545	SECTION 09-00170-00-CH	COUNTY	TOTAL SHEETS 108	SHEET NO. 27
SCALE: 1"=50'	SHEET NO. 27 OF 108 SHEETS	STA. 300+00	TO STA. 311+00	CONTRACT NO. 63742		
FED. ROAD DIST. NO. 7 ILLINOIS FED. AID PROJECT						