

DATE	BY
DESIGNED	TKH
DRAWN	TKH
CHECKED	JMG
DATE	10/22/2012

DATE	BY
DESIGNED	TKH
DRAWN	TKH
CHECKED	JMG
DATE	10/22/2012

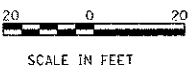
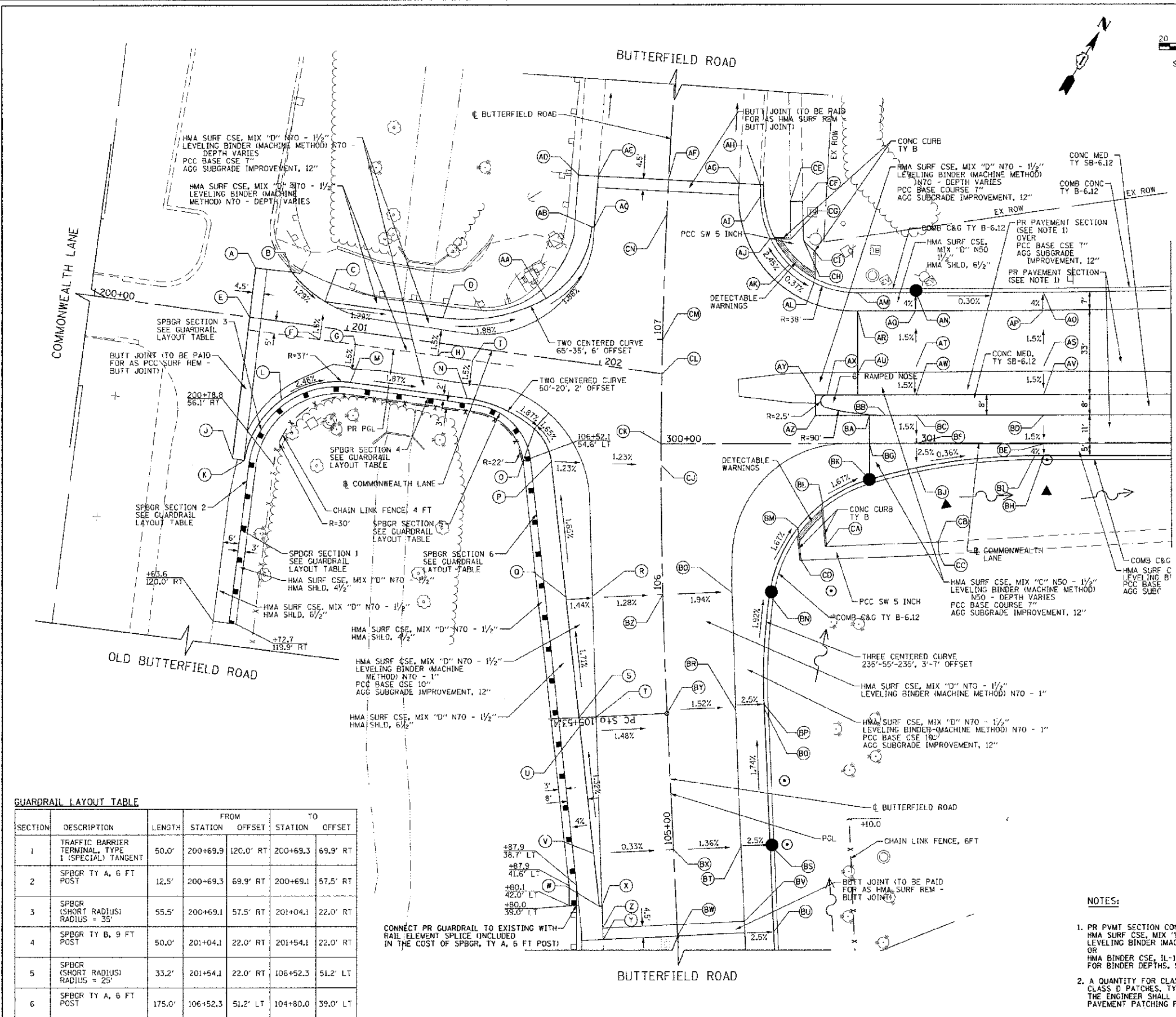

SECTION	DESCRIPTION	LENGTH	FROM STATION	TO STATION	FROM OFFSET	TO OFFSET
1	TRAFFIC BARRIER TERMINAL, TYPE 1 (SPECIAL) TANGENT	50.0'	200+69.9	200+69.3	120.0' RT	69.9' RT
2	SPBGR TY A, 6 FT POST	12.5'	200+69.3	200+69.1	69.9' RT	57.5' RT
3	SPBGR (SHORT RADIUS) RADIUS = 35'	55.5'	200+69.1	201+04.1	57.5' RT	22.0' RT
4	SPBGR TY B, 9 FT POST	50.0'	201+04.1	201+54.1	22.0' RT	22.0' RT
5	SPBGR (SHORT RADIUS) RADIUS = 25'	33.2'	201+54.1	106+52.3	22.0' RT	51.2' LT
6	SPBGR TY A, 6 FT POST	175.0'	106+52.3	104+80.0	51.2' LT	39.0' LT

STATION	OFFSET	ELEVATION
A	200+61.2	19.4' LT 667.33
B	200+75.5	19.7' LT 667.24
C	200+90.0	10.0' LT 667.01
D	201+36.7	10.0' LT 666.41
E	200+61.5	0.0' RT 667.76
F	200+90.0	5.0' RT 667.24
G	201+04.1	5.0' RT 667.06
H	201+36.7	5.0' RT 666.64
I	201+50.4	5.0' RT 666.20
J	200+62.5	55.8' RT 668.32
K	200+67.1	56.0' RT 668.31
L	200+78.3	30.5' RT 667.54
M	201+04.1	20.0' RT 666.83
N	201+50.4	20.0' RT 665.97
O	106+64.6	49.8' LT 665.42
P	106+52.0	43.1' LT 665.66
Q	106+00.0	38.0' LT 665.95
R	106+00.0	27.6' LT 666.80
S	105+53.4	34.6' LT 667.35
T	105+53.4	27.8' LT 667.55
U	105+50.0	34.4' LT 667.41
V	106+64.6	31.4' LT 668.15
W	104+79.2	30.1' LT 668.36
X	104+79.2	29.1' LT 668.39
Y	104+66.2	29.2' LT 668.54
Z	104+10.7	29.1' LT 668.45
AA	107+42.7	46.1' LT 665.68
AB	107+42.8	29.2' LT 664.94
AC	107+42.8	28.2' LT 664.97
AD	107+62.6	35.4' LT 664.65
AE	107+62.6	27.6' LT 664.81
AF	107+62.6	0.0' RT 664.51
AG	107+62.6	27.7' RT 663.66
AH	107+62.6	36.0' RT 663.75
AI	107+57.8	36.3' RT 663.85
AJ	107+41.3	40.9' RT 664.27
AK	107+31.1	48.7' RT 664.58
AL	107+24.3	58.7' RT 664.54
AM	300+77.1	59.0' LT 664.47
AN	301+00.0	59.0' LT 664.39
AO	301+50.0	59.0' LT 664.24
AP	301+50.0	52.0' LT 664.52
AQ	301+00.0	51.9' LT 664.68
AR	300+77.1	51.9' LT 664.75
AS	301+50.0	30.0' LT 664.86
AT	301+00.0	30.0' LT 665.01
AU	300+77.1	27.8' LT 665.05
AV	301+50.0	19.0' LT 664.69
AW	301+00.0	19.0' LT 664.84
AX	300+65.0	19.0' LT 664.95
AY	300+60.5	19.0' LT 664.96
AZ	300+60.5	11.0' LT 664.98
BA	300+81.6	11.0' LT 664.90
BB	300+88.0	11.0' LT 664.87
BC	301+00.0	11.0' LT 664.58
BD	301+50.0	11.0' LT 664.36
BE	301+50.0	0.0' RT 664.20
BF	301+00.0	0.0' RT 664.42
BG	300+81.6	0.0' RT 664.73
BH	301+50.0	5.0' RT 664.00
BI	301+46.5	5.0' RT 664.01
BJ	301+00.0	9.6' RT 664.18
BK	300+81.6	14.1' RT 664.50
BL	300+63.2	23.4' RT 664.87
BM	300+33.5	33.1' RT 665.10
BN	105+98.8	41.8' RT 665.56
BO	106+00.0	27.2' RT 665.92
BP	105+55.2	36.1' RT 666.51
BQ	105+53.4	38.1' RT 666.54
BR	105+53.4	27.0' RT 666.73
BS	105+00.0	37.9' RT 667.38
BT	105+00.0	26.5' RT 667.66
BU	104+66.2	37.7' RT 668.28
BV	104+70.7	26.4' RT 668.28
BW	104+66.2	0.0' RT 668.59
BX	105+00.0	0.0' RT 668.05
BY	105+53.4	0.0' RT 667.14
BZ	106+00.0	0.0' RT 666.43
CA	106+17.7	64.1' RT 664.86
CB	106+18.3	108.3' RT 664.24
CC	106+13.8	108.5' RT 664.55
CD	106+12.4	54.5' RT 665.33
CE	107+56.4	48.1' RT 664.36
CF	107+56.7	52.9' RT 664.83
CG	107+41.3	48.9' RT 663.92
CH	107+41.3	53.9' RT 664.09
CI	107+37.1	58.2' RT 664.49
CJ	106+50.0	0.0' RT 665.70
CK	106+59.0	0.0' RT 665.58
CL	106+86.6	0.0' RT 665.30
CM	107+00.0	0.0' RT 665.04
CN	107+50.0	0.0' RT 664.61

NOTES:
 1. PR PAVT SECTION CONSISTS OF:
 HMA SURF CSE, MIX "D" N50 - 1 1/2"
 LEVELING BINDER (MACHINE METHOD) N50 - DEPTH VARIES
 OR
 HMA BINDER CSE, IL-19.0 N50 - DEPTH VARIES
 FOR BINDER DEPTHS, SEE SHEET NO. 38
 2. A QUANTITY FOR CLASS D PATCHES, TYPE I, 8" AND
 CLASS D PATCHES, TYPE II, 8" IS INCLUDED IN THE PLANS.
 THE ENGINEER SHALL APPROVE THE LOCATIONS OF
 PAVEMENT PATCHING PRIOR TO PLACEMENT.