

THE CONTRACTOR SHALL BE RESPONSIBLE FOR PERFORMING ALL NECESSARY EQUIPMENT AND PHASING CHANGES TO THE INSTALLATION TO COVER THE DIFFERENT SIGNAL HEAD REQUIREMENTS AND SIGNAL PHASING. THE COST OF THIS WORK WILL BE INCLUDED IN THE COST OF TEMPORARY TRAFFIC SIGNAL INSTALLATION.

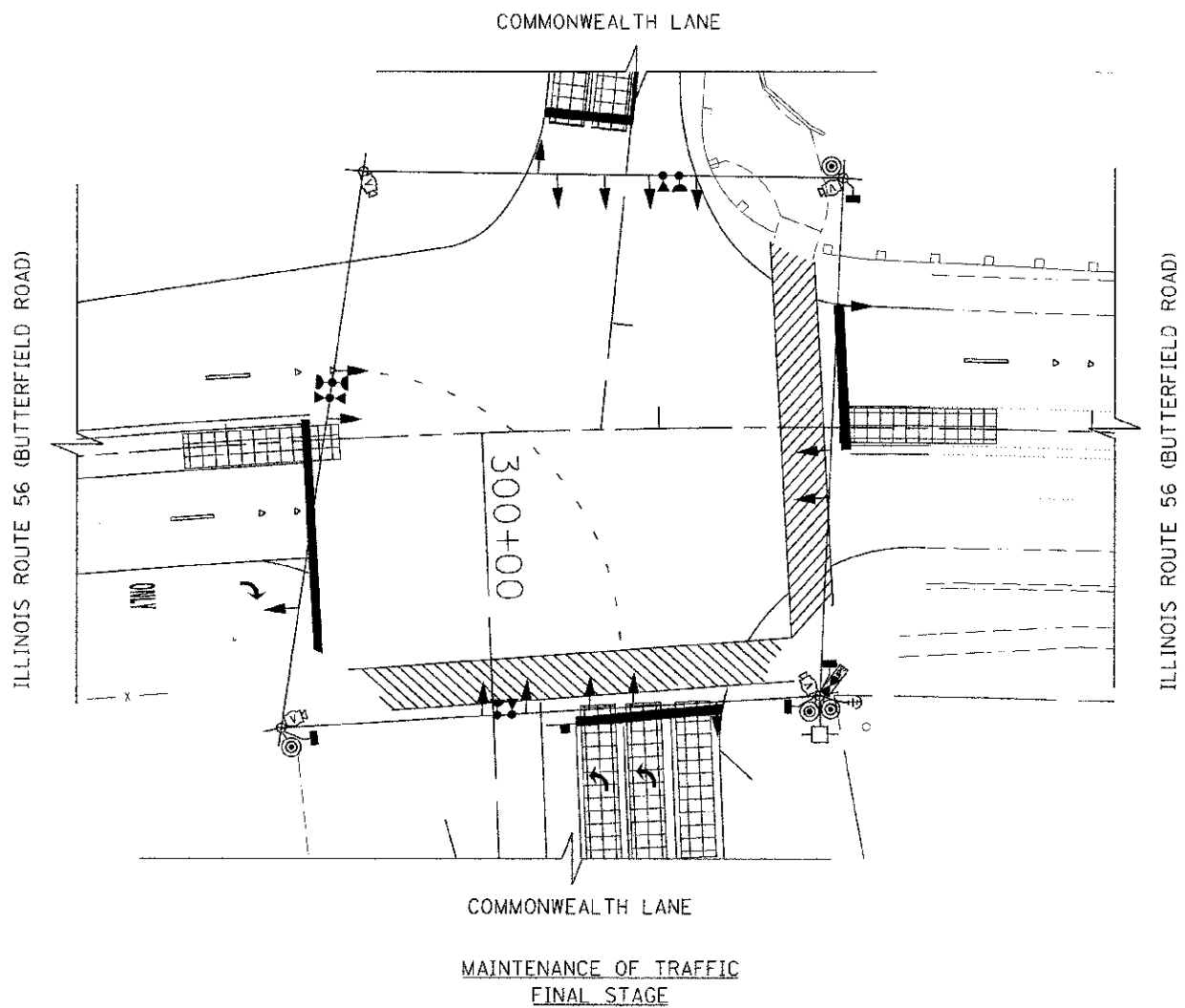
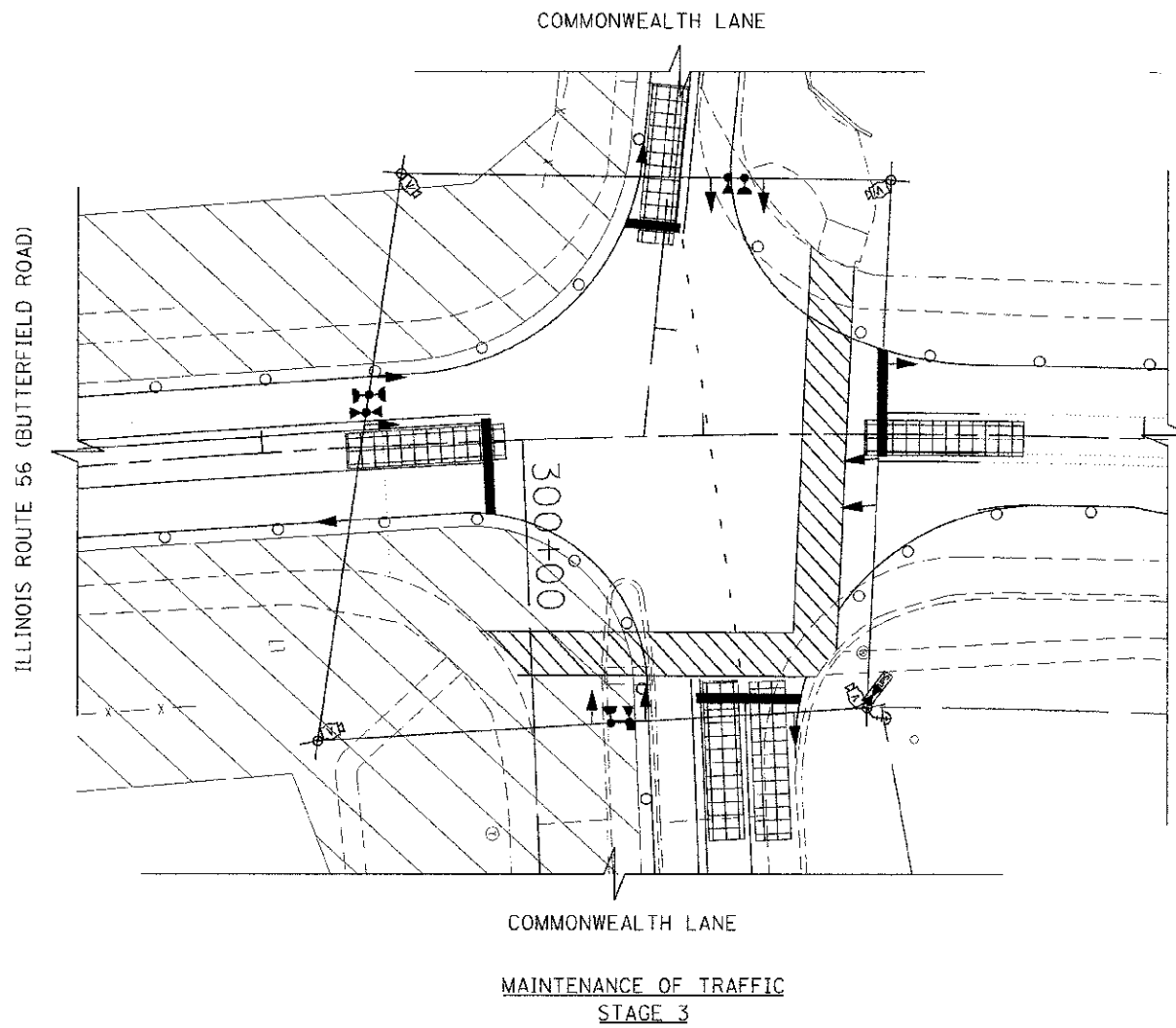

PLAN	SUPERVISOR	DATE
NOTE BOOK	ALIGNED	
NO.	REVISED	
	REVISED	
	REVISED	
	REVISED	
	REVISED	
	REVISED	

PROFILE	SUPERVISOR	DATE
NOTE BOOK	ALIGNED	
NO.	REVISED	
	REVISED	
	REVISED	
	REVISED	
	REVISED	
	REVISED	

FILE PATH = G:\DIRB\2008\Road\VTWGC_2\Sheet\13\DIRB20_13_Temp\Stage3.dwg



USER NAME = kalerenz	DESIGNED - JSL	REVISED - 10/10/12
FILE NAME = DLX2008-TS-Temp-Sheet3.dwg	DRAWN - JSL	REVISED - 12/13/12
PLOT SCALE = 23.00000 / 1 in.	CHECKED - HPJ	REVISED -
PLOT DATE = 12/17/2012	DATE - 10/22/2012	REVISED -

STATE OF ILLINOIS
DEPARTMENT OF TRANSPORTATION

ILLINOIS ROUTE 56 (BUTTERFIELD ROAD) AT COMMONWEALTH LANE
TEMPORARY TRAFFIC SIGNAL M.O.T. STAGING PLAN (2 of 2)
SCALE: 1"=20' SHEET NO. 45 OF 108 SHEETS

F.A.I. RTE.	SECTION	COUNTY	TOTAL SHEETS	SHEET NO.
3545	09-00170-00-CH	DUPAGE	106	45
FED. ROAD DIST. NO. 7 ILLINOIS FED. AID PROJECT			CONTRACT NO. 63742	