

NORTH CURB LINE

Location	Station	Offset	Theoretical Grade Elevations
West end of W. Appr. Slab	22757.12	-18.10	369.94
A	22767.06	-18.25	370.14
B	22777.01	-18.43	370.36
East end of W. Appr. Slab	22787.56	-18.66	370.59

NORTH EDGE OF ROADWAY

Location	Station	Offset	Theoretical Grade Elevations
West end of W. Appr. Slab	22753.58	-12.00	369.75
A	22763.54	-12.00	369.95
B	22773.51	-12.00	370.15
East end of W. Appr. Slab	22783.77	-12.00	370.38

☉ ROADWAY & PROFILE GRADE

Location	Station	Offset	Theoretical Grade Elevations
West end of W. Appr. Slab	22746.57	0.00	369.38
A	22756.57	0.00	369.57
B	22766.57	0.00	369.77
East end of W. Appr. Slab	22776.91	0.00	369.99

STAGE CONSTRUCTION JOINT

Location	Station	Offset	Theoretical Grade Elevations
West end of W. Appr. Slab	22744.93	2.79	369.29
A	22754.94	3.02	369.48
B	22764.95	3.22	369.67
East end of W. Appr. Slab	22774.96	3.40	369.88

SOUTH EDGE OF ROADWAY

Location	Station	Offset	Theoretical Grade Elevations
West end of W. Appr. Slab	22739.51	12.00	369.01
A	22749.54	12.00	369.19
B	22759.58	12.00	369.39
East end of W. Appr. Slab	22769.99	12.00	369.60

SOUTH CURB LINE

Location	Station	Offset	Theoretical Grade Elevations
West end of W. Appr. Slab	22735.82	18.23	368.82
A	22745.87	18.14	369.00
B	22755.92	18.02	369.20
East end of W. Appr. Slab	22766.59	17.86	369.41

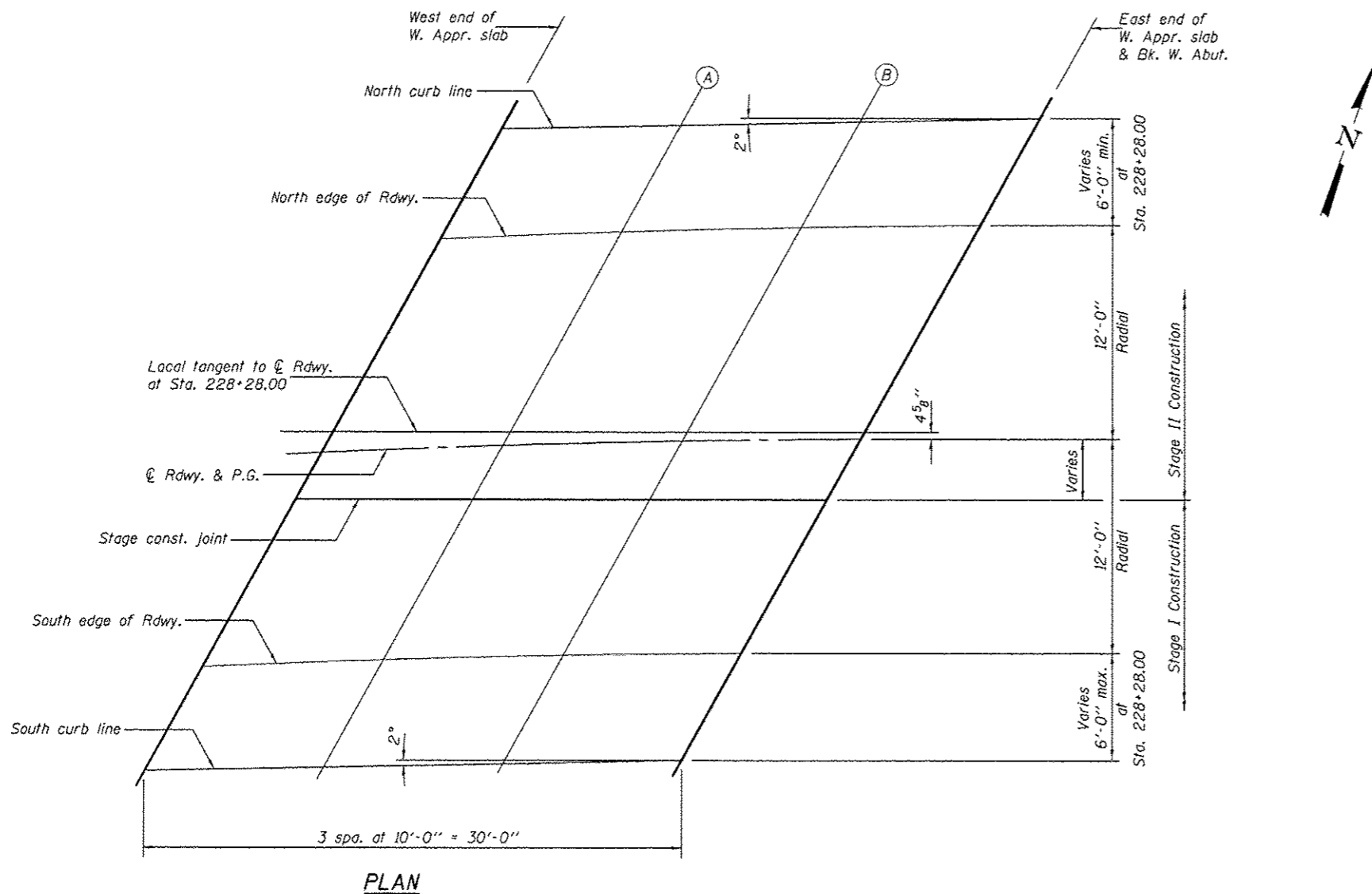

PLAN

⚠ SHEET ADDED 1-4-13

DESIGNED - Michael D. Rolape	EXAMINED - <i>John F. [Signature]</i>	DATE - NOVEMBER 21, 2012
CHECKED - Stephen M. Ryan	ACTING ENGINEER OF BRIDGE DESIGN	
DRAWN - h.f. duong	PASSED - <i>Carl [Signature]</i>	REVISED
CHECKED - GRA/SMR	ACTING ENGINEER OF BRIDGES AND STRUCTURES	REVISED

**STATE OF ILLINOIS
DEPARTMENT OF TRANSPORTATION**

**TOP OF WEST APPROACH SLAB ELEVATIONS
STRUCTURE NO. 035-0016**

SHEET NO. 7 OF 21 SHEETS

F.A.P. RTE. 885	SECTION 118-1	COUNTY HARDIN	TOTAL SHEETS 50	SHEET NO. 27
				CONTRACT NO. 78152
ILLINOIS FED. AID PROJECT				