

RTE.	SECTION	COUNTY	TOTAL SHEETS	SHEET NO.
*	2006-027 I	LAKE	31	15
FED. ROAD DIST. NO. 1		ILLINOIS	FED. AID PROJECT	

\* PARK ROADS IDNR File No. 2-03-025 B  
D91-401-06

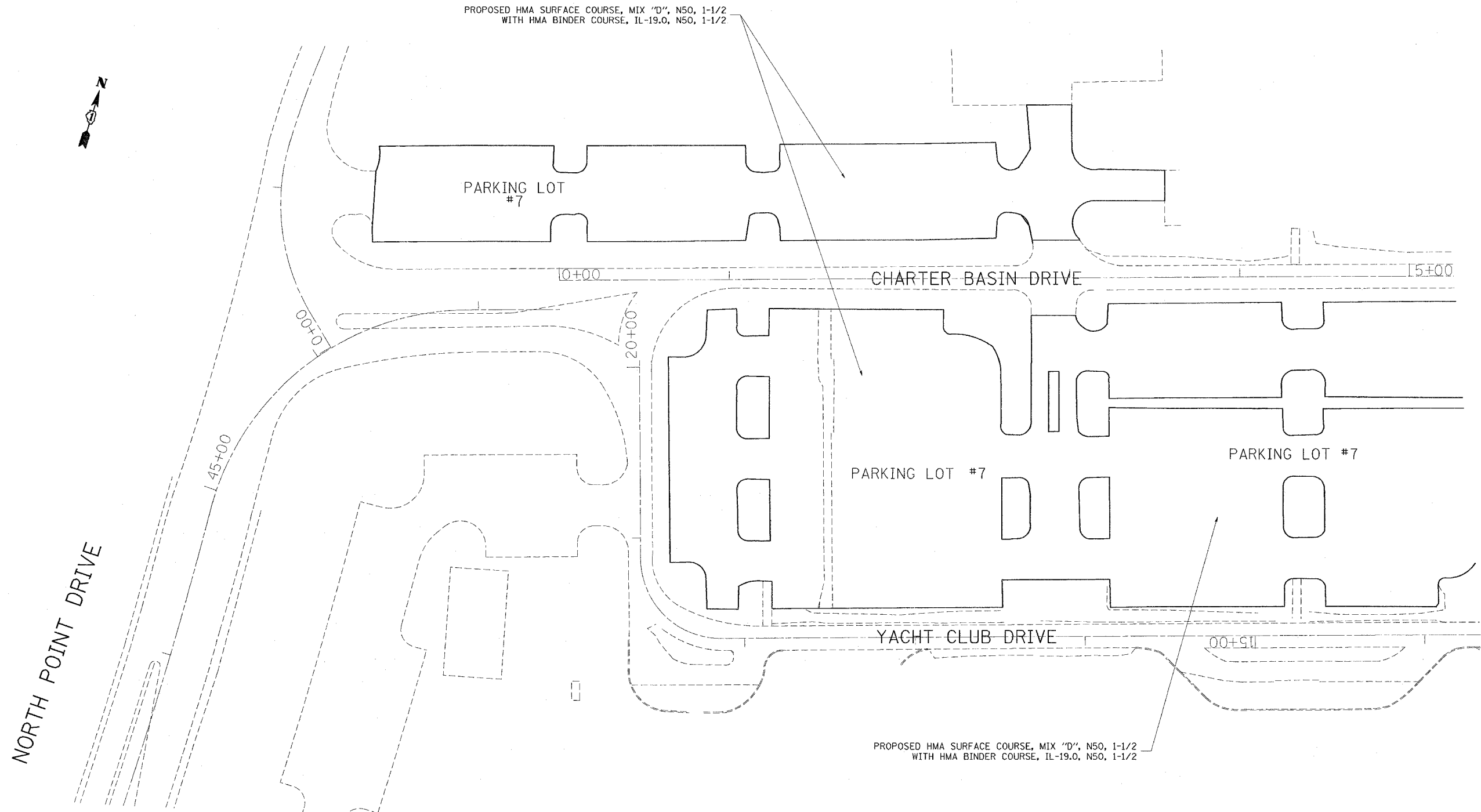

NOTE: RESURFACING LIMIT SHALL BE TO THE RAIDOUS RETURN AND/OR AS DIRECTIED BY THE ENGINEER

REVISIONS	
NAME	DATE

ILLINOIS DEPARTMENT OF TRANSPORTATION  
PARK ROADS  
LLINOIS BEACH STATE PARK  
NORTH POINT MARINA  
YACHT CLUB DRIVE  
PARKING LOT 7 NORTH SIDE  
PROPOSED PLAN

SCALE:  
DATE

DRAWN BY: CDT  
CHECKED BY

11/2/2006  
FILE NAME  
PLOT SCALE  
REFERENCE