

RTE.	SECTION	COUNTY	TOTAL SHEETS	SHEET NO.
*	2006-027 1	LAKE	31	24
FED. ROAD DIST. NO. 1	ILLINOIS	FED. AID PROJECT		
* PARK ROADS IDNR File No. 2-03-025 B D91-401-06				

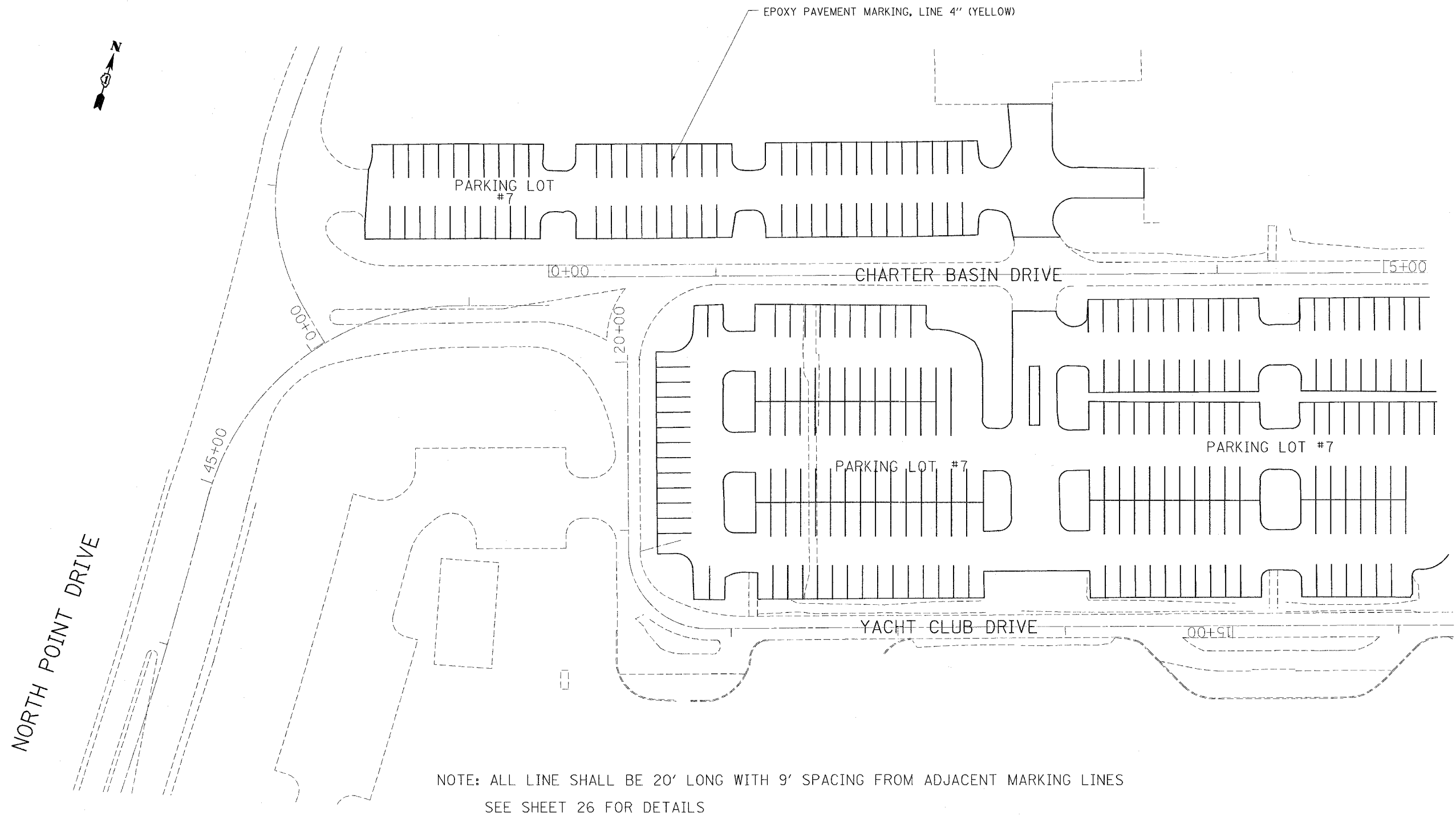

NOTE: ALL LINE SHALL BE 20' LONG WITH 9' SPACING FROM ADJACENT MARKING LINES
SEE SHEET 26 FOR DETAILS

REVISIONS	
NAME	DATE

ILLINOIS DEPARTMENT OF TRANSPORTATION
PARK ROADS
LLINOIS BEACH STATE PARK
NORTH POINT MARINA
CHARTER BASIN DRIVE
PARKING LOT 7 NORTH SIDE
PAVEMENT MARKING PLAN

SCALE: DATE DRAWN BY: CDT CHECKED BY:

11/12/2006
C:\p\2006\11\12\11134402\design-02
50.0000 7' IN.
REF#