

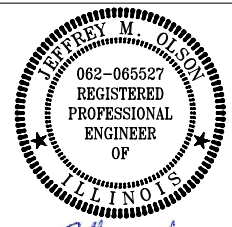

INDEX OF SHEETS	
SHEET NO.	SHEET TITLE
1	COVER SHEET
2	SUMMARY OF QUANTITIES AND INDEX TO SHEETS
3	SCOPE OF WORK
4	CONSTRUCTION SAFETY AND PHASING PLAN
5	CONSTRUCTION SAFETY NOTES AND DETAILS
6	TYPICAL SECTION
7	CIVIL SITE DEMOLITION PLAN
8	PROPOSED CONSTRUCTION PLAN
9	PROPOSED STAKING PLAN
10	PROPOSED GRADING AND DRAINAGE PLAN
11	DRAINAGE DETAILS

SUMMARY OF QUANTITIES				
ITEM NO.	DESCRIPTION	UNIT	TOTAL QUANTITY	AS-BUILT QUANTITY
AR150520	MOBILIZATION	L SUM	1.0	
AR152410	UNCLASSIFIED EXCAVATION	CU YD	625.0	
AR156510	SILT FENCE	FOOT	329.0	
AR201613	BIT. BASE CSE.-METHOD I, SUPERPAVE	TON	202.0	
AR209650	AGGREGATE BASE PREPARATION	SQ YD	2,446.0	
AR401613	BIT, SURF. CSE.-METHOD I, SUPERPAVE	TON	202.0	
AR401900	REMOVE BITUMINOUS PAVEMENT	SQ YD	28.0	
AR602510	BITUMINOUS PRIME COAT	GALLON	700.0	
AR603510	BITUMINOUS TACK COAT	GALLON	165.0	
AR620520	PAVEMENT MARKING-WATERBORNE	SQ FT	431.0	
AR701008	8" PVC STORM SEWER	FOOT	123.0	
AR701200	SLOTTED DRAIN	FOOT	189.0	
AR705506	6" PERFORATED UNDERDRAIN	FOOT	374.0	
AR705630	UNDERDRAIN INSPECTION HOLE	EACH	1.0	
AR705640	UNDERDRAIN CLEANOUT	EACH	1.0	
AR752208	METAL END SECTION 8"	EACH	1.0	
AR901510	SEEDING	ACRE	0.8	
AR908510	MULCHING	ACRE	0.8	



*Handwritten signature of Jeffrey M. Olson*

DATE SIGNED: 11/17/23 LICENSE EXPIRES: 11/30/25

**CONSTRUCT T-HANGAR PAVEMENTS**

IDA No: 910-5105  
SBGP No: N/A  
Contract No.: HV008

NO.	DATE	DESCRIPTION		
		DES	DWN	REV

ISSUE: NOVEMBER 17, 2023  
PROJECT NO: 23A0069D  
CAD FILE: G-002-FLP.DWG  
DESIGN BY: JMO 8/24/2023  
DRAWN BY: HLE 8/24/2023  
REVIEWED BY: JMO 11/17/2023

SHEET TITLE

**SUMMARY OF QUANTITIES AND INDEX TO SHEETS**

**GENERAL NOTES**

**QUANTITIES**

PAYMENT WILL BE MADE UNDER THE ITEM NUMBERS, DESCRIPTIONS AND UNITS NOTED IN THE ABOVE TABLE IN ACCORDANCE WITH THE BASIS OF PAYMENT FOR EACH RESPECTIVE WORK ITEM COMPLETED AND ACCEPTED BY THE ENGINEER.

**CERTIFIED PAYROLLS**

THE RESIDENT ENGINEER/TECHNICIAN CANNOT FORWARD CONSTRUCTION REPORTS TO THE ILLINOIS DIVISION OF AERONAUTICS FOR PROCESSING UNTIL ALL CERTIFIED PAYROLLS FOR THE PERIOD HAVE BEEN RECEIVED.

**MATERIAL CERTIFICATIONS**

MATERIALS TO BE INCORPORATED INTO THE PROJECT CANNOT BE USED WITHOUT PRIOR APPROVAL. ALL MATERIALS TO BE USED IN THE PROJECT MUST BE SUBMITTED TO THE RESIDENT ENGINEER/TECHNICIAN FOR APPROVAL. USE OF MATERIALS WITHOUT PRIOR APPROVAL AND ULTIMATELY DETERMINED TO BE UNACCEPTABLE BY THE ILLINOIS DIVISION OF AERONAUTICS ARE SUBJECT TO REMOVAL AND/OR NON-PAYMENT.

**NPDES PERMIT**

THIS PROJECT WILL NOT DISTURB MORE THAN 1 ACRE. THEREFORE A NPDES PERMIT IS NOT REQUIRED.

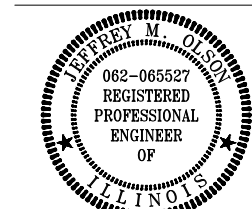

*Jeffrey M. Olson*

DATE SIGNED: 11/17/23 LICENSE EXPIRES: 11/30/25

**CONSTRUCT T-HANGAR PAVEMENTS**

IDA No: 910-5105  
SBGP No: N/A  
Contract No.: HV008

NO.	DATE	DESCRIPTION		
		DES	DWN	REV

ISSUE: NOVEMBER 17, 2023

PROJECT NO: 23A0069D

CAD FILE: C-101-SOW.DWG

DESIGN BY: JMO 8/24/2023

DRAWN BY: HLE 8/24/2023

REVIEWED BY: JMO 11/17/2023

SHEET TITLE

**SCOPE OF WORK**

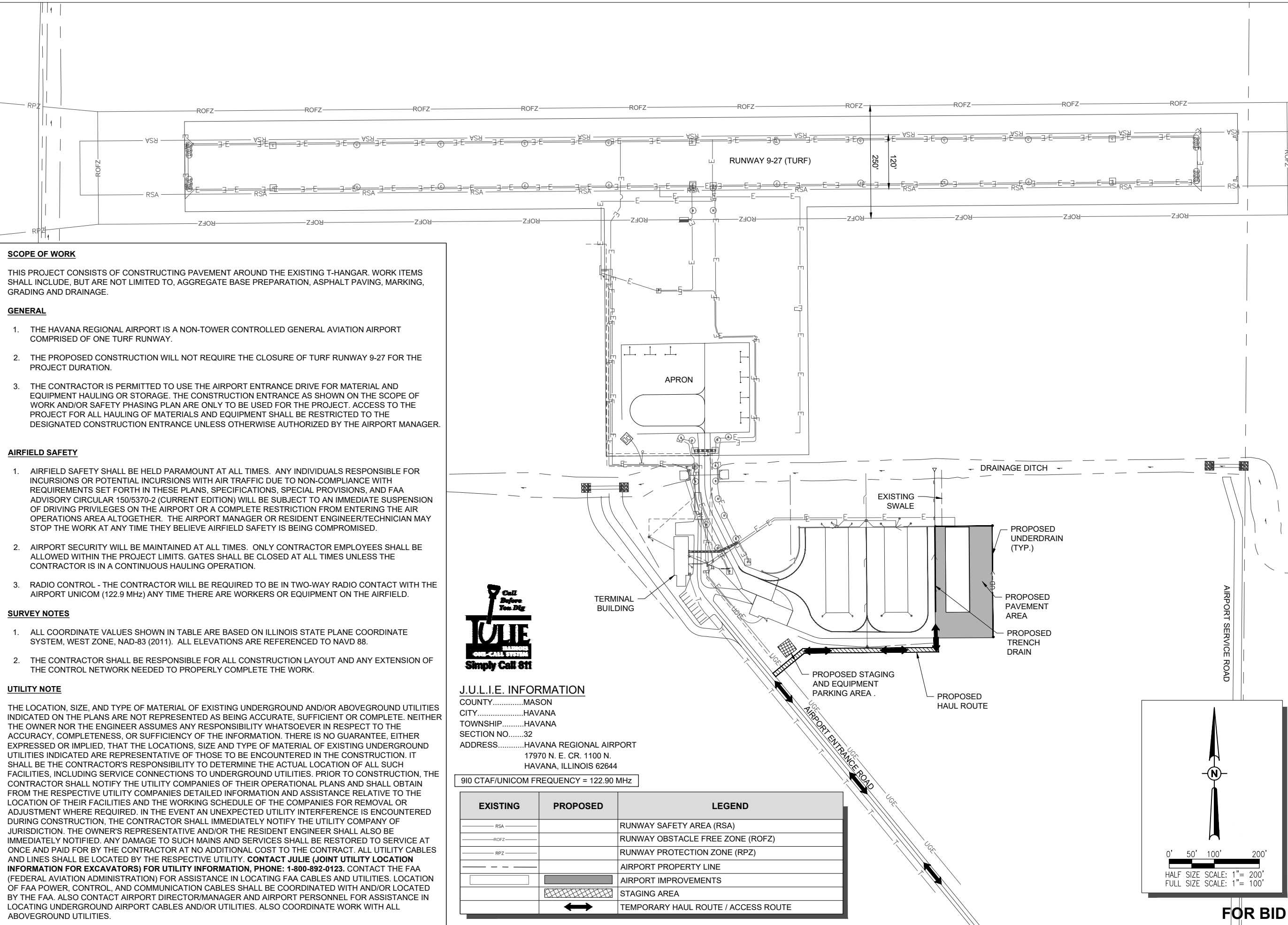

**SCOPE OF WORK**

THIS PROJECT CONSISTS OF CONSTRUCTING PAVEMENT AROUND THE EXISTING T-HANGAR. WORK ITEMS SHALL INCLUDE, BUT ARE NOT LIMITED TO, AGGREGATE BASE PREPARATION, ASPHALT PAVING, MARKING, GRADING AND DRAINAGE.

**GENERAL**

1. THE HAVANA REGIONAL AIRPORT IS A NON-TOWER CONTROLLED GENERAL AVIATION AIRPORT COMPRISED OF ONE TURF RUNWAY.
2. THE PROPOSED CONSTRUCTION WILL NOT REQUIRE THE CLOSURE OF TURF RUNWAY 9-27 FOR THE PROJECT DURATION.
3. THE CONTRACTOR IS PERMITTED TO USE THE AIRPORT ENTRANCE DRIVE FOR MATERIAL AND EQUIPMENT HAULING OR STORAGE. THE CONSTRUCTION ENTRANCE AS SHOWN ON THE SCOPE OF WORK AND/OR SAFETY PHASING PLAN ARE ONLY TO BE USED FOR THE PROJECT. ACCESS TO THE PROJECT FOR ALL HAULING OF MATERIALS AND EQUIPMENT SHALL BE RESTRICTED TO THE DESIGNATED CONSTRUCTION ENTRANCE UNLESS OTHERWISE AUTHORIZED BY THE AIRPORT MANAGER.

**AIRFIELD SAFETY**

1. AIRFIELD SAFETY SHALL BE HELD PARAMOUNT AT ALL TIMES. ANY INDIVIDUALS RESPONSIBLE FOR INCURSIONS OR POTENTIAL INCURSIONS WITH AIR TRAFFIC DUE TO NON-COMPLIANCE WITH REQUIREMENTS SET FORTH IN THESE PLANS, SPECIFICATIONS, SPECIAL PROVISIONS, AND FAA ADVISORY CIRCULAR 150/5370-2 (CURRENT EDITION) WILL BE SUBJECT TO AN IMMEDIATE SUSPENSION OF DRIVING PRIVILEGES ON THE AIRPORT OR A COMPLETE RESTRICTION FROM ENTERING THE AIR OPERATIONS AREA ALTOGETHER. THE AIRPORT MANAGER OR RESIDENT ENGINEER/TECHNICIAN MAY STOP THE WORK AT ANY TIME THEY BELIEVE AIRFIELD SAFETY IS BEING COMPROMISED.
2. AIRPORT SECURITY WILL BE MAINTAINED AT ALL TIMES. ONLY CONTRACTOR EMPLOYEES SHALL BE ALLOWED WITHIN THE PROJECT LIMITS. GATES SHALL BE CLOSED AT ALL TIMES UNLESS THE CONTRACTOR IS IN A CONTINUOUS HAULING OPERATION.
3. RADIO CONTROL - THE CONTRACTOR WILL BE REQUIRED TO BE IN TWO-WAY RADIO CONTACT WITH THE AIRPORT UNICOM (122.9 MHz) ANY TIME THERE ARE WORKERS OR EQUIPMENT ON THE AIRFIELD.

**SURVEY NOTES**

1. ALL COORDINATE VALUES SHOWN IN TABLE ARE BASED ON ILLINOIS STATE PLANE COORDINATE SYSTEM, WEST ZONE, NAD-83 (2011). ALL ELEVATIONS ARE REFERENCED TO NAVD 88.
2. THE CONTRACTOR SHALL BE RESPONSIBLE FOR ALL CONSTRUCTION LAYOUT AND ANY EXTENSION OF THE CONTROL NETWORK NEEDED TO PROPERLY COMPLETE THE WORK.

**UTILITY NOTE**

THE LOCATION, SIZE, AND TYPE OF MATERIAL OF EXISTING UNDERGROUND AND/OR ABOVEGROUND UTILITIES INDICATED ON THE PLANS ARE NOT REPRESENTED AS BEING ACCURATE, SUFFICIENT OR COMPLETE. NEITHER THE OWNER NOR THE ENGINEER ASSUMES ANY RESPONSIBILITY WHATSOEVER IN RESPECT TO THE ACCURACY, COMPLETENESS, OR SUFFICIENCY OF THE INFORMATION. THERE IS NO GUARANTEE, EITHER EXPRESSED OR IMPLIED, THAT THE LOCATIONS, SIZE AND TYPE OF MATERIAL OF EXISTING UNDERGROUND UTILITIES INDICATED ARE REPRESENTATIVE OF THOSE TO BE ENCOUNTERED IN THE CONSTRUCTION. IT SHALL BE THE CONTRACTOR'S RESPONSIBILITY TO DETERMINE THE ACTUAL LOCATION OF ALL SUCH FACILITIES, INCLUDING SERVICE CONNECTIONS TO UNDERGROUND UTILITIES. PRIOR TO CONSTRUCTION, THE CONTRACTOR SHALL NOTIFY THE UTILITY COMPANIES OF THEIR OPERATIONAL PLANS AND SHALL OBTAIN FROM THE RESPECTIVE UTILITY COMPANIES DETAILED INFORMATION AND ASSISTANCE RELATIVE TO THE LOCATION OF THEIR FACILITIES AND THE WORKING SCHEDULE OF THE COMPANIES FOR REMOVAL OR ADJUSTMENT WHERE REQUIRED. IN THE EVENT AN UNEXPECTED UTILITY INTERFERENCE IS ENCOUNTERED DURING CONSTRUCTION, THE CONTRACTOR SHALL IMMEDIATELY NOTIFY THE UTILITY COMPANY OF JURISDICTION. THE OWNER'S REPRESENTATIVE AND/OR THE RESIDENT ENGINEER SHALL ALSO BE IMMEDIATELY NOTIFIED. ANY DAMAGE TO SUCH MAINS AND SERVICES SHALL BE RESTORED TO SERVICE AT ONCE AND PAID FOR BY THE CONTRACTOR AT NO ADDITIONAL COST TO THE CONTRACT. ALL UTILITY CABLES AND LINES SHALL BE LOCATED BY THE RESPECTIVE UTILITY. **CONTACT JULIE (JOINT UTILITY LOCATION INFORMATION FOR EXCAVATORS) FOR UTILITY INFORMATION, PHONE: 1-800-892-0123.** CONTACT THE FAA (FEDERAL AVIATION ADMINISTRATION) FOR ASSISTANCE IN LOCATING FAA CABLES AND UTILITIES. LOCATION OF FAA POWER, CONTROL, AND COMMUNICATION CABLES SHALL BE COORDINATED WITH AND/OR LOCATED BY THE FAA. ALSO CONTACT AIRPORT DIRECTOR/MANAGER AND AIRPORT PERSONNEL FOR ASSISTANCE IN LOCATING UNDERGROUND AIRPORT CABLES AND/OR UTILITIES. ALSO COORDINATE WORK WITH ALL ABOVEGROUND UTILITIES.



**J.U.L.I.E. INFORMATION**  
 COUNTY.....MASON  
 CITY.....HAVANA  
 TOWNSHIP.....HAVANA  
 SECTION NO.....32  
 ADDRESS.....HAVANA REGIONAL AIRPORT  
 17970 N. E. CR. 1100 N.  
 HAVANA, ILLINOIS 62644

910 CTAF/UNICOM FREQUENCY = 122.90 MHz

EXISTING	PROPOSED	LEGEND
---	---	RUNWAY SAFETY AREA (RSA)
---	---	RUNWAY OBSTACLE FREE ZONE (ROFZ)
---	---	RUNWAY PROTECTION ZONE (RPZ)
---	---	AIRPORT PROPERTY LINE
---	---	AIRPORT IMPROVEMENTS
---	---	STAGING AREA
---	---	TEMPORARY HAUL ROUTE / ACCESS ROUTE

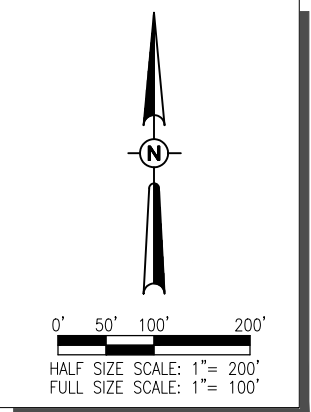

**FOR BID**

**PROPOSED SAFETY PLAN**

GENERAL - THE HAVANA REGIONAL AIRPORT IS COMPRISED OF ONE TURF RUNWAY. THE PROPOSED CONSTRUCTION WILL NOT NECESSITATE CLOSING THIS RUNWAY.

IDENTIFICATION - WHEN THE CONTRACTORS VEHICLES AND EQUIPMENT ARE ON THE AIRPORT THEY SHALL BE PROPERLY MARKED WITH THREE (3) FOOT SQUARE CHECKERED FLAGS (INTERNATIONAL ORANGE AND WHITE). THE CONTRACTOR WILL ALSO PROVIDE WORKERS WITH SOME TYPE OF TAG OR GARMENT TO IDENTIFY THE PERSON AS BEING PART OF THE CONSTRUCTION CREW.

RADIO CONTROL - THE CONTRACTOR WILL BE REQUIRED TO BE IN TWO-WAY RADIO CONTACT (122.90 MHz) WITH THE AIRPORT UNICOM. THIS WILL KEEP THE CONTRACTOR IN CONSTANT CONTACT WITH THE HAVANA REGIONAL AIRPORT AND ENABLE THE AIRPORT TO IMMEDIATELY CONTACT THE CONTRACTOR IN CASE OF AN AERONAUTICAL EMERGENCY THAT WOULD REQUIRE ACTION BY THE CONTRACTOR AND/OR THEIR PERSONNEL.

**SAFETY PLAN COMPLIANCE DOCUMENT**

PRIOR TO THE ISSUANCE OF A CONSTRUCTION NOTICE-TO-PROCEED (NTP), THE CONTRACTOR SHALL BE RESPONSIBLE FOR PREPARING AND SUBMITTING A SAFETY PLAN COMPLIANCE DOCUMENT IN ACCORDANCE WITH FAA ADVISORY CIRCULAR 150/5370-2G, PARAGRAPH 2.4.2, OR EQUIVALENT SECTION IN SUBSEQUENT/CURRENT ISSUE. THE AIRPORT DIRECTOR SHALL APPROVE THIS DOCUMENT AND SUBMIT TO THE AIRPORT AUTHORITY FOR APPROVAL PRIOR TO THE NTP ISSUANCE.

**AIRPORT SECURITY NOTE**

AIRPORT SECURITY WILL BE MAINTAINED AT ALL TIMES. THE CONTRACTOR WILL CLOSE THE EXISTING GATE AT THE END OF EACH WORKING DAY.

**HEIGHT OF CONSTRUCTION EQUIPMENT**

THE MAXIMUM ANTICIPATED HEIGHT OF THE CONSTRUCTION EQUIPMENT WILL BE 25 FEET, WHICH IS EXPECTED TO BE A TRACTOR AND TRAILER FULLY EXTENDED OR A LINE TRUCK.

**EROSION CONTROL**

THIS PROJECT WILL NOT DISTURB MORE THAN 1 ACRE OF LAND, THEREFORE, A N.P.D.E.S. PERMIT WILL NOT BE REQUIRED.



Engineering | Architecture | Planning | Allied Services

Offices Nationwide  
www.hanson-inc.com

Hanson Professional Services Inc.  
1525 S. 6th Street  
Springfield, IL 62568  
phone: 217-788-2450  
fax: 217-788-2503

Illinois Licensed  
Professional Service Corporation  
#184-001084

HAVANA REGIONAL AIRPORT  
17970 E Cr 1100n  
Havana, Illinois 62644  
Telephone: 309.543.9006

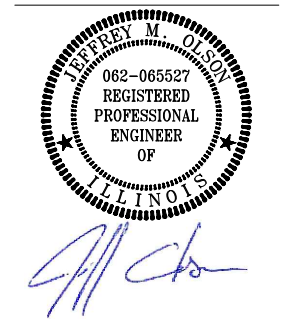

DATE SIGNED: 11/17/23 LICENSE EXPIRES: 11/30/25

**CONSTRUCT T-HANGAR PAVEMENTS**

IDA No: 910-5105  
SBGP No: N/A  
Contract No.: HV008

NO.	DATE	DESCRIPTION		
		DES	DWN	REV

ISSUE: NOVEMBER 17, 2023  
PROJECT NO: 23A0069D  
CAD FILE: C-102-CSPP.DWG  
DESIGN BY: JMO 9/27/2023  
DRAWN BY: HLE 9/27/2023  
REVIEWED BY: JMO 11/17/2023

SHEET TITLE

**CONSTRUCTION SAFETY AND PHASING PLAN**

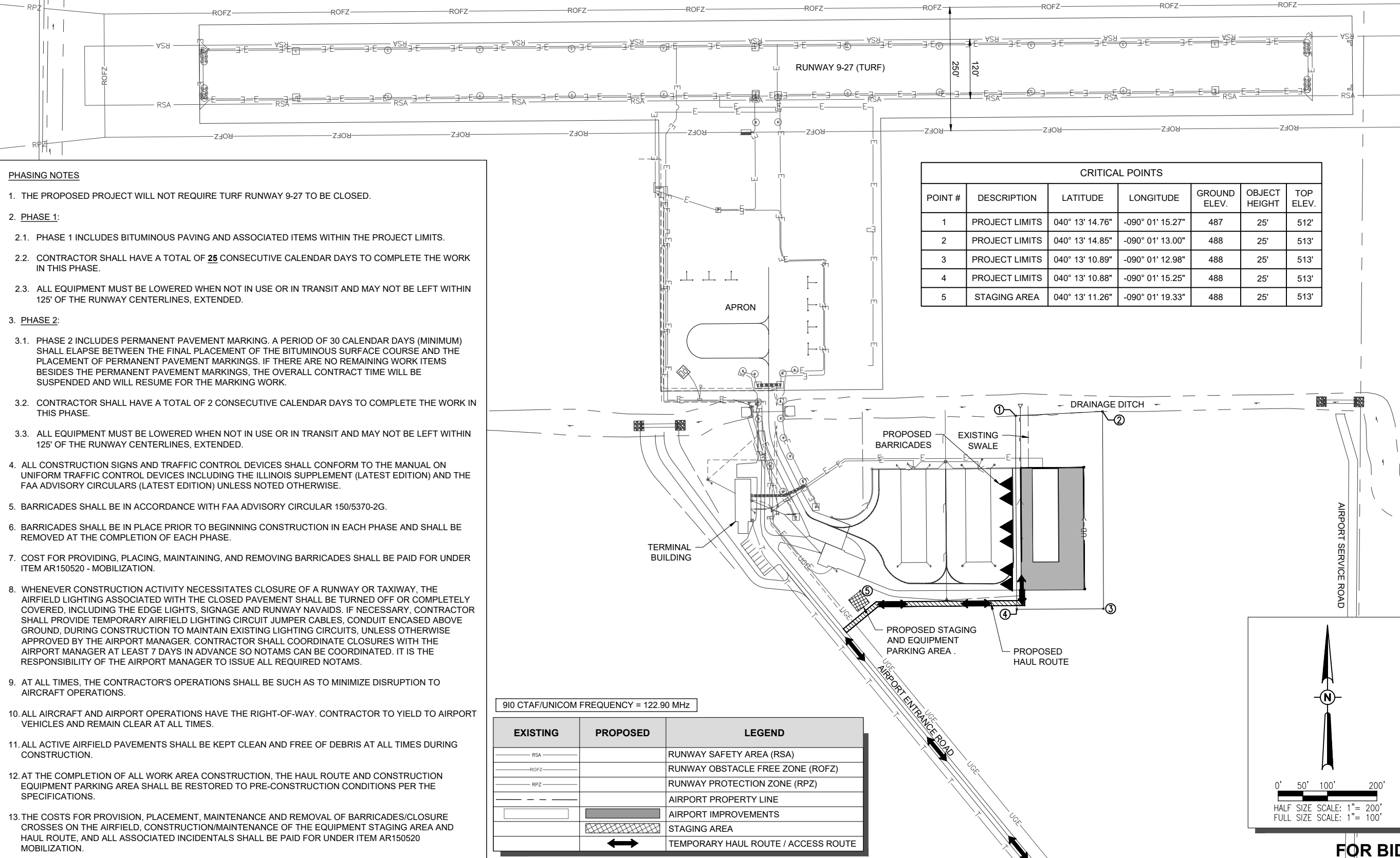

CRITICAL POINTS						
POINT #	DESCRIPTION	LATITUDE	LONGITUDE	GROUND ELEV.	OBJECT HEIGHT	TOP ELEV.
1	PROJECT LIMITS	040° 13' 14.76"	-090° 01' 15.27"	487	25'	512'
2	PROJECT LIMITS	040° 13' 14.85"	-090° 01' 13.00"	488	25'	513'
3	PROJECT LIMITS	040° 13' 10.89"	-090° 01' 12.98"	488	25'	513'
4	PROJECT LIMITS	040° 13' 10.88"	-090° 01' 15.25"	488	25'	513'
5	STAGING AREA	040° 13' 11.26"	-090° 01' 19.33"	488	25'	513'

- PHASING NOTES**
- THE PROPOSED PROJECT WILL NOT REQUIRE TURF RUNWAY 9-27 TO BE CLOSED.
  - PHASE 1:**
    - PHASE 1 INCLUDES BITUMINOUS PAVING AND ASSOCIATED ITEMS WITHIN THE PROJECT LIMITS.
    - CONTRACTOR SHALL HAVE A TOTAL OF **25** CONSECUTIVE CALENDAR DAYS TO COMPLETE THE WORK IN THIS PHASE.
    - ALL EQUIPMENT MUST BE LOWERED WHEN NOT IN USE OR IN TRANSIT AND MAY NOT BE LEFT WITHIN 125' OF THE RUNWAY CENTERLINES, EXTENDED.
  - PHASE 2:**
    - PHASE 2 INCLUDES PERMANENT PAVEMENT MARKING. A PERIOD OF 30 CALENDAR DAYS (MINIMUM) SHALL ELAPSE BETWEEN THE FINAL PLACEMENT OF THE BITUMINOUS SURFACE COURSE AND THE PLACEMENT OF PERMANENT PAVEMENT MARKINGS. IF THERE ARE NO REMAINING WORK ITEMS BESIDES THE PERMANENT PAVEMENT MARKINGS, THE OVERALL CONTRACT TIME WILL BE SUSPENDED AND WILL RESUME FOR THE MARKING WORK.
    - CONTRACTOR SHALL HAVE A TOTAL OF 2 CONSECUTIVE CALENDAR DAYS TO COMPLETE THE WORK IN THIS PHASE.
    - ALL EQUIPMENT MUST BE LOWERED WHEN NOT IN USE OR IN TRANSIT AND MAY NOT BE LEFT WITHIN 125' OF THE RUNWAY CENTERLINES, EXTENDED.
  - ALL CONSTRUCTION SIGNS AND TRAFFIC CONTROL DEVICES SHALL CONFORM TO THE MANUAL ON UNIFORM TRAFFIC CONTROL DEVICES INCLUDING THE ILLINOIS SUPPLEMENT (LATEST EDITION) AND THE FAA ADVISORY CIRCULARS (LATEST EDITION) UNLESS NOTED OTHERWISE.
  - BARRICADES SHALL BE IN ACCORDANCE WITH FAA ADVISORY CIRCULAR 150/5370-2G.
  - BARRICADES SHALL BE IN PLACE PRIOR TO BEGINNING CONSTRUCTION IN EACH PHASE AND SHALL BE REMOVED AT THE COMPLETION OF EACH PHASE.
  - COST FOR PROVIDING, PLACING, MAINTAINING, AND REMOVING BARRICADES SHALL BE PAID FOR UNDER ITEM AR150520 - MOBILIZATION.
  - WHENEVER CONSTRUCTION ACTIVITY NECESSITATES CLOSURE OF A RUNWAY OR TAXIWAY, THE AIRFIELD LIGHTING ASSOCIATED WITH THE CLOSED PAVEMENT SHALL BE TURNED OFF OR COMPLETELY COVERED, INCLUDING THE EDGE LIGHTS, SIGNAGE AND RUNWAY NAVAIDS. IF NECESSARY, CONTRACTOR SHALL PROVIDE TEMPORARY AIRFIELD LIGHTING CIRCUIT JUMPER CABLES, CONDUIT ENCASED ABOVE GROUND, DURING CONSTRUCTION TO MAINTAIN EXISTING LIGHTING CIRCUITS. UNLESS OTHERWISE APPROVED BY THE AIRPORT MANAGER, CONTRACTOR SHALL COORDINATE CLOSURES WITH THE AIRPORT MANAGER AT LEAST 7 DAYS IN ADVANCE SO NOTAMS CAN BE COORDINATED. IT IS THE RESPONSIBILITY OF THE AIRPORT MANAGER TO ISSUE ALL REQUIRED NOTAMS.
  - AT ALL TIMES, THE CONTRACTOR'S OPERATIONS SHALL BE SUCH AS TO MINIMIZE DISRUPTION TO AIRCRAFT OPERATIONS.
  - ALL AIRCRAFT AND AIRPORT OPERATIONS HAVE THE RIGHT-OF-WAY. CONTRACTOR TO YIELD TO AIRPORT VEHICLES AND REMAIN CLEAR AT ALL TIMES.
  - ALL ACTIVE AIRFIELD PAVEMENTS SHALL BE KEPT CLEAN AND FREE OF DEBRIS AT ALL TIMES DURING CONSTRUCTION.
  - AT THE COMPLETION OF ALL WORK AREA CONSTRUCTION, THE HAUL ROUTE AND CONSTRUCTION EQUIPMENT PARKING AREA SHALL BE RESTORED TO PRE-CONSTRUCTION CONDITIONS PER THE SPECIFICATIONS.
  - THE COSTS FOR PROVISION, PLACEMENT, MAINTENANCE AND REMOVAL OF BARRICADES/CLOSURE CROSSES ON THE AIRFIELD, CONSTRUCTION/MAINTENANCE OF THE EQUIPMENT STAGING AREA AND HAUL ROUTE, AND ALL ASSOCIATED INCIDENTALS SHALL BE PAID FOR UNDER ITEM AR150520 MOBILIZATION.

910 CTAF/UNICOM FREQUENCY = 122.90 MHz

EXISTING	PROPOSED	LEGEND
— RSA —		RUNWAY SAFETY AREA (RSA)
— ROFZ —		RUNWAY OBSTACLE FREE ZONE (ROFZ)
— RPZ —		RUNWAY PROTECTION ZONE (RPZ)
	—	AIRPORT PROPERTY LINE
	▭	AIRPORT IMPROVEMENTS
	▨	STAGING AREA
	↔	TEMPORARY HAUL ROUTE / ACCESS ROUTE

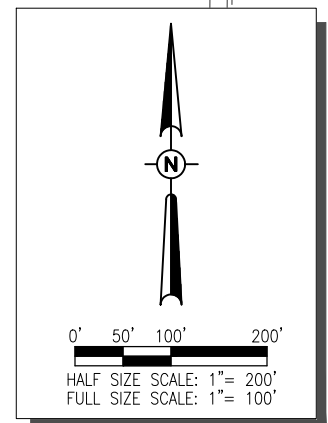

**FOR BID**

NOV 17, 2023 1:00 PM ENGELO1909 1:23:03\23A0069D\CAD\AIRPORT\SHEETC-102-CSPP.DWG

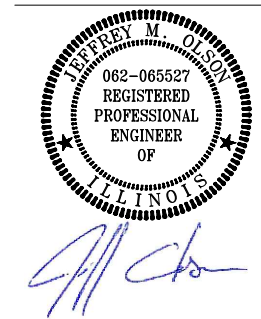

DATE SIGNED: 11/17/23 LICENSE EXPIRES: 11/30/25

**CONSTRUCT T-HANGAR PAVEMENTS**

IDA No: 910-5105  
SBGP No: N/A  
Contract No.: HV008

NO.	DATE	DESCRIPTION		
		DES	DWN	REV

ISSUE: NOVEMBER 17, 2023  
PROJECT NO: 23A0069D  
CAD FILE: C-102-CSPP.DWG  
DESIGN BY: JMO 9/27/2023  
DRAWN BY: HLE 9/27/2023  
REVIEWED BY: JMO 11/17/2023

SHEET TITLE

**CONSTRUCTION SAFETY NOTES AND DETAILS**

**SAFETY NOTES**

- THE FOLLOWING NOTES ARE THE CONSTRUCTION SAFETY PROCEDURES THAT THE CONTRACTOR SHALL FOLLOW THROUGHOUT THIS PROJECT. ADDITIONAL REQUIREMENTS ARE SHOWN ON THE CONSTRUCTION SAFETY AND PHASING PLAN SHEET AND THIS SHEET.
- ALL PROVISIONS OF THE LATEST EDITION OF FAA ADVISORY CIRCULAR AC 150/5370-2G (CURRENT EDITION), "OPERATIONAL SAFETY ON AIRPORTS DURING CONSTRUCTION", APPLY TO THIS CONTRACT, EXCEPT AS MODIFIED BY THIS SAFETY PLAN, OR AS MODIFIED BY THE OWNER THROUGH THE RESIDENT ENGINEER/TECHNICIAN AT THE PRECONSTRUCTION CONFERENCE, OR DURING THE COURSE OF THE CONTRACT.
- THE CONTRACTORS SHALL MINIMIZE DISRUPTION OF STANDARD OPERATING PROCEDURES FOR AERONAUTICAL ACTIVITY BY REMAINING WITHIN THE PRESCRIBED STAGING, CONSTRUCTION, AND PHASING AREAS PRESENTED ON THE CONSTRUCTION SAFETY AND PHASING PLAN SHEETS.
- NO UNAUTHORIZED PERSONNEL SHALL ENTER ANY AREA OF THE AIRPORT THAT COULD POTENTIALLY BE HAZARDOUS. THE AIRPORT MANAGER RESERVES THE RIGHT TO SUSPEND OPERATIONS IN ORDER TO MAINTAIN SAFETY AT THE AIRPORT.
- CONTRACTOR EQUIPMENT, VEHICLES, AND PROJECT MATERIALS SHALL BE STORED AT THE STAGING AREA SHOWN ON THE PLAN VIEW, EXCEPT AS OTHERWISE PROVIDED FOR AT THE PRE-CONSTRUCTION CONFERENCE.
- ALL CONSTRUCTION EQUIPMENT OPERATING IN THE PRESCRIBED CONSTRUCTION AREA IS REQUIRED TO DISPLAY A CHECKERBOARD FLAG PROPERLY LOCATED OR A ROTATING BEACON (STROBE) AS SPECIFIED IN AC 150/5210-5D, "PAINTING, MARKING, AND LIGHTING OF VEHICLES USED ON AN AIRPORT" LATEST EDITION.
- NO CONSTRUCTION MATERIAL STOCKPILES SHALL BE LOCATED WITHIN 125' OF THE ACTIVE RUNWAY CENTERLINE, WITHIN 44.5' OF ANY OTHER ACTIVE AIRPORT OPERATIONS AREA (EX. TAXIWAY), OR PENETRATE A PART 77 IMAGINARY SURFACE (PROVIDED BY THE RESIDENT ENGINEER/TECHNICIAN) EXTENDING OUT AND UPWARDS FROM ALL SIDES OF AN ACTIVE RUNWAY.
- CLOSED AIRFIELD PHASING AREAS, OPEN TRENCHES, AND STOCKPILED MATERIALS AT THE CONSTRUCTION SITE SHALL BE PROMINENTLY MARKED WITH LIGHTED BARRICADES WITH STEADY BURNING OR FLASHING RED LIGHTS AS SPECIFIED IN 150/5370-2G, "OPERATIONAL SAFETY ON AIRPORT DURING CONSTRUCTION, LATEST EDITION. LIGHTED BARRICADES MUST BE NO TALLER THAN 18" (EXCLUSIVE OF SUPPLEMENTARY LIGHTS AND FLAGS) ON THE TAXIWAYS AND COMPLY WITH ADVISORY CIRCULAR 150/5370-2G, LATEST EDITION. CONTRACTOR SHALL NIGHT CHECK BARRICADES DAILY FOR PROPER OPERATION.
- NO OPEN TRENCHES WITHIN 125' OF AN ACTIVE RUNWAY CENTERLINE OR WITHIN 44.5' OF ANY TAXIWAY CENTERLINE WILL BE PERMITTED UNLESS APPROPRIATELY BACKFILLED OR COVERED. COVERING FOR OPEN TRENCHES MUST BE DESIGNED TO ALLOW SAFE OPERATIONS OF THE HEAVIEST AIRCRAFT OPERATING ON THE RUNWAY/TAXIWAY ACROSS THE TRENCH WITHOUT DAMAGING THE AIRCRAFT. OTHER TRENCHES SHALL BE MAINTAINED SAFE, I.E., BARRICADED OR COVERED WITH STEEL PLATES IN ALL OTHER AREAS.
- OPEN TRENCHES, EXCAVATIONS, AND STOCKPILED MATERIALS AT THE CONSTRUCTION SITE SHOULD BE PROMINENTLY MARKED WITH ORANGE FLAGS AND LIGHTED WITH FLASHING RED LIGHTS DURING HOURS OF RESTRICTED VISIBILITY AND/OR DARKNESS.
- NO CONSTRUCTION EQUIPMENT GREATER THAN 25' TALL WILL BE PERMITTED ON THE AIRPORT UNLESS PERMITTED WITH THE APPROVAL OF THE AIRPORT MANAGER AND AIRSPACE APPROVAL BY THE FAA.
- NO OPEN FLAME WELDING OR TORCH CUTTING OPERATION IS PERMITTED UNLESS ADEQUATE FIRE AND SAFETY PRECAUTIONS ARE PROVIDED AND HAVE BEEN APPROVED BY THE AIRPORT MANAGER NO FLARE POTS ARE ALLOWED ON THE PROJECT.
- SOIL, DEBRIS, AND LOOSE MATERIAL DROPPED OR TRACKED ONTO AIRPORT ROADS, TAXIWAYS, AND SOD SURFACES, OR WHICH CAN BE BLOWN ONTO SUCH SURFACES, SHALL BE IMMEDIATELY SWEEPED, PICKED UP AND REMOVED, OR PLACED INTO CLOSED CONTAINERS. ANY DAMAGE TO AIRPORT PROPERTY SHALL BE REPAIRED IMMEDIATELY AT NO COST TO THE OWNER.
- EACH CONTRACTOR SHALL BE RESPONSIBLE FOR LOCATING AND MAINTAINING AIRPORT LIGHTING AND NAVIGATIONAL ELECTRICAL SYSTEMS DURING CONSTRUCTION. A CONTACT PERSON AND TELEPHONE NUMBER FOR 24 HOUR EMERGENCY IMMEDIATE REPAIR SHALL BE SUBMITTED TO THE AIRPORT MANAGER AND RESIDENT ENGINEER/TECHNICIAN. HAUL ROUTES CROSSING PAVEMENT, DRAINAGE, MISCELLANEOUS. STRUCTURES AND/OR AIRFIELD CABLES SHALL BE PROTECTED FROM DAMAGE.
- ALL AIRCRAFT AND AIRPORT OPERATIONS HAVE THE RIGHT-OF-WAY. CONTRACTOR TO YIELD TO VEHICLES AND REMAIN CLEAR AT ALL TIMES.
- CONTRACTOR SHALL PLACE, SECURE, AND MAINTAIN LIGHTED BARRICADES AND CLOSURE CROSSES WHEN A RUNWAY/TAXIWAY/APRON IS CLOSED OR AS REQUIRED BY THE PLANS AND DESIGNATED BY THE RESIDENT ENGINEER/TECHNICIAN.
- CONTRACTOR SHALL MARK HAZARDOUS AREA WITH STEADY-BURNING OR FLASHING RED LIGHTS DURING PERIODS OF LOW VISIBILITY AS REQUIRED.
- THE CONTRACTOR SHALL PERIODICALLY PERFORM ONSITE INSPECTIONS THROUGHOUT THE DURATION OF THE PROJECT WITH THE IMMEDIATE REMEDY OF ANY DIFFERENCES, WHETHER CAUSED BY NEGLIGENCE, OVERSIGHT, OR PROJECT SCOPE CHANGE.
- CONTRACTOR SHALL MOVE MAINTENANCE OF TRAFFIC COMPONENTS AT THE WRITTEN DIRECTION OF THE RESIDENT ENGINEER/TECHNICIAN AT NO ADDITIONAL COST.
- CONTRACTOR SHALL NOT REMOVE THE BARRICADES WITHOUT THE APPROVAL BY THE RESIDENT ENGINEER/TECHNICIAN.
- CONTRACTOR SHALL MAINTAIN FLASHERS, SIGNS AND/OR BARRICADES AS REQUIRED BY THE PLANS, CITY OR COUNTY REGULATIONS OR CONTRACTOR ACTIVITIES. CONTRACTOR SHALL OBTAIN ANY AND ALL REQUIRED LOCAL PERMITS UNLESS SPECIFIED OTHERWISE.
- THE CONTRACTOR SHALL UTILIZE WATER AND/OR CHEMICALS APPROVED BY THE RESIDENT ENGINEER/TECHNICIAN AS NECESSARY TO CONTROL DUST.
- NO CONSTRUCTION VEHICLES SHALL BE DRIVEN ACROSS THE TURF RUNWAY. CONSTRUCTION EQUIPMENT OR CONSTRUCTION ACTIVITY WILL NOT BE PERMITTED WITHIN 125' OF ANY ACTIVE RUNWAY CENTERLINE OR WITHIN 44.5' OF ANY OTHER ACTIVE AIRPORT TAXIWAY OR APRON. HOWEVER, CONSTRUCTION MAY BE PERMITTED IN THESE AREAS IF THE CONTRACTOR HAS GAINED APPROVAL FROM THE AIRPORT MANAGER AT LEAST 7 DAYS IN ADVANCE OF THE SCHEDULED CONSTRUCTION PERIOD AND THE OPERATIONAL AREA IS CLOSED TO TRAFFIC AND PROPER NOTAMS ARE ISSUED BY THE AIRPORT MANAGER TO THE APPROPRIATE FLIGHT SERVICE STATION.
- UNLESS SPECIFIED OTHERWISE, COST FOR THE ABOVE IS TO BE CONSIDERED INCIDENTAL TO THE PROJECT. SEPARATE PAYMENT SHALL NOT BE MADE.

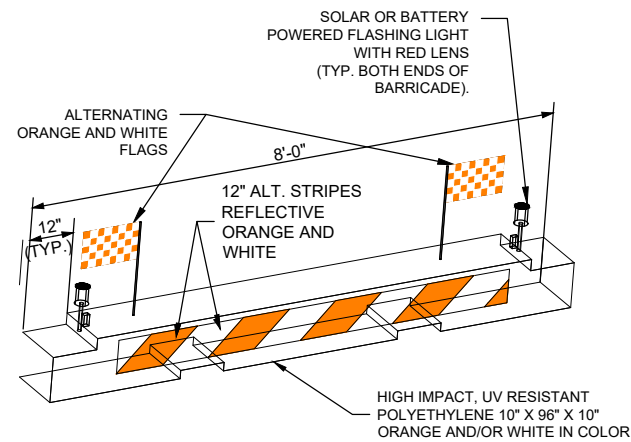

**LOW-PROFILE BARRICADE DETAIL**  
NOT TO SCALE

DETAIL ABOVE REPRESENTS ONE OPTION FOR LOW-PROFILE BARRICADES. OTHER OPTIONS MAY BE UTILIZED AS LONG AS THEY MEET THE REQUIREMENTS OF THE PROJECT, INCLUDING BARRICADE NOTE 1.

**BARRICADE NOTES**

- ALL CONSTRUCTION SIGNS AND TRAFFIC CONTROL DEVICES SHALL CONFORM TO THE MANUAL ON UNIFORM TRAFFIC CONTROL DEVICES INCLUDING THE ILLINOIS SUPPLEMENT (LATEST EDITION) AND THE FAA ADVISORY CIRCULARS (LATEST EDITION) UNLESS NOTED OTHERWISE. THE FAA OR MORE STRINGENT SPECIFICATIONS SHALL GOVERN.
- BARRICADES SHALL BE "LOW-PROFILE" WITH A MAXIMUM HEIGHT OF 18" ABOVE GROUND, EXCLUSIVE OF ASSOCIATED WARNING LIGHTS AND FLAGS.
- BARRICADES SHALL BE SPACED END TO END THE WIDTH OF THE PAVEMENT, WITH GAPS BETWEEN BARRICADES NOT TO EXCEED 4' WIDE. BARRICADES ARE TO BE SET BACK 66' FROM THE ACTIVE TAXIWAY CENTERLINE OR AS SHOWN ON THE PLANS.
- CONSTRUCTION RED WARNING LIGHT: THESE ARE PORTABLE, LENS DIRECTED, ENCLOSED LIGHTS. THE COLOR OF THE LIGHT EMITTED SHALL BE RED. THEY MAY BE USED IN EITHER A STEADY BURN (TYPE C) OR LOW INTENSITY FLASHING MODE (TYPE A) UNLESS NOTED OTHERWISE.
- THE LIGHTING SHALL BE MAINTAINED IN OPERATION DURING THE HOURS OF DARKNESS BETWEEN 1/2 HOUR BEFORE SUNSET AND 1/2 HOUR AFTER SUNRISE AND WHEN CONDITIONS EXIST WHICH TEND TO OBSCURE VISION.
- BARRICADES SHALL BE SECURED TO THE GROUND BY APPROVED METHODS TO PREVENT MOVEMENT BY PROP WASH, JET BLAST OR OTHER WIND CURRENTS.
- THE ONLY COLOR COMBINATION ON BARRICADES IS ORANGE AND WHITE. THE ORANGE STRIPES SHALL BE ENCAPSULATED LENS REFLECTIVE SHEETING. THE WHITE STRIPES SHALL BE EITHER ENCAPSULATED OR ENCLOSED LENS REFLECTIVE SHEETING AND MUST BE IN ACCEPTABLE CONDITION.
- COST FOR PROVIDING, PLACING, MAINTAINING, AND REMOVING BARRICADES SHALL BE PAID FOR UNDER ITEM AR150520 - MOBILIZATION.

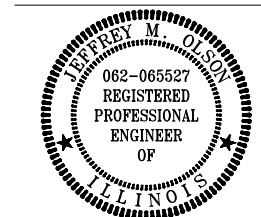

*Handwritten signature of Jeffrey M. Olson*

DATE: 11/17/23 LICENSE: 11/30/25  
SIGNED: 11/17/23 EXPIRES: 11/30/25

CONSTRUCT T-HANGAR PAVEMENTS

IDA No: 910-5105  
SBGP No: N/A  
Contract No.: HV008

NO.	DATE	DESCRIPTION		
		DES	DWN	REV

ISSUE: NOVEMBER 17, 2023  
PROJECT NO: 23A0069D  
CAD FILE: C-301-TYP.DWG  
DESIGN BY: JMO 10/18/2023  
DRAWN BY: AJL 10/18/2023  
REVIEWED BY: JMO 11/17/2023

SHEET TITLE

TYPICAL SECTION

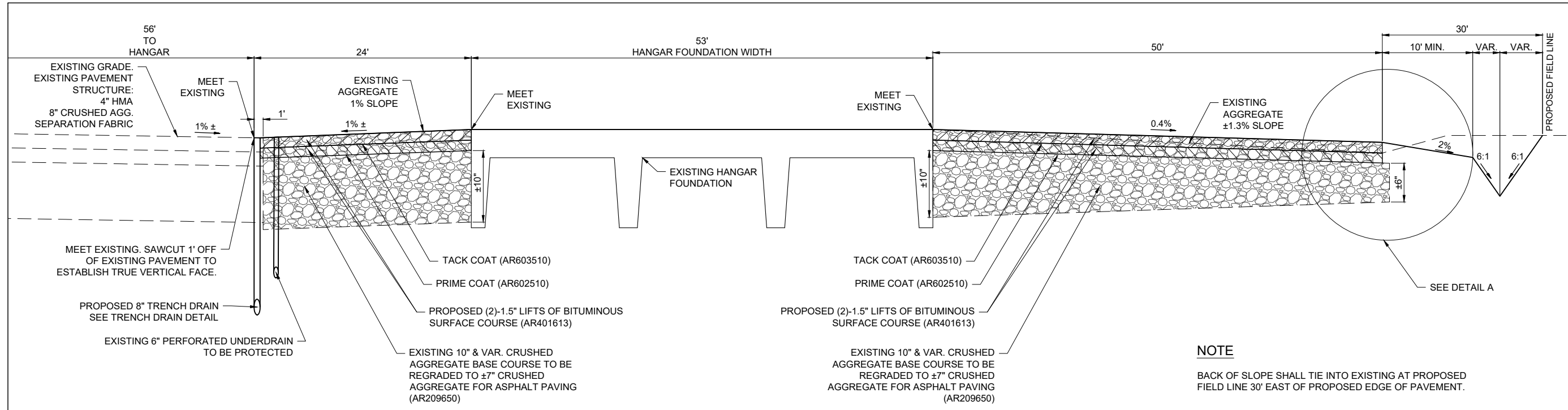

**NOTE**  
BACK OF SLOPE SHALL TIE INTO EXISTING AT PROPOSED FIELD LINE 30' EAST OF PROPOSED EDGE OF PAVEMENT.

TYPICAL SECTION A-A  
NOT TO SCALE

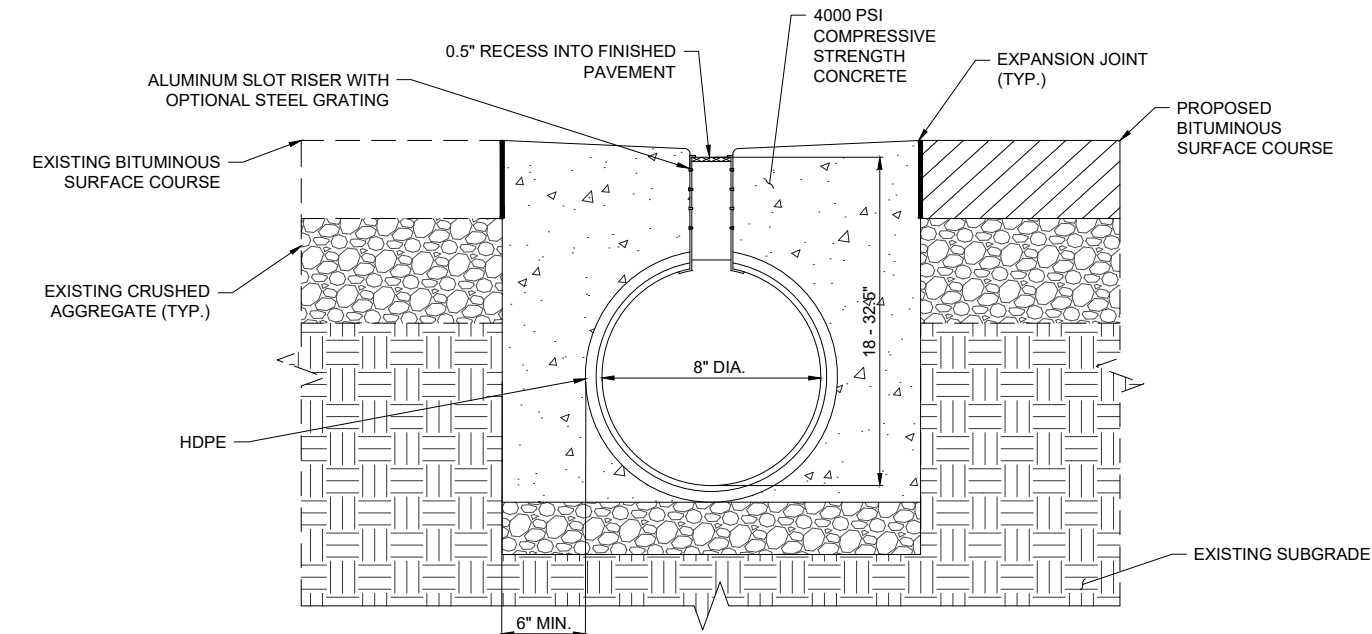

**SLOTTED DRAIN NOTE**

ALL MATERIAL ASSOCIATED WITH THE PROPER INSTALLATION OF THE PROPOSED SLOTTED DRAIN IS TO BE INCLUDED IN THE BID UNIT PRICE. THIS INCLUDES CONCRETE, AGGREGATE, CONTROLLED LOW STRENGTH MATERIAL, POROUS BACKFILL, FABRIC ENVELOPE, AND PERFORATED SLOTTED DRAIN PIPE.

THE PROPOSED PCC PAVEMENT SHALL BE IN CONFORMANCE WITH ITEM 610 OF THE SPECIFICATIONS.

EXTEND AGGREGATE BASE COURSE 12\"/>

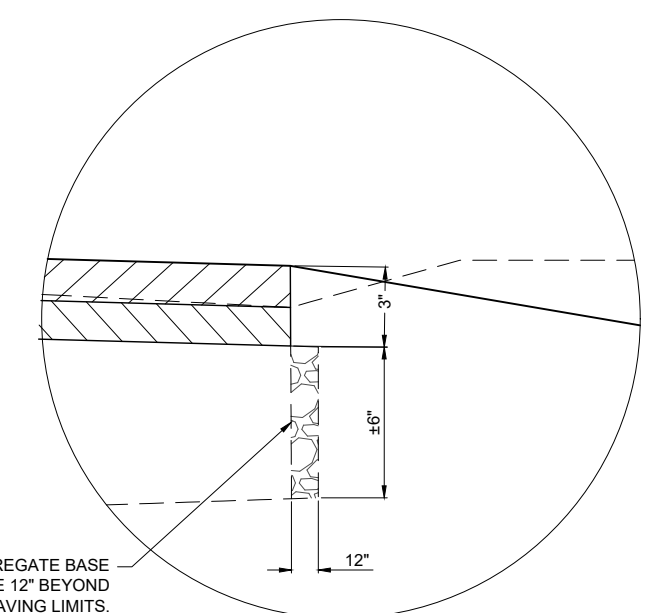

DETAIL A  
NOT TO SCALE

NOV 17, 2023 1:00 PM ENGELO1909 1:23:03S23A0069D\CAD\AIRPORT\SHHEETC-301-TYP.DWG

**FOR BID**











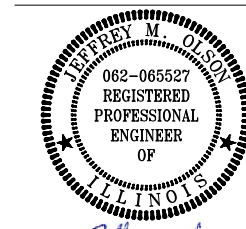

*Jeffrey M. Owsen*

DATE: 11/17/23 LICENSE: 11/30/25  
SIGNED: 11/17/23 EXPIRES: 11/30/25

**CONSTRUCT T-HANGAR PAVEMENTS**

IDA No: 910-5105  
SBGP No: N/A  
Contract No.: HV008

NO.	DATE	DESCRIPTION		
		DES	DWN	REV

ISSUE: NOVEMBER 17, 2023  
PROJECT NO: 23A0069D  
CAD FILE: C-131-DRN.DWG  
DESIGN BY: JMO 10/18/2023  
DRAWN BY: AJL 10/18/2023  
REVIEWED BY: JMO 11/17/2023

SHEET TITLE

**DRAINAGE DETAILS**

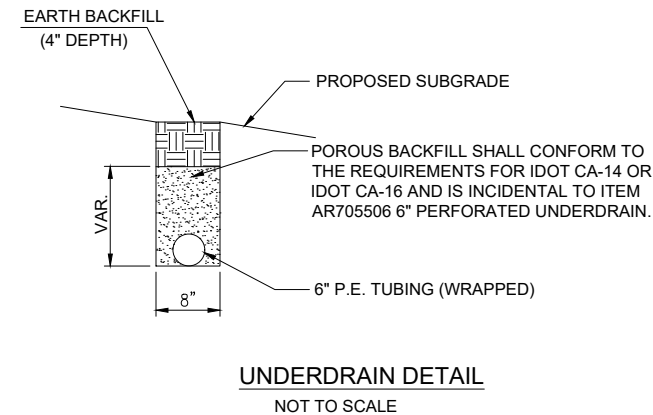

**UNDERDRAIN DETAIL**  
NOT TO SCALE

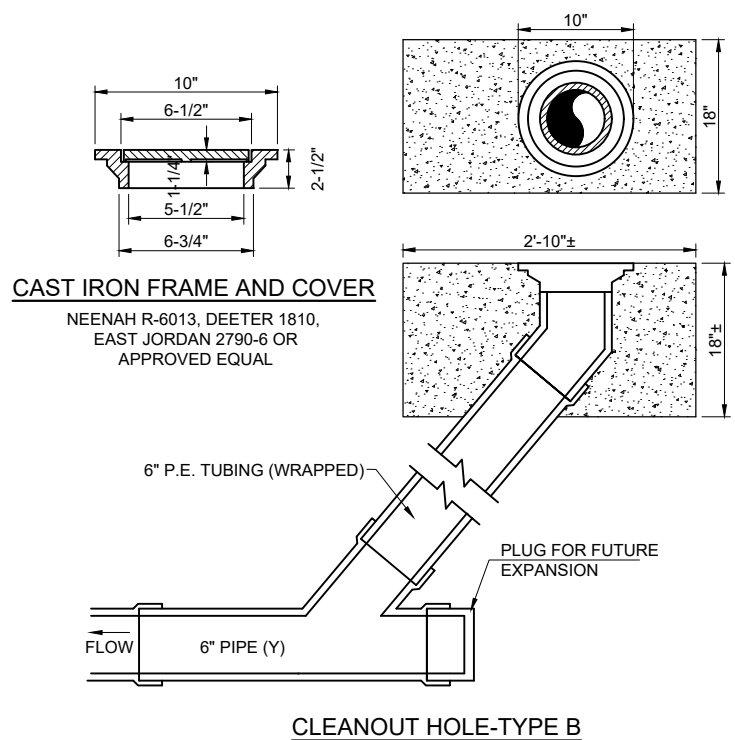

**CAST IRON FRAME AND COVER**  
NEENAH R-6013, DEETER 1810,  
EAST JORDAN 2790-6 OR  
APPROVED EQUAL

**CLEANOUT HOLE-TYPE B**

**INSPECTION HOLE NOTES**

- DIAMETER OF PIPE AS SPECIFIED.
- TOP OF INSPECTION HOLES SHALL BE 2" ABOVE FINISH GROUND LINE AT LOCATION SHOWN ON PLANS.
- 1/2" CHAMFER TO BE USED ON ALL EXPOSED EDGES OF INSPECTION HOLES.
- THE CONCRETE SHALL BE STRUCTURAL PORTLAND CEMENT CONCRETE (NON-REINFORCED)

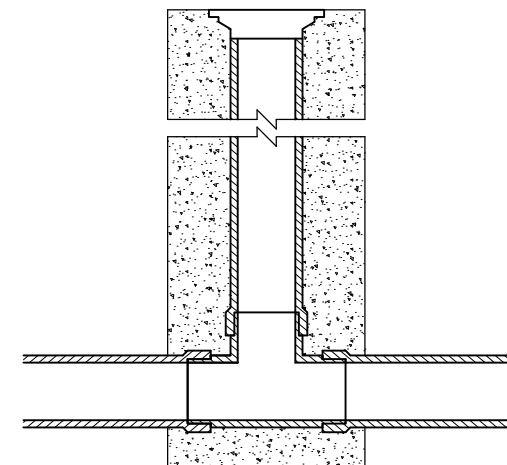

**INSPECTION HOLE-TYPE A**

**FOR BID**