

ROUTE	SECTION	COUNTY	TOTAL SHEETS	SHEET NUMBER
VARIOUS	2005-023BP	COOK AND DUPAGE	13	1

STATE OF ILLINOIS
DEPARTMENT OF TRANSPORTATION
DIVISION OF HIGHWAYS
DISTRICT ONE

CONTRACT 62955

D-91-208-05

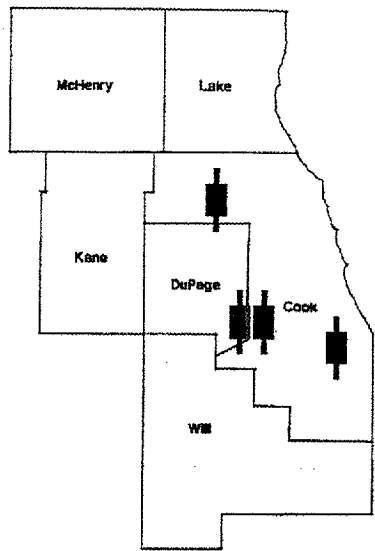

LOCATION OF IMPROVEMENT INDICATED THUS:

FOR INDEX OF SHEETS SEE SHEET 2

PROPOSED HIGHWAY PLANS

VARIOUS ROUTES AND LOCATIONS
SECTION 2005-023BP
BRIDGE PAINTING WITH WARRANTY
COOK AND DUPAGE COUNTIES
C-91-208-05

IMPROVEMENTS ARE LOCATED IN THE VILLAGES OF COUNTRYSIDE, ELK GROVE, HINSDALE AND THE CITY OF CHICAGO

- 1) SN 016-0537: WILLOW SPRINGS ROAD OVER I - 55
- 2) SN 016-0904: 119th STREET OVER I - 57
- 3) SN 016-0960: BIESTERFIELD ROAD OVER I - 290
- 4) SN 022-0126: 55th STREET OVER IL - 83

STATE OF ILLINOIS
DEPARTMENT OF TRANSPORTATION
DIVISION OF HIGHWAYS

SUBMITTED: Oct. 27 2005
Diane M. O'Keefe /cd
DEPUTY DIRECTOR OF HIGHWAY, REGION ENGINEER

December 9 2005
Mike Hine (R)
ENGINEER OF DESIGN AND ENVIRONMENT

December 9 2005
Eric Harm (R)
DEPUTY DIRECTOR, DIVISION OF HIGHWAYS

**PRINTED BY THE AUTHORITY
OF THE STATE OF ILLINOIS**

J.U.L.I.E.: JOINT UTILITY LOCATION
INFORMATION FOR EXCAVATION
(800) 892-0123

C.U.A.N.: CHICAGO UTILITY
ALERT NETWORK
(312) 774-7000

DISTRICT ONE BUREAU OF DESIGN
MAINTENANCE DESIGN ENGINEER: R. BORO (847) 705-4178

CONTRACT NO. 62955

ROUTE	SECTION	COUNTY	TOTAL SHEETS	SHEET NUMBER
VARIOUS	2004-053BP	COOK & DPAGE	13	2

Contract 62955

INDEX OF SHEETS

- 1 TITLE SHEET
- 2 INDEX OF SHEETS, STATE STANDARDS AND GENERAL NOTES
- 3 GENERAL PAINT NOTES
- 4 LOCATION MAPS
- 5 SUMMARY OF QUANTITIES
- 6 EXISTING BRIDGE PLANS (SN 016-0537: LOCATION 1)
- 7 EXISTING BRIDGE PLANS (SN 016-0904: LOCATION 2)
- 8 - 9 EXISTING BRIDGE PLANS (SN 016-0960, -0039: LOCATION 3)
- 10 EXISTING BRIDGE PLANS (SN 022-0126: LOCATION 4)
- 11 DISTRICT ONE FREEWAY STANDARD: SHOULDER CLOSURES AND PARTIAL RAMP CLOSURES
- 12 TRAFFIC CONTROL AND PROTECTION FOR SIDE ROADS, INTERSECTIONS AND DRIVEWAYS

STATE STANDARDS

- 701101-01 MULTI-LANE OFF-ROAD OPERATIONS
- 701301-02 LANE CLOSURE 2L, 2W SHORT TIME OPERATIONS
- 701400-02 APPROACH TO LANE CLOSURE, FREEWAY/EXPRESSWAY
- 701401-03 LANE CLOSURE, FREEWAY/EXPRESSWAY
- 701411-03 LANE CLOSURE MULTILANE AT ENTRANCE OR EXIT RAMP FOR SPEED > OR = 45 MPH
- 701446 TWO LANE CLOSURE, FREEWAY/EXPRESSWAY
- 701601-04 URBAN LANE CLOSURE, MULTILANE, 1W OR 2W WITH NONTRAVERSABLE MEDIAN
- 702001-05 TRAFFIC CONTROL DEVICES

GENERAL NOTES

IT SHALL BE THE CONTRACTOR'S RESPONSIBILITY TO VERIFY ALL DIMENSIONS & CONDITIONS EXISTING IN THE FIELD PRIOR TO CONSTRUCTION & ORDERING OF MATERIALS.

THE CONTRACTOR WILL NOT BE ALLOWED TO SET UP A YARD OR FIELD OFFICE ON STATE PROPERTY WITHOUT WRITTEN PERMISSION FROM THE DEPARTMENT.

THE CONTRACTOR SHALL CONTACT THE DISTRICT ONE TRAFFIC CONTROL SUPERVISOR AT (847) 705-4151 FOR EXPRESSWAYS, AND (847) 705-4470 FOR ARTERIALS A MINIMUM OF 72 HOURS IN ADVANCE OF BEGINNING WORK.

WHEN ARTIFICIAL LIGHTING IS UTILIZED IN NIGHT OPERATIONS, THE CONTRACTOR SHALL EXERCISE THE UTMOST PRECAUTIONS IN PREVENTING ADVERSE VISIBILITY TO THE MOTORING PUBLIC AND ADJOINING RESIDENTIAL AREA.

IT SHALL BE THE CONTRACTORS RESPONSIBILITY TO PROTECT AND MAINTAIN THE EXISTING BRIDGE LIGHTING AT ALL LOCATIONS.

THE "ADVANCED WARNING SIGN DETAIL FOR ARTERIAL TRAFFIC" LOCATED IN THE SPECIAL PROVISIONS FOR "TEMPORARY INFORMATION SIGNING FOR LANE CLOSURES" IS APPLICABLE ONLY TO ARTERIAL ROADS AND SHALL NOT BE APPLIED TO EXPRESSWAYS.

THE CONTRACTOR SHALL BE REQUIRED TO PROVIDE ACCESS TO ABUTTING PROPERTY AT ALL TIMES DURING THE CONSTRUCTION OF THIS PROJECT.

DO NOT SCALE PLANS FOR CONSTRUCTION DIMENSIONS.

ILLINOIS DEPARTMENT OF TRANSPORTATION
INDEX OF SHEETS
STATE STANDARDS
GENERAL NOTES

ROUTE	SECTION	COUNTY	TOTAL SHEETS	SHEET NUMBER
VARIOUS	2004-053BP	COOK & DUPAGE	13	3

Contract 62955

GENERAL NOTES FOR PAINT

CLEANING AND PAINTING OF THE EXISTING STRUCTURAL STEEL SHALL BE AS SPECIFIED IN THE SPECIAL PROVISION FOR "CLEANING AND PAINTING EXISTING STEEL STRUCTURES".

A MINIMUM OF FOUR (4) AT LOCATIONS 1, 2, AND 4 AND THREE (3) AT LOCATION, 3 AIR MONITORS WILL BE REQUIRED TO MONITOR ABRASIVE BLASTING OPERATIONS PER LOCATION, SEE SPECIAL PROVISIONS FOR CONTAINMENT AND DISPOSAL OF LEAD PAINT CLEANING RESIDUE.

THE SSPC-QP1 AND SSPC-QP2 PAINTING CONTRACTOR CERTIFICATIONS WILL BE REQUIRED FOR THESE BRIDGES.

ALL LOCATIONS SHALL BE PAINTED ACCORDING TO THE REQUIREMENTS OF PAINT SYSTEM 5 – MOISTURE CURED URETHANE-RAPID DEPLOYMENT (MCU). THE COLOR OF THE FINAL FINISH COAT FOR ALL INTERIOR STEEL SURFACES SHALL BE GRAY, MUNSELL NO 5B 7/1. THE COLOR OF THE FINAL FINISH COAT FOR THE EXTERIOR AND BOTTOM FLANGE OF THE FASCIA BEAMS SHALL BE REDDISH BROWN, MUNSELL NO 2.5YR 3/4.

ALL ITEMS (SUCH AS, BUT NOT LIMITED TO; CONDUITS, BRACKETS AND DECK DRAINS) ATTACHED TO THE OUTSIDE OF THE FASCIA BEAMS SHOULD BE CLEANED AND PAINTED.

ALL STRUCTURAL STEEL SHALL BE CLEANED PER NEAR WHITE BLAST CLEANING SSPC-SP10. SEE SPECIAL PROVISION, "WARRANTY FOR CLEANING AND PAINTING STEEL STRUCTURES."

ILLINOIS DEPARTMENT OF TRANSPORTATION
GENERAL PAINT NOTES

ROUTE	SECTION	COUNTY	TOTAL SHEETS	SHEET NUMBER
VARIOUS	2004-053BP	COOK & DUPAGE	13	4

Contract 62955

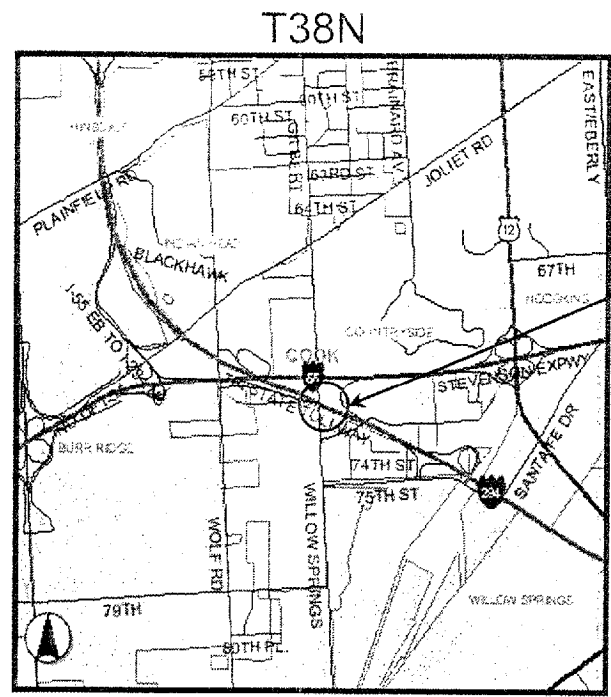

LYONS TWP

LOCATION 1
 SN 016-0537
 WILLOW SPRINGS ROAD OVER I-55.
 I-55, 2003 ADT = 141,200
 SPEED LIMIT = 55 MPH
 WILLOW SPRINGS ROAD, 2002 ADT = 14,300
 SPEED LIMIT = 35-40 MPH

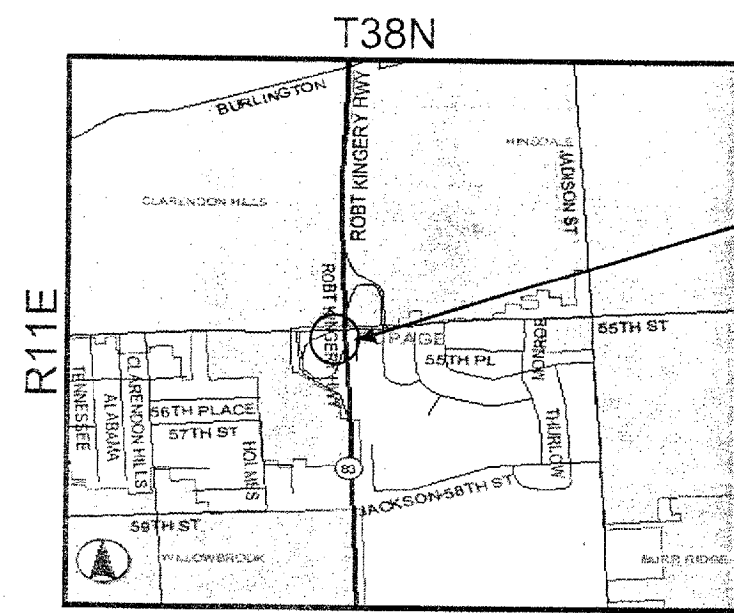

DOWNERS GROVE TWP

LOCATION 4
 SN 022-0126
 55th STREET OVER IL-83.
 IL-83, 2003 ADT = 58,900
 SPEED LIMIT = 55 MPH
 55th STREET, 2001 ADT = 26,200
 SPEED LIMIT = 35-40 MPH

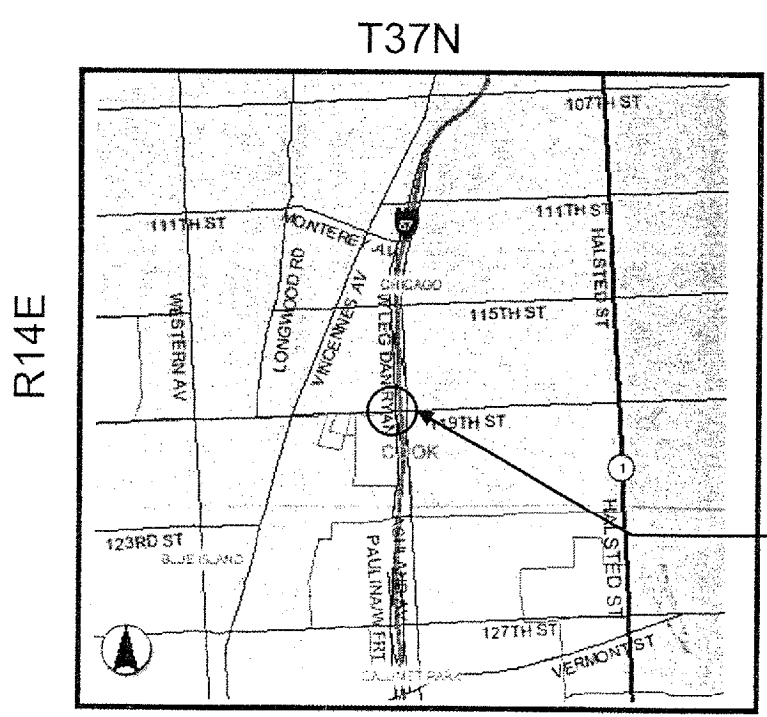

CALUMET TWP

LOCATION 3
 SN 016-0960
 BIESTERFIELD ROAD OVER I-290
 I-290, 2003 ADT = 77,950
 SPEED LIMIT = 55 MPH

LOCATION 2
 SN 016-0904
 119th STREET OVER I-57
 119th STREET, 1997 ADT = 15,400
 SPEED LIMIT = 30 MPH
 I-57, 2003 ADT = 110,200
 SPEED LIMIT = 55 MPH

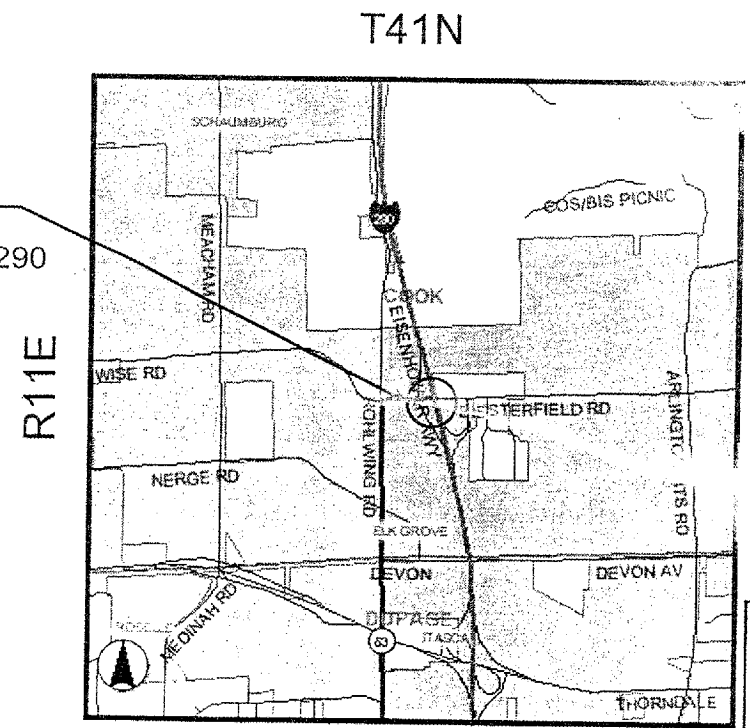

ELK GROVE TWP

ILLINOIS DEPARTMENT OF TRANSPORTATION
 LOCATION MAPS

ROUTE	SECTION	COUNTY	TOTAL SHEETS	SHEET NUMBER
VARIOUS	2004-053BP	COOK & DUPAGE	13	5

SUMMARY OF QUANTITIES

CONTRACT: 62955

Code No.	Description	Unit	URBAN Total Quantities	CONSTRUCTION TYPE CODE: SFTY - 2A				
				COOK COUNTY			DUPAGE COUNTY	
				LOCATION 1 016-0537	LOCATION 2 016-0904	LOCATION 3 016-0960	LOCATION 4 022-0126	
50600600	CLEANING AND PAINTING STEEL BRIDGE NO. 1	L SUM	1	1				
50600700	CLEANING AND PAINTING STEEL BRIDGE NO. 2	L SUM	1		1			
50600800	CLEANING AND PAINTING STEEL BRIDGE NO. 3	L SUM	1			1		
50600900	CLEANING AND PAINTING STEEL BRIDGE NO. 4	L SUM	1				1	
50606400	CONTAINMENT AND DISPOSAL OF LEAD PAINT CLEANING RESIDUES	L SUM	1	0.25	0.25	0.25	0.25	
67000400	ENGINEER'S FIELD OFFICE, TYPE A	CAL MO	6	1.50	1.50	1.50	1.50	
67100100	MOBILIZATION	L SUM	1	0.25	0.25	0.25	0.25	
70102630	TRAFFIC CONTROL AND PROTECTION, STANDARD 701601	L SUM	1				1	
X0322467	TEMPORARY INFORMATION SIGNING FOR LANE CLOSURES	SQ FT	48				48	
X5067501	BRIDGE CLEANING & PAINTING WARRANTY NO.1	L SUM	1	1				
X5067502	BRIDGE CLEANING & PAINTING WARRANTY NO.2	L SUM	1		1			
X5067503	BRIDGE CLEANING & PAINTING WARRANTY NO.3	L SUM	1			1		
X7011015	TRAFFIC CONTROL AND PROTECTION (EXPRESSWAYS)	L SUM	1	0.33	0.33	0.34		
X5067504	BRIDGE CLEANING & PAINTING WARRANTY NO.4	L SUM	1				1	

ILLINOIS DEPARTMENT OF TRANSPORTATION

SUMMARY OF QUANTITIES

Rev.

ROUTE	SECTION	COUNTY	TOTAL SHEETS	SHEET NUMBER
VARIOUS	2004-053BP	COOK & DUPAGE	13	6

Contract 62955
Sh 1 OF 2

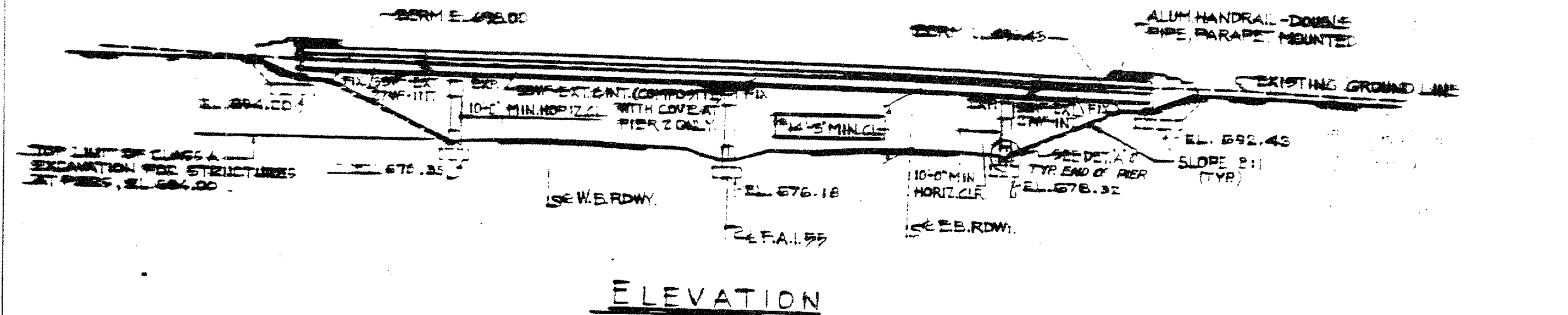

ELEVATION

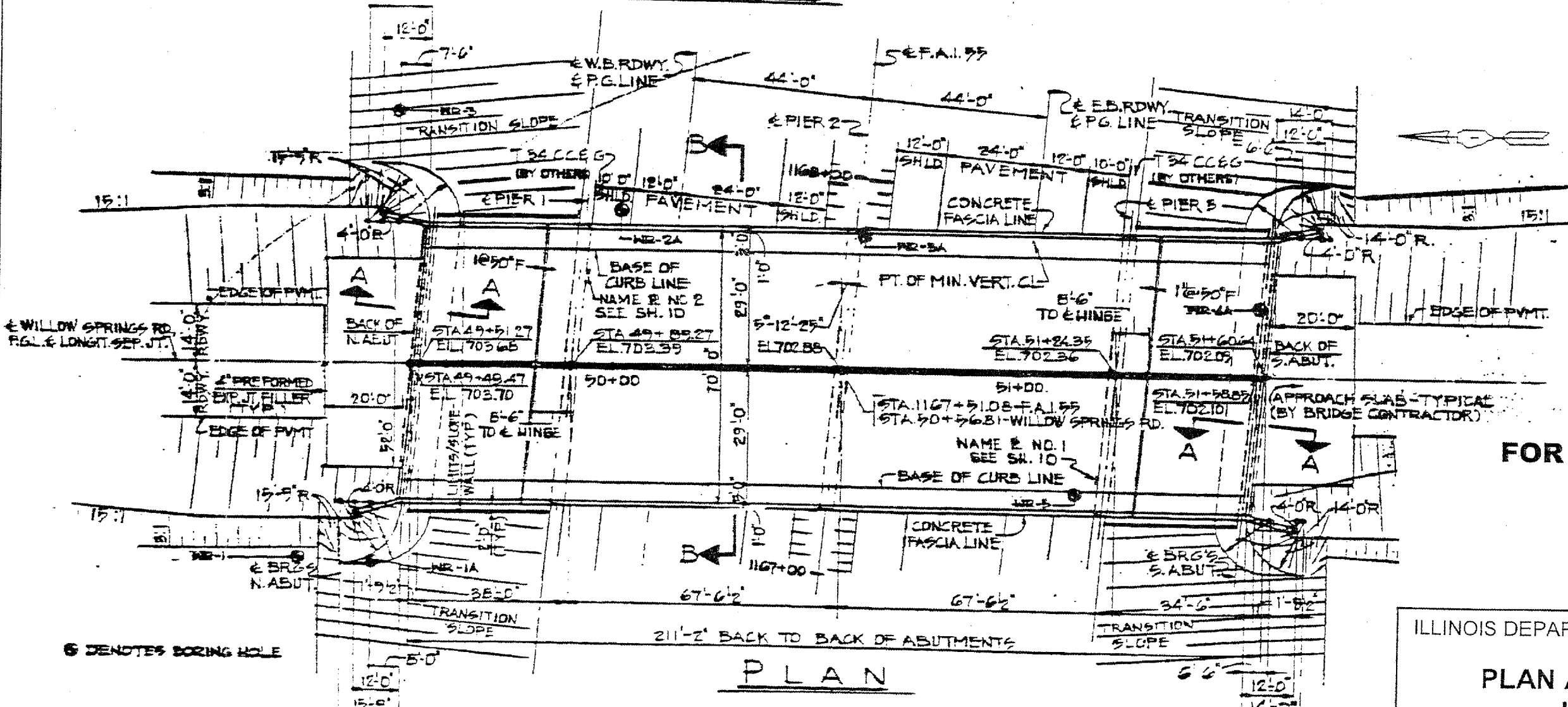

PLAN

FOR INFORMATION ONLY

ILLINOIS DEPARTMENT OF TRANSPORTATION
PLAN AND ELEVATIONS
LOCATION 1
SN 016-0537
WILLOW SPRINGS RD OVER I-55

ROUTE VARIOUS	SECTION 2004-0538P	COUNTY COOK & DU PAGE	TOTAL SHEETS 13	SHEET NUMBER 7
------------------	-----------------------	--------------------------	--------------------	-------------------

CONTRACT 62955

Sh2 of 2

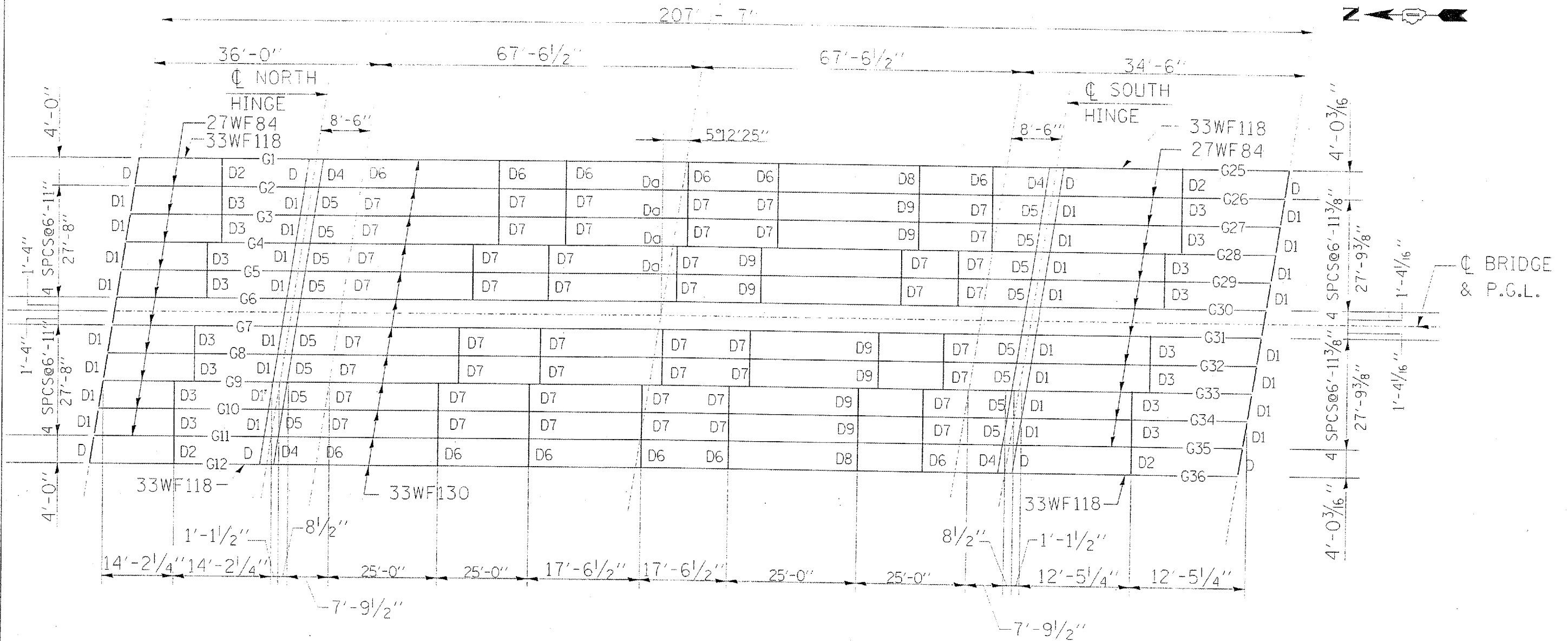

FRAMING PLAN

DIAPHRAGMS

D, D1, D4 & D5	12 WF 40
D2 & D3	12 WF 36
D6, D7, D8 & D9	16 WF 36

ILLINOIS DEPARTMENT OF
TRANSPORTATION
FRAMING PLAN
SN 016-0537
LOCATION 1
WILLOW SPRINGS RD. OVER I-55

ROUTE VARIOUS	SECTION 2004-053BP	COUNTY COOK & DUPAGE	TOTAL SHEETS 13	SHEET NUMBER 8
------------------	-----------------------	-------------------------	-----------------------	----------------------

Contract 62955
Sh 1 OF 2

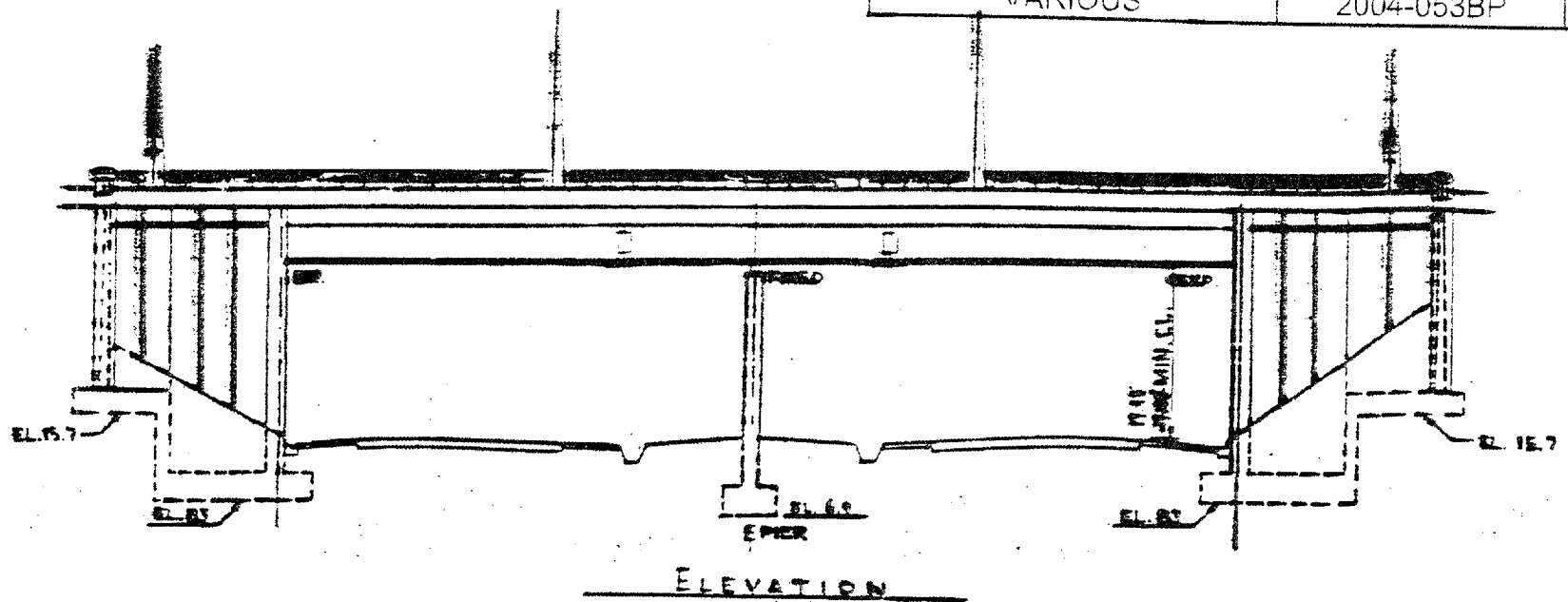

ELEVATION

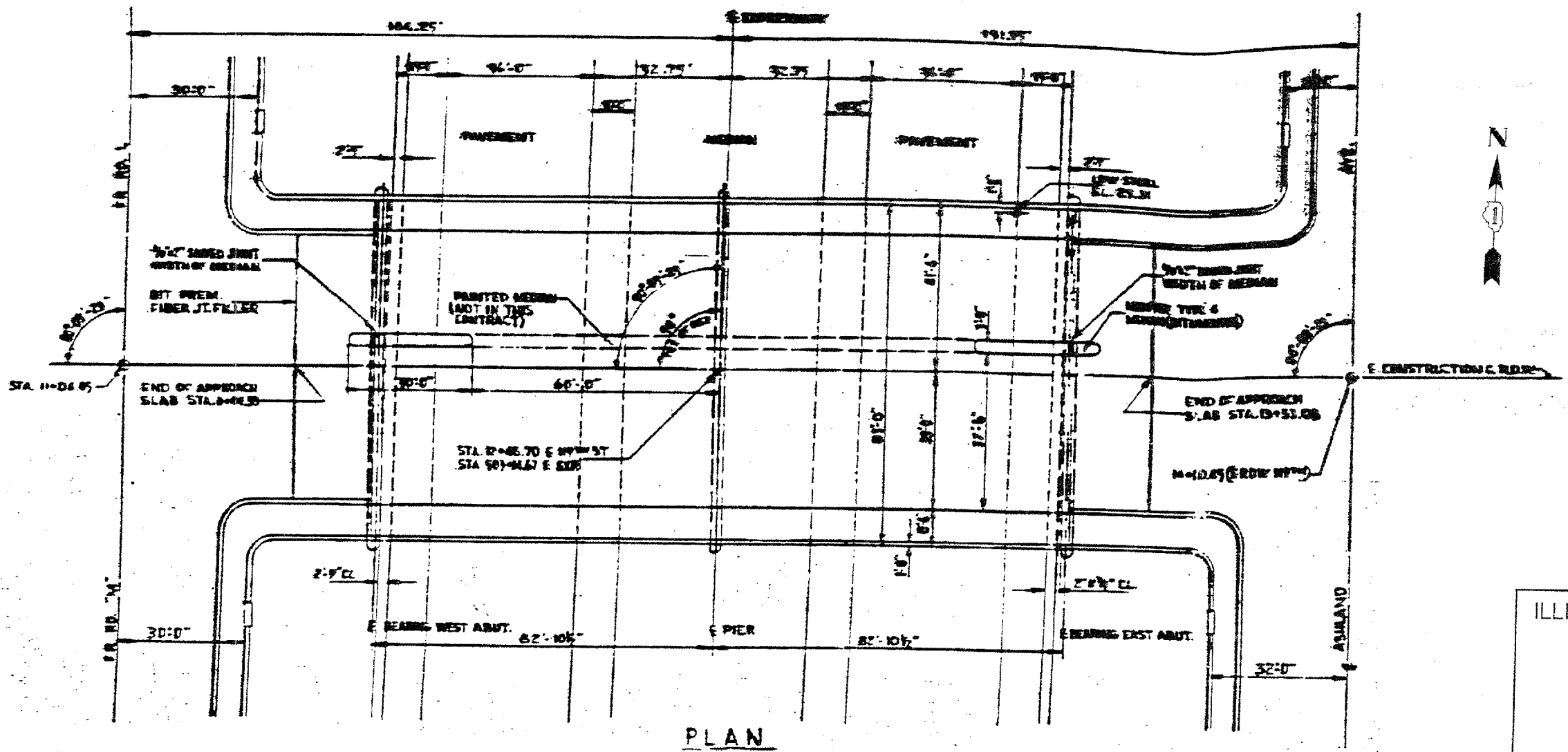

PLAN



FOR INFORMATION ONLY

ILLINOIS DEPARTMENT OF TRANSPORTATION
PLAN AND ELEVATIONS
LOCATION 2
 SN 016-0904
 119th STREET OVER I-57

ROUTE	SECTION	COUNTY	TOTAL SHEETS	SHEET NUMBER
VARIOUS	2004-053BP	COOK & DUPAGE	13	9

Contract 62955
Sh 2 OF 2

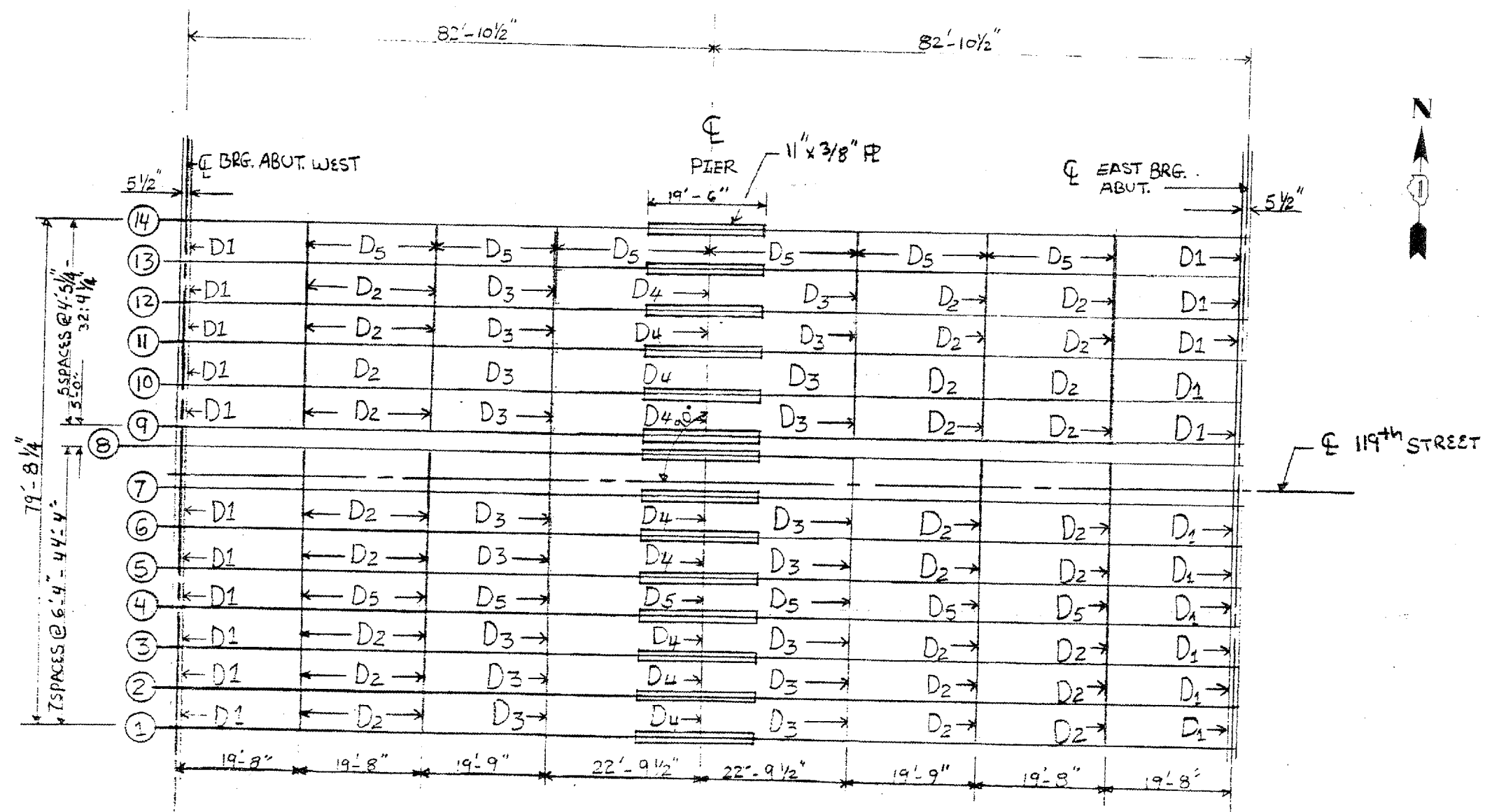

FRAMING PLAN

ALL GIRDERS 36WF182

DIAPHRAGMS	
D1	12WF40
D2, D3, D4, D5	16WF36

ILLINOIS DEPARTMENT OF TRANSPORTATION

FRAMING PLAN
LOCATION 2
SN 016-0904
119th STREET OVER I-57

ROUTE	SECTION	COUNTY	TOTAL SHEETS	SHEET NUMBER
VARIOUS	2004-053B	COOK & DUPAGE	13	11

Sh 2 OF 2 Contract 62955

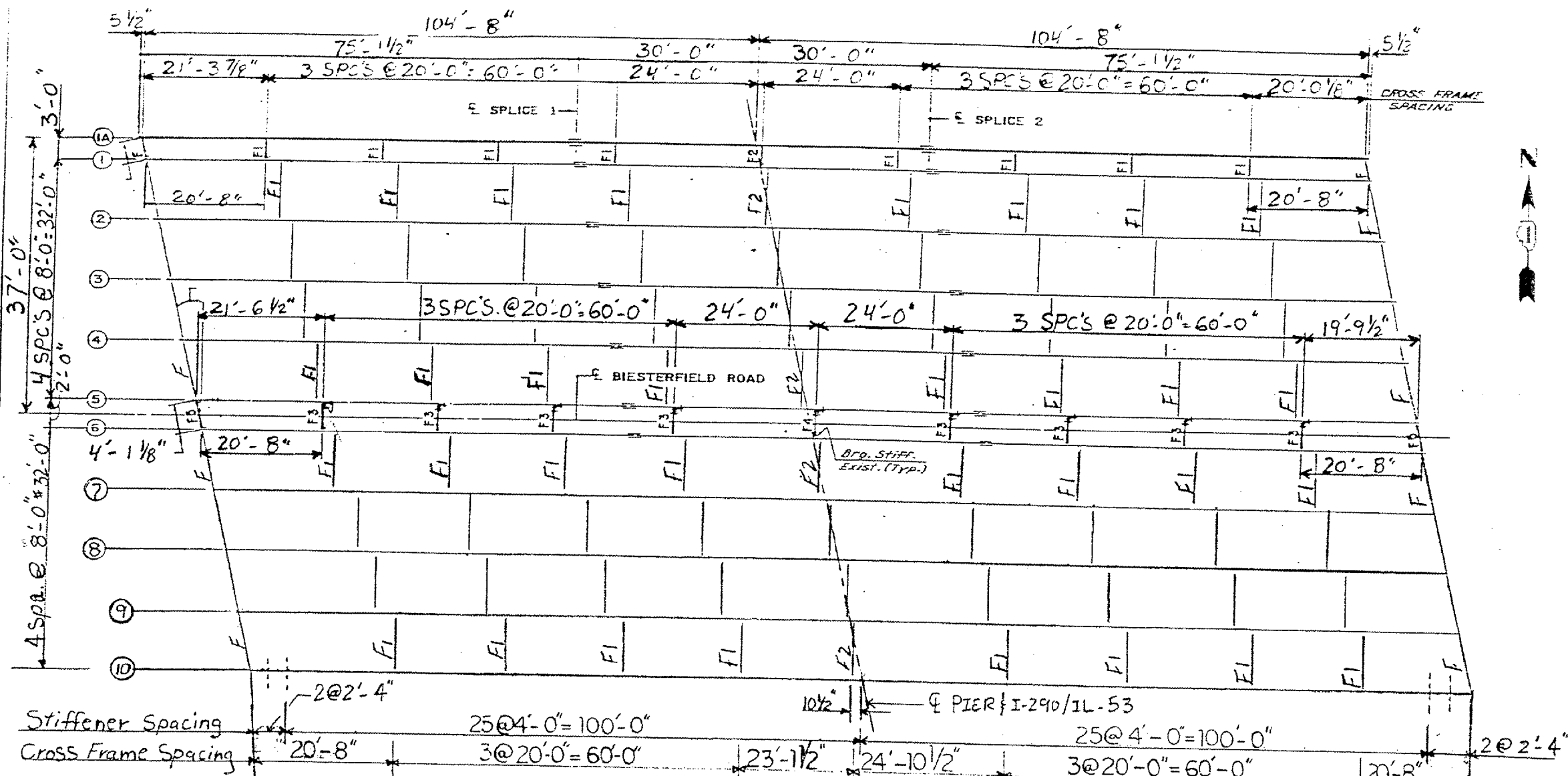

FRAMING PLAN

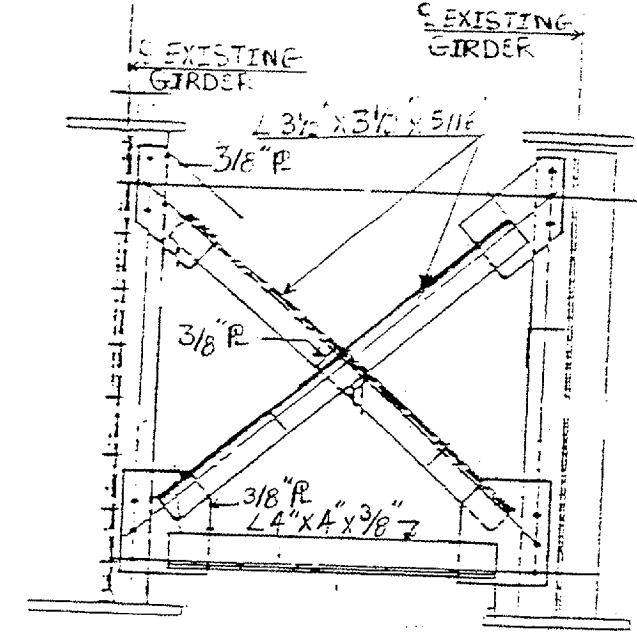

FRAME F3, F4, F2 & F1
(8 REQ'D.)

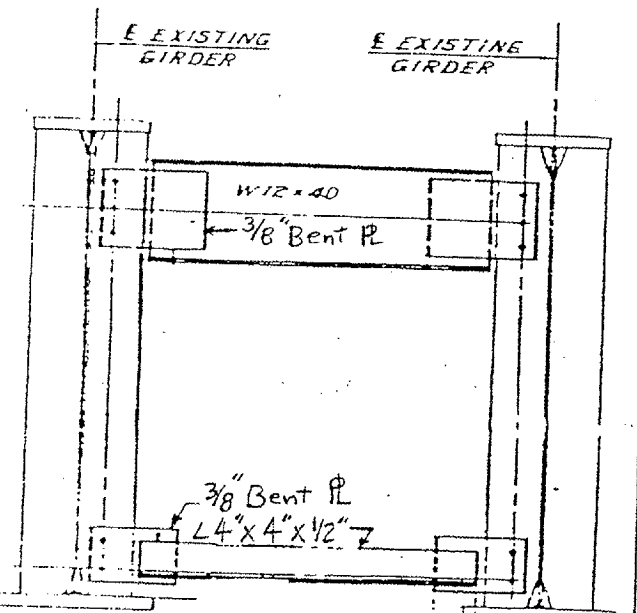

FRAME F5 & F
(2 REQ'D.)

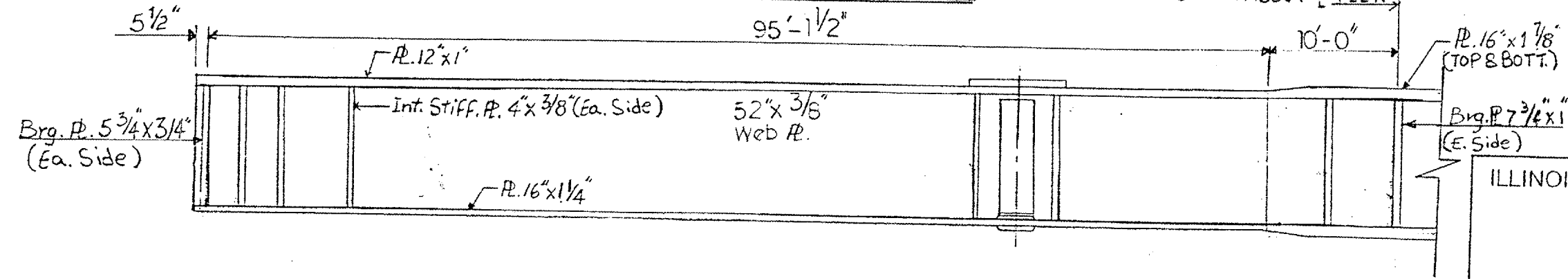

HALF GIRDER ELEVATION

ILLINOIS DEPARTMENT OF TRANSPORTATION
FRAMING PLAN
LOCATION 3
 SN 016-0960
 BIESTERFIELD ROAD OVER I-290

ROUTE VARIOUS	SECTION 2004-053BP	COUNTY COOK & DUPAGE	TOTAL SHEETS 13	SHEET NUMBER 13
------------------	-----------------------	-------------------------	--------------------	--------------------

Contract 62955
Sh 2 OF 2

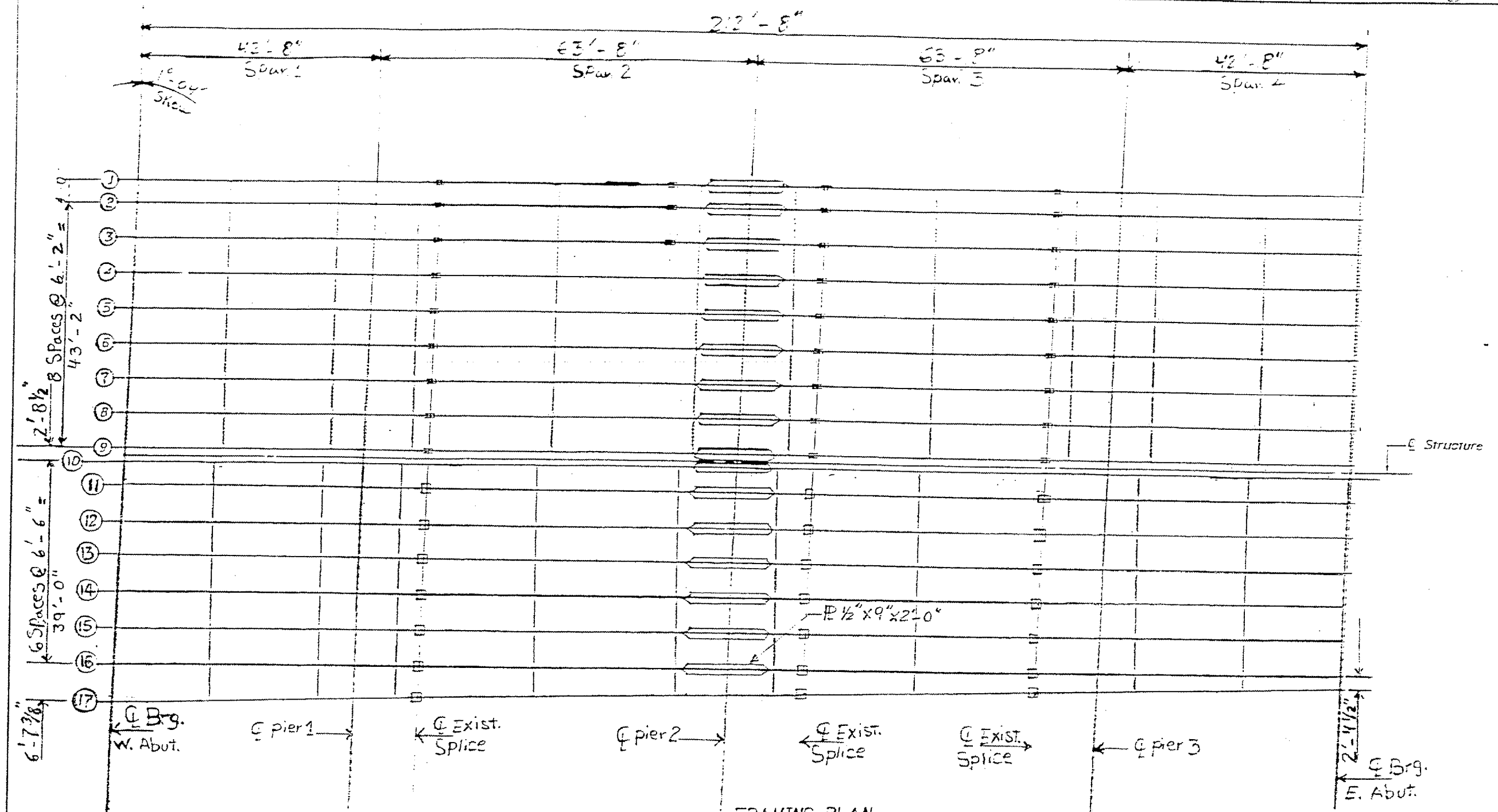

FRAMING PLAN

ALL BEAMS ARE 33W F118
 ALL INTERIOR DIAPHRAGM ARE 16W X 36
 ALL END DIAPHRAGM ARE 12W F 40

ILLINOIS DEPARTMENT OF TRANSPORTATION
FRAMING PLAN
 LOCATION 4
 SN: 022-0126
 55th STREET OVER I-83