

ROUTE	SECTION	COUNTY	TOTAL SHEETS	SHEET NUMBER
VARIOUS	2011-216-I	VARIOUS	28	11

CONTRACT NO. 60R56

LOCATION 12: SN 099-0169
IL 102 OVER
FORKED CREEK OVERFLOW
WESLEY TOWNSHIP

R 10 E

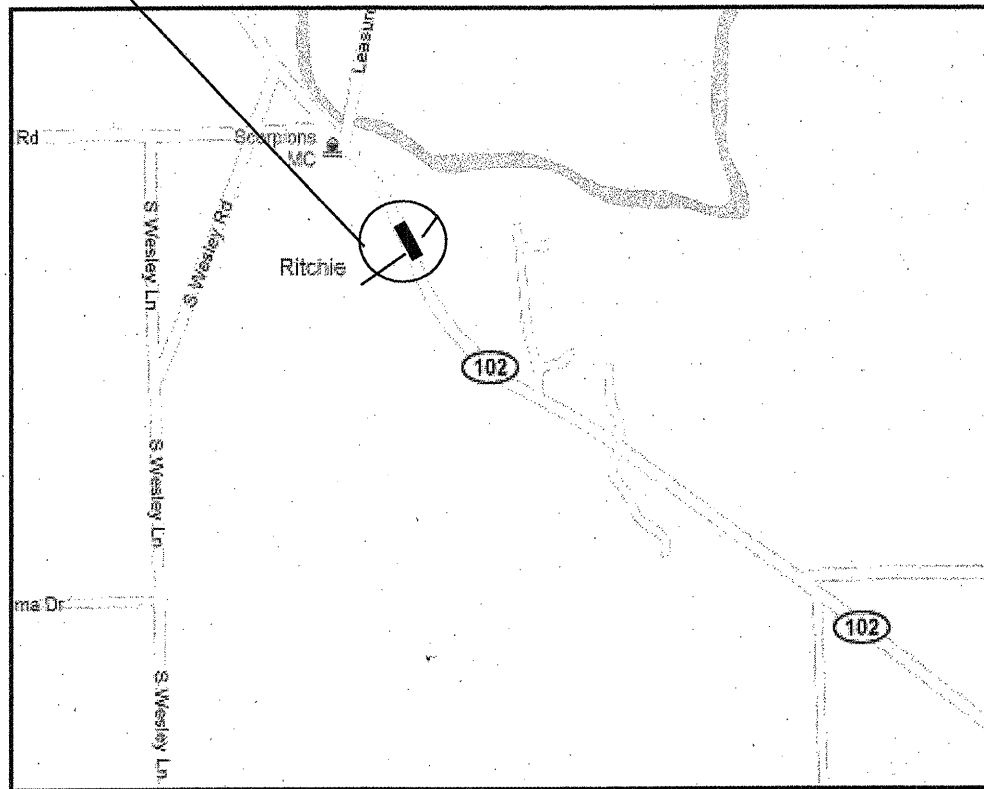

T 32 N

WESLEY TOWNSHIP
WILL COUNTY

TRAFFIC DATA

IL 102
2009 ADT = 2750
POSTED SPEED LIMIT = 40 MPH

IL 113
2009 ADT = 2650
POSTED SPEED LIMIT = 50 MPH

LOCATION 13: 099-0170
IL 102 OVER RAYNS CREEK
WESLEY TOWNSHIP

R 10 E

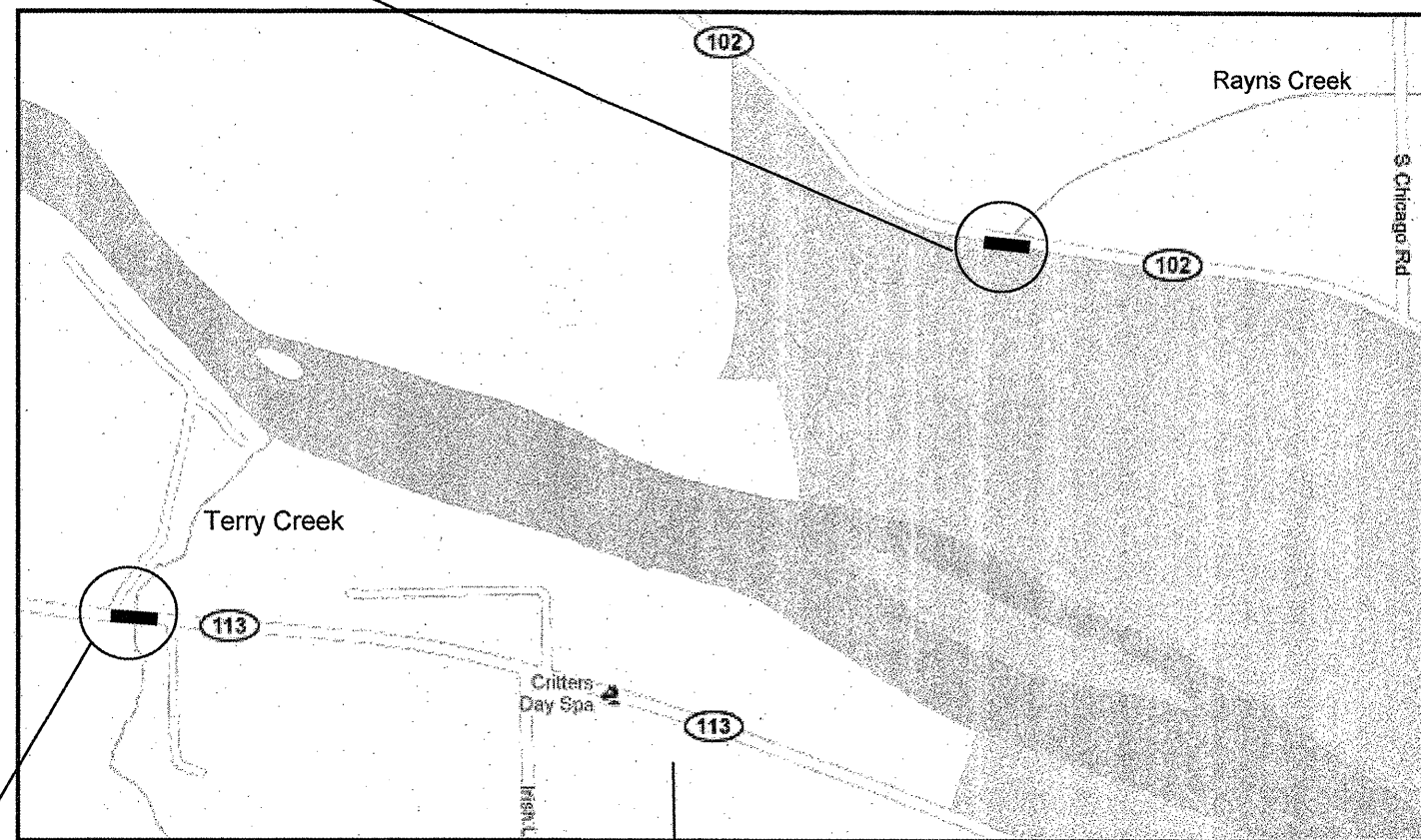

T 32 N

← CUSTER TOWNSHIP | WESLEY TOWNSHIP →

WILL COUNTY

LOCATION 14: 099-0172
IL 113 OVER TERRY CREEK
CUSTER TOWNSHIP

ILLINOIS DEPARTMENT OF
TRANSPORTATION

LOCATION MAP
LOCATION 12; 13 & 14