

1-20-2012 LETTING ITEM 113

ROUTE	SECTION	COUNTY	TOTAL SHEETS	SHEET NUMBER
VARIOUS	2011-216-I	VARIOUS	28	1

FOR INDEX OF SHEETS SEE SHEET 2

CONTRACT NO. 60R56

D-91-156-12

STATE OF ILLINOIS
DEPARTMENT OF TRANSPORTATION
DIVISION OF HIGHWAYS
DISTRICT ONE
PROPOSED HIGHWAY PLANS

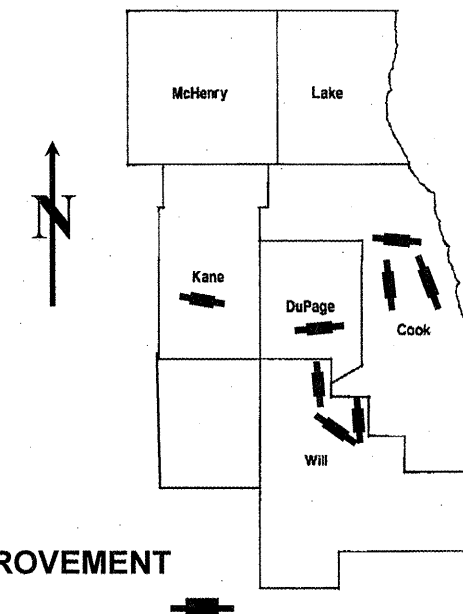

LOCATION OF IMPROVEMENT INDICATED THUS: 

IMPROVEMENTS ARE LOCATED IN THE CITIES OF CHICAGO, BLUE ISLAND, NAPERVILLE, THE VILLAGES OF OAK BROOK, MOKENA, ROCKDALE AND THE TOWNSHIPS OF BATAVIA, GREEN GARDEN, PEOTONE, WILTON, WESLEY, AND CUSTER

VARIOUS ROUTES
AT VARIOUS STRUCTURES S. of IL 38
SECTION 2011-216-I
BRIDGE DECK & CRACK SEALING
VARIOUS COUNTIES
C-91-156-12

SEE LOCATION MAPS
SHEETS 6-11

STATE OF ILLINOIS
DEPARTMENT OF TRANSPORTATION
DIVISION OF HIGHWAYS
 SUBMITTED: NOVEMBER 2, 2011
Diana M. O'Keefe DEPUTY DIRECTOR OF HIGHWAYS, REGION ENGINEER
December 9 2011
Scott E. Stitt ENGINEER OF DESIGN AND ENVIRONMENT
acting
December 9 2011
William R. Freyer DIRECTOR, DIVISION OF HIGHWAYS
interim

PRINTED BY THE AUTHORITY
OF THE STATE OF ILLINOIS

C.U.A.N.: CHICAGO
UTILITY ALERT NETWORK
(312) 744-7000

J.U.L.I.E.: JOINT UTILITY LOCATION
INFORMATION FOR EXCAVATION
(800) 892-0123 OR 811

PROJECT ENGINEER: ROBERT BORO (847) 705-4237
PROJECT MANAGER: ISSAM RAYYAN (847) 705-4178

CONTRACT NO. 60R56

ROUTE	SECTION	COUNTY	TOTAL SHEETS	SHEET NUMBER
VARIOUS	2011-216-I	VARIOUS	28	2

CONTRACT NO. 60R56

INDEX OF SHEETS

- 1 TITLE SHEET
- 2 INDEX OF SHEETS
- 3 GENERAL NOTES, STATE STANDARDS
- 4 SUMMARY OF QUANTITIES
- 5 SCHEDULE OF QUANTITIES
- 6 – 11 LOCATION MAPS
- 12 EXISTING BRIDGE PLANS (LOCATION NO. 1, SN 016-0776)
- 13-14 EXISTING BRIDGE PLANS (LOCATION NO 2, SN 016-1020)
- 15 EXISTING BRIDGE PLANS (LOCATION NO. 3, SN 022-0040)
- 16 EXISTING BRIDGE PLANS (LOCATION NO. 4, SN 022-0084)
- 17 EXISTING BRIDGE PLANS (LOCATION NO. 5, SN 045-0020)
- 18 EXISTING BRIDGE PLANS (LOCATION NO. 6, SN 099-0315)
- 19 EXISTING BRIDGE PLANS (LOCATION NO.7, SN 099-0098)
- 20 EXISTING BRIDGE PLANS (LOCATION NO. 8, SN 099-0118)
- 21 EXISTING BRIDGE PLANS (LOCATION NO. 9, SN 099-0119)
- 22 EXISTING BRIDGE PLANS (LOCATION NO.10, SN 099-0122)
- 23 EXISTING BRIDGE PLANS (LOCATION NO. 11, SN 099-0133)
- 24 EXISTING BRIDGE PLANS (LOCATION NO. 12, SN 099-0169)
- 25 EXISTING BRIDGE PLANS (LOCATION NO 13, SN 099-0170)
- 26 EXISTING BRIDGE PLANS (LOCATION NO.14, SN 099-0172)
- 27 TRAFFIC CONTROL AND PROTECTION FOR SIDE ROADS,
INTERSECTIONS AND DRIVEWAYS (TC-10)
- 28 ARTERIAL ROAD INFORMATION SIGN (TC-22)

**ILLINOIS DEPARTMENT OF
TRANSPORTATION**

INDEX OF SHEETS

ROUTE	SECTION	COUNTY	TOTAL SHEETS	SHEET NUMBER
VARIOUS	2011-216-I	VARIOUS	28	3

CONTRACT NO. 60R56

GENERAL NOTES

BEFORE STARTING ANY EXCAVATION, THE CONTRACTOR SHALL CALL "J.U.L.I.E." AT (800) 892-0123 OR 811 FOR FIELD LOCATIONS OF BURIED ELECTRIC, TELEPHONE AND GAS UTILITIES. 48 HOURS NOTIFICATION IS REQUIRED

BEFORE STARTING ANY EXCAVATION, THE CONTRACTOR SHALL CALL "C.U.A.N." (CHICAGO UTILITY ALERT NETWORK) AT (312) 744-7000 FOR FIELD LOCATIONS OF BURIED ELECTRIC, TELEPHONE AND GAS UTILITIES. 48 HOURS NOTIFICATION IS REQUIRED.

THE CONTRACTOR SHALL COORDINATE CONSTRUCTION ACTIVITIES WITH UTILITY COMPANIES AND THE CITIES OF CHICAGO, BLUE ISLAND, NAPERVILLE AND VILLAGES OF OAK BROOK, ROCKDALE & MOKENA.

IT SHALL BE THE CONTRACTOR'S RESPONSIBILITY TO VERIFY ALL DIMENSIONS & CONDITIONS EXISTING IN THE FIELD PRIOR TO CONSTRUCTION & ORDERING OF MATERIALS.

THE CONTRACTOR WILL NOT BE ALLOWED TO SET UP A YARD OR FIELD OFFICE ON STATE PROPERTY WITHOUT WRITTEN PERMISSION FROM THE DEPARTMENT.

THE CONTRACTOR SHALL CONTACT THE DISTRICT ONE TRAFFIC CONTROL SUPERVISOR AT (847) 705-4470 A MINIMUM OF 72 HOURS IN ADVANCE OF BEGINNING WORK.

DO NOT SCALE PLANS FOR CONSTRUCTION DIMENSIONS.

EXISTING PAVEMENT MARKINGS SHALL BE TEMPORARILY COVERED PRIOR TO APPLICATION OF THE DECK SURFACE TREATMENT, TO PREVENT THE MATERIAL FROM BEING APPLIED TO THE MARKINGS. THE TEMPORARY COVERING SHALL BE REMOVED AFTER APPLICATION OF THE DECK SURFACE TREATMENT AND PRIOR TO OPENING TO TRAFFIC. COST IS INCLUDED WITH THE DECK SURFACE TREATMENT SPECIFIED.

THESE PLANS HAVE BEEN PREPARED FROM NOTES RECEIVED FROM THE BUREAU OF MAINTENANCE.

STATE STANDARDS

701301-04 LANE CLOSURE, 2L, 2W, SHORT TIME OPERATIONS

701501-06 URBAN LANE CLOSURE, 2L, 2W, UNDIVIDED

701601-07 URBAN LANE CLOSURE, MULTILANE, 1W OR 2W WITH NONTRAVERSABLE MEDIAN

701606-08 URBAN LANE CLOSURE, MULTILANE, 2W WITH MOUNTABLE MEDIAN

701801-05 LANE CLOSURE, MULTILANE 1W OR 2W CROSSWALK OR SIDEWALK CLOSURE

701901-02 TRAFFIC CONTROL DEVICES

ILLINOIS DEPARTMENT OF
TRANSPORTATION

GENERAL NOTES
STATE STANDARDS

ROUTE	SECTION	COUNTY	TOTAL SHEETS	SHEET NUMBER
VARIOUS	2011-216-I	VARIOUS	28	4

CONTRACT NO. 60R56

SUMMARY OF QUANTITIES						
CODE NO	DESCRIPTION	UNITS	TOTAL	CONSTRUCTION TYPE CODE: 0014		
67000400	ENGINEER'S FIELD OFFICE, TYPE A	CAL MO	3	3		
67100100	MOBILIZATION	L SUM	1	1		
70102620	TRAFFIC CONTROL AND PROTECTION, STANDARD 701501	L SUM	1	1		
70102625	TRAFFIC CONTROL AND PROTECTION, STANDARD 701606	L SUM	1	1		
70102630	TRAFFIC CONTROL AND PROTECTION, STANDARD 701601	L SUM	1	1		
70102640	TRAFFIC CONTROL AND PROTECTION, STANDARD 701801	L SUM	1	1		
Z0030850	TEMPORARY INFORMATION SIGNING	SQ FT	154.2	154.2		
Z0048665	RAILROAD PROTECTIVE LIABILITY INSURANCE	L SUM	1	1		
58700300	CONCRETE SEALER	SQ FT	69085	69085		

*URBAN
100% STATE*

ROUTE	SECTION	COUNTY	TOTAL SHEETS	SHEET NUMBER
VARIOUS	2011-216-I	VARIOUS	28	5

CONTRACT: 60R56

Location	COOK COUNTY		DUPAGE COUNTY		KANE COUNTY	WILL COUNTY								
	SN 016-0776	SN 016-1020	SN 022-0040	SN 022-0084	SN 045-0020	SN 099-0315	SN 099-0098	SN 099-0118	SN 099-0119	SN 099-0122	SN 099-0133	SN 099-0169	SN 099-0170	SN 099-0172
	1	2	3	4	5	6	7	8	9	10	11	12	13	14
BRIDGE DECK CONCRETE CRACK SEALER (SQ. FT)	5912	13502	7425	16630	2537	2168	2849	2085	1733	1983	6192	3621	964	1484
TRAFFIC CONTROL AND PROTECTION, STANDARD 701501						0.13		0.13	0.11	0.11	0.20	0.14	0.09	0.09
TRAFFIC CONTROL AND PROTECTION, STANDARD 701601	0.24	0.38		0.38										
TRAFFIC CONTROL AND PROTECTION, STANDARD 701606			0.33		0.33		0.34							
TRAFFIC CONTROL AND PROTECTION, STANDARD 701801	0.15	0.15	0.25	0.33	0.12									
RAILROAD PROTECTIVE LIABILITY INSURANCE (L SUM)		1												

ILLINOIS DEPARTMENT OF TRANSPORTATION
 SCHEDULE OF QUANTITIES

ROUTE	SECTION	COUNTY	TOTAL SHEETS	SHEET NUMBER
VARIOUS	2011-216-I	VARIOUS	28	6

CONTRACT NO. 60R56

**LOCATION 1: SN 016-0776
WESTERN AVE (GREGORY)
OVER VERMONT ST
CITY OF BLUE ISLAND**

**LOCATION 2: SN 016-1020
PULASKI RD NB
OVER RR-BRC
CITY OF CHICAGO**

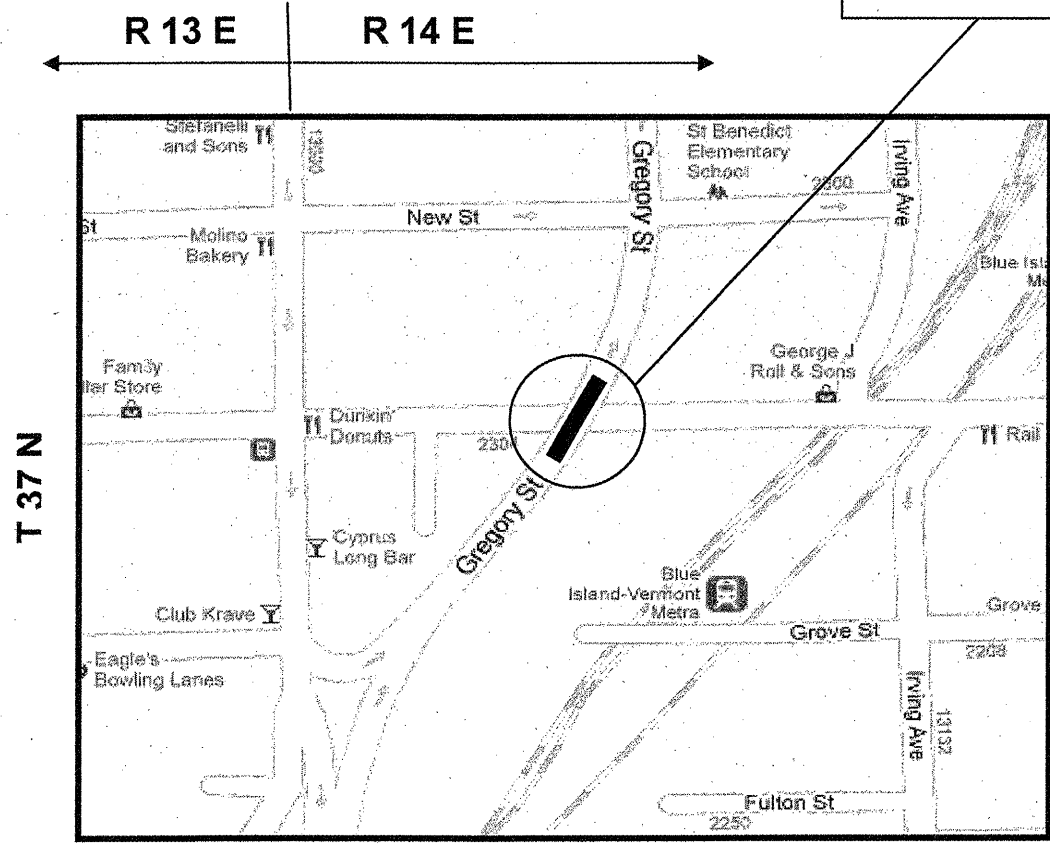

**CALUMET TOWNSHIP
COOK COUNTY**

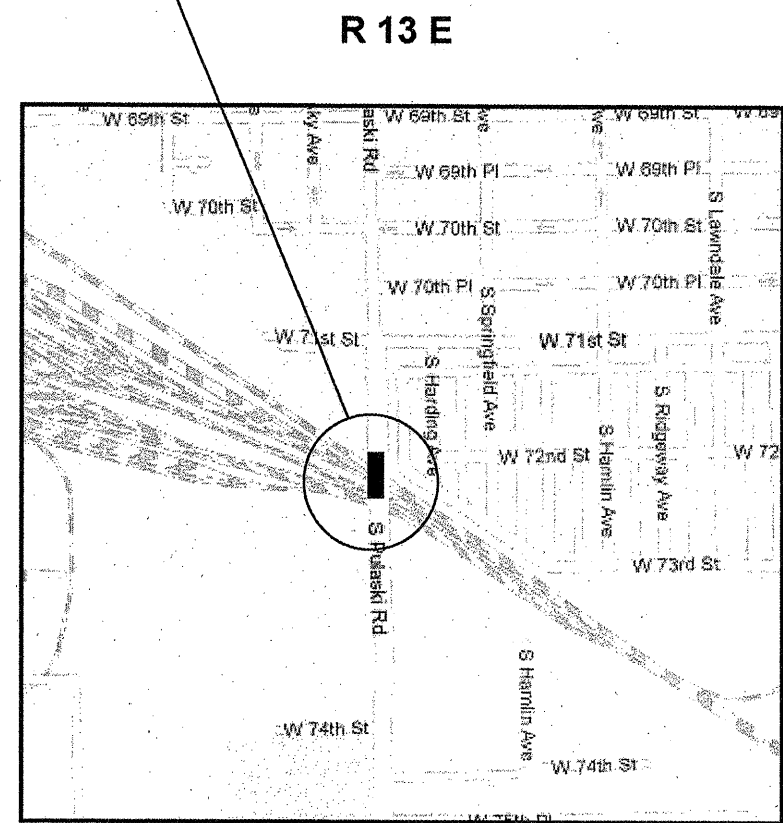

**LAKE TOWNSHIP
COOK COUNTY**



TRAFFIC DATA

WESTERN AVE (GREGORY) ST

2010 ADT = 8100
POSTED SPEED LIMIT = 25 MPH

PULASKI RD

2010 ADT = 22800
POSTED SPEED LIMIT = 35 MPH

**ILLINOIS DEPARTMENT OF
TRANSPORTATION**

**LOCATION MAP
LOCATION 1 & 2**

ROUTE	SECTION	COUNTY	TOTAL SHEETS	SHEET NUMBER
VARIOUS	2011-216-I	VARIOUS	28	7

CONTRACT NO. 60R56

LOCATION 3: SN 022-0040
US 34 (W OGDEN AVE)
OVER W BR DUPAGE RIVER
CITY OF NAPERVILLE

R 9 E

T 38 N

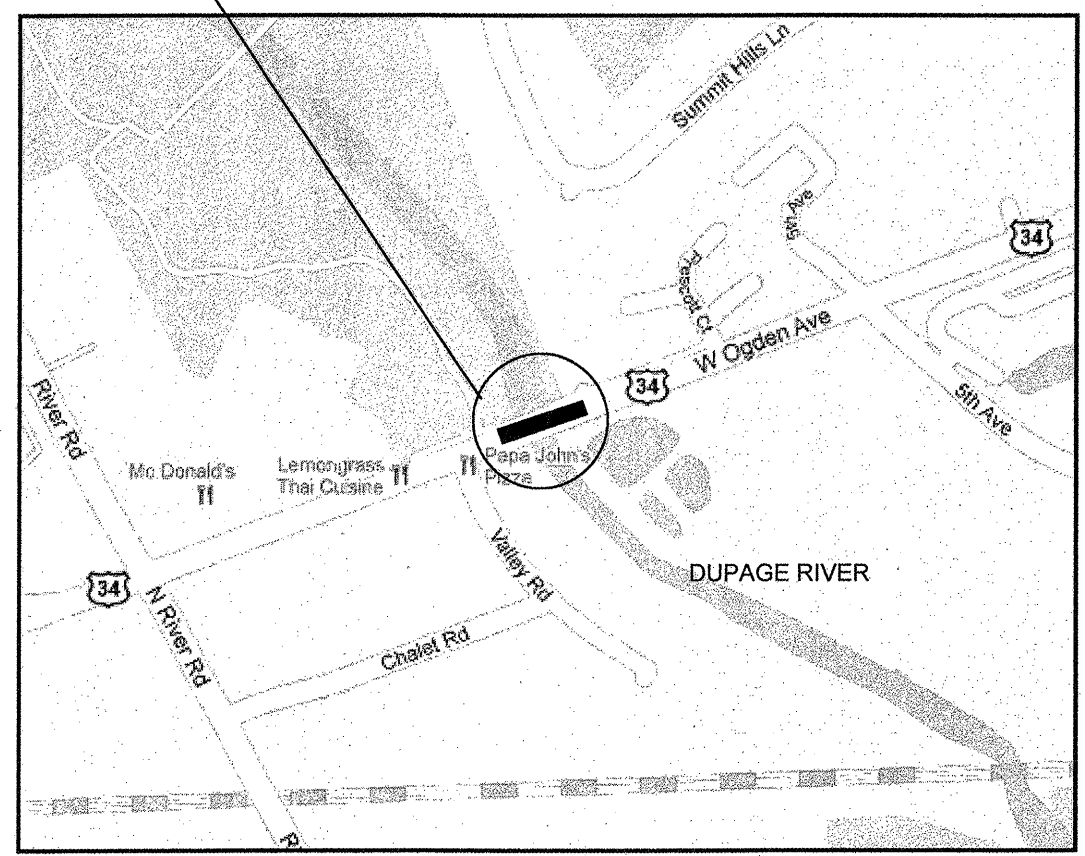

NAPERVILLE TOWNSHIP
DUPAGE COUNTY

LOCATION 4: SN 022-0084
22nd ST (CERMAK RD)
OVER SALT CREEK
VILLAGE OF OAK BROOK

R 11 E

T 39 N

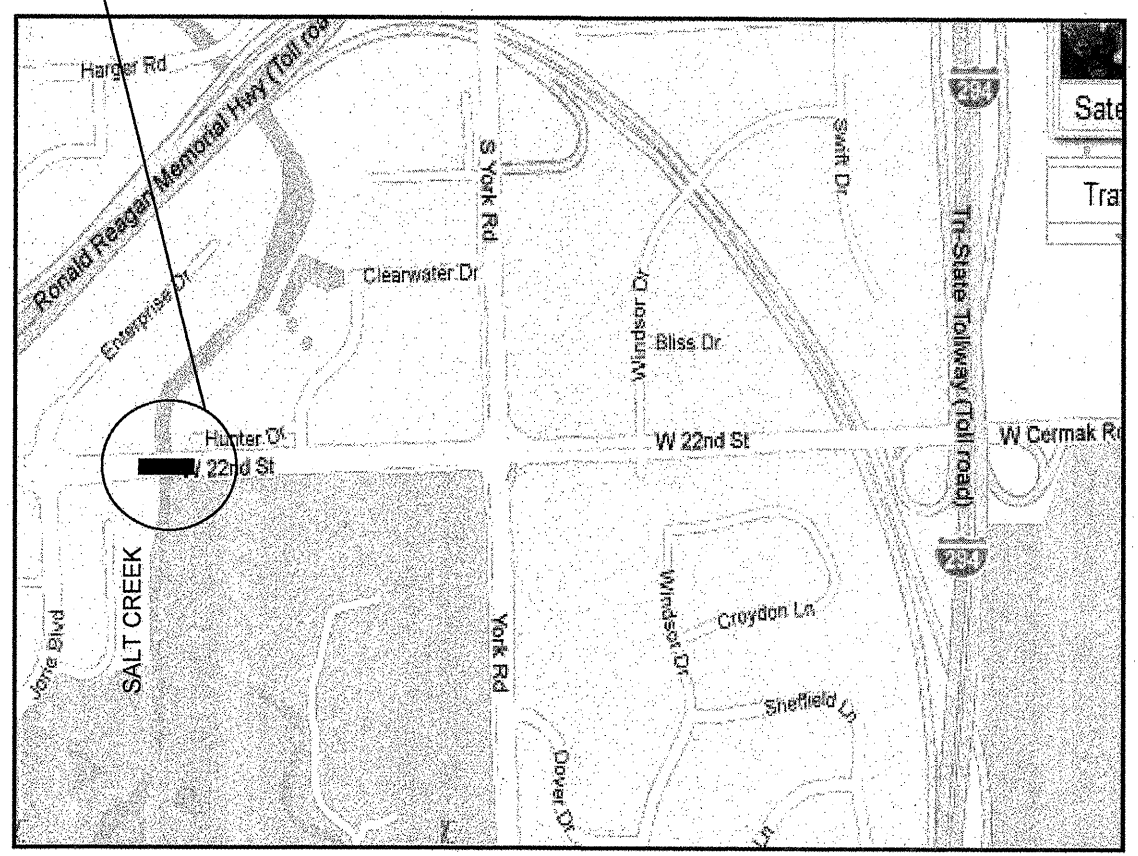

YORK TOWNSHIP
DUPAGE COUNTY



TRAFFIC DATA

US 34 (W OGDEN AVE)

2009 ADT = 32800
POSTED SPEED LIMIT = 40 MPH

22nd ST (CERMAK RD)

2008 ADT = 21000
POSTED SPEED LIMIT = 40 MPH

ILLINOIS DEPARTMENT OF
TRANSPORTATION

LOCATION MAP
LOCATION 3 & 4

ROUTE	SECTION	COUNTY	TOTAL SHEETS	SHEET NUMBER
VARIOUS	2011-216-I	VARIOUS	28	8

CONTRACT NO. 60R56

LOCATION 5: SN 045-0020
IL 31
OVER MILL CREEK
BATAVIA TOWNSHIP

R 8 E

T 39 N

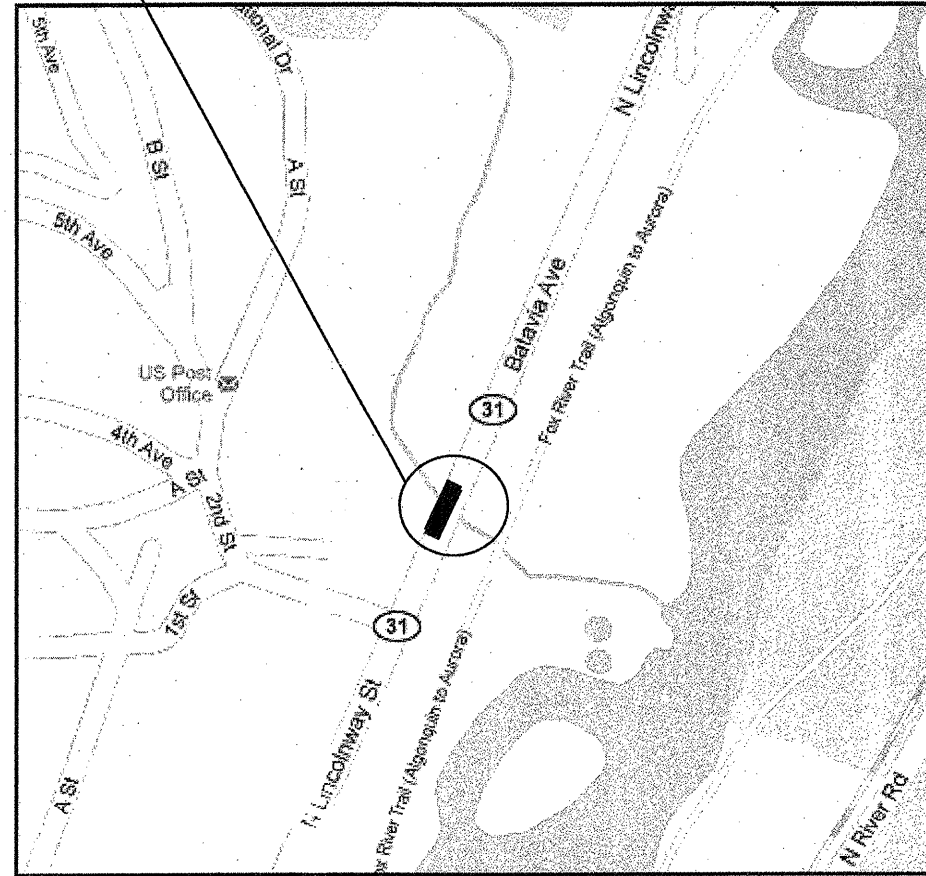

BATAVIA TOWNSHIP
KANE COUNTY



R 12 E

T 35 N

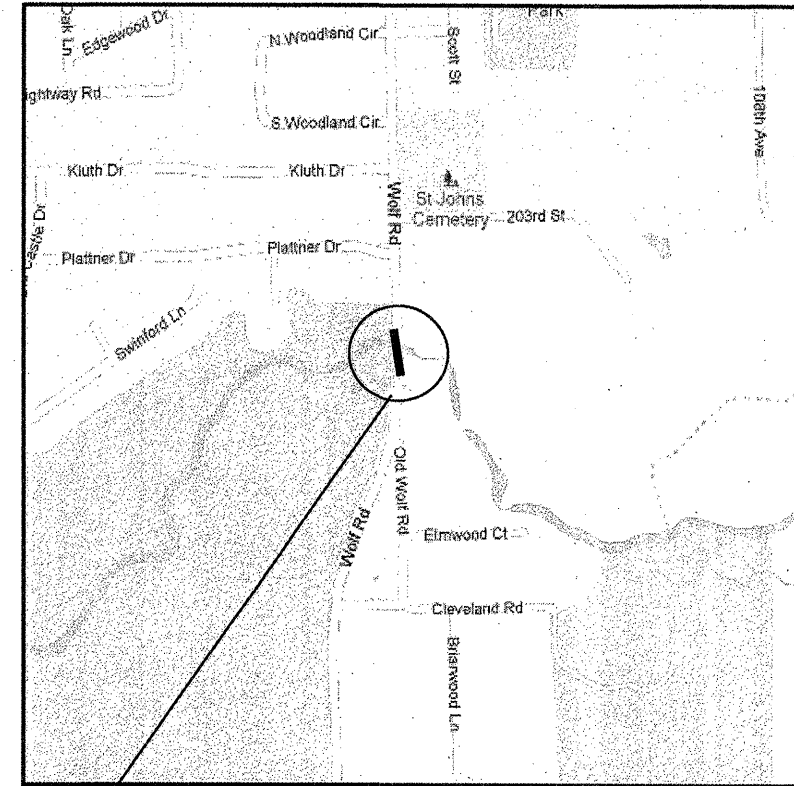

LOCATION 6: 099-0315
WOLF RD OVER
HICKORY CREEK
VILLAGE OF MOKENA

FRANKFORT TOWNSHIP
WILL COUNTY

TRAFFIC DATA

IL 31

2009 ADT = 12600
POSTED SPEED LIMIT = 35 MPH

WOLF ROAD

2008 ADT = 12100
POSTED SPEED LIMIT = 40 MPH

ILLINOIS DEPARTMENT OF
TRANSPORTATION

LOCATION MAP
LOCATION 5 & 6

ROUTE	SECTION	COUNTY	TOTAL SHEETS	SHEET NUMBER
VARIOUS	2011-216-I	VARIOUS	28	9

CONTRACT NO. 60R56

LOCATION 7: SN 099-0098
US 6 OVER I & M CANAL
VILLAGE OF ROCKDALE

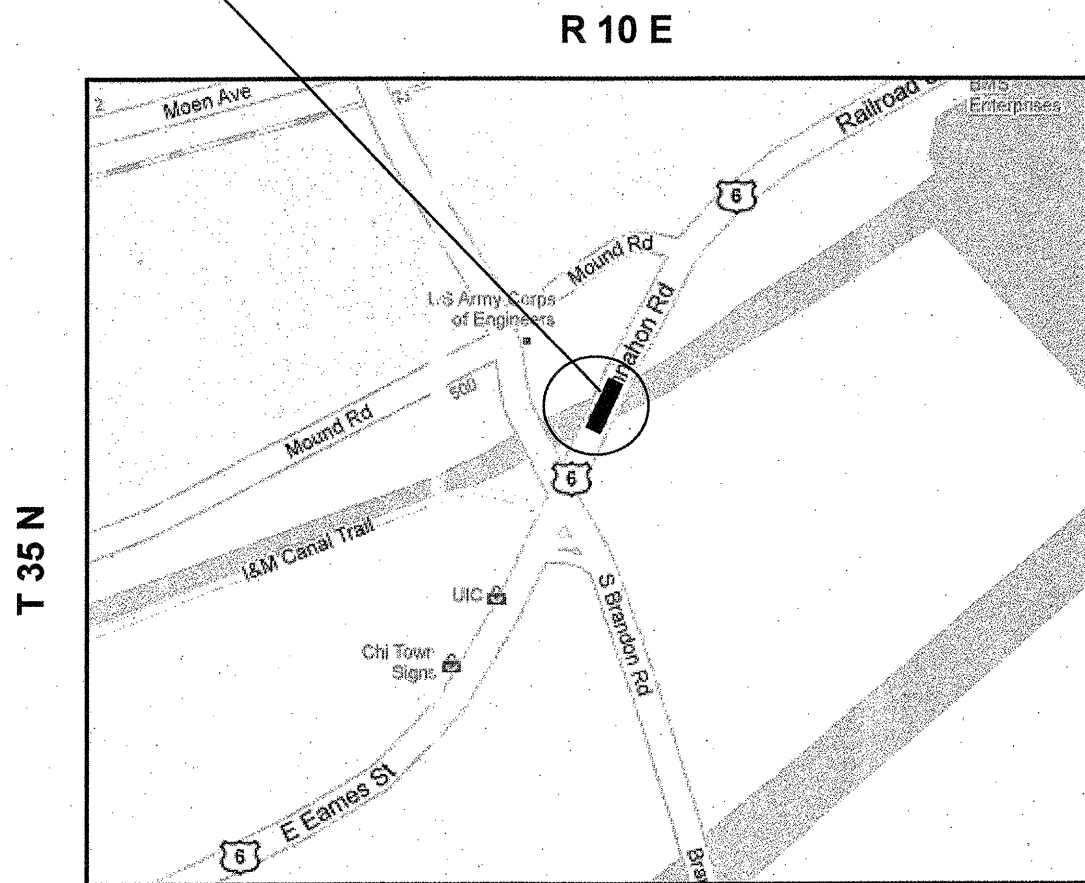

JOLIET TOWNSHIP
WILL COUNTY



T 34 N

R 12 E

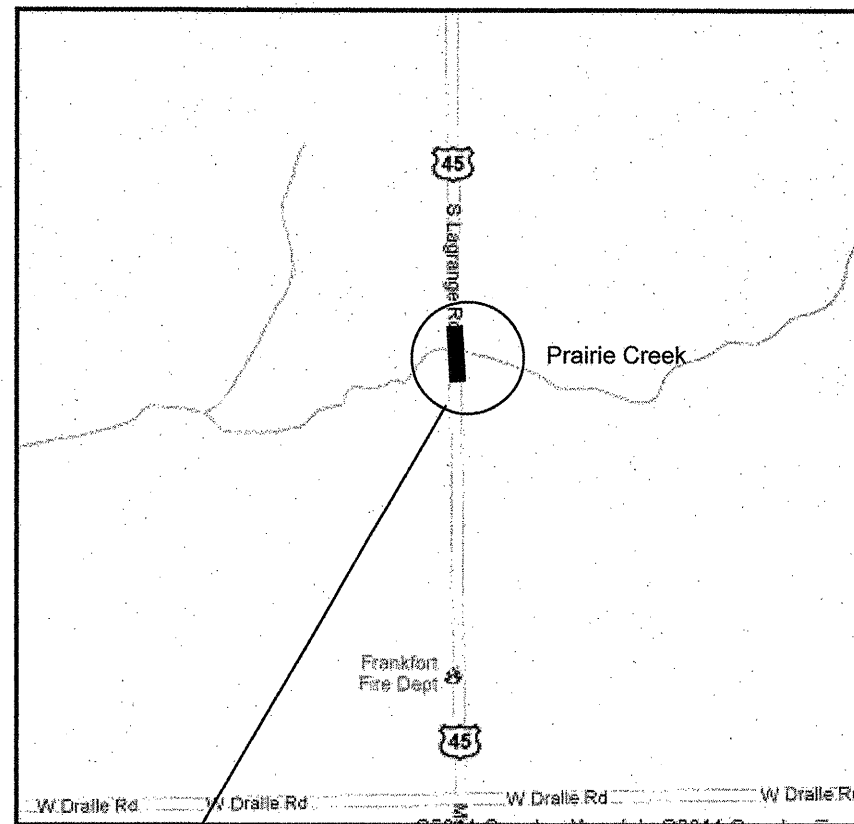

GREEN GARDEN TOWNSHIP
WILL COUNTY

R 12 E

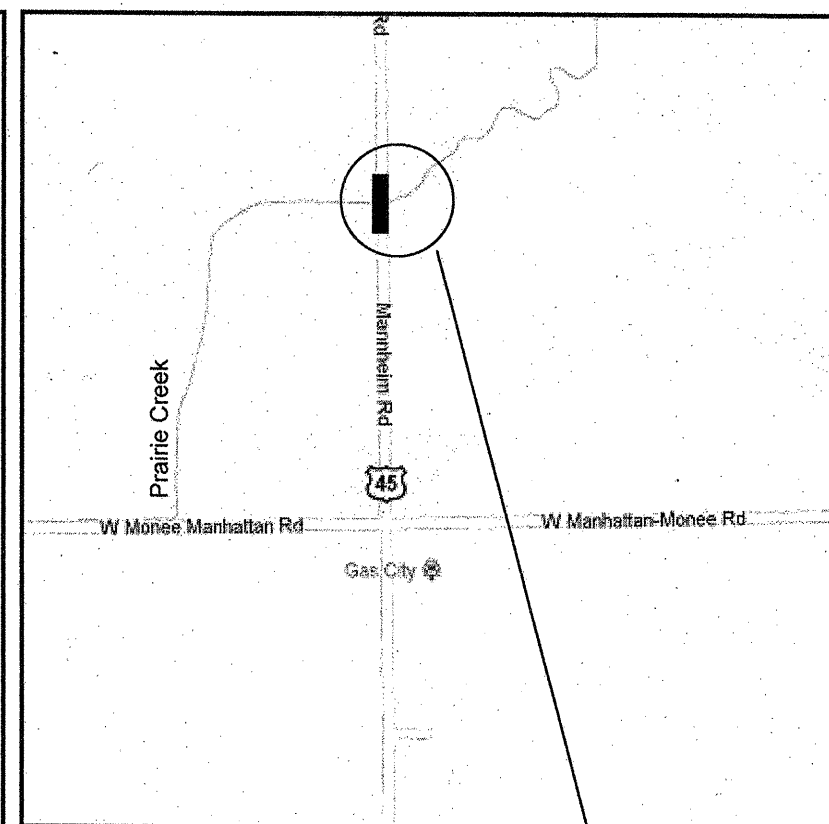

LOCATION 9: 099-0119
US 45 OVER
PRAIRIE CREEK
GREEN GARDEN TOWNSHIP

LOCATION 8: 099-0118
US 45 OVER
N BR PRAIRIE CREEK
GREEN GARDEN TOWNSHIP

TRAFFIC DATA

US 6

2009 ADT = 2550
POSTED SPEED LIMIT = 45 MPH

US 45

2009 ADT = 5100
POSTED SPEED LIMIT = 55 MPH

ILLINOIS DEPARTMENT OF
TRANSPORTATION

LOCATION MAP
LOCATION 7; 8 & 9

ROUTE	SECTION	COUNTY	TOTAL SHEETS	SHEET NUMBER
VARIOUS	2011-216-I	VARIOUS	28	10

CONTRACT NO. 60R56

LOCATION 10: SN 099-0122
US 45/ 52 OVER
SMALL STREAM
PEOTONE TOWNSHIP

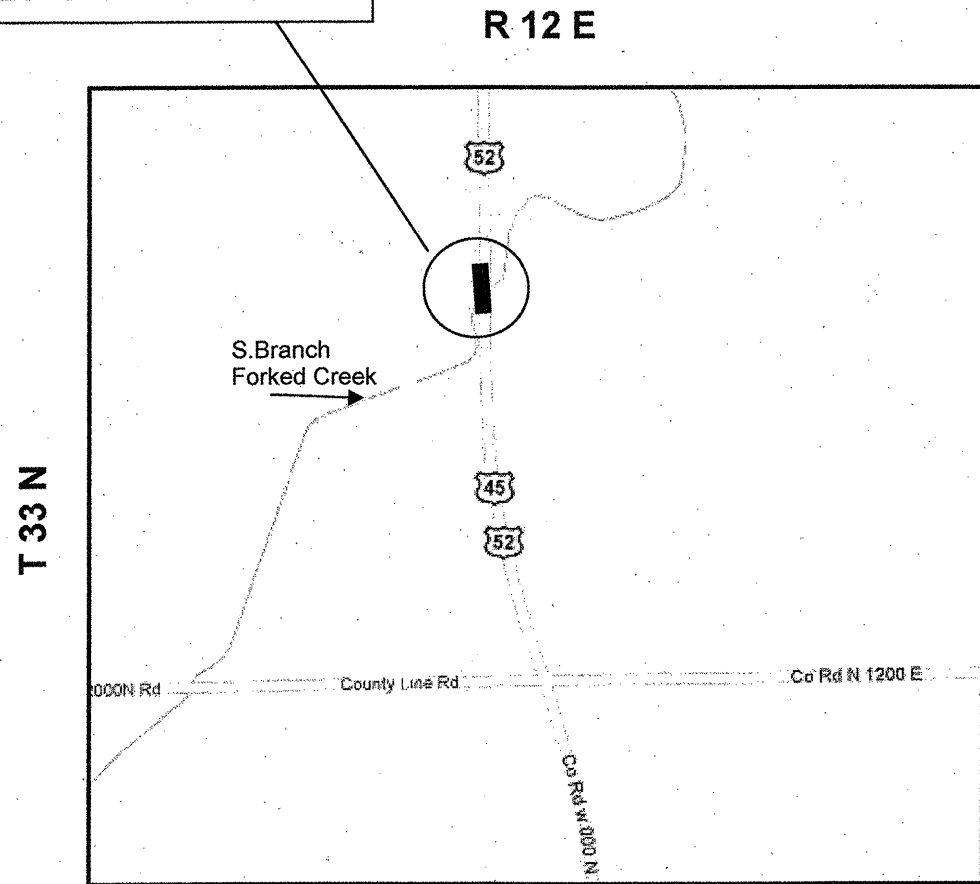

PEOTONE TOWNSHIP
WILL COUNTY

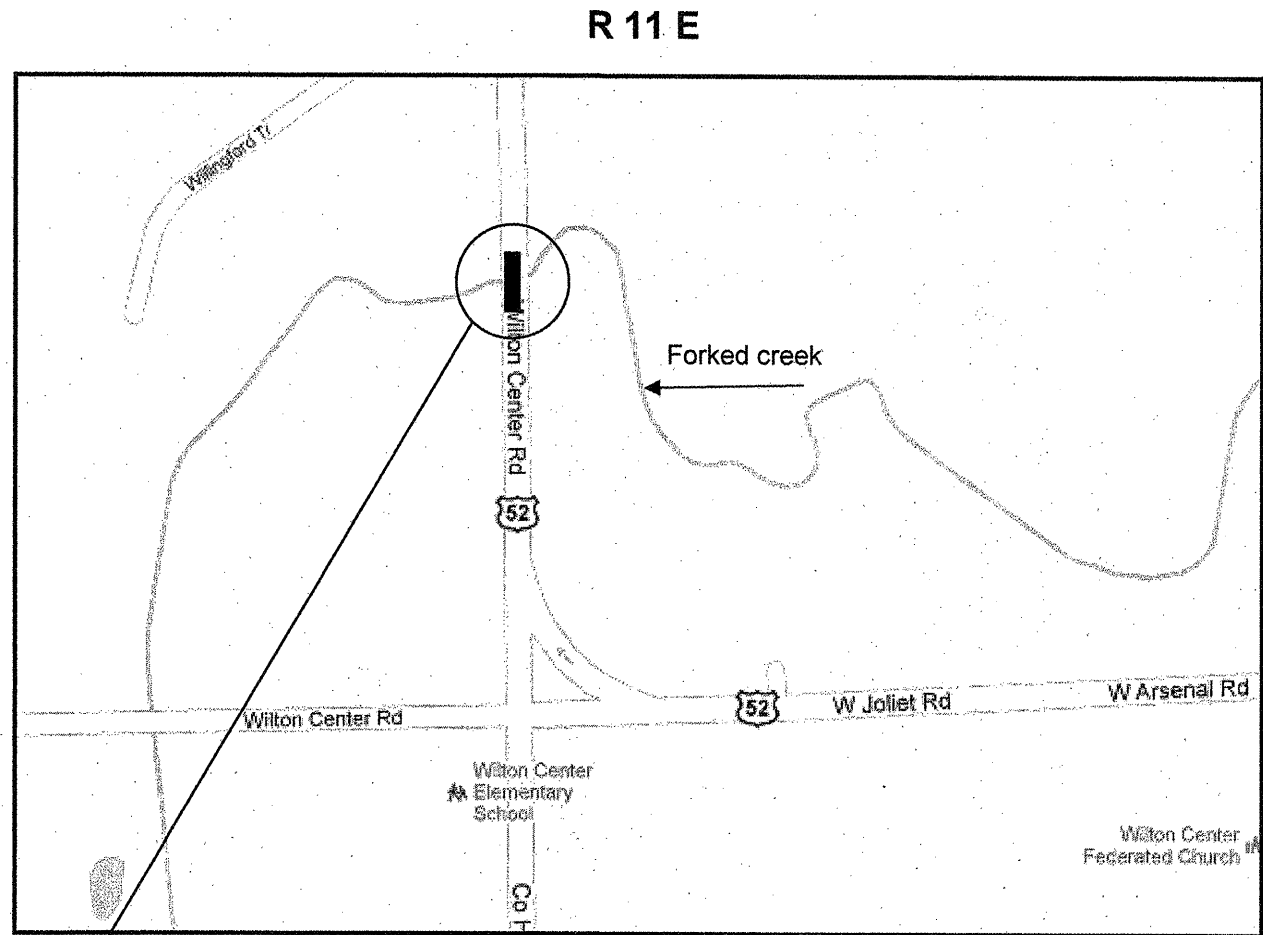

WILTON TOWNSHIP
WILL COUNTY

LOCATION 11: 099-0133
US 52 OVER
FORKED CREEK
WILTON TOWNSHIP

TRAFFIC DATA

US 45 /52

2009 ADT = 5500
POSTED SPEED LIMIT = 45 MPH

US 52

2009 ADT = 3850
POSTED SPEED LIMIT = 45 MPH

ILLINOIS DEPARTMENT OF
TRANSPORTATION

LOCATION MAP
LOCATION 10 & 11

ROUTE	SECTION	COUNTY	TOTAL SHEETS	SHEET NUMBER
VARIOUS	2011-216-I	VARIOUS	28	11

CONTRACT NO. 60R56

LOCATION 12: SN 099-0169
IL 102 OVER
FORKED CREEK OVERFLOW
WESLEY TOWNSHIP

R 10 E

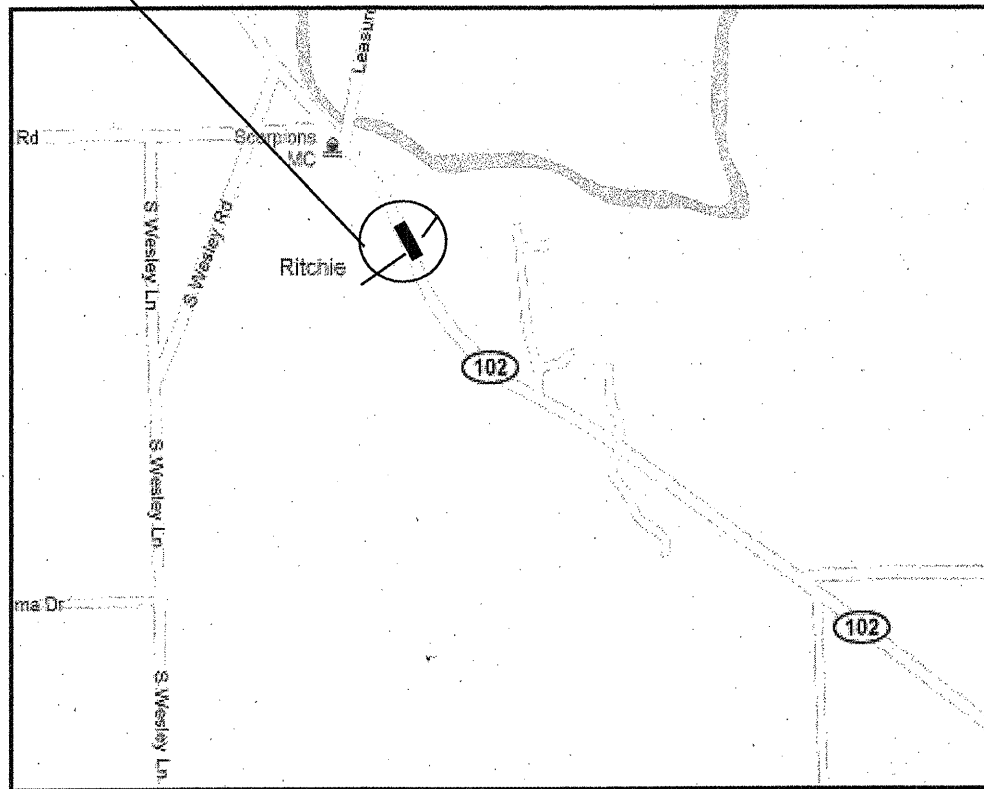

T 32 N

WESLEY TOWNSHIP
WILL COUNTY

TRAFFIC DATA

IL 102
2009 ADT = 2750
POSTED SPEED LIMIT = 40 MPH

IL 113
2009 ADT = 2650
POSTED SPEED LIMIT = 50 MPH

LOCATION 13: 099-0170
IL 102 OVER RAYNS CREEK
WESLEY TOWNSHIP

R 10 E

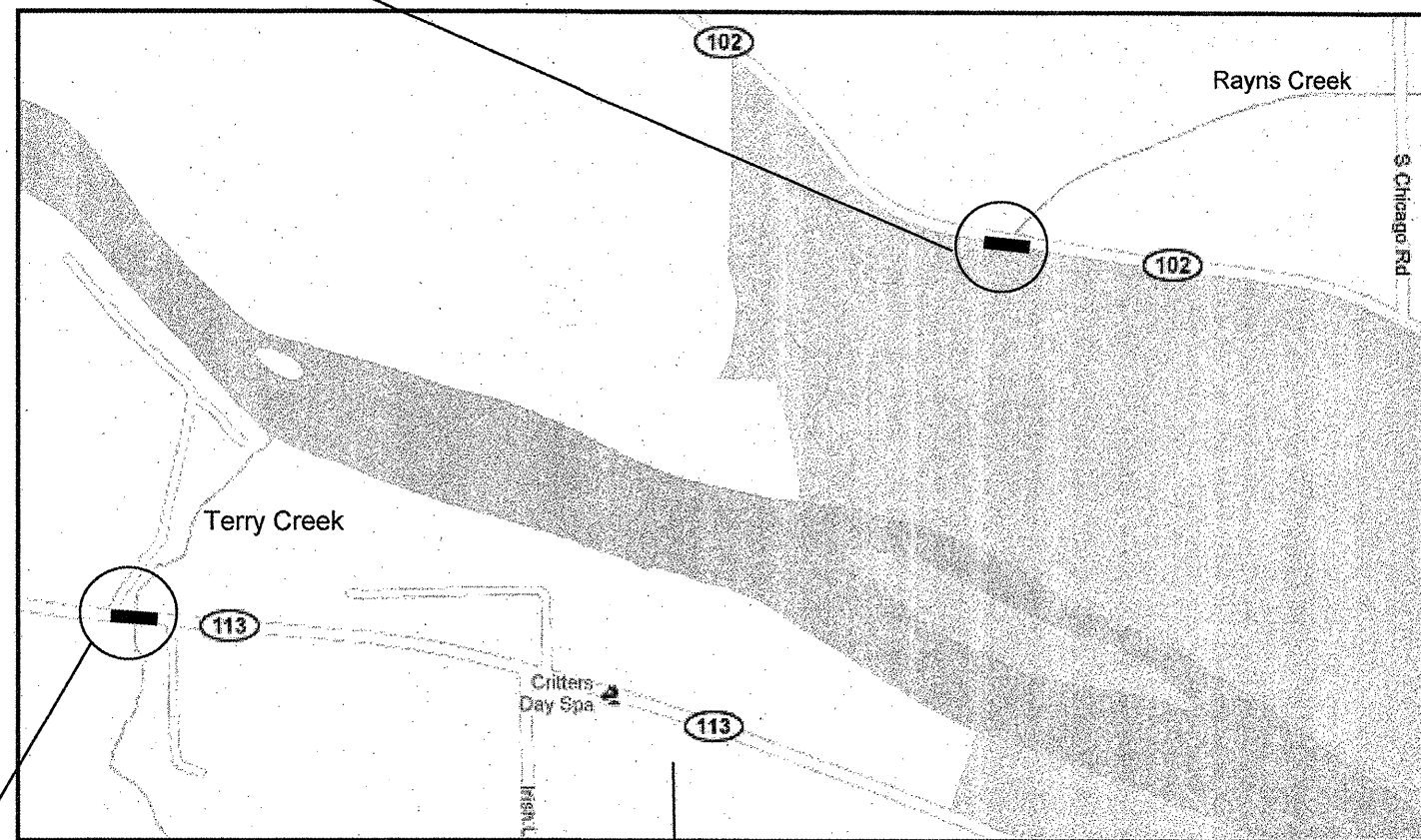

T 32 N

← CUSTER TOWNSHIP | WESLEY TOWNSHIP →

WILL COUNTY

LOCATION 14: 099-0172
IL 113 OVER TERRY CREEK
CUSTER TOWNSHIP

ILLINOIS DEPARTMENT OF
TRANSPORTATION

LOCATION MAP
LOCATION 12; 13 & 14

ROUTE	SECTION	COUNTY	TOTAL SHEETS	SHEET NUMBER
VARIOUS	2011-216-I	VARIOUS	28	12

CONTRACT NO. 60R56

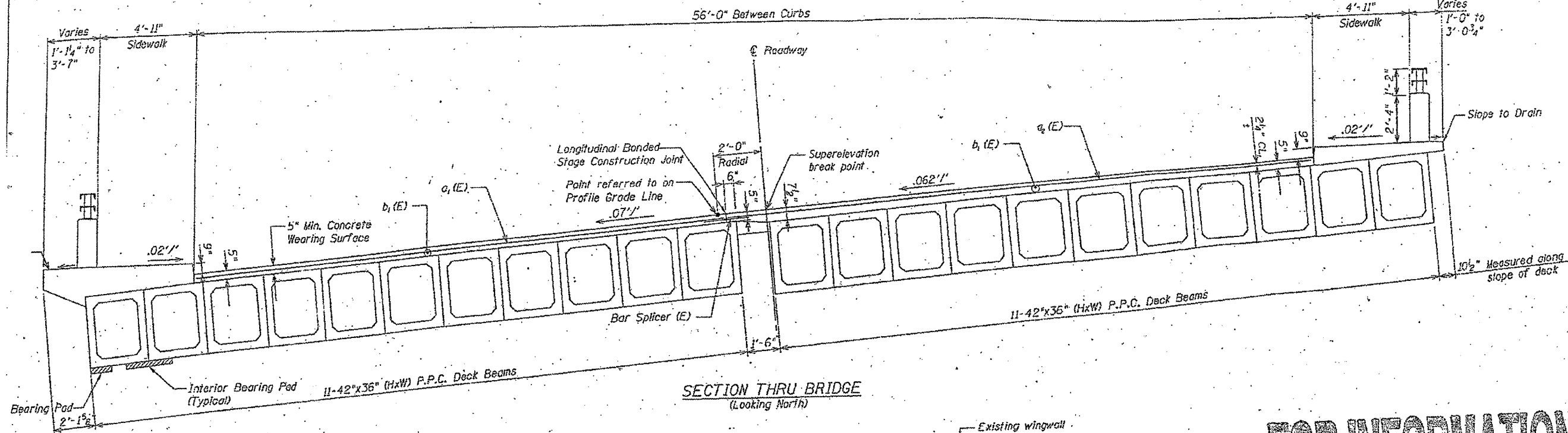

FOR INFORMATION ONLY

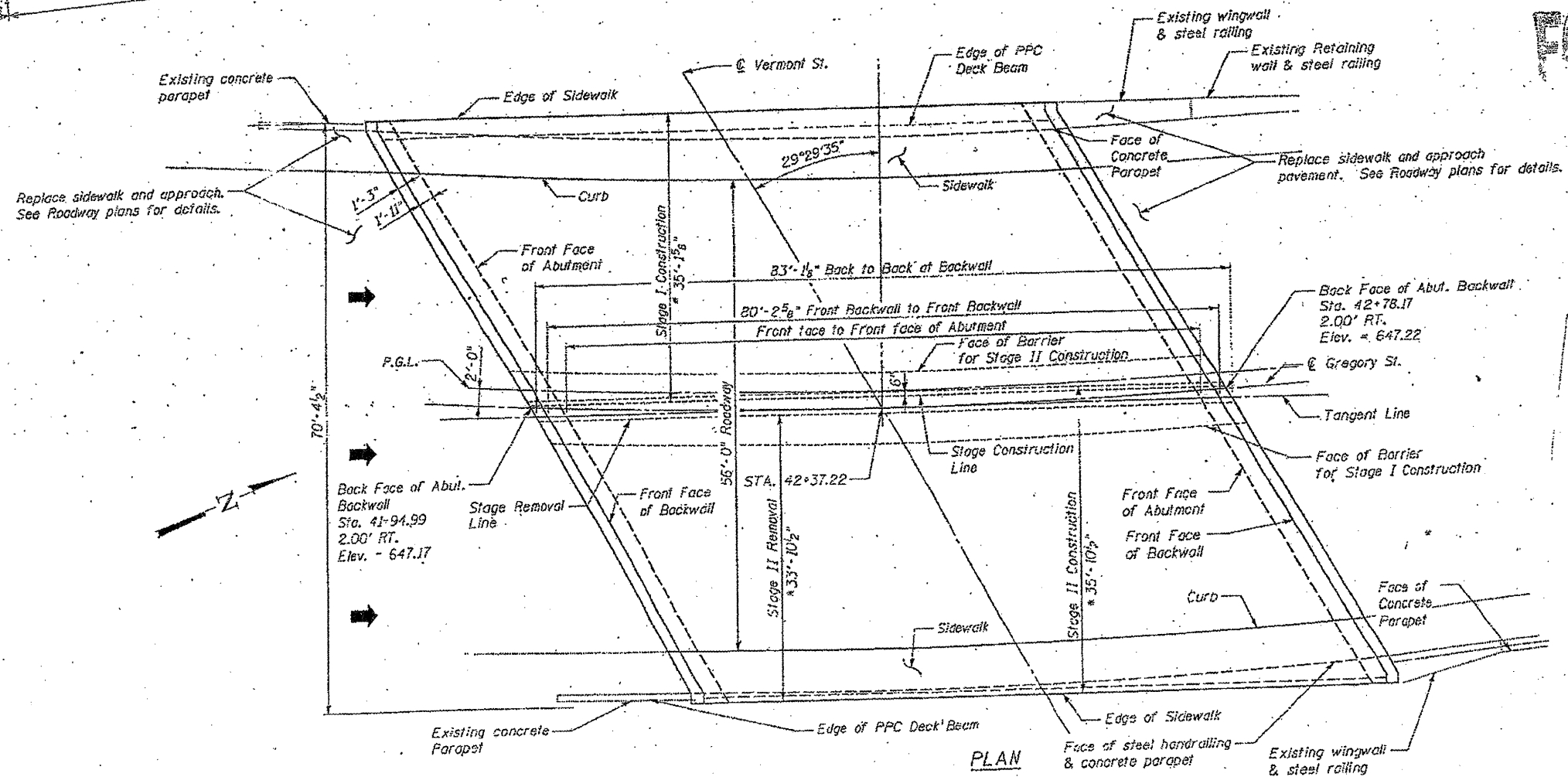

ILLINOIS DEPARTMENT OF
TRANSPORTATION

EXISTING PLANS
LOCATION 1 (SN 016-0776)

ROUTE	SECTION	COUNTY	TOTAL SHEETS	SHEET NUMBER
VARIOUS	2011-216-1	VARIOUS	28	13

CONTRACT NO. 60R56

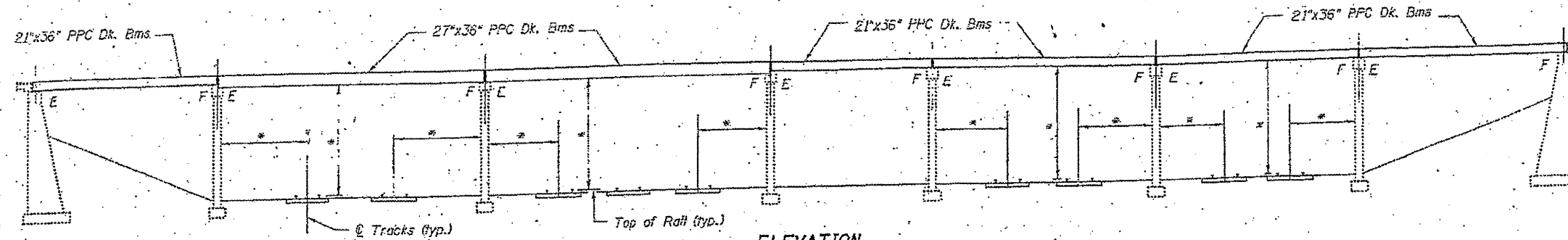

ELEVATION

Note: Existing clearances shall be maintained.

FOR INFORMATION ONLY

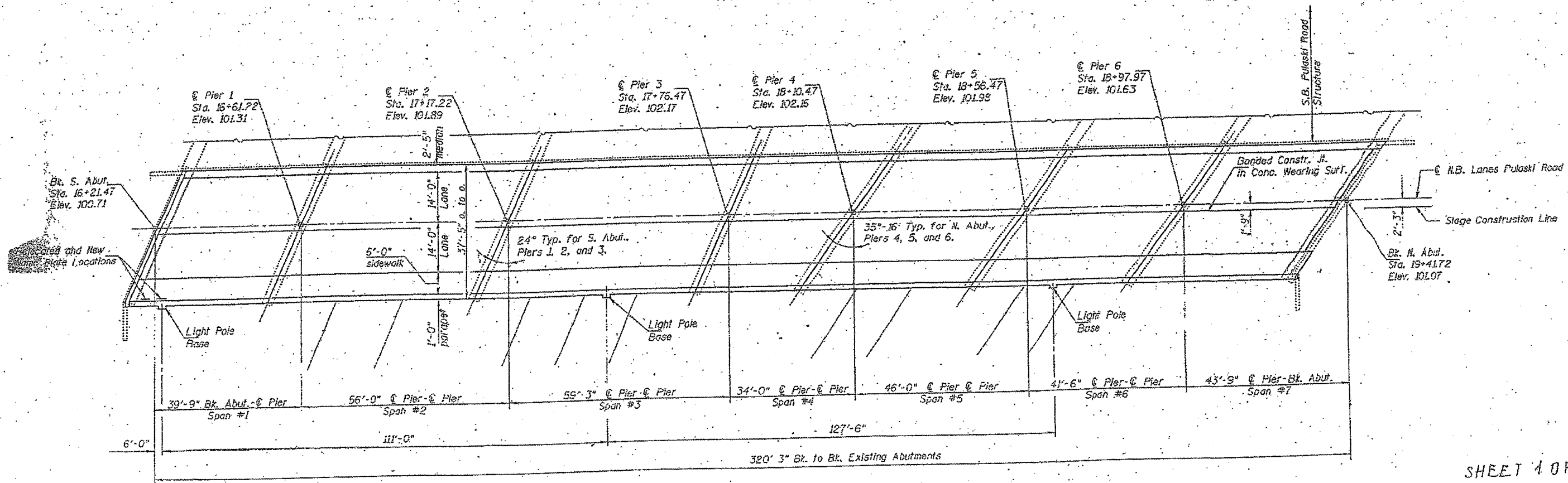

PLAN

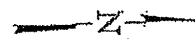

SHEET 1 OF 2

ILLINOIS DEPARTMENT OF
TRANSPORTATION

EXISTING PLANS
LOCATION 2 (SN 016-1020) 1 of 2

ROUTE VARIOUS	SECTION 201-216-I	COUNTY VARIOUS	TOTAL SHEETS 28	SHEET NUMBER 14
------------------	----------------------	-------------------	--------------------	--------------------

CONTRACT NO. 60R56

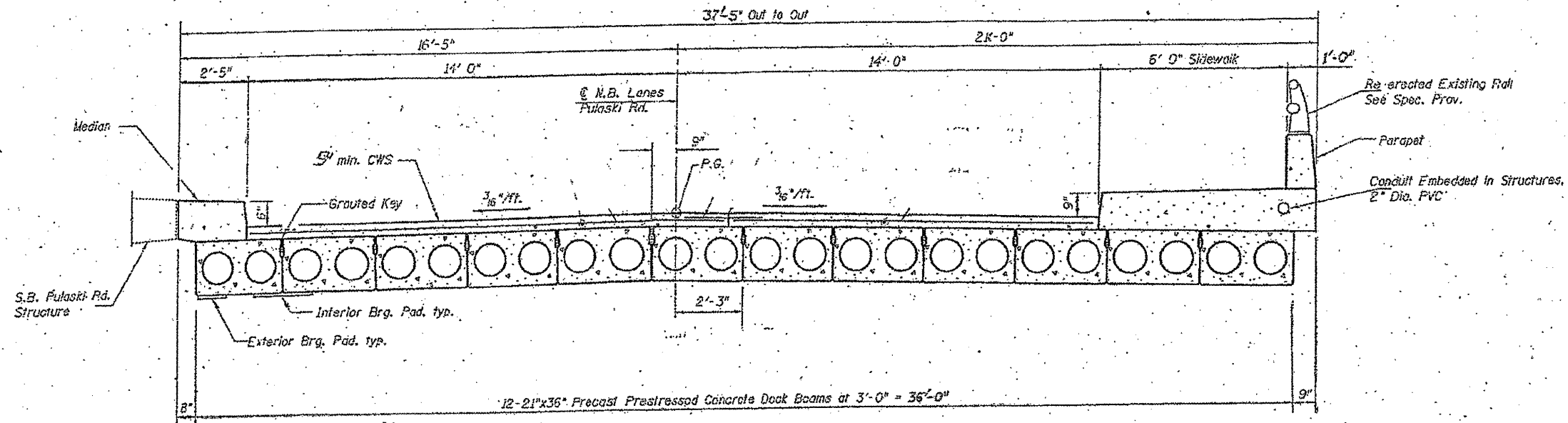

CROSS SECTION
Span 1, Span 4, Span 5, Span 6, and Span 7
(Looking North)

FOR INFORMATION ONLY

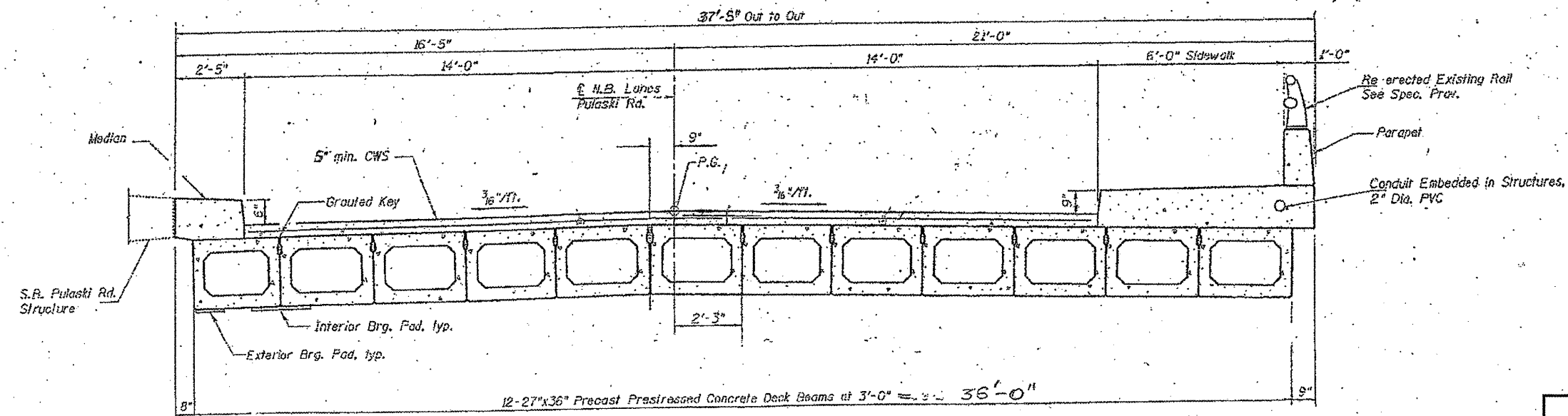

CROSS SECTION
Span 2 and Span 3
(Looking North)

SHEET 2 OF 2

**ILLINOIS DEPARTMENT OF
TRANSPORTATION**

**EXISTING PLANS
LOCATION 2 (SN 016-1020) 2 of 2**

ROUTE VARIOUS	SECTION 2011-216-1	COUNTY VARIOUS	TOTAL SHEETS 28	SHEET NUMBER 15
------------------	-----------------------	-------------------	--------------------	--------------------

CONTRACT NO. 60R56

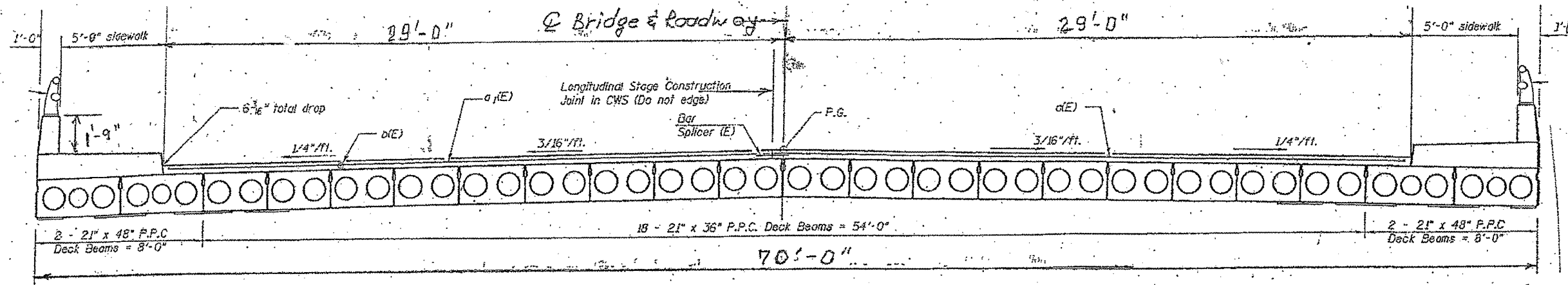

CROSS SECTION
(LOOKING EAST)

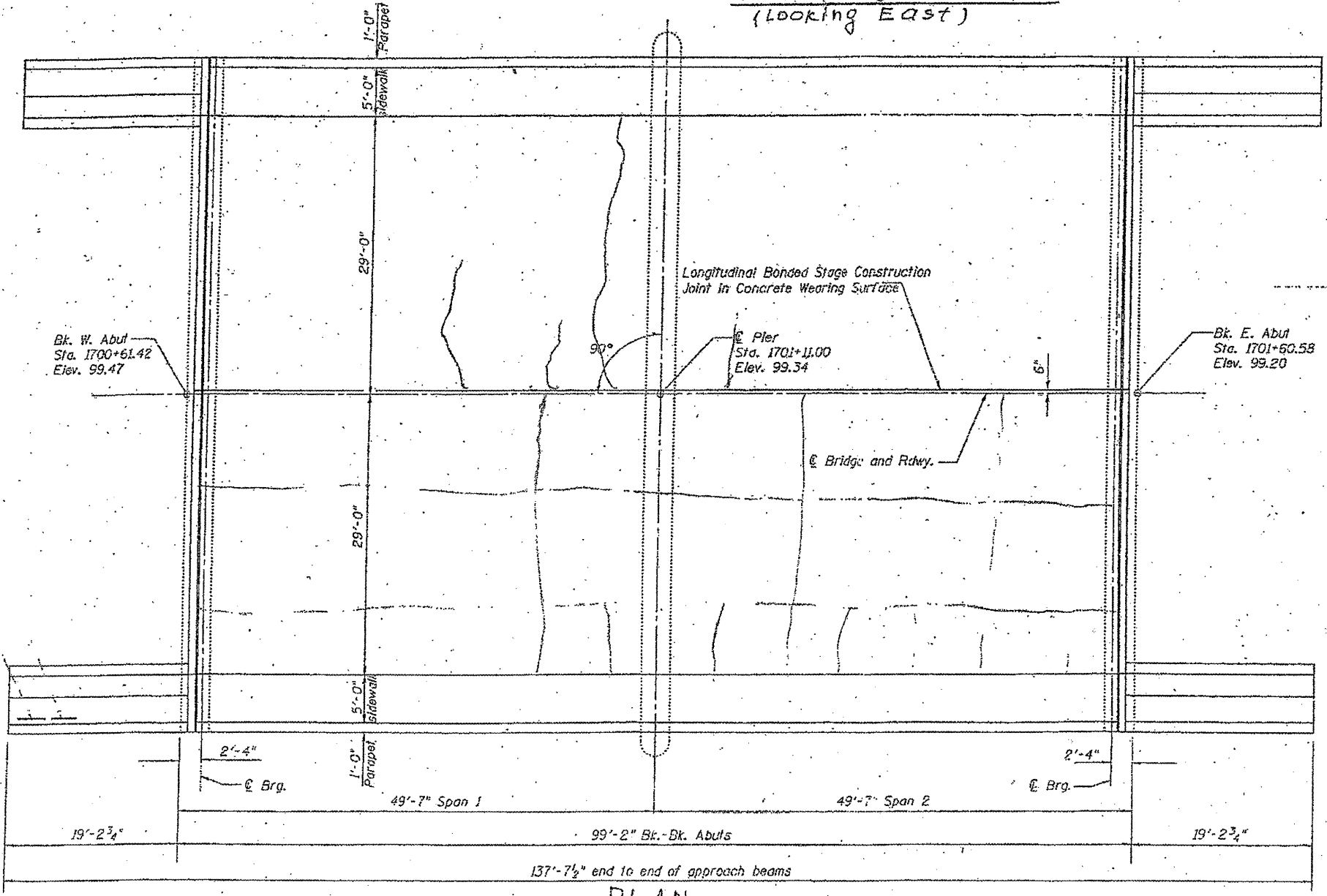

FOR INFORMATION ONLY

ILLINOIS DEPARTMENT OF
TRANSPORTATION

EXISTING PLANS
LOCATION 3 (SN 022-0040)

ROUTE VARIOUS	SECTION 2011-216-I	COUNTY VARIOUS	TOTAL SHEETS 28	SHEET NUMBER 16
-------------------------	------------------------------	--------------------------	---------------------------	---------------------------

CONTRACT NO. 60R56

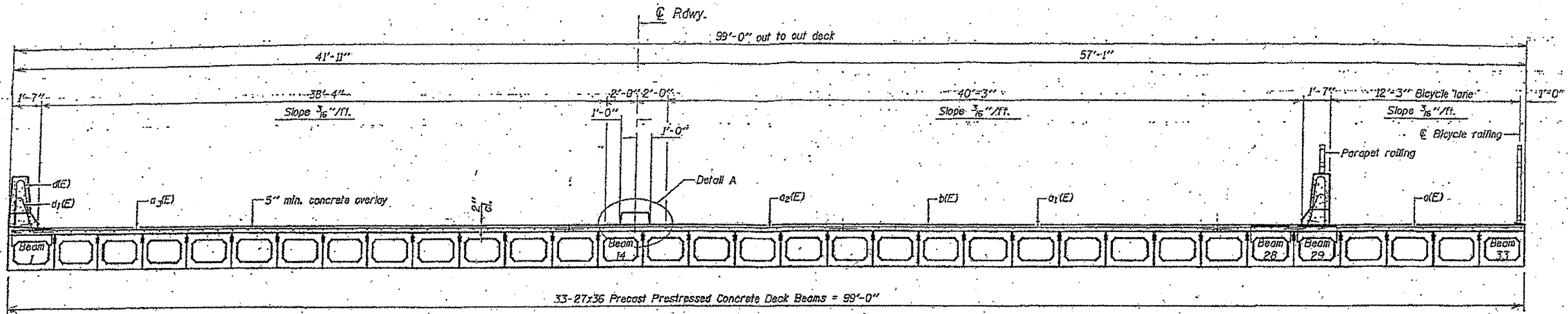

CROSS SECTION
(Looking east)

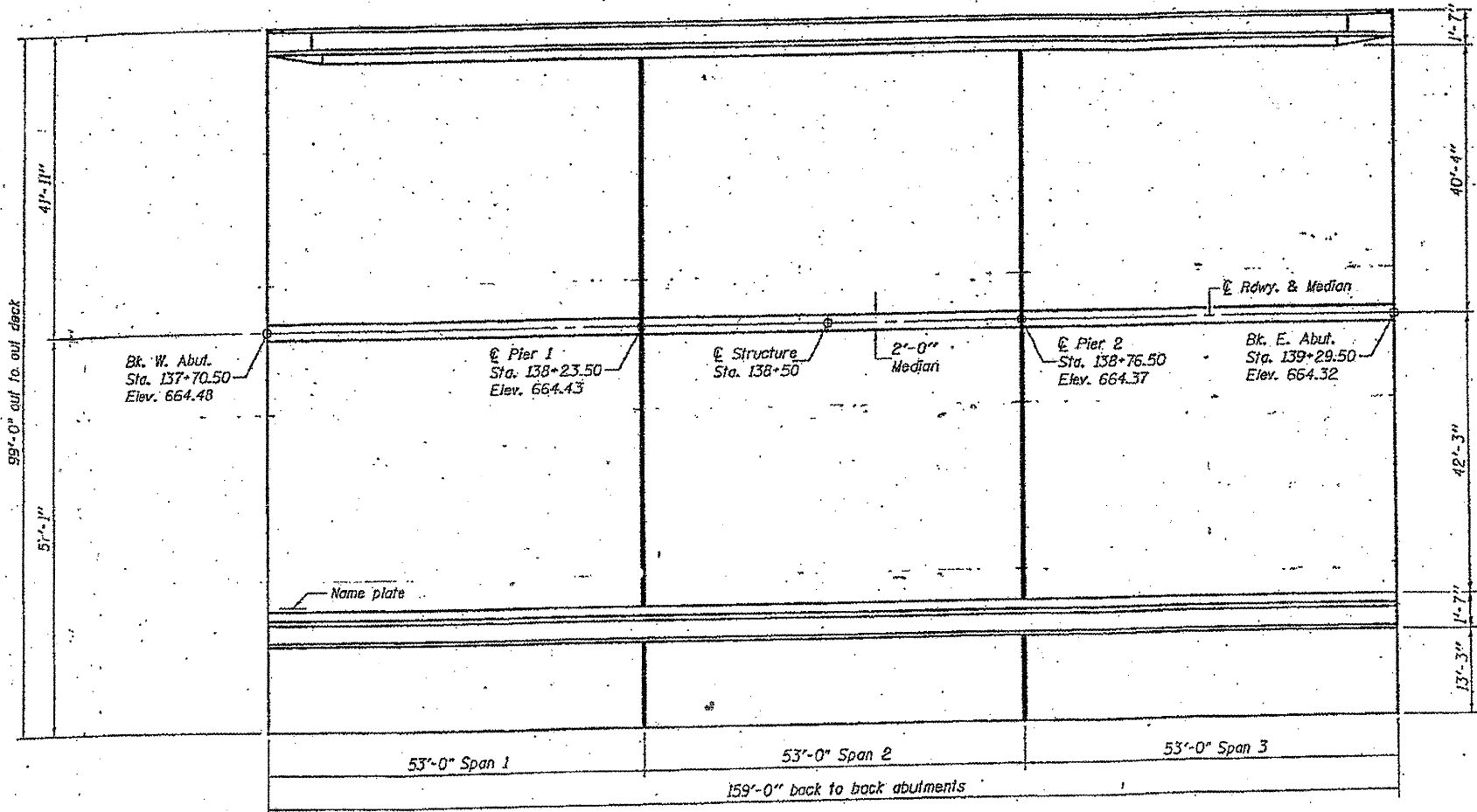

PLAN

FOR INFORMATION ONLY

ILLINOIS DEPARTMENT OF
TRANSPORTATION

EXISTING PLANS
LOCATION 4 (SN 022-0084)

ROUTE VARIOUS	SECTION 2011-216-1	COUNTY VARIOUS	TOTAL SHEETS 28	SHEET NUMBER 17
------------------	-----------------------	-------------------	-----------------------	-----------------------

CONTRACT NO. 60R56

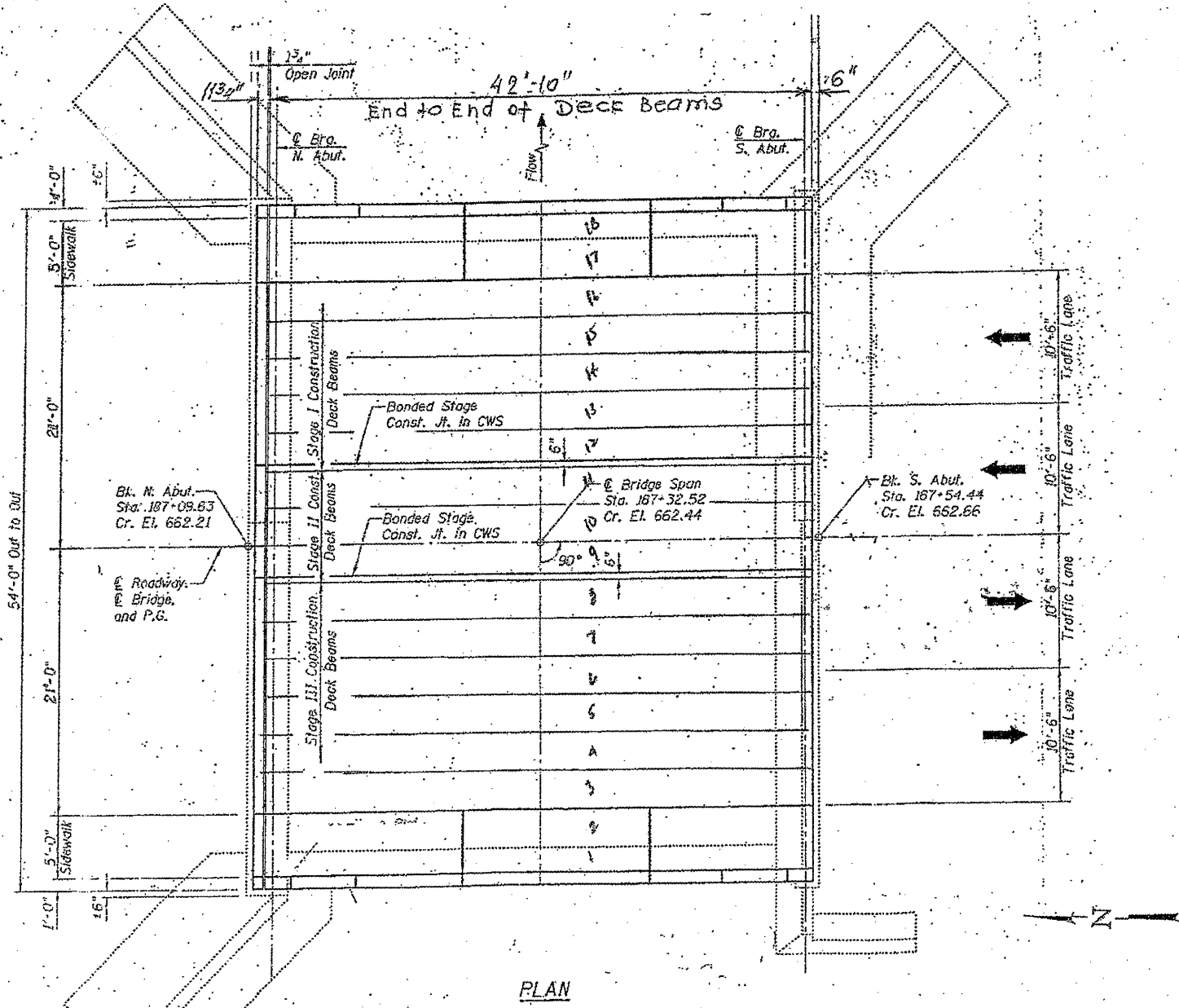
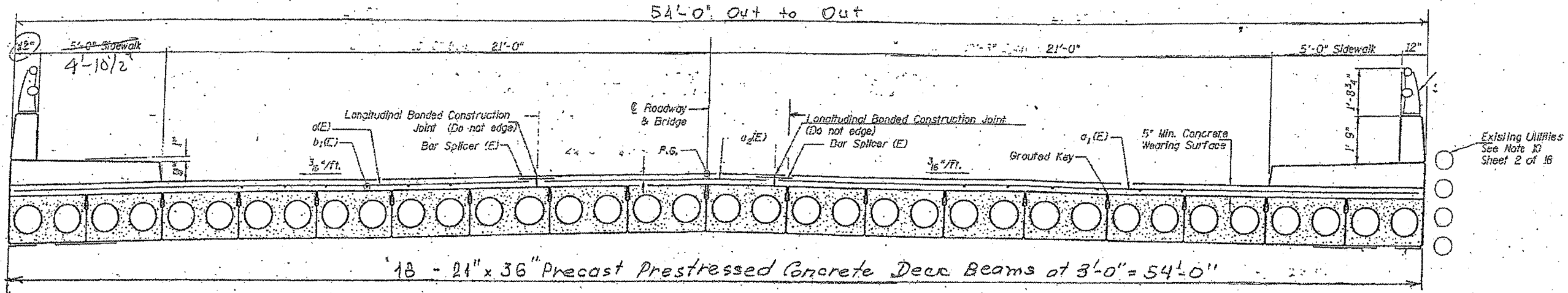

FOR INFORMATION ONLY

ILLINOIS DEPARTMENT OF TRANSPORTATION

EXISTING PLANS
LOCATION 5 (SN 045-0020)

ROUTE	SECTION	COUNTY	TOTAL SHEETS	SHEET NUMBER
VARIOUS	2011-216-I	VARIOUS	28	18

CONTRACT NO. 60R56

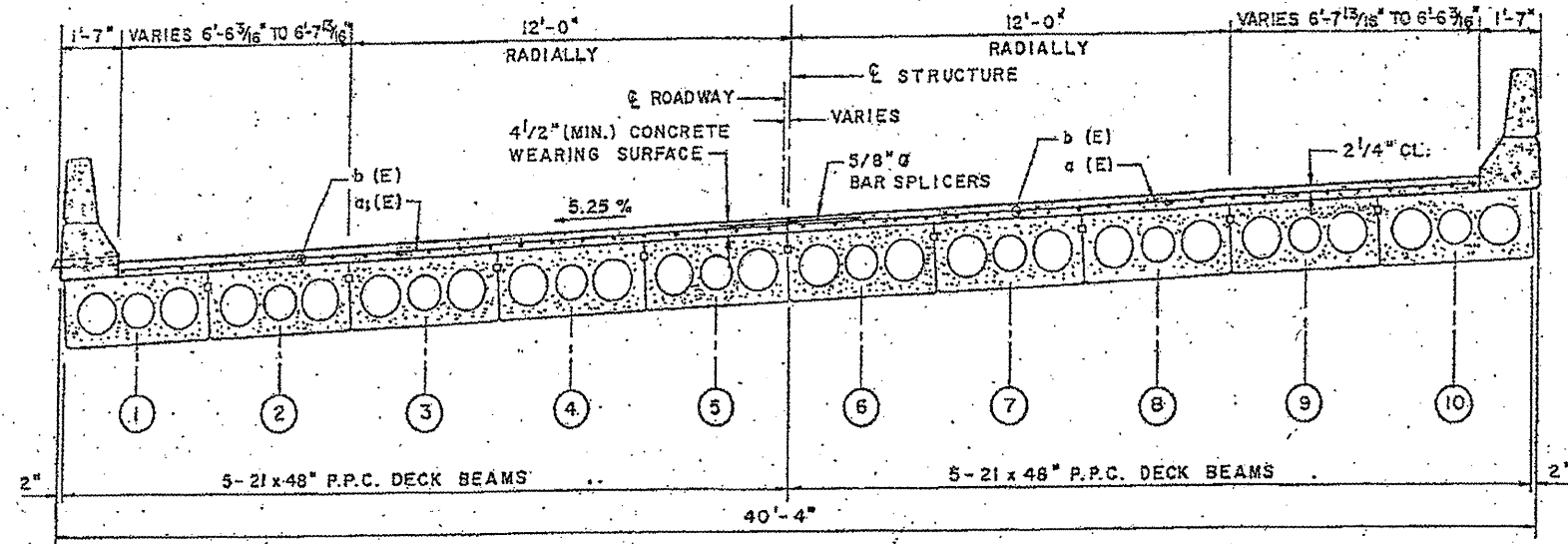

CROSS SECTION
(LOOKING SOUTH)

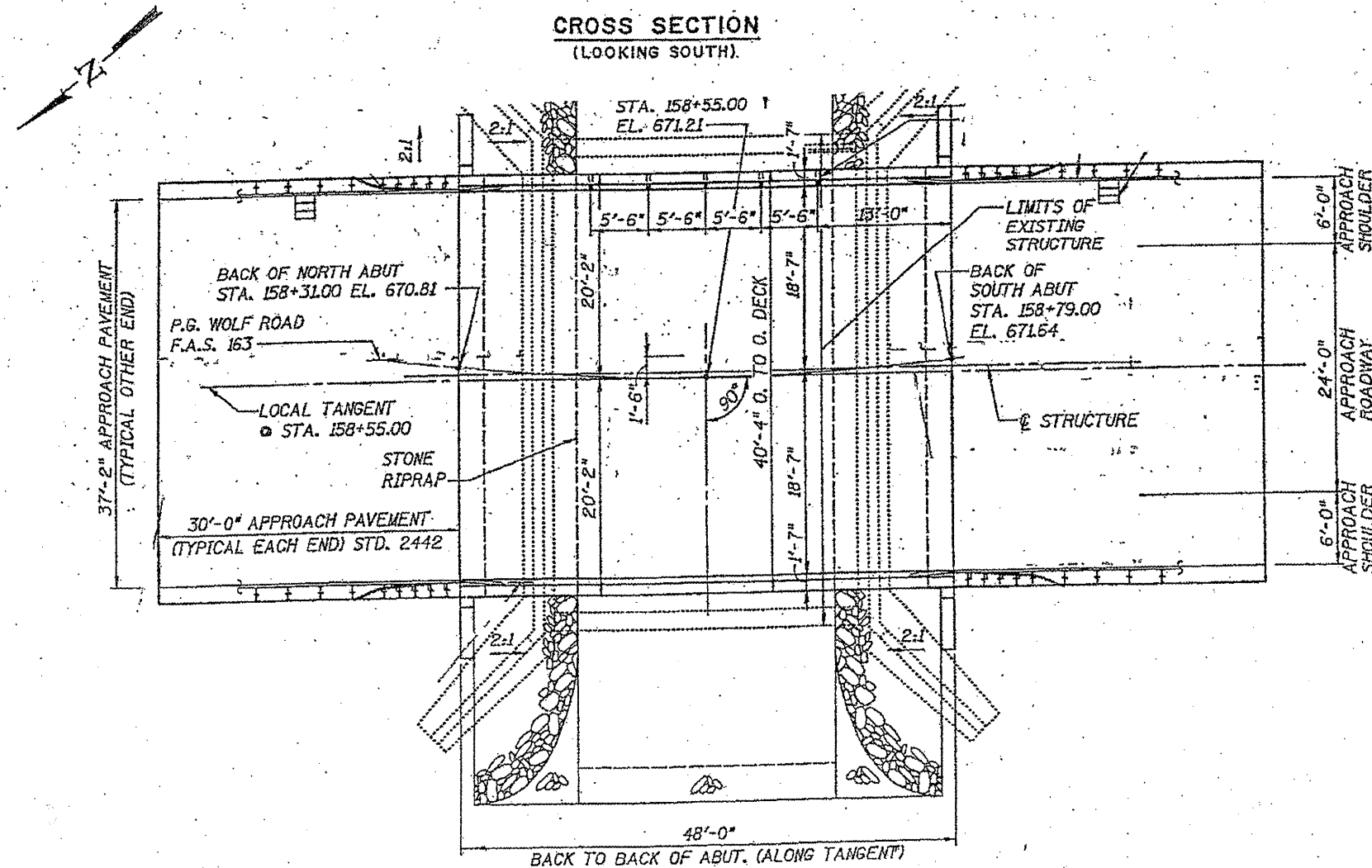

FOR INFORMATION ONLY

ILLINOIS DEPARTMENT OF
TRANSPORTATION

EXISTING PLANS
LOCATION 6 (SN 099-0315)

ROUTE VARIOUS	SECTION 2011-216-I	COUNTY VARIOUS	TOTAL SHEETS 28	SHEET NUMBER 19
------------------	-----------------------	-------------------	-----------------------	-----------------------

CONTRACT NO. 60R56

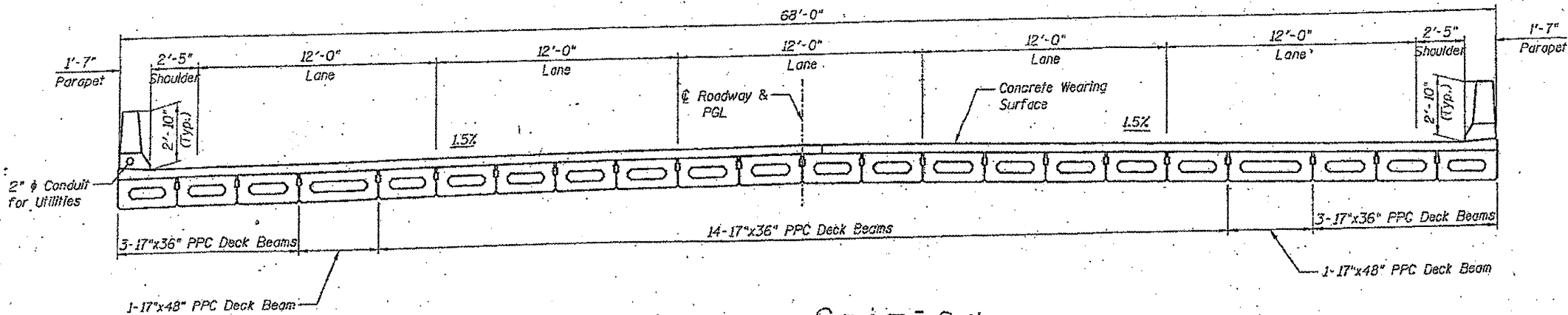

CROSS SECTION
LOOKING North



FOR INFORMATION ONLY

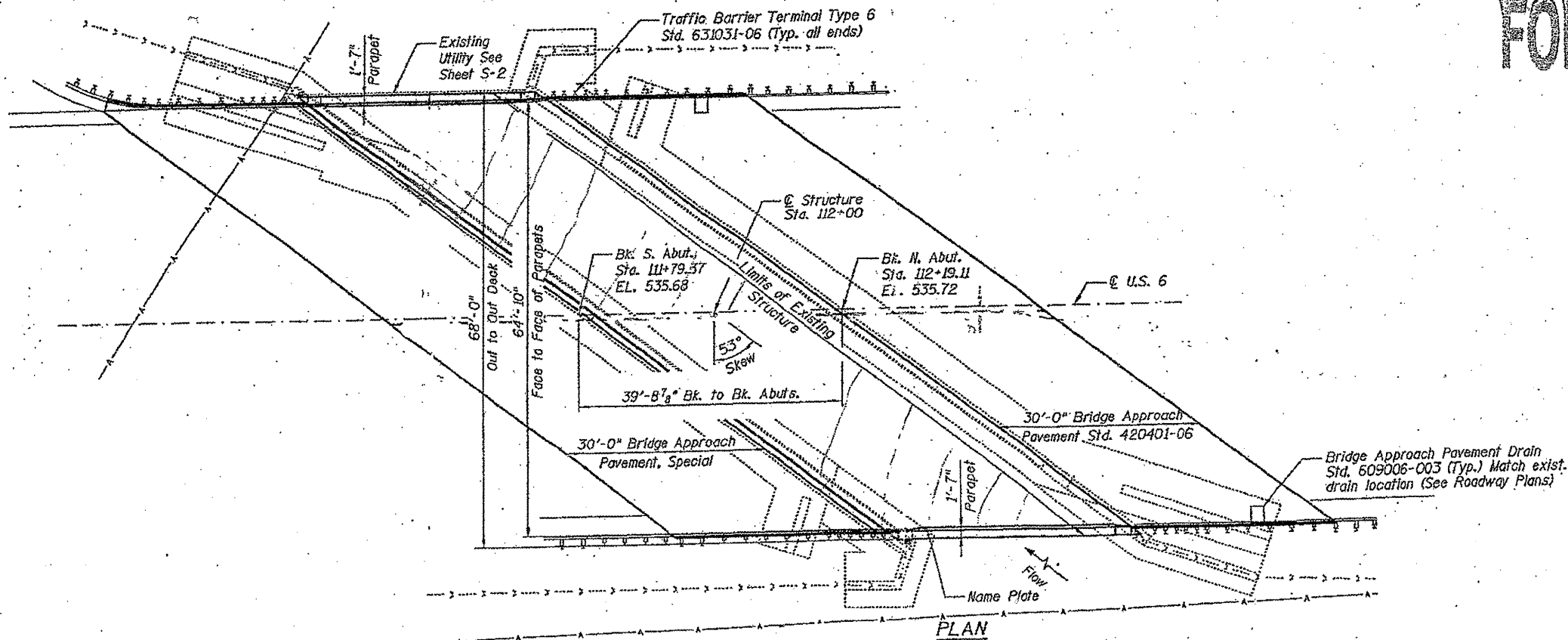

PLAN

ILLINOIS DEPARTMENT OF
TRANSPORTATION

EXISTING PLANS
LOCATION 7 (SN 099-0098)

ROUTE	SECTION	COUNTY	TOTAL SHEETS	SHEET NUMBER
VARIOUS	2011-216-I	VARIOUS	28	20

CONTRACT NO. 60R56

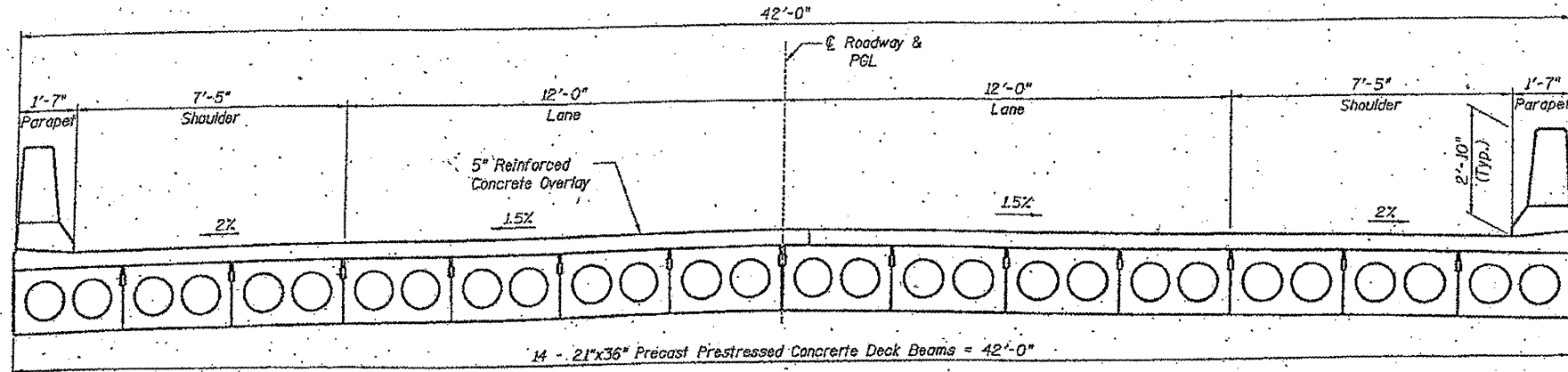

CROSS SECTION
Looking North

FOR INFORMATION ONLY

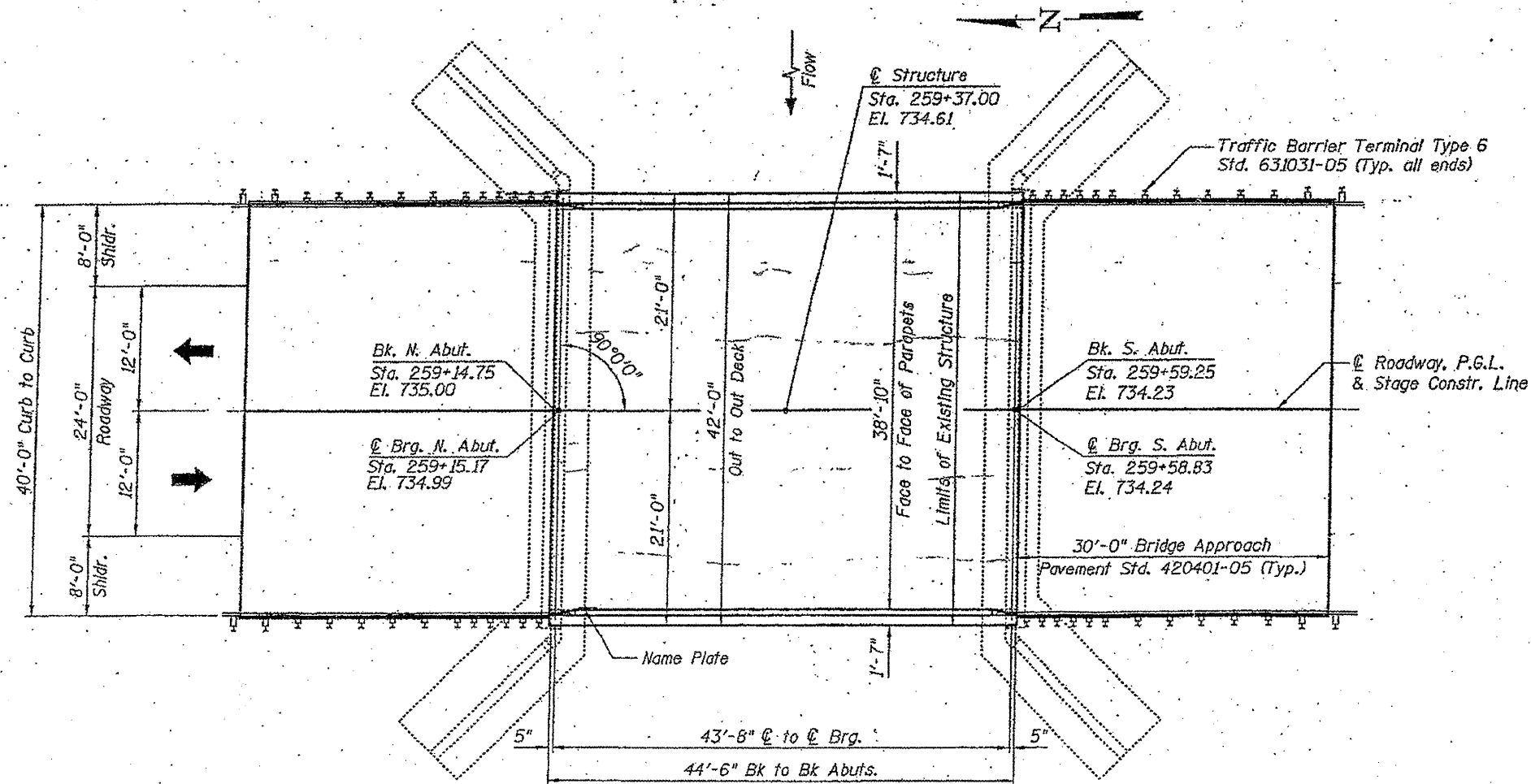

PLAN

ILLINOIS DEPARTMENT OF
TRANSPORTATION

EXISTING PLANS
LOCATION 8 (SN 099-0118)

ROUTE	SECTION	COUNTY	TOTAL SHEETS	SHEET NUMBER
VARIOUS	2011-216-1	VARIOUS	28	21

CONTRACT NO. 60R56

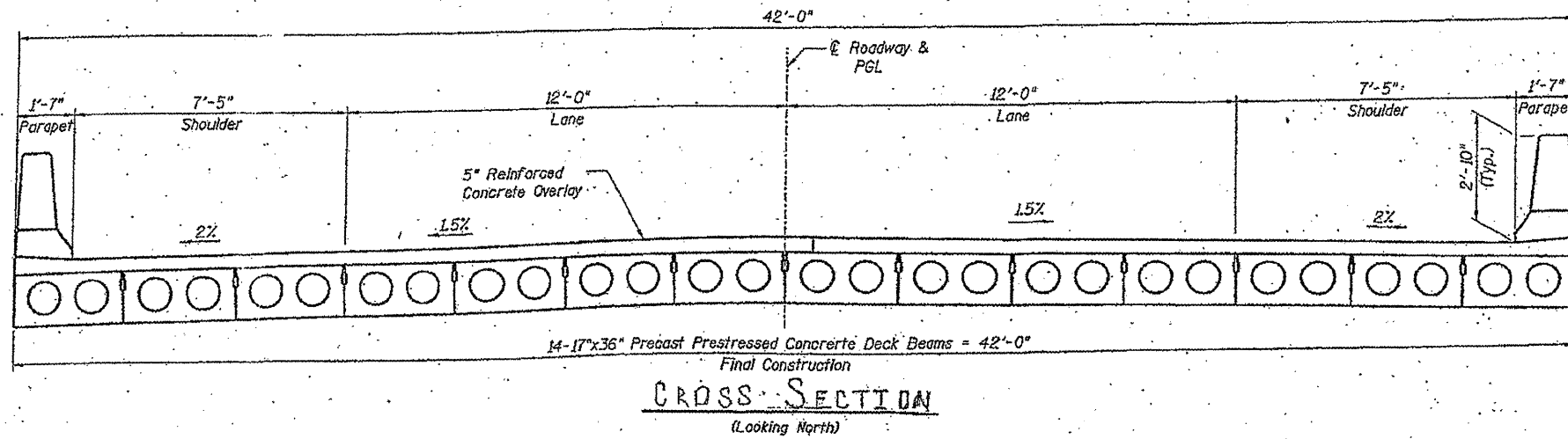

FOR INFORMATION ONLY

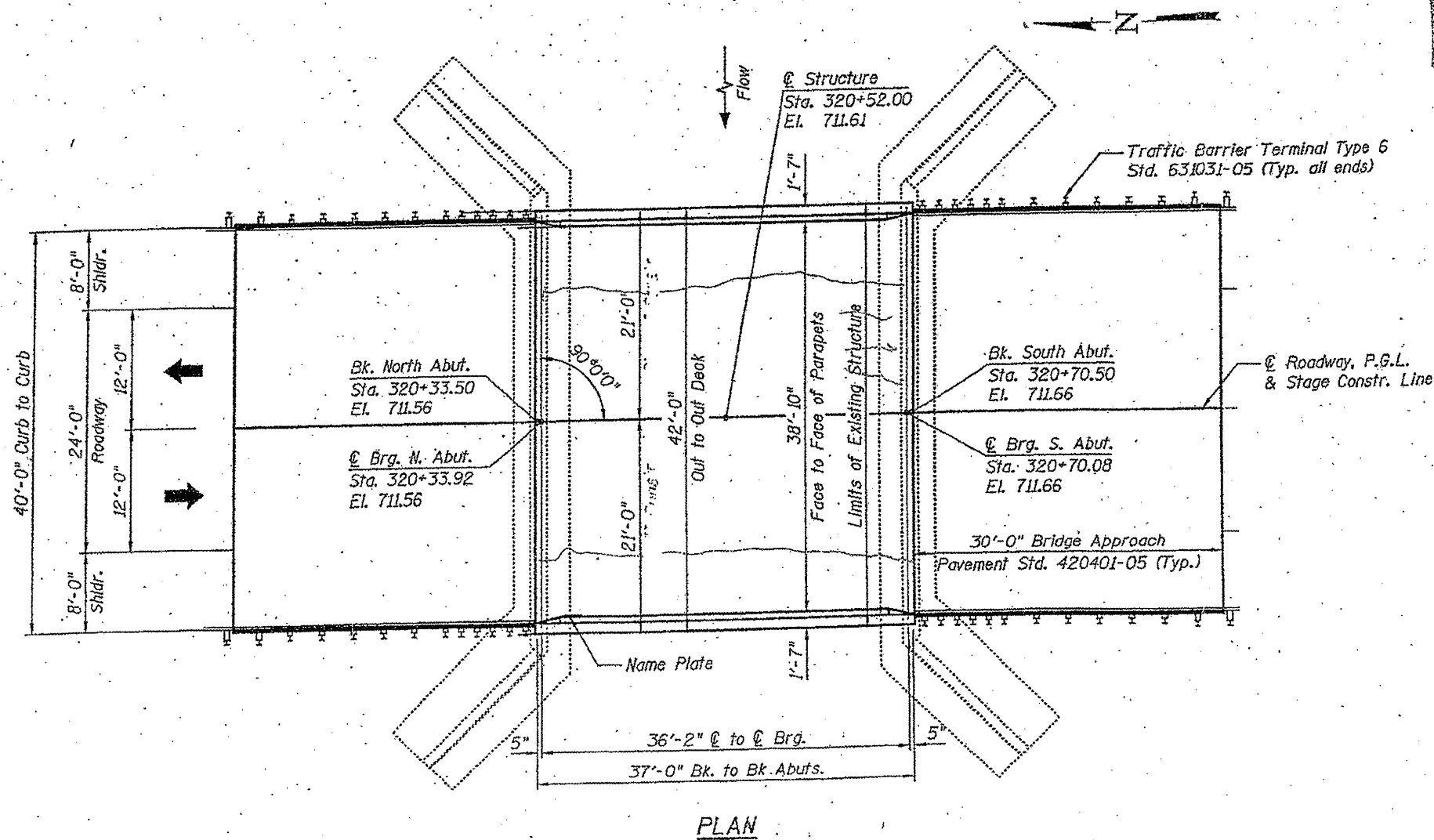

ILLINOIS DEPARTMENT OF
TRANSPORTATION

EXISTING PLANS
LOCATION 9 (SN 099-0119)

ROUTE VARIOUS	SECTION 2011-216-I	COUNTY VARIOUS	TOTAL SHEETS 28	SHEET NUMBER 22
------------------	-----------------------	-------------------	--------------------	--------------------

CONTRACT NO. 60R56

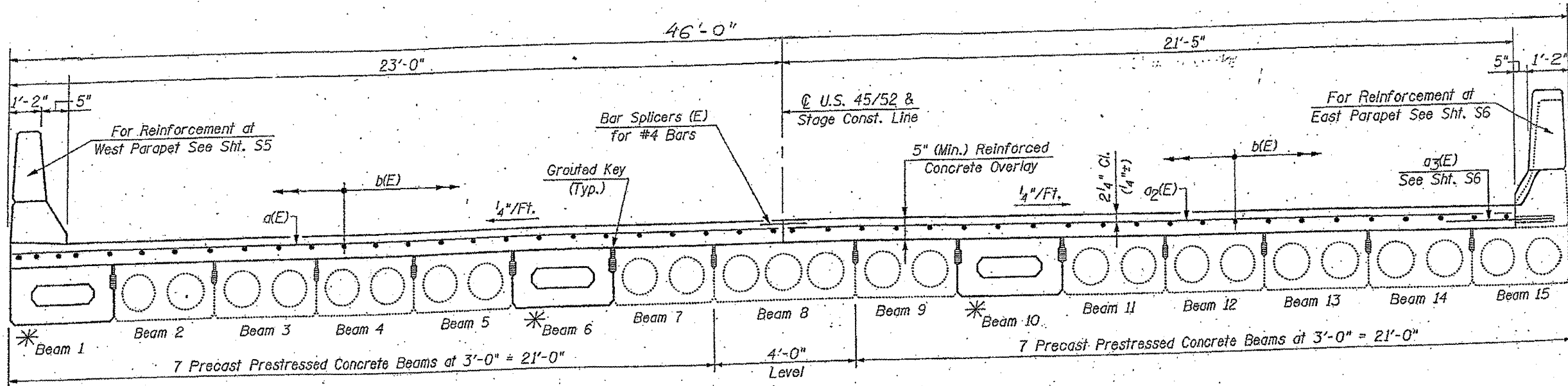

DECK CROSS SECTION
(Looking North)

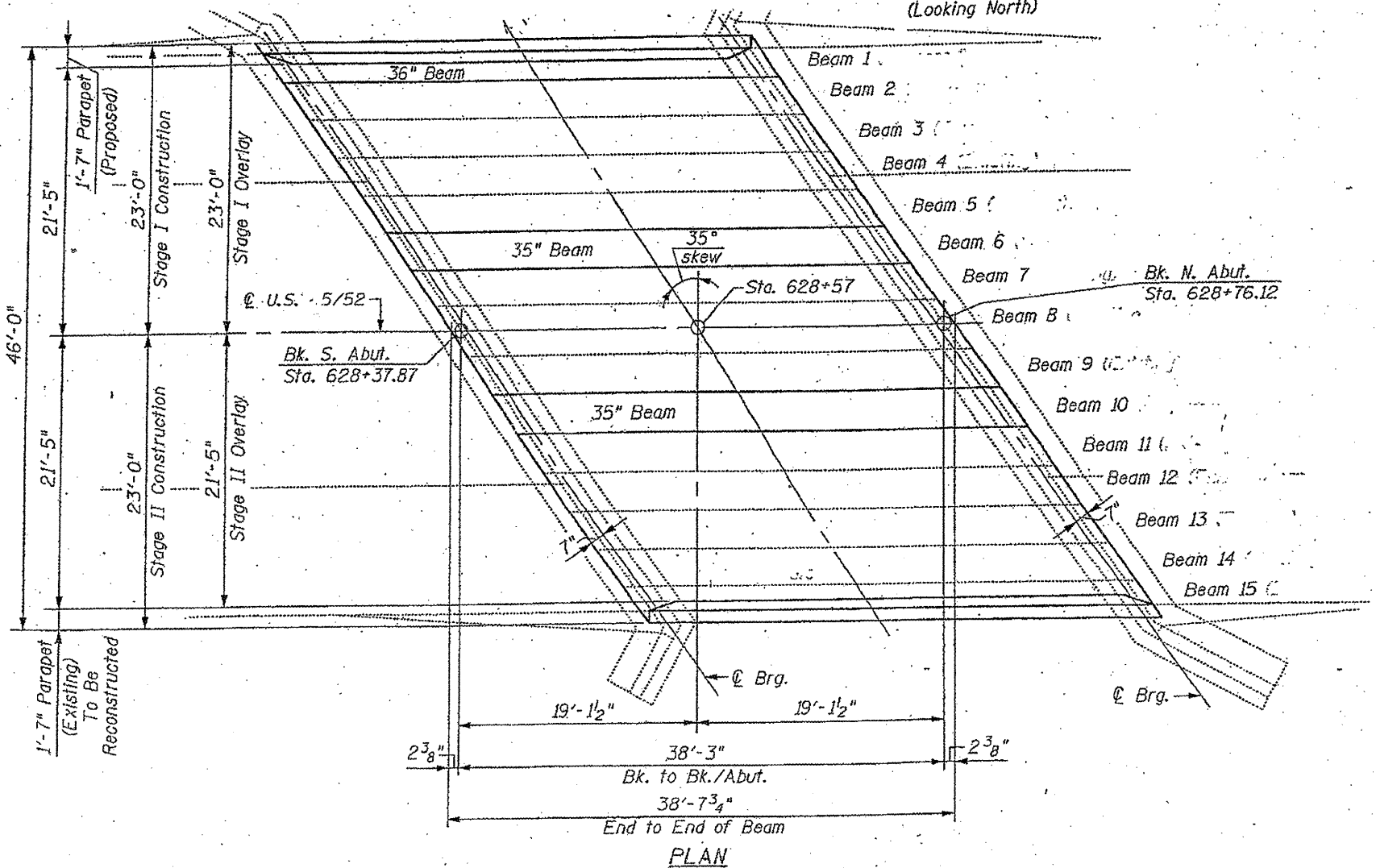

PLAN

FOR INFORMATION ONLY

ILLINOIS DEPARTMENT OF
TRANSPORTATION

EXISTING PLANS
LOCATION 10 (SN 099-0122)

ROUTE	SECTION	COUNTY	TOTAL SHEETS	SHEET NUMBER
VARIOUS	2011-216-1	VARIOUS	28	23

CONTRACT NO. 60R56

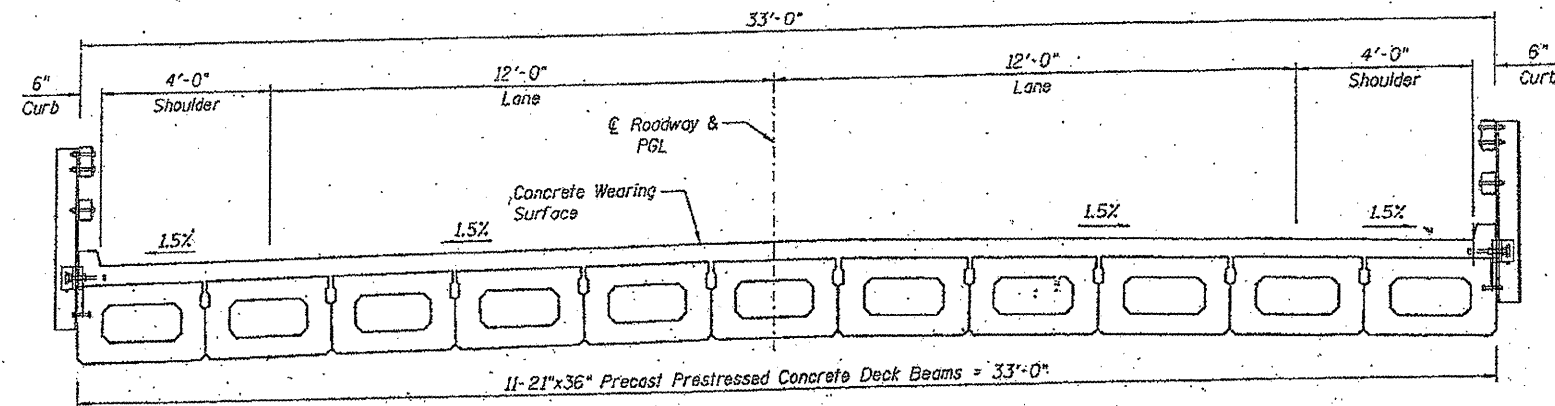

CROSS SECTION
(Looking North)

FOR INFORMATION ONLY

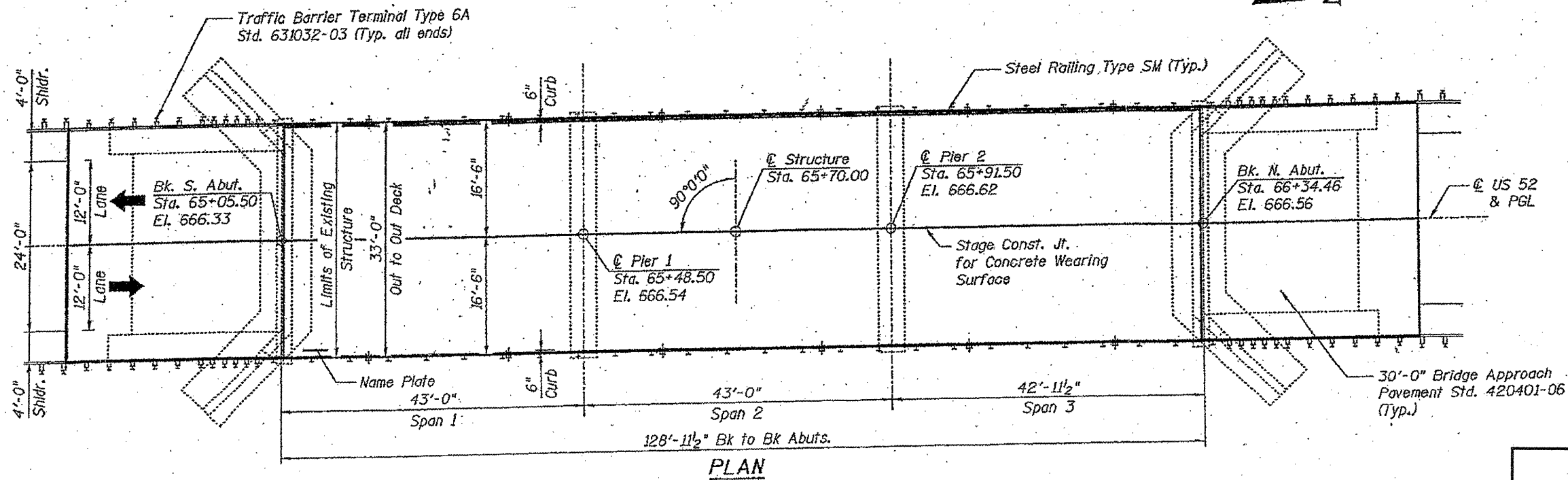

PLAN

ILLINOIS DEPARTMENT OF
TRANSPORTATION

EXISTING PLANS
LOCATION 11 (SN 099-0133)

ROUTE	SECTION	COUNTY	TOTAL SHEETS	SHEET NUMBER
VARIOUS	2011-216-1	VARIOUS	28	24

CONTRACT NO. 60R56

FOR INFORMATION ONLY

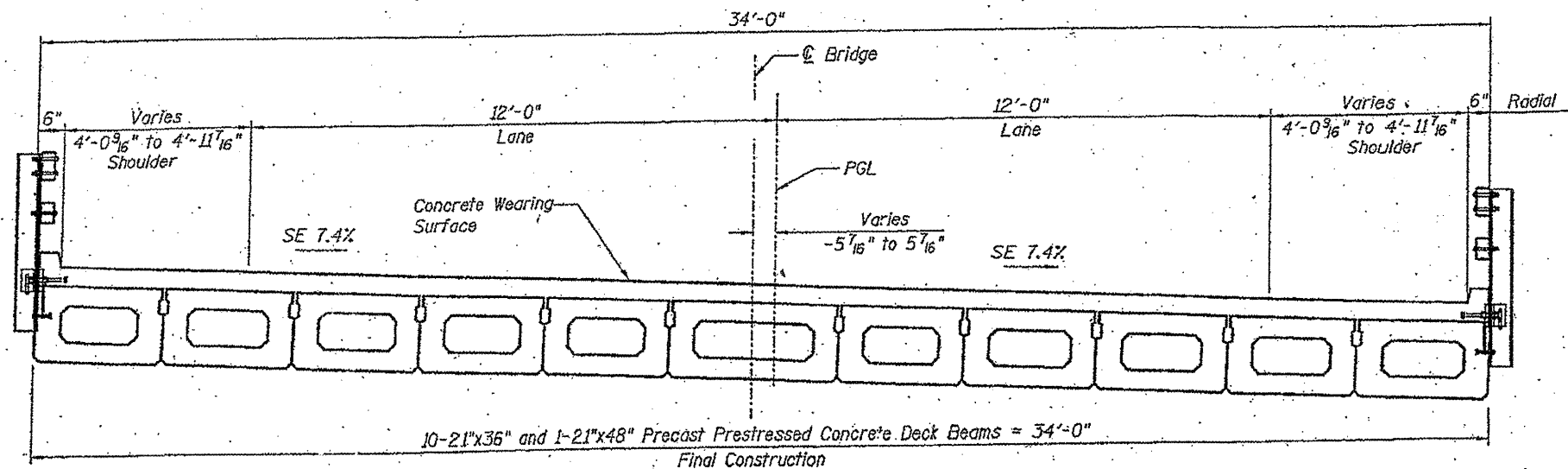

CROSS SECTION
(Looking North)

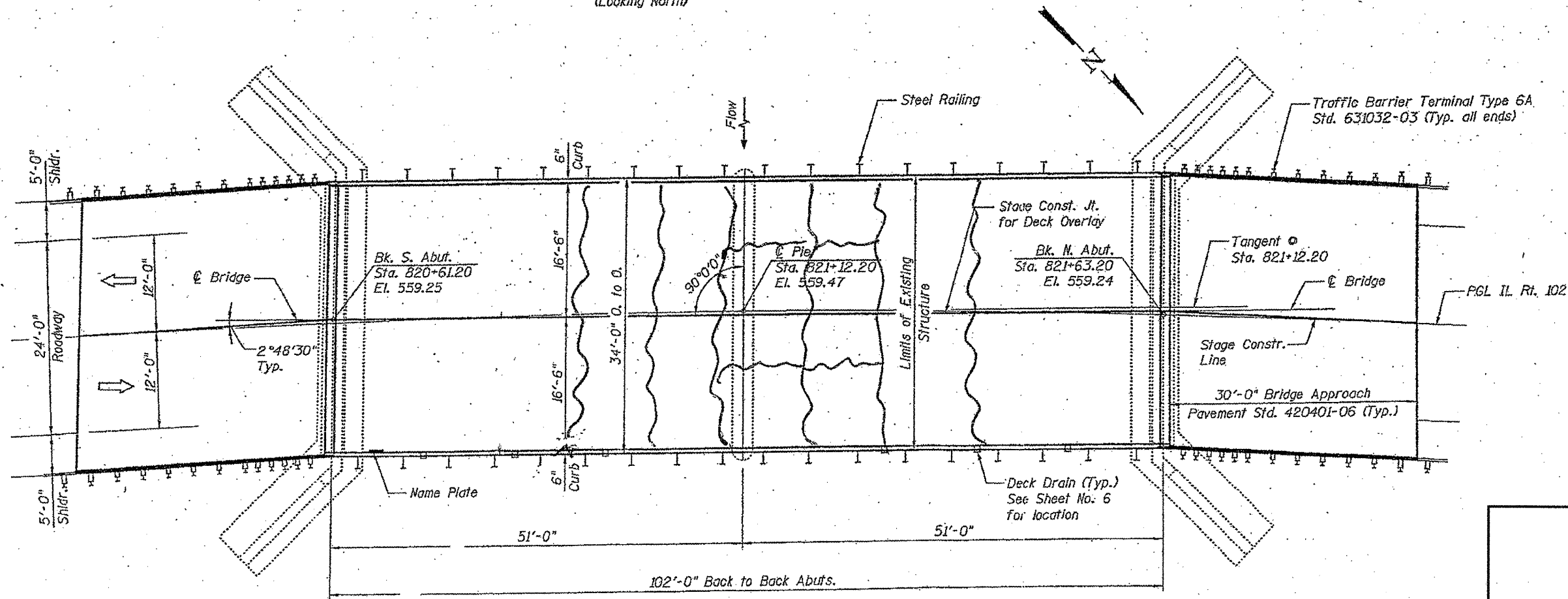

PLAN

**ILLINOIS DEPARTMENT OF
TRANSPORTATION**

**EXISTING PLANS
LOCATION 12 (SN 099-0169)**

ROUTE	SECTION	COUNTY	TOTAL SHEETS	SHEET NUMBER
VARIOUS	2011-216-1	VARIOUS	25	25

CONTRACT NO. 60R56

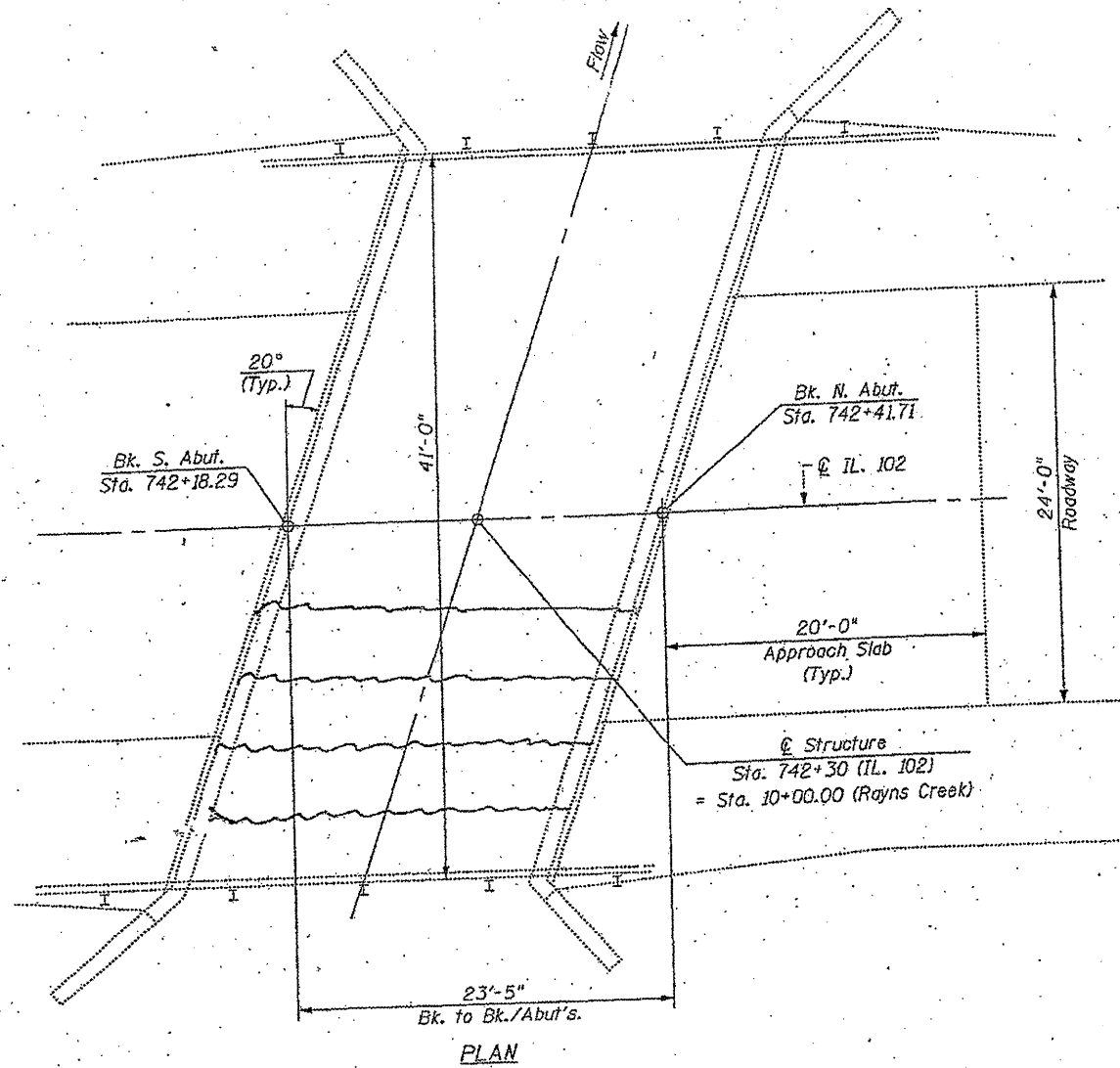

FOR INFORMATION ONLY

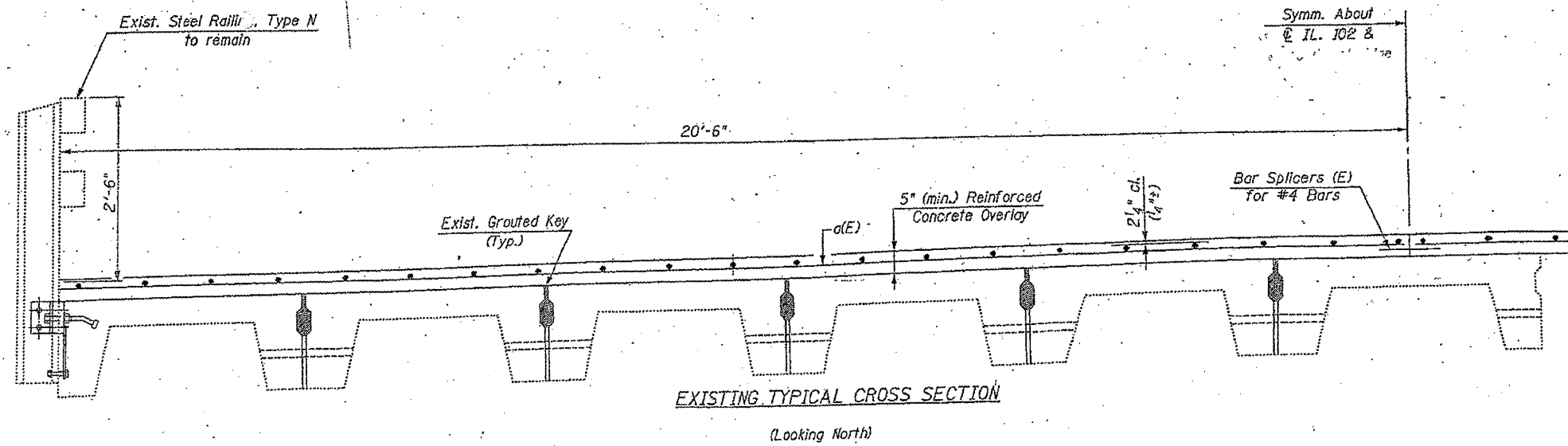

ILLINOIS DEPARTMENT OF
TRANSPORTATION

EXISTING PLANS
LOCATION 13 (SN 099-0170)

ROUTE VARIOUS	SECTION 2011-216-I	COUNTY VARIOUS	TOTAL SHEETS 28	SHEET NUMBER 26
------------------	-----------------------	-------------------	--------------------	--------------------

CONTRACT NO. 60R56

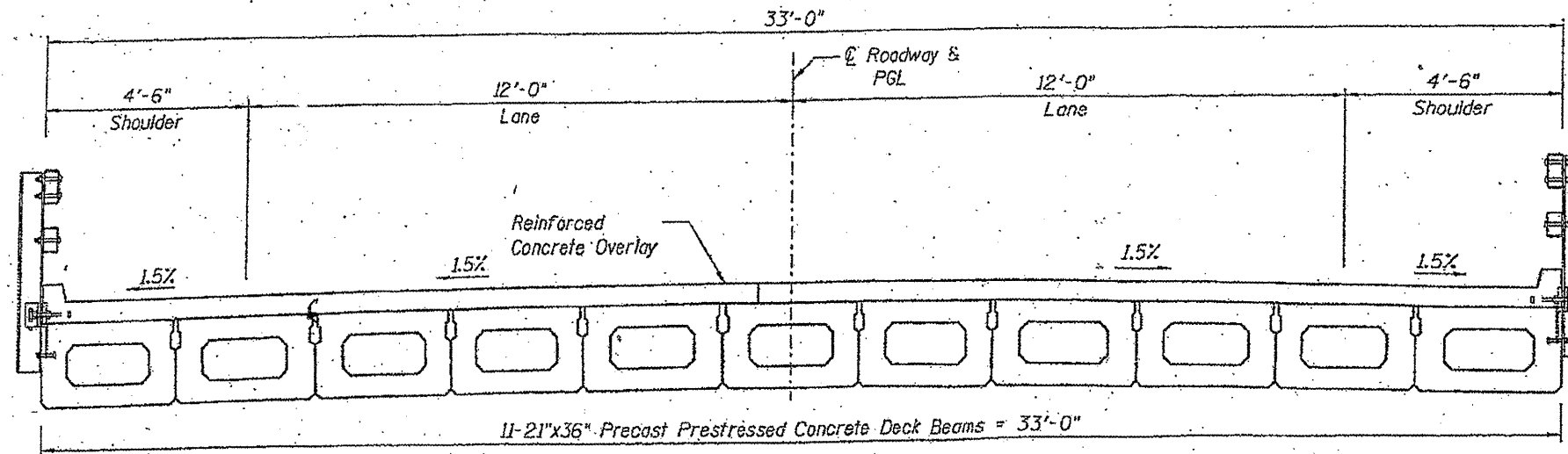

CROSS SECTION
(Looking West)

FOR INFORMATION ONLY

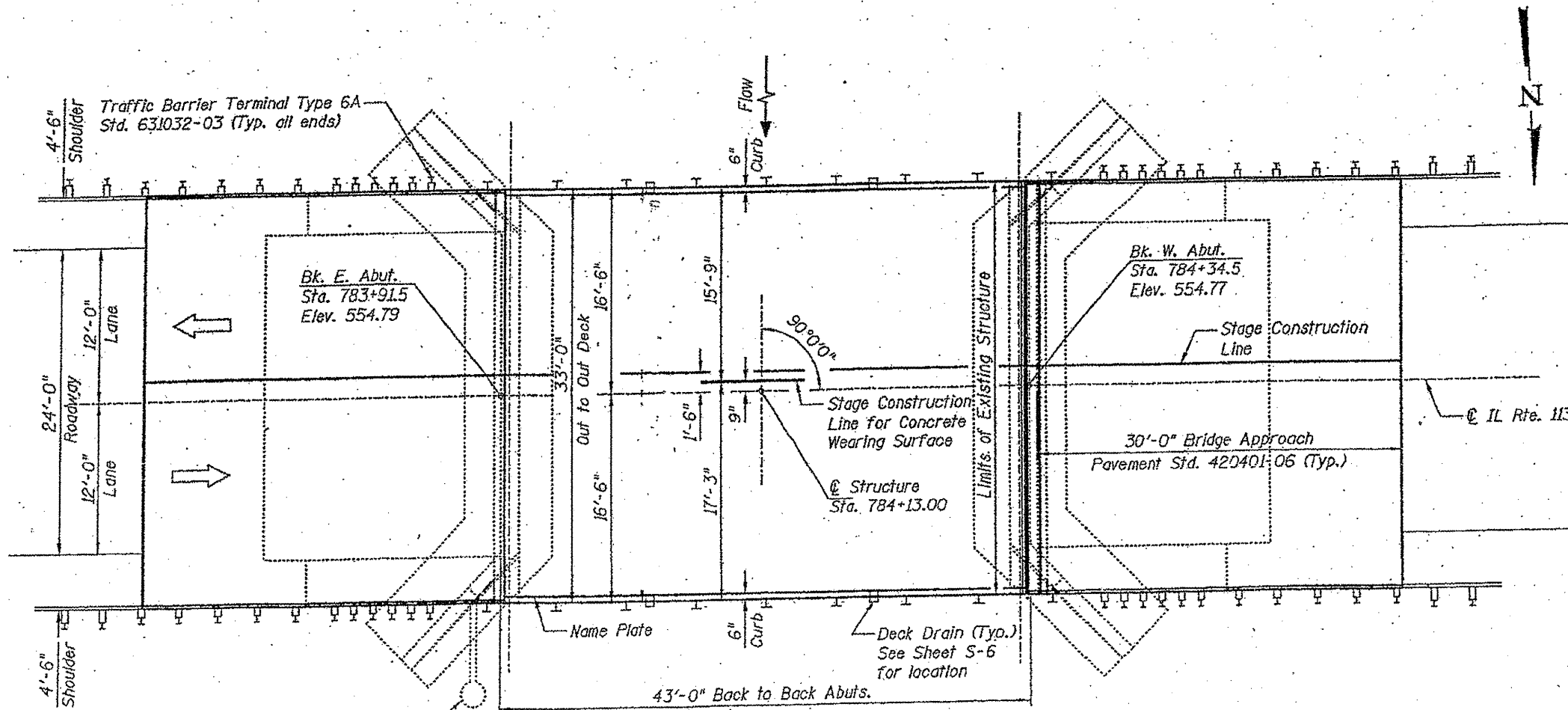

**ILLINOIS DEPARTMENT OF
TRANSPORTATION**

**EXISTING PLANS
LOCATION 14 (SN 099-0172)**

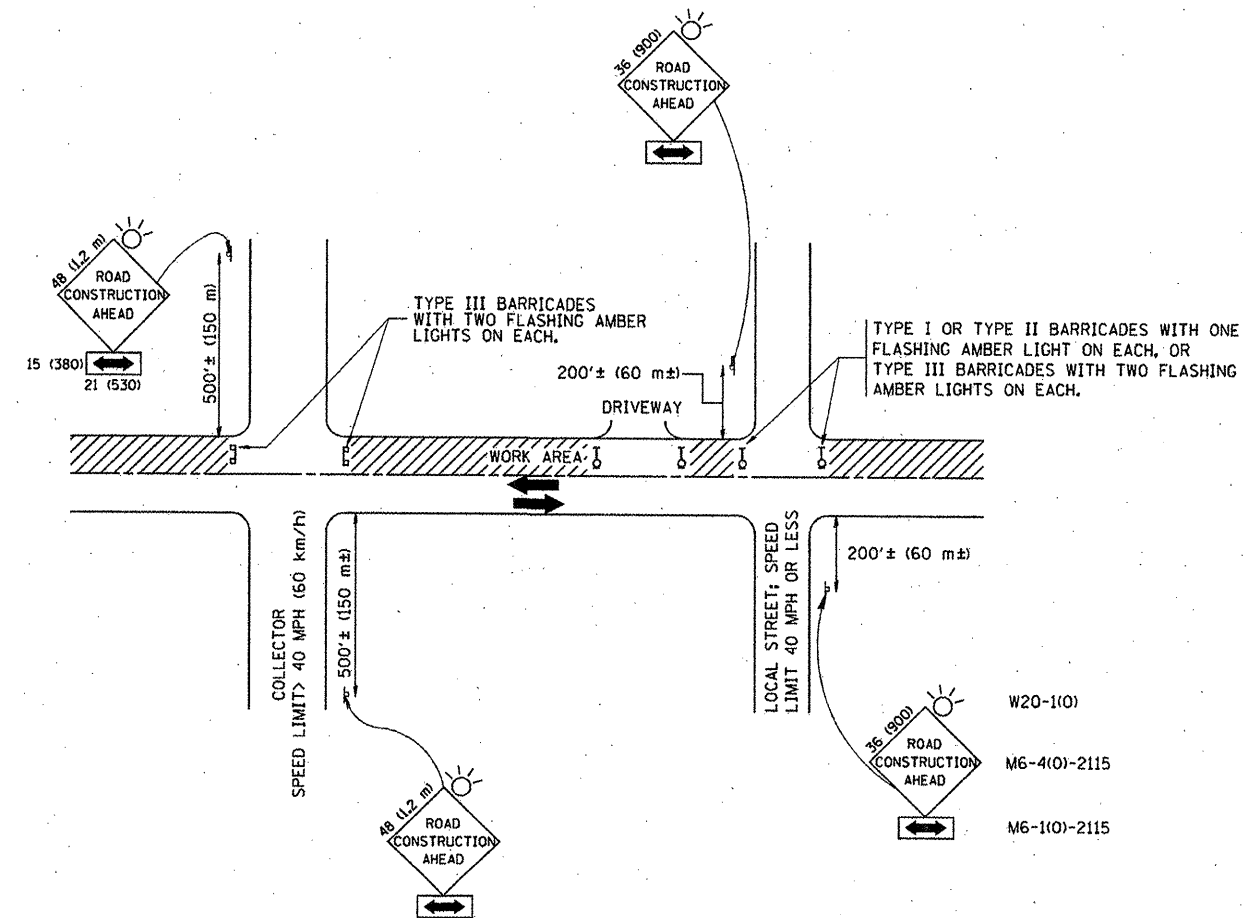

TRAFFIC CONTROL AND PROTECTION FOR SIDE ROADS, INTERSECTIONS, AND DRIVEWAYS

NOTES:

- A. FOR NO LANE RESTRICTION ON THE SIDE ROAD OR DRIVEWAYS
- SIDE ROAD WITH A SPEED LIMIT OF 40 MPH (60 km/h) OR LESS AS SHOWN ON THE DRAWING AND AS DIRECTED BY THE ENGINEER:
 - ONE **ROAD CONSTRUCTION AHEAD** SIGN 36 x 36 (900x900) WITH A FLASHER AND FLAG MOUNTED ON IT APPROXIMATELY 200' (60 m) IN ADVANCE OF THE MAIN ROUTE.
 - THE CLOSED PORTION OF THE MAIN ROUTE SHALL BE PROTECTED BY BLOCKING WITH TYPE I, TYPE II OR TYPE III BARRICADES, 1/3 OF THE CROSS SECTION OF THE CLOSED PORTION.
 - SIDE ROAD WITH A SPEED LIMIT GREATER THAN 40 MPH (60 km/h) AS SHOWN ON THE DRAWING AND AS DIRECTED BY THE ENGINEER:
 - ONE **ROAD CONSTRUCTION AHEAD** SIGN 48 x 48 (1.2 m x 1.2 m) WITH A FLASHER MOUNTED ON IT APPROXIMATELY 500' (150 m) IN ADVANCE OF THE MAIN ROUTE.
 - THE CLOSED PORTION OF THE MAIN ROUTE SHALL BE PROTECTED BY BLOCKING WITH TYPE III BARRICADES, 1/2 OF THE CROSS SECTION OF THE CLOSED PORTION.
3. WHEN THE SIDE ROAD LIES BETWEEN THE BEGINNING OF THE MAINLINE SIGNING AND THE WORK ZONE, A SINGLE HEADED ARROW (M6-1) SHALL BE USED IN LIEU OF THE DOUBLE HEADED ARROW (M6-4).
- B. FOR A LANE CLOSURE ON A SIDE ROAD OR DRIVEWAY:
- USE APPLICABLE PORTIONS OF THE TYPICAL APPLICATION OF TRAFFIC CONTROL DEVICES (STD. 701501, STD. 701606 OR THE APPROPRIATE STANDARD). THE SPACING OF SIGNS AND BARRICADES SHALL BE ADJUSTED FOR FIELD CONDITIONS AS DIRECTED BY THE ENGINEER. THE DIRECTIONAL ARROW SHALL BE COVERED OR REMOVED WHEN NO LONGER CONSISTENT WITH THE SIDE ROAD LANE CLOSURE.
- C. ADVANCE WARNING SIGNS ARE TO BE OMITTED ON DRIVEWAY UNLESS OTHERWISE NOTED.
- D. THE TRAFFIC CONTROL AND PROTECTION FOR SIDE ROADS, INTERSECTIONS, AND DRIVEWAYS SHALL BE INCIDENTAL TO THE COST OF SPECIFIED TRAFFIC CONTROL STANDARDS OR ITEMS.

All dimensions are in millimeters (inches) unless otherwise shown.

FILE NAME = W:\dststd\22x34\tc18.dgn	USER NAME = geglennob	DESIGNED - LHA	REVISED - J. OBERLE 10-18-95
		DRAWN -	REVISED - A. HOUSEH 03-06-96
		CHECKED -	REVISED - A. HOUSEH 10-15-96
		DATE - 06-89	REVISED - T. RAMMACHER 01-06-00

STATE OF ILLINOIS
DEPARTMENT OF TRANSPORTATION

TRAFFIC CONTROL AND PROTECTION FOR
SIDE ROADS, INTERSECTIONS, AND DRIVEWAYS

SCALE: NONE SHEET NO. 1 OF 1 SHEETS STA. TO STA.

F.A. RTE.	SECTION	COUNTY	TOTAL SHEETS	SHEET NO.
VQR	201-216-1	VQR	28	27
TC-10			CONTRACT NO. 60RS7	
FED. ROAD DIST. NO. 1 ILLINOIS FED. AID PROJECT				

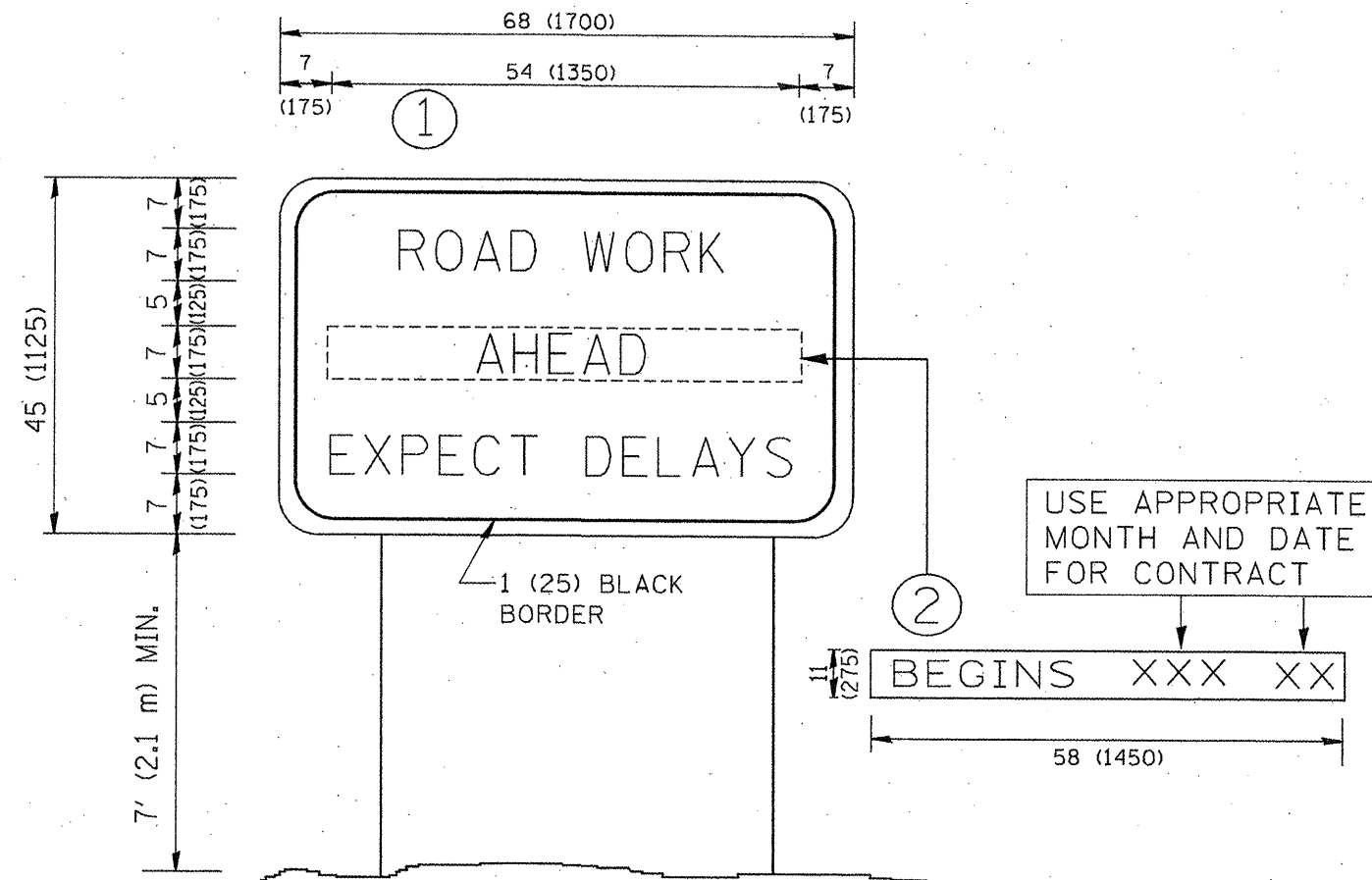

NOTES:

1. USE BLACK LETTERING ON ORANGE BACKGROUND.
2. ERECT SIGNS IN ADVANCE OF THE LOCATION FOR THE "ROAD CONSTRUCTION AHEAD" SIGN AT LOCATIONS AS DIRECTED BY THE ENGINEER.
3. ERECT SIGN ① WITH INSTALLED PANEL ② ONE WEEK PRIOR TO THE START OF CONSTRUCTION.
4. REMOVE PANEL ② SOON AFTER THE START OF CONSTRUCTION.
5. SEE SPECIAL PROVISION FOR "TEMPORARY INFORMATION SIGNING" FOR ADDITIONAL INFORMATION.
6. ONE SIGN ASSEMBLY EQUALS 25.70 SQ. FT. (2.3 SQ. M.)
7. SHALL BE PAID FOR AS TEMPORARY INFORMATION SIGNING.

ALL DIMENSIONS ARE IN INCHES (MILLIMETERS) UNLESS OTHERWISE SHOWN.

FILE NAME = W:\dststd\22x34\to22.dgn	USER NAME = gaglionobt	DESIGNED -	REVISED - R. MIRS 09-15-97
		DRAWN -	REVISED - R. MIRS 12-11-97
	PLOT SCALE = 50,000 / IN.	CHECKED -	REVISED - T. RAMMACHER 02-02-99
	PLOT DATE = 1/4/2008	DATE -	REVISED - C. JUCIUS 01-31-07

**STATE OF ILLINOIS
DEPARTMENT OF TRANSPORTATION**

**ARTERIAL ROAD
INFORMATION SIGN**

SCALE: NONE SHEET NO. 1 OF 1 SHEETS STA. TO STA.

F.A. RTE.	SECTION	COUNTY	TOTAL SHEETS	SHEET NO.
VAR	2011-216-1	VAR	28	26
TC-22			CONTRACT NO. 60R57	
FED. ROAD DIST. NO. 1 ILLINOIS FED. AID PROJECT				