

N:\PROJECTS\0003377\_000\0003377\_000\Design\Structural\CAD\016-2818 11 Bridge Approach Slab Details 1of2.dgn

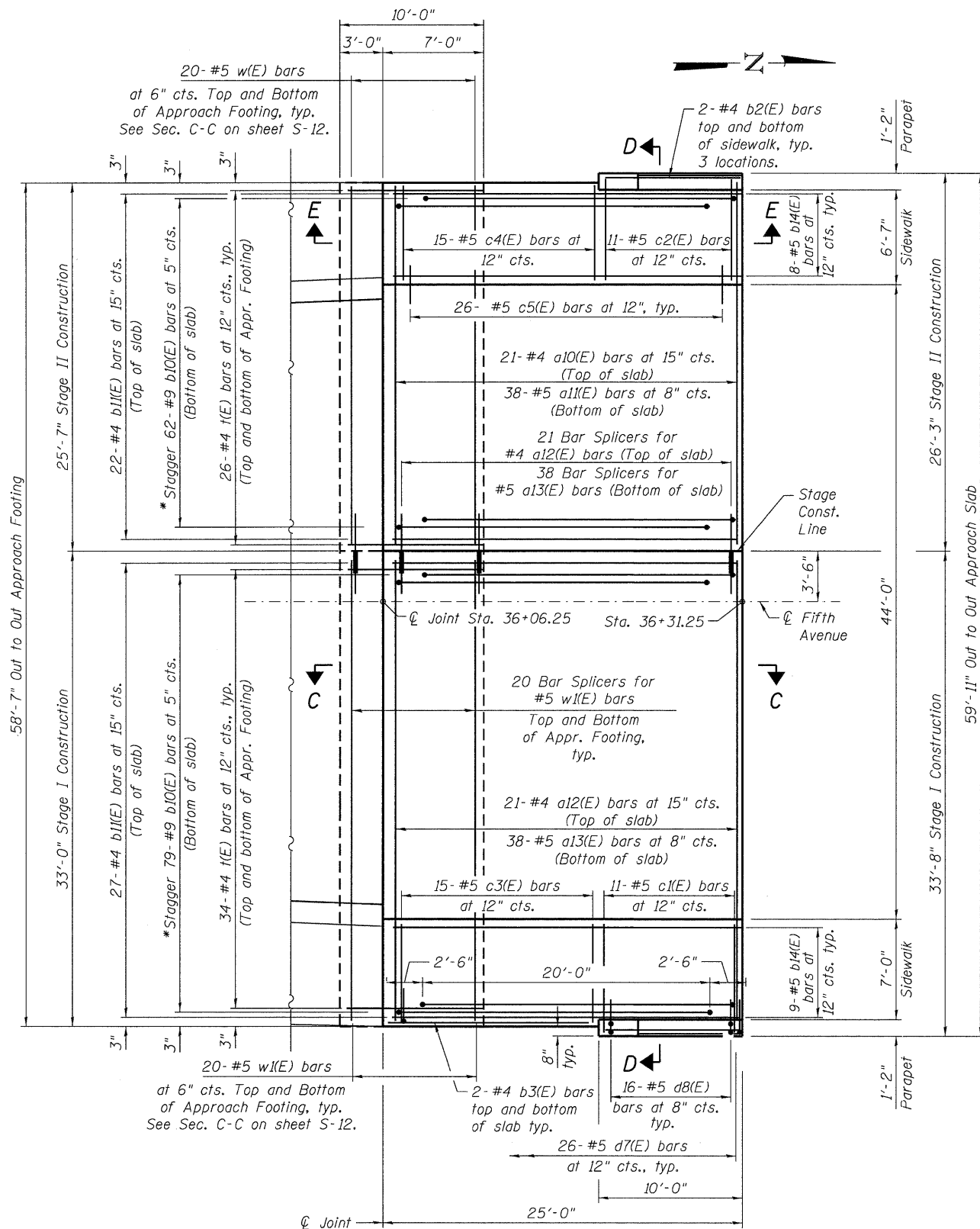

**SOUTH APPROACH PLAN**

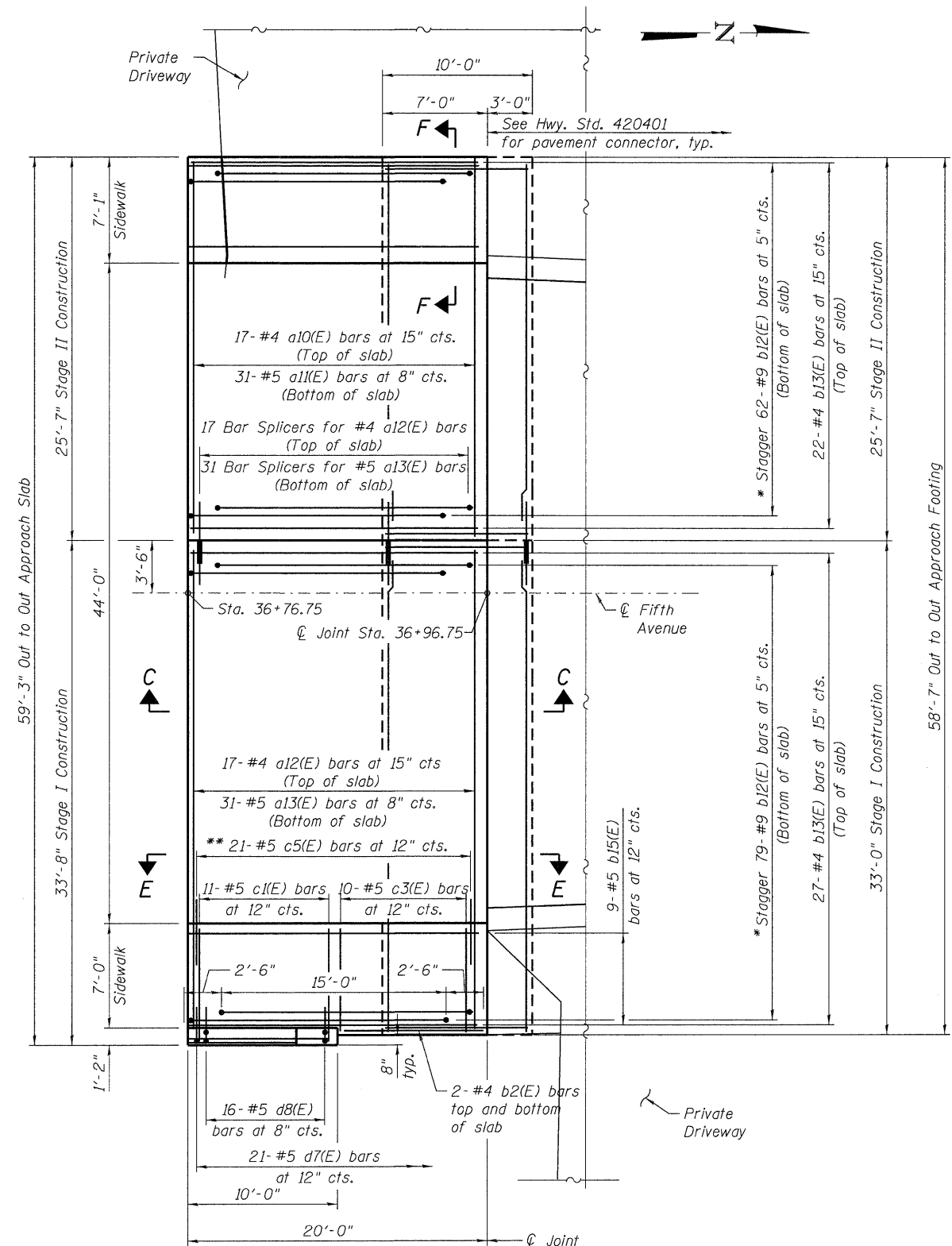

**NORTH APPROACH PLAN**

\* Tilt #9 b10(E) and b12(E) bars as required to maintain clearance.  
 \*\* Adjust c5(E) bars at North end of approach to allow for sidewalk transition.

**NOTE**

Sections C-C, D-D, E-E, and F-F shown on sheet S-12.



USER NAME = rdanley	DESIGNED BWS	REVISED -
PLOT SCALE = 5/8" = 1' - 0"	CHECKED LVH	REVISED -
PLOT DATE = 10/26/2011	DRAWN RD	REVISED -
	CHECKED AMK	REVISED -

**STATE OF ILLINOIS  
DEPARTMENT OF TRANSPORTATION**

**BRIDGE APPROACH SLAB DETAILS 1  
STRUCTURE NO. 016-2818**

SHEET NO. 5-11 OF 5-17 SHEETS

F.A.U. RTE. 2742	SECTION 3222-W-BR	COUNTY COOK	TOTAL SHEETS 51	SHEET NO. 36
CONTRACT NO. 62116			ILLINOIS FED. AID PROJECT	