

**DETOUR GENERAL NOTES:**

1. THE ENGINEER SHALL BE NOTIFIED IN WRITING AT LEAST THREE WEEKS PRIOR TO THE DAY THE DETOUR IS TO BE IN EFFECT. THE CONTRACTOR SHALL CONTACT THE APPROPRIATE LOCAL AGENCIES AND INTERESTED PARTIES.
2. ALL SIGNING SHALL BE IN ACCORDANCE WITH THE APPLICABLE PROVISIONS OF THE STANDARD SPECIFICATIONS, THE DETAILS IN THESE PLANS, THE LATEST EDITION OF THE STATE OF ILLINOIS "MANUAL ON UNIFORM TRAFFIC CONTROL DEVICES," AND AS DIRECTED BY THE ENGINEER.
3. THE SIZES OF ALL SIGNS NOT SPECIFIED IN THESE PLANS SHALL BE AS REQUIRED BY THE ILLINOIS "MANUAL ON UNIFORM TRAFFIC CONTROL DEVICES".
4. ADDITIONAL SIGNING AND/OR BARRICADES DEEMED NECESSARY BY THE ENGINEER SHALL BE PROVIDED AND INSTALLED AT NO ADDITIONAL COST.
5. THE CONTRACTOR SHALL PROVIDE THE ENGINEER WITH THE NAMES AND PHONE NUMBERS OF HIS REPRESENTATIVES ON THE CONSTRUCTION SITE, AND HIS REPRESENTATIVE RESPONSIBLE FOR THE DETOUR SIGNING, PRIOR TO THE START OF WORK.
6. THE CONTRACTOR SHALL BE RESPONSIBLE FOR THE FIELD LOCATION OF ALL DETOUR AND CONSTRUCTION SIGNING. THE CONTRACTOR MAY REQUEST THE ENGINEER TO FIELD VERIFY THE POSITIONING OF ANY SIGNS.
7. ACTUAL LOCATIONS FOR THE SIGNING SHOWN ON THE DETOUR PLAN MAY BE ADJUSTED TO FIT FIELD CONDITIONS.
8. ALL EXISTING SIGNING THAT IS NOT APPLICABLE WHILE THE DETOUR IS IN EFFECT SHALL BE COMPLETELY COVERED BY THE CONTRACTOR IN A MANNER MEETING THE APPROVAL OF THE ENGINEER.
9. ALL DETOUR SIGNING SHALL BE POST MOUNTED.
10. ALL DETOUR SIGNING EXCEPT REGULATORY SIGNS SHALL HAVE BLACK LEGENDS ON FLUORESCENT ORANGE SHEETING AND STANDARD BLACK BORDERS. THE FLUORESCENT ORANGE REFLECTIVE SHEETING SHALL MEET THE REQUIREMENTS OF ARTICLE 1106.01 OF THE STANDARD SPECIFICATIONS. ALL DETOUR SIGNING SHALL BE NEW OR IN LIKE-NEW CONDITION. THE ENGINEER SHALL BE THE SOLE JUDGE OF THE CONDITION OF THE SIGNS.
11. THE ROAD NAME SIGN SHALL BE A BLACK LEGEND ON ORANGE REFLECTIVE SHEETING. THE SIGN BLANK SHALL BE VARIABLE WITH DESIGN SERIES C LETTERS. THE CAPITAL LETTERS SHALL BE 6".
12. AT A MINIMUM, ALL AMBER FLASHING LIGHTS THAT ARE REQUIRED FOR THE DETOUR SIGNING SHALL MEET THE REQUIREMENTS FOR TYPE A-LOW INTENSITY FLASHING LIGHTS IN ARTICLE 1106.02 OF THE STANDARD SPECIFICATIONS. ALL LIGHTS SHALL OPERATE DURING HOURS OF DARKNESS. ONLY LIGHTS THAT HAVE BEEN ROVED BY THE ILLINOIS DEPARTMENT OF TRANSPORTATION SHALL BE USED.
13. THE CONTRACTOR SHALL BE RESPONSIBLE FOR ENSURING THAT ALL BARRICADES, SIGNS, LIGHTS AND OTHER DEVICES INSTALLED BY HIM ARE IN PLACE AND OPERATING 24 HOURS EACH DAY, INCLUDING SUNDAYS AND HOLIDAYS.
14. THE "ROAD CLOSED" (R11-2 & R11-4) SIGNS SHALL BE MOUNTED ON THE TYPE III BARRICADES. ALL TYPE III BARRICADES SHALL HAVE 2 AMBER TYPE A-LOW INTENSITY FLASHING LIGHTS SPACED NEAR THE CENTERLINES OF THE SUPPORTS.
15. THE TYPE III BARRICADES USED AT POINTS OF CLOSURE TO THRU TRAFFIC ONLY SHALL NOT EXCEED 8 FEET IN WIDTH EACH FOR A SINGLE APPROACH LANE. ALL BARRICADES AT THESE LOCATIONS SHALL HAVE REFLECTORIZED STRIPING ON THE BACK SIDES OF THE BARRICADES.
16. CONSTRUCTION EQUIPMENT SHALL NOT BE PARKED IMMEDIATELY BEHIND THE TYPE III BARRICADES DURING NON-WORKING HOURS. IN ANY EVENT, ARTICLE 701.11 OF THE STANDARD SPECIFICATIONS SHALL APPLY.
17. DURING NON-WORKING HOURS THE CONTRACTOR SHALL PROVIDE A MEANS TO RESTRAIN THE TYPE III BARRICADES FROM EASY MOVEMENT BY VANDALS. THE CHOSEN METHOD SHALL BE APPROVED BY THE ENGINEER.
18. THE CONTRACTOR SHALL BE RESPONSIBLE FOR MAINTAINING THE VISIBILITY OF ALL DETOUR AND CONSTRUCTION SIGNS, INCLUDING BRUSHING BACK VEGETATION IF DEEMED NECESSARY BY THE ENGINEER.
19. THE COST OF THE WORK FOR THE DETOUR SHALL BE INCLUDED IN THE UNIT PRICE FOR "TRAFFIC CONTROL AND PROTECTION FOR TEMPORARY DETOUR."

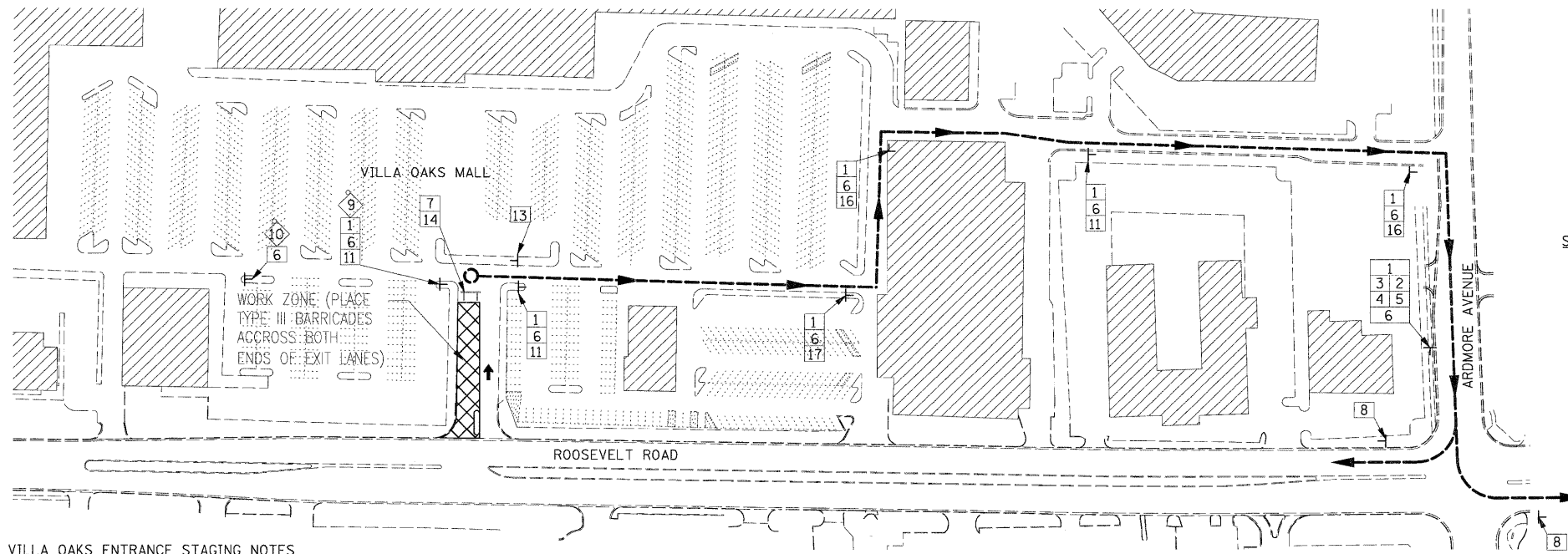

**VILLA OAKS ENTRANCE STAGING NOTES**

1. ONCE WORK HAS COMMENCED AT THE VILLA OAKS MALL ENTRANCE THE CONTRACTOR WILL HAVE 14 CALENDAR DAYS TO COMPLETE ALL WORK.
2. THE TWO (2) EXIT LANES FROM VILLA OAKS MALL MAY BE CLOSED FOR A PERIOD OF 8 HOURS TO REMOVE THE EXISTING PAVEMENT AND FOR 36 HOURS TO PLACE THE NEW PAVEMENT AND TRAFFIC DETECTOR LOOPS. DURING THESE CLOSURES DETOUR "A" SHALL BE UTILIZED. WHEN THE EXIT LANES ARE OPEN TO TRAFFIC AGGREGATE SHALL BE USED TO MAINTAIN TRAFFIC AT ENTRANCE.

**DETOUR "A" - PLAN**  
(TRAFFIC EXITING VILLA OAKS MALL)

3. ONE 12-FOOT ENTRANCE LANE SHALL BE MAINTAINED AT ALL TIMES ENTERING VILLA OAKS MALL TO SERVE EASTBOUND ROOSEVELT ROAD TRAFFIC TURNING LEFT (NORTHBOUND) INTO THE MALL. WESTBOUND ROOSEVELT ROAD TRAFFIC TURNING RIGHT (NORTHBOUND) INTO THE MALL SHALL BE REROUTED USING DETOUR "B" WHEN THE EAST ENTRANCE LANE IS CLOSED IN ORDER TO AVOID THE TIGHT RIGHT TURN CONDITION THAT WILL EXIST. BOTH ENTERING LANES MAY BE CLOSED FOR NO MORE THAN 36 HOURS TO ALLOW FOR PLACEMENT OF THE NEW CONCRETE PAVEMENT. DURING THIS CLOSURE DETOUR "B" SHALL BE UTILIZED.

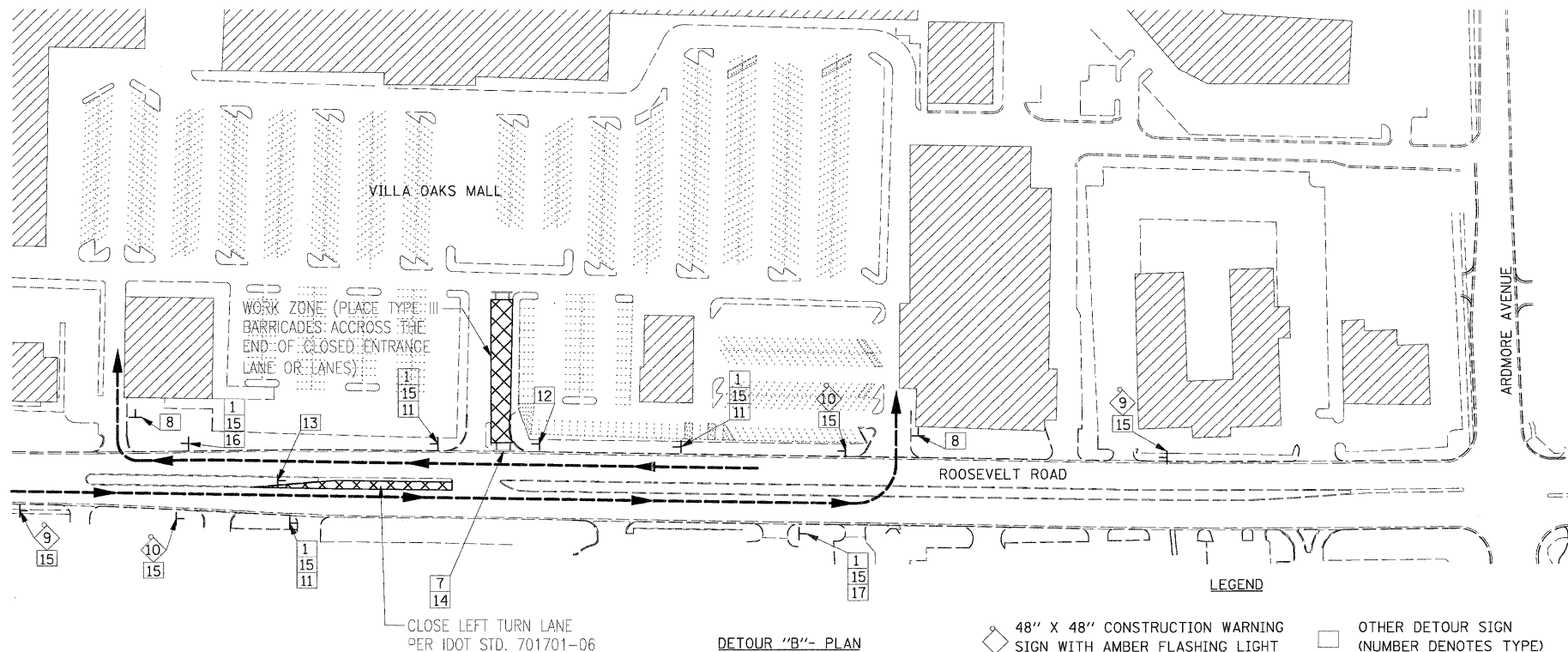

**DETOUR "B" - PLAN**  
(TRAFFIC ENTERING VILLA OAKS MALL)

- LEGEND**
- 48" X 48" CONSTRUCTION WARNING SIGN WITH AMBER FLASHING LIGHT (NUMBER DENOTES TYPE)
  - M4-9 SERIES DETOUR SIGN WITH ROAD NAME & DIRECTION PLATES (NUMBER DENOTES TYPE)
  - OTHER DETOUR SIGN (NUMBER DENOTES TYPE)
  - TYPE III BARRICADE WITH AMBER FLASHING LIGHTS
  - DETOUR ROUTE "A"
  - DETOUR ROUTE "B"
  - SIGN POST

**SCHEDULE OF SIGNS**

SIGN NUMBER	SIGN TYPE	SIGN TYPE
1	DETOUR	M4-8-2412
2	EAST	M3-2-2412
3	WEST	M3-4-2412
4	←	M6-1-2115
5	→	M6-1-2115
6	ROOSEVELT ROAD	W17-1000-2412
7	ROAD CLOSED	G20-1-3618
8	END DETOUR	M4-8a(0)-2418
9	ROAD CLOSED AHEAD	W20-2(0)-48
10	DETOUR AHEAD	W20-2-48
11	↑	M6-3-2115
12	↻	R3-1-24
13	↻	R3-2-24
14	DETOUR	M4-10L-4818
15	VILLA OAKS MALL ENTRANCE CLOSED	SPECIAL(0)-3621
16	↻	M5-1R-2115
17	↻	M5-1L-2115

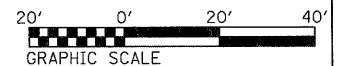

FILE NAME = D163197-ah1-mot.dgn	USER NAME IDOT	DESIGNED DA/SC	REVISOR 10/24/2011	<b>STATE OF ILLINOIS DEPARTMENT OF TRANSPORTATION</b>	<b>MAINTENANCE OF TRAFFIC PLAN ROOSEVELT RD. AT VILLA OAK DR. INTERSECTION</b>	F.A.P. RTE. 347	SECTION 02-00077-00-SW	COUNTY DUPAGE	TOTAL SHEETS 73	SHEET NO. 19	
PLOT SCALE 20,0000' / IN.	DRAWN BM/CC/BB	CHECKED DA	REVISOR			SCALE: AS SHOWN	SHEET NO. 1 OF 1 SHEETS	CONTRACT NO. 63197		FED. ROAD DIST. NO. ILLINOIS FED. AID PROJECT	
PLOT DATE 10/25/2011	DATE 06/08/2011	REVISOR	REVISOR								