

**CONSTRUCTION NOTES:**

- ① RELOCATE EXISTING SIGNAL POST AND SIGNAL HEAD, 1-FACE, 3-SECTION. INSTALL NEW PEDESTRIAN SIGNAL HEAD, 1-FACE, BRACKET MOUNTED WITH COUNTDOWN TIMER AND PEDESTRIAN PUSHBUTTON ON RELOCATED POST. INSTALL NEW TYPE A CONCRETE FOUNDATION AND REMOVE EXISTING CONCRETE FOUNDATION. REMOVE EXISTING 5C CABLE AND INSTALL NEW 2C, 3C, AND 5C CABLES.
- ② SAWCUT NEW DETECTOR LOOPS. REMOVE EXISTING LEAD-IN CABLE FROM CONDUIT AND INSTALL NEW LEAD-IN CABLE.
- ③ INSTALL NEW PEDESTRIAN SIGNAL HEAD, 1-FACE, BRACKET MOUNTED WITH COUNTDOWN TIMER AND PEDESTRIAN PUSHBUTTON ON EXISTING MAST ARM. INSTALL NEW 2C AND 3C CABLES.

**RESTORATION OF WORK AREA.**

RESTORATION OF THE TRAFFIC SIGNAL WORK AREA SHALL BE INCIDENTAL TO THE RELATED PAY ITEM SUCH AS FOUNDATION, CONDUIT, HANDHOLE, TRENCH AND BACKFILL, ETC. AND NO EXTRA COMPENSATION SHALL BE ALLOWED. ALL ROADWAY SURFACES SUCH AS SHOULDERS, MEDIANS, SIDEWALKS, PAVEMENT, ETC. SHALL BE REPLACED IN KIND. ALL DAMAGE TO MOWED LAWNS SHALL BE REPLACED WITH AN APPROVED SOD, AND ALL DAMAGE TO UNMOWED FIELDS SHALL BE SEEDED IN ACCORDANCE WITH STANDARD SPECIFICATIONS 252 AND 250 RESPECTIVELY.

ALL SIGNAL FOUNDATIONS AND UNDERGROUND WORK SHALL BE COMPLETED PRIOR TO THE REMOVAL OF THE EXISTING SIGNAL POST OR EXISTING FOUNDATIONS.

**TRAFFIC SIGNAL LEGEND**

- |  | PROPOSED | EXISTING |
|--|----------|----------|
| CONTROLLER   |          |          |
| SERVICE INSTALLATION   |          |          |
| SIGNAL HEAD  |          |          |
| SIGNAL HEAD WITH BACKPLATE                                   |          |          |
| SIGNAL HEAD, PEDESTRIAN                                      |          |          |
| SIGNAL POST  |          |          |
| MAST ARM ASSEMBLY AND POLE, STEEL                            |          |          |
| MAST ARM ASSEMBLY AND POLE, ALUMINUM                         |          |          |
| COMBINATION MAST ARM ASSEMBLY AND POLE, STEEL WITH LUMINAIRE |          |          |
| UNIT DUCT  |          |          |
| COMMON TRENCH  |          |          |
| HANDHOLE   |          |          |
| HEAVY DUTY HANDHOLE  |          |          |
| DOUBLE HANDHOLE  |          |          |
| UNDERGROUND CONDUIT  |          |          |
| PEDESTRIAN PUSHBUTTON DETECTOR                               |          |          |
| DETECTOR LOOP  |          |          |
| CAST IRON JUNCTION BOX                                       |          |          |
| EMERGENCY VEHICLE LIGHT DETECTOR                             |          |          |
| CONFIRMATION BEACON  |          |          |
| SIGNAL HEAD OPTICALLY PROGRAMMED                             |          |          |
| CONDUIT SPLICE   |          |          |
| WOOD POLE  |          |          |
| RACEWAY FOR MAGNETIC DETECTOR, TYPE I OR TYPE II             |          |          |
| VEHICLE DETECTOR, NON COMPENSATED MAGNETIC TYPE              |          |          |
| RAILROAD CONTROL CABINET                                     |          |          |
| TELEPHONE CONNECTION   |          |          |
| ILLUMINATED SIGN - "NO LEFT TURN"                            |          |          |
| ILLUMINATED SIGN - "NO RIGHT TURN"                           |          |          |

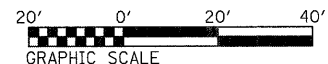
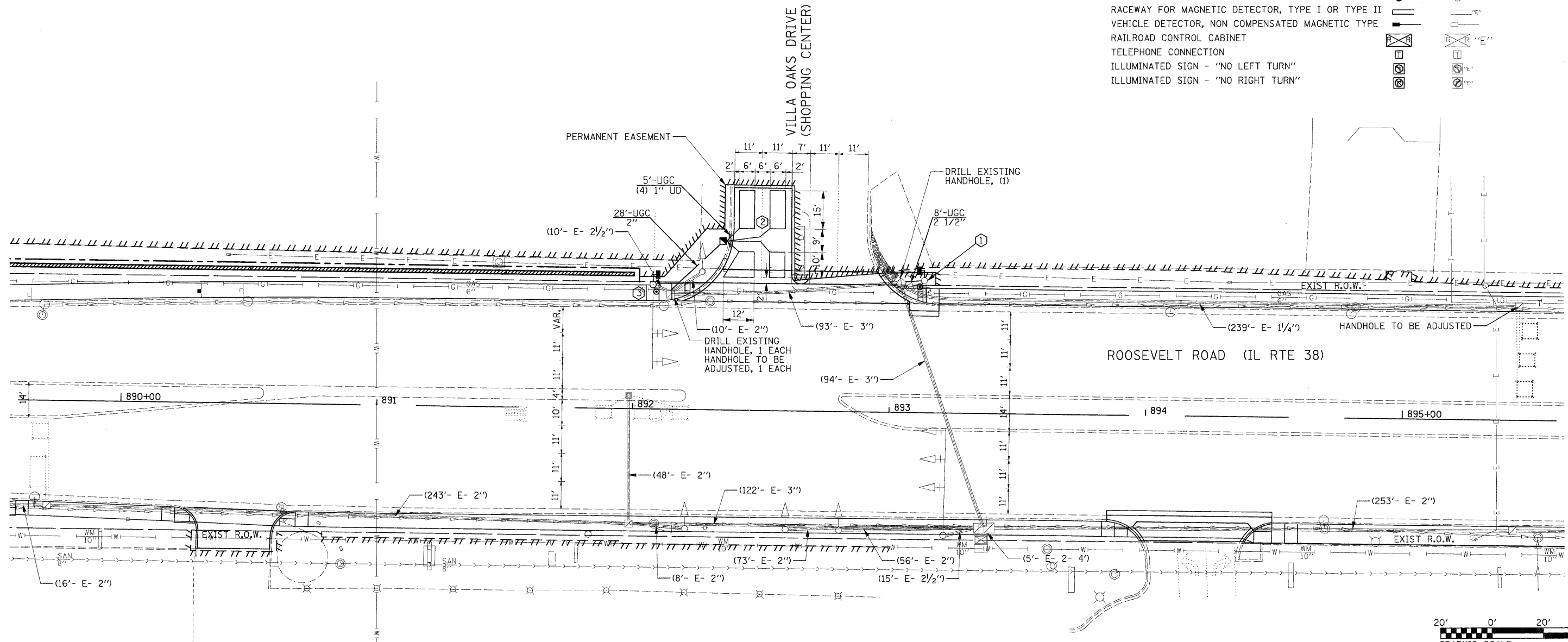
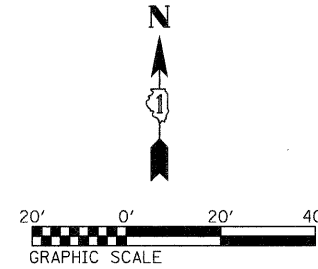

|                                     |                 |             |                   |   |  |                 |                         |   |                 |              |  |
|-------------------------------------|-----------------|-------------|-------------------|---|--|-----------------|-------------------------|---|-----------------|--------------|--|
| FILE NAME =<br>D163197-shr-ta04.dgn | USER NAME IDOT  | DESIGNED TM | REVISD 10/24/2011 | <b>STATE OF ILLINOIS<br/>DEPARTMENT OF TRANSPORTATION</b> | <b>TRAFFIC SIGNAL MODIFICATION PLAN<br/>ROOSEVELT RD. AT VILLA OAKS DR. INTERSECTION</b> | F.A.P. RTE. 347 | SECTION 02-00077-00-SW  | COUNTY DUPAGE                                 | TOTAL SHEETS 73 | SHEET NO. 49 |  |
| PLOT SCALE 20,0000' / IN.           | DRAWN BM/CC/BB  | CHECKED DA  | REVISD            |   |  | SCALE: AS SHOWN | SHEET NO. 3 OF 6 SHEETS | CONTRACT NO. 63197                            |                 |              |  |
| PLOT DATE 10/25/2011                | DATE 06/08/2011 | REVISD      |                   |   |  |                 |                         | FED. ROAD DIST. NO. ILLINOIS FED. AID PROJECT |                 |              |  |
|                                     |                 |             |                   |   |  |                 |                         |   |                 |              |  |